

REVISIONS			
REV	DESCRIPTION, ECN, EAR NO.	DATE	APP'D
A	PROPOSAL DRAWING	OCT08/14	L.CHAN
B	PROPOSAL DRAWING	FEB04/16	L.CHAN
C	PROPOSAL DRAWING	APR05/16	L.CHAN

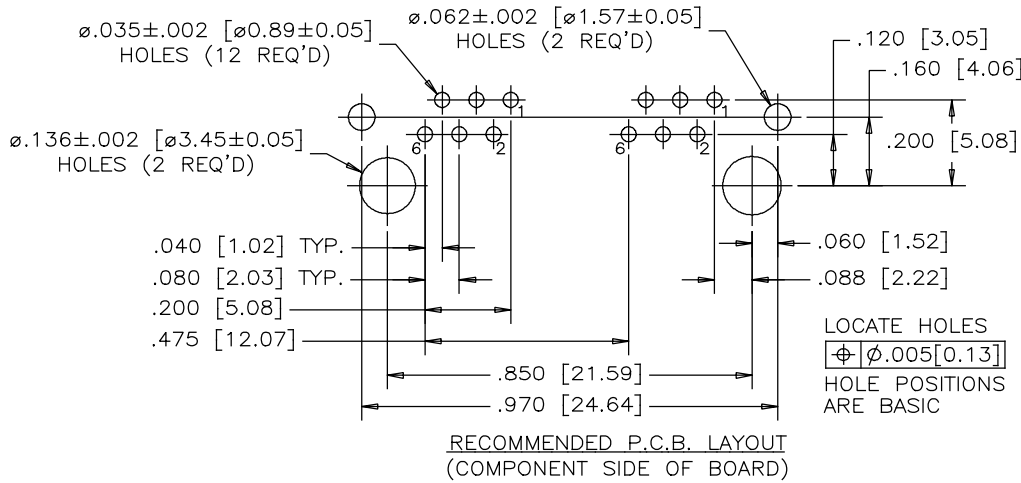
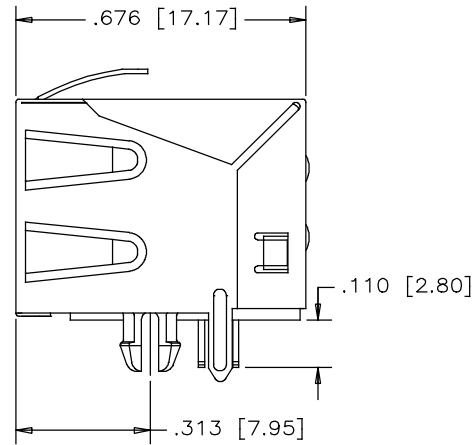
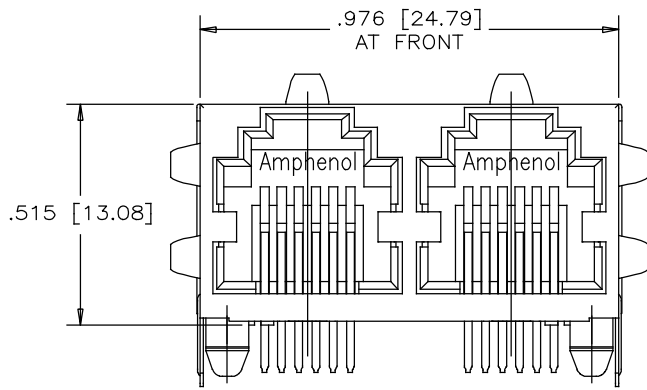

MATERIALS:

PLASTIC HOUSING: HIGH TEMPERATURE RESISTANT NYLON
 UL FLAMMABILITY RATING 94V-0.
 SOLDER REFLOW PROCESS COMPATIBLE.

CONTACTS: PHOSPHOR BRONZE

CONTACT PLATING: GOLD PLATED ON MATING SURFACES.
 (SEE PART NO. FOR THICKNESS).
 50 MICROINCHES [1.27 MICRONS] MIN.
 NICKEL UNDERPLATE
 100 MICROINCHES [2.54 MICRONS] MIN.
 MATTE TIN ON CONTACT TAILS.

SHIELD: COPPER ALLOY; NICKEL PLATED WITH TIN DIPPED
 PCB TAILS.

RECOMMENDED SOLDERING TEMPERATURE:
 WAVE SOLDERING OR REFLOW SOLDERING AT 260°C
 MAXIMUM FOR 5 SEC MAXIMUM.

AMPHENOL PART NUMBER: RJE01-X62-02

GOLD PLATING:
 1=RJ45 CONTACT 6u"
 G=RJ45 CONTACT 15u"
 J=RJ45 CONTACT 30u"
 6=RJ45 CONTACT 50u"

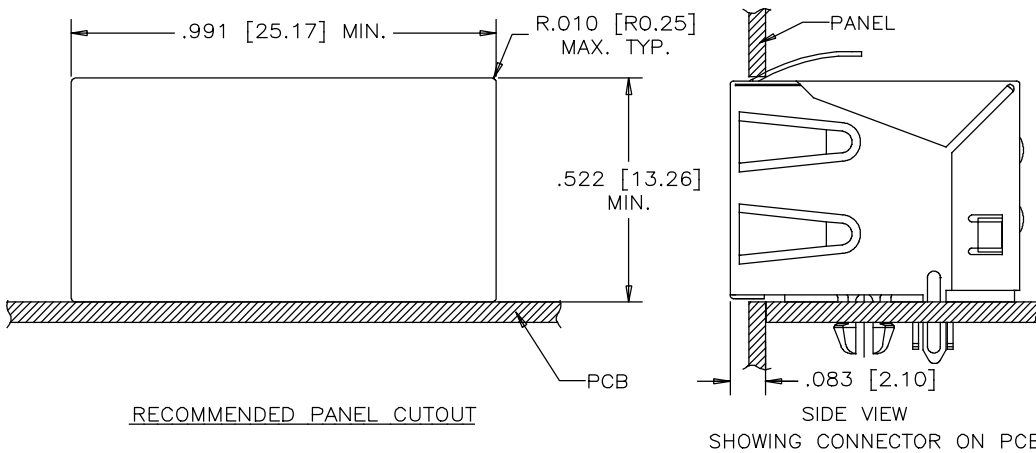

THIS DOCUMENT CONTAINS PROPRIETARY INFORMATION AND SUCH INFORMATION MAY NOT BE DISCLOSED TO OTHERS FOR ANY PURPOSE OR USED FOR MANUFACTURING PURPOSES WITHOUT WRITTEN PERMISSION FROM AMPHENOL CANADA CORP.

UNLESS SPECIFIED OTHERWISE	DRAWN	F.WANG	OCT08/14	Amphenol Canada Corp. www.amphenolcanada.com
PRIMARY UNITS INCHES	CHECKED	L.Chan	OCT08/14	
SECONDARY MILLIMETERS	M.E. APP'D			HIGH SPEED MODULAR JACK, 2 PORT, 6 POSITION, 6 CONTACTS, SHIELD WITH PCB TAILS—RoHS COMPLIANT
REFERENCE IN PARENTHESES	Q.A. APP'D			
GENERAL TOLERANCES FOR MM	DWG APP'D			DWG NO. P-RJE01-X62-02
1 DECIMAL PLACE ±0.025	ENG. REL. NO.			
2 DECIMAL PLACE ±0.020	REF.			REV C
3 DECIMAL PLACE ±0.015	THIRD ANGLE PROJECTION			
ANGULAR DEGREES ±1.5°	DO NOT SCALE DRAWING			CODE ID NO. 03554 DWG SIZE: C SCALE: N/A SHEET 1 OF 1