

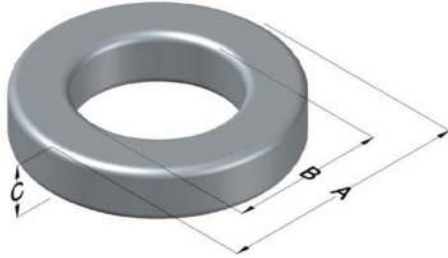

0076074A7

110 Delta Drive
 Pittsburgh, PA 15238
 NAFTA Sales: (1)800-245-3984
 HK Sales : (852)3102-9337
 magnetics@spang.com
 www.mag-inc.com



Kool M μ Hf Permeability (μ)	A _L (nH/T ²)	Core Marking			Coating Color
		Lot Number	Part Number	Inductance Grade	
26	65 ± 8%	XXXXXX	76074A7	N/A	Black

Dimensions	Uncoated		Coated Limits		Packaging
	(mm)	(in)	(mm)	(in)	
OD (A)	68.00	2.677	69.42	2.733	Cardboard cut-outs Box Qty= 35 pcs
ID (B)	35.99	1.417	34.67	1.365	
HT (C)	19.99	0.787	21.41	0.843	

Electrical Characteristics			Physical Characteristics						
Watt Loss @ 100 kHz, 100mT max (mW/cm ³)	DC Bias min (oersteds)		Voltage Breakdown wire to wire min (V _{AC})	Break Strength min (kg)	Window Area W _A (mm ²)	Cross Section A _e (mm ²)	Path Length L _e (mm)	Volume V _e (mm ³)	Weight (g)
	550	80%							
	130	245							

Winding Information					Temperature Rating	
Winding Length Per Turn				Wound Coil Dimensions (mm)		Curie Temp: 500°C
Winding Factor	(mm)	Winding Factor	(mm)	Maximum OD (70%)		Coating Temp (Continuous up to): 200°C
				Maximum HT (70%)		Notes:
0%	77.7	40%	95.7	Surface Area (mm ²)		
20%	86.6	45%	97.9	Unwound Core		
25%	89.0	50%	76.1	40% Winding Factor		
30%	90.5	60%	106			
35%	93.4	70%	112			

Typical DC Bias Performance

