

PRODUCT NUMBER
98416-XXX-XX-XXXLF

PLATING _____
S = 0.38µm GOLD/GXT ON CONTACT AREA
3.81µm TIN LEAD ON TAIL
G = 0.76µm GOLD/GXT ON CONTACT AREA
3.81µm TIN LEAD ON TAIL
F = GOLD FASH ON CONTACT AREA
3.81µm TIN LEAD ON TAIL

RoHS COMPATIBLE, SEE NOTE 8

POLARIZATION, SEE NOTE 7
PACKAGING, SEE NOTE 5
TOTAL NB OF POS, 04 UP TO 50 ONLY 16 POS TOOLED.
COLOR OPTION NOTE 1

PIN STYLE	TAIL LENGTH
04	2.00
06	2.50
08	3.10
10	3.70

NOTES:

- MATERIAL HOUSING: HIGH TEMP. THERMOPLASTIC UL-94VO
- = STANDARD COLOR CREAM
B = OPTIONAL COLOR BLACK
- MATERIAL TERMINAL: COPPER ALLOY
- TO DETERMINE DIMENSIONS:
N = NUMBER OF POSITIONS PER ROW
- 7N MIN. PIN RETENTION IN EITHER DIRECTION.
- PACKAGING:
= PLASTIC BOX
- = PLASTIC BOX WHEN POLARISATION FEATURE APPLICABLE
U = TUBE AVAILABLE FROM 06 TO 50 POS
- DIM "C" = (N x 2) + 1.4
EXAMPLE: N = 7
DIM "C" = (7 x 2) + 1.4 = 15.4 mm
- FOR POLARIZATION, SPECIFIED PIN
EXAMPLE : A03 = ROW A, POSITION 03 TO OMIT PIN
OMIT FROM PRODUCT NUMBER IF THIS FEATURE IS NOT APPLICABLE.
- RoHS COMPATIBLE PRODUCT SPECIFICATIONS
 - PLATING:
- "LF" MEANS THE PRODUCT IS LEAD-FREE,
2µm MINIMUM MATTE TIN OVER 1.27µm
MINIMUM NICKEL UNDERPLATE.
 - MANUFACTURING PROCESS COMPATIBILITY
- THE HOUSING WILL WITHSTAND EXPOSURE TO
260°C ±5°C SOLDER BATH TEMPERATURE FOR
5 SECONDS IN A WAVE SOLDER APPLICATION
WITH A 1.6mm MIN THICK CIRCUIT BOARD.
 - LABELLING:
- MEETS PACKAGING SPECS AS PER GS-14-920
 - THIS PRODUCT MEETS EUROPEAN DIRECTIVES
AND OTHER COUNTRY REGULATIONS AS DISCRIBED
IN GS-47-0004.

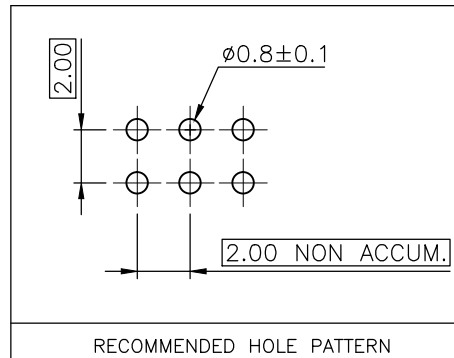
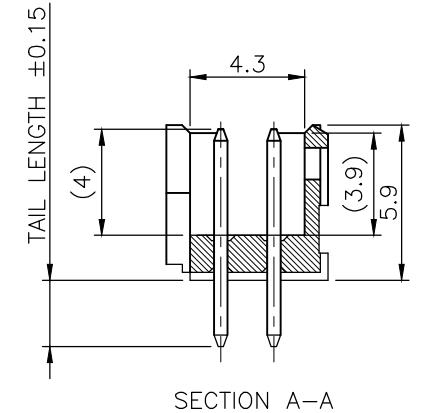
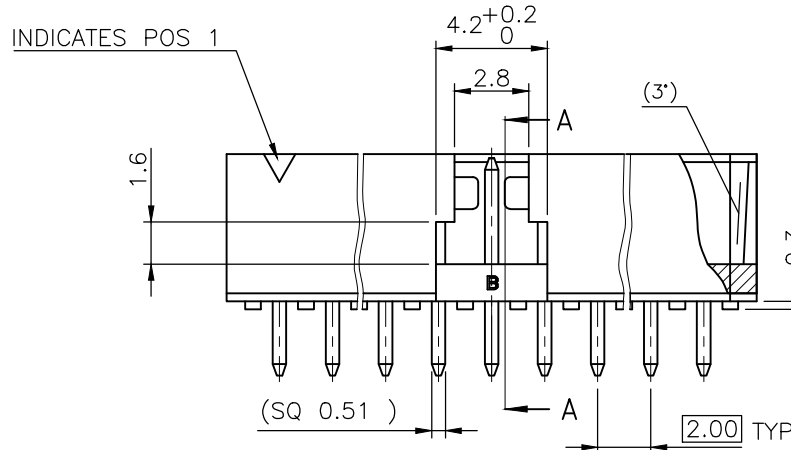
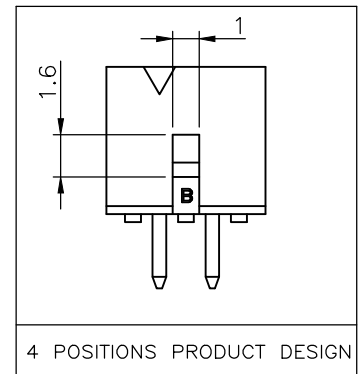
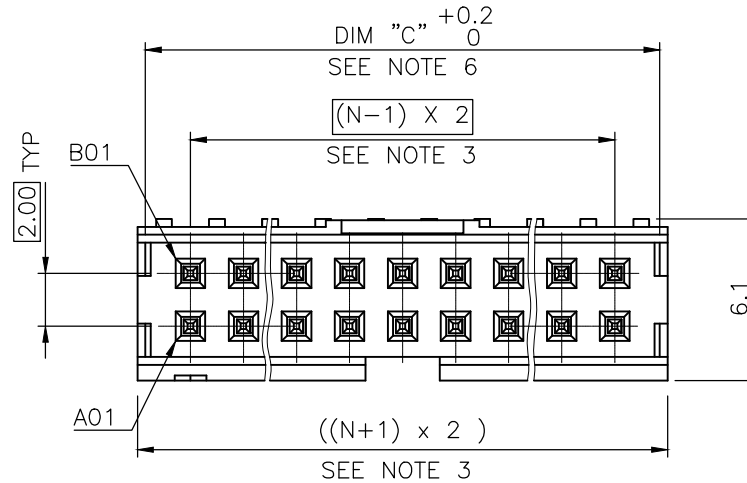

mat'l. code		surface		tolerance		projection		product family	
SEE NOTES		ISO 1302		ISO 406 ISO 101		101		MINITEK	
ltr	ecn no	dr	date	tolerances unless otherwise specified		mm		title	
A		AMA	14.12.11	angles	linear	X.X ±0.3		SHR HEADER	
B	B-20254	LMU	15.02.16			X.XX ±0.13		2.0MM, HIGH END WALLS	
						X.XXX ±0.05		scale 1:1	
		dr	L.MULIN			11.05.19		sheet 1 of 2 size	
		enfr	J.COMPAGNON			11.05.19		98416 A3	
		chr	JCO			11.05.20		type CUSTOMER Drawing	
		appd	JCO			11.12.02			
sheet index	revision	B	B						
	sheet	1	2						

2.6
1.5

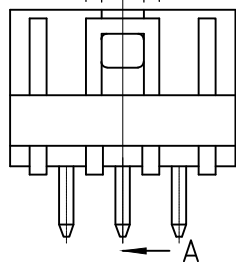

2x3 POS AND 2x4 POS CONFIGURATION
NO LATCHING AVAILABLE FOR 2x2 POS

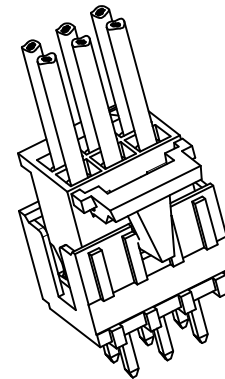
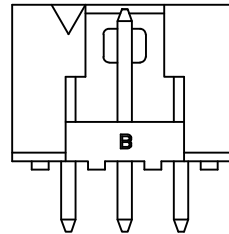
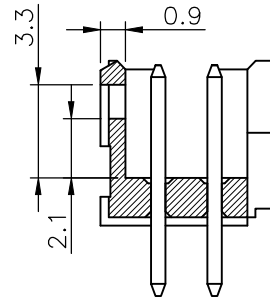

4.6
1
0.6

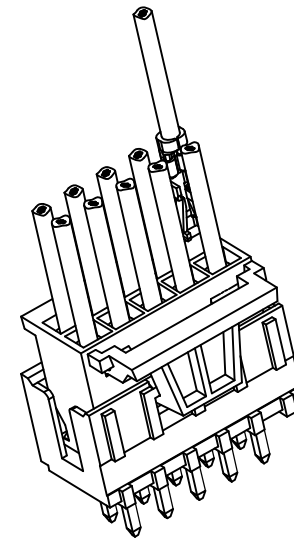
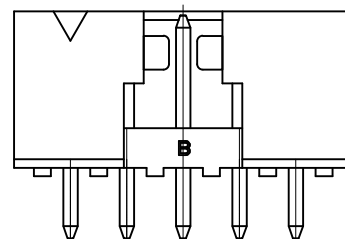
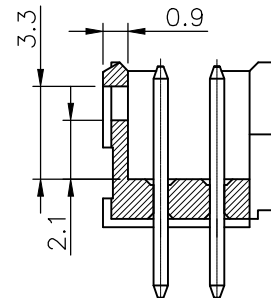
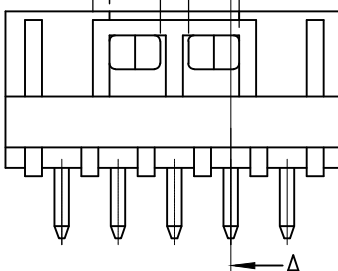

2x5 POS UP TO 2x25 POS CONFIGURATION

LATCHING FEATURES WHEN USED IN COMBINATION
WITH ACTIVE LATCH HOUSING 10073599

mat'l. code		surface		tolerance		projection		product family	
SEE NOTES		ISO 1302 ✓		ISO 406 ISO		101		MINITEK	
ltr	ecn no	dr	date	tolerances unless otherwise specified		mm		title	
A		AMA	14.12.11	angles	X.X ±0.3	← mm →		SHR HEADER	
B	B-20254	LMU	15.02.16	linear	X.XX ±0.13	scale 1:1		2.0MM, HIGH END WALLS	
					X.XXX ±0.05	FCJ		dwg no 98416 sheet 2 of - size A3	
		dr	L.MULIN		11.05.19			type CUSTOMER Drawing	
		enr	J.COMPAGNON		11.05.19				
		chr	JCO		11.05.20				
		appd	JCO		11.12.02				
sheet	revision								
index	sheet								



Copyright FCI