

PROD	LOC	DIST	P	F	ZONE	LTR	DESCRIPTION	DATE	APPD
4085	DF	50				A	REV PER 0600-4326-95	CT	DE

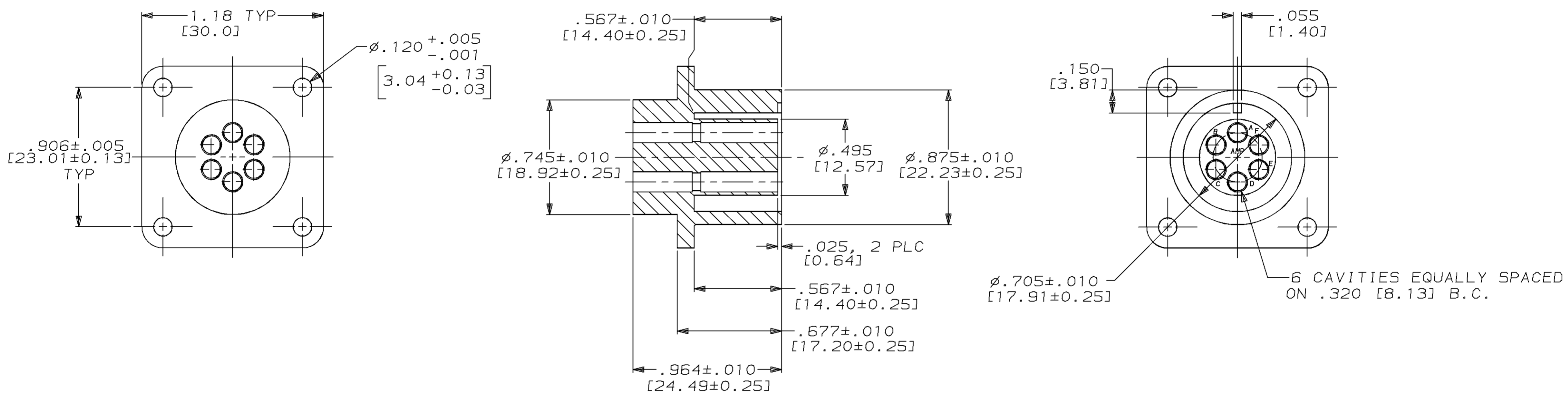

- THIS CONNECTOR ACCEPTS SIX AMP MULTIMATE SOCKET CONTACTS, NOT SUPPLIED WITH CONNECTOR.
- MARKED PER MIL-STD-130.

449652-1
PART NO.

DO NOT SCALE PRINT. UNLESS SPECIFIED DIMENSIONS IN INCHES [mm] TOLERANCES ON : 2 PLC DEC ± .03 [0.8] 3 PLC DEC ± .005 [0.13] ANGLES ± -	DR 9-8-93 C.C. THOMAS	AMP Incorporated Harrisburg, PA 17105-3608		
	CHK 9-8-93 S. GLATFELTER			
MATERIAL POLYESTER MLDG CMPD	APPD 9-8-93 S. GLATFELTER	RECEPTACLE, 6 POSN., LGH, 145-65		
COLOR RED	APPD 9-9-93 C.C. THOMAS	SIZE C	CAGE CODE 00779	DRAWING NO G=449652
	PRODUCT SPEC -	SCALE 2:1	SHEET 1 OF 1	
	APPLICATION SPEC -	CUSTOMER DRAWING		
	WEIGHT -			

THIS DRAWING IS A CONTROLLED DOCUMENT FOR AMP INCORPORATED. IT IS SUBJECT TO CHANGE AND THE CONTROLLING ENGINEERING ORGANIZATION SHOULD BE CONTACTED FOR THE LATEST REVISION.