

THIS COPY IS PROVIDED ON A RESTRICTED BASIS AND IS NOT TO BE USED IN ANY WAY DETRIMENTAL TO THE INTERESTS OF PANDUIT CORP.

| PANDUIT PART NUMBER | STUD SIZE | DIMENSIONS in.  |                |               |                |               |
|---------------------|-----------|-----------------|----------------|---------------|----------------|---------------|
|                     |           | A $\pm .030$    | W $\pm .010$   | C $\pm .020$  | M $\pm .030$   | H $\pm .010$  |
| PN12-6HDR-2K        | #6        | 1.02<br>(25.91) | .31<br>(7.87)  | .31<br>(7.87) | .86<br>(21.84) | .15<br>(3.81) |
| PN12-8HDR-2K        | #8        | 1.02<br>(25.91) | .31<br>(7.87)  | .31<br>(7.87) | .86<br>(21.84) | .17<br>(4.32) |
| PN12-10HDR-2K       | #10       | 1.05<br>(26.67) | .38<br>(9.65)  | .31<br>(7.87) | .86<br>(21.84) | .20<br>(5.08) |
| PN12-14HDR-2K       | 1/4"      | 1.20<br>(30.48) | .52<br>(13.21) | .38<br>(9.65) | .94<br>(23.88) | .27<br>(6.86) |
| PN12-56HDR-2K       | 5/16"     | 1.20<br>(30.48) | .52<br>(13.21) | .38<br>(9.65) | .94<br>(23.88) | .33<br>(8.38) |
| PN12-38HDR-2K       | 3/8"      | 1.28<br>(32.51) | .58<br>(14.73) | .38<br>(9.65) | .98<br>(24.89) | .39<br>(9.91) |

NOTES :

- UL LISTED AND CSA CERTIFIED FOR :
  - 600 V MAX. VOLTAGE RATING
  - 221°F (105°C) MAX. TEMP. RATING
  - #16-12 AWG (1.5-4.0 mm<sup>2</sup>) SOLID OR STRANDED, COPPER WIRE
- PACKAGE QTY. : 2K = 2000 PCS.  
CONTINUOUS MOLDED CARRIER STRIP
- MATERIAL :
  - STAMPING - .05" THK COPPER, TIN PLATED
  - HOUSING - YELLOW NYLON
  - SLEEVE - BRASS, TIN PLATED
- DIMENSIONS IN BRACKETS ARE IN MILLIMETERS
- INSTALLATION TOOLS :
  - PRESSES - CP-851, CP-860, CP-861
  - APPLICATOR - CA-800
  - DIE INSERTS - CD-800-3

6. WIRE STRIP LENGTH:  $9/32^{+1.32}_{-0}$  (7.1<sup>+0.8</sup><sub>-0</sub>)



LISTED  
587H  
E52164



CERTIFIED  
LR31212

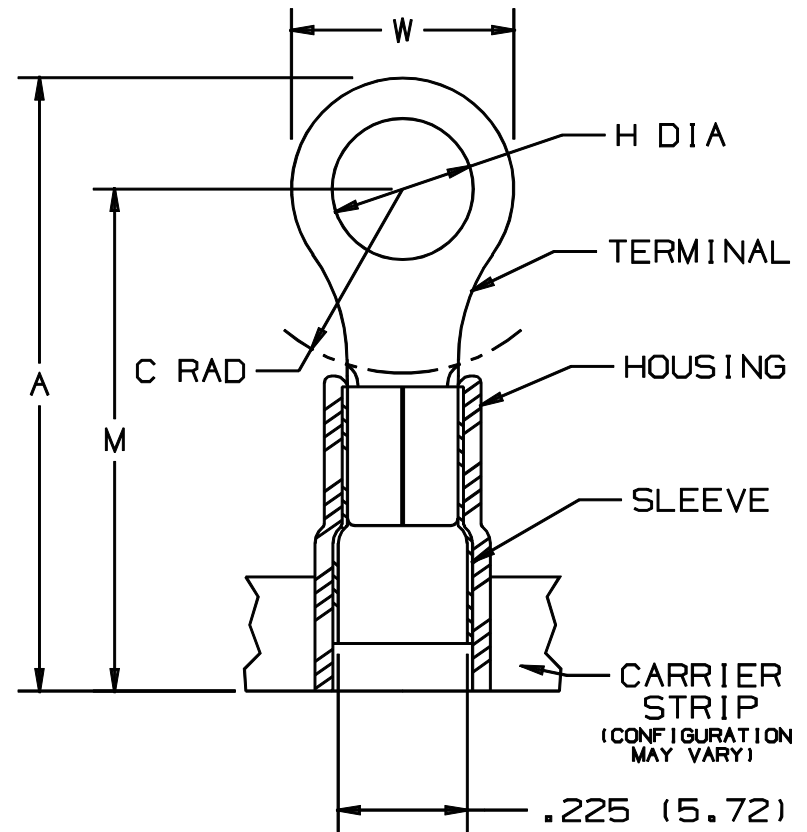
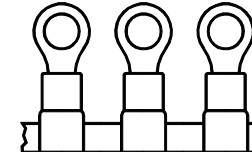

.225 (5.72)  
MAX WIRE  
INSUL DIA  
.130 (3.30)  
MIN. WIRE  
INSL. DIA.

A41097\_04

|     |       |      |     |   |       |      |     |  |
|-----|-------|------|-----|---|-------|------|-----|--|
| 04  | 12/00 | ED   |     | FILESPEC WAS: N41097AA_PCD_03           |       |      |     | <p>PANDUIT CORP. TINLEY PARK, ILLINOIS</p> <p>TERMO 3PC. CONTINUOUSLY MOLDED NYLON INSULATED, 16-12 BARREL, HEAVY DUTY RINGS</p> |
| 03  | 12/96 | JAMB |     | ADDED DIM., "MIN. WIRE INSUL. DIA."     |       |      |     |  |
| 02  | 9/96  | TSM  | RLS | REVISE DIMS AND TOLERANCES, ADD NOTE #6 | 050B2 | LA   | DBH |  |
|     |       |      |     | ORIGINAL FILE SPEC WAS A41097A          |       |      |     |  |
| REV | DATE  | BY   | CHK | DESCRIPTION                             | ECN   | CUST | PM  | DRAWN BY JMV<br>Ck'D LA<br>SCALE NONE<br>DRAWING NO. A41097  |