

PART NUMBER	PLATING	RECOMMENDED WIRE SIZE	DIM 'A' HEIGHT	DIM 'B' WIDTH	DIM 'C' GAP	DIM 'D' TIPS	RECOMMENDED CRIMP APPLICATOR	MATING CONTACT	PACKAGE SIZE
44262-4334	30μ * GOLD STRIPE OVER 50μ * NICKEL OVERALL WITH 80-130μ * SELECT TIN	8 AWG (2) 12 AWG	7.42±0.5 .292±.020	5.84±0.5 .230±.020			63832-6300	44262-6*** SEE MOLEX DRAWING SD-44262-026 OR WITH BLADES 0.64/.025 THICK X 6.10/.240 MIN WIDE	1800 PARTS/ REEL
44262-4332	30μ * GOLD STRIPE OVER 50μ * NICKEL OVERALL WITH 80-130μ * SELECT TIN	10-12 AWG (2) 14 AWG	5.97±0.5 .235±.020	5.33±0.5 .210±.020	0.10/.004	2.54/.100 REF	63832-6000		2500 PARTS/ REEL
44262-4336	30μ * GOLD STRIPE OVER 50μ * NICKEL OVERALL WITH 80-130μ * SELECT TIN	14-16 AWG (2) 16 AWG (2) 18 AWG	5.20±0.5 .205±.020	5.33±0.5 .210±.020			63832-6100		
44262-4434	30μ * GOLD STRIPE OVER 50μ * NICKEL OVERALL WITH 80-130μ * SELECT TIN	8 AWG (2) 12 AWG	7.42±0.5 .292±.020	5.84±0.5 .230±.020			63832-6300	FOR USE WITH BLADES 1.27/.050 THICK X 6.10/.240 MIN WIDE	1800 PARTS/ REEL
44262-4432	30μ * GOLD STRIPE OVER 50μ * NICKEL OVERALL WITH 80-130μ * SELECT TIN	10-12 AWG (2) 14 AWG	5.97±0.5 .235±.020	5.33±0.5 .210±.020	0.64/.025	3.07/.121 REF	63832-6000		2500 PARTS/ REEL
44262-4436	30μ * GOLD STRIPE OVER 50μ * NICKEL OVERALL WITH 80-130μ * SELECT TIN	14-16 AWG (2) 16 AWG (2) 18 AWG	5.20±0.5 .205±.020	5.33±0.5 .210±.020			63832-6100		
44262-4534	30μ * GOLD STRIPE OVER 50μ * NICKEL OVERALL WITH 80-130μ * SELECT TIN	8 AWG (2) 12 AWG	7.42±0.5 .292±.020	5.84±0.5 .230±.020			63832-6300	FOR USE WITH BLADES 0.81/.032 THICK X 6.10/.240 MIN WIDE RECOMMENDED FOR 6 CIRCUITS AND ABOVE	1800 PARTS/ REEL
44262-4532	30μ * GOLD STRIPE OVER 50μ * NICKEL OVERALL WITH 80-130μ * SELECT TIN	10-12 AWG (2) 14 AWG	5.97±0.5 .235±.020	5.33±0.5 .210±.020	0.30/.012	2.74/.108 REF	63832-6000		2500 PARTS/ REEL
44262-4536	30μ * GOLD STRIPE OVER 50μ * NICKEL OVERALL WITH 80-130μ * SELECT TIN	14-16 AWG (2) 16 AWG (2) 18 AWG	5.20±0.5 .205±.020	5.33±0.5 .210±.020			63832-6100		
44262-4634	30μ * GOLD STRIPE OVER 50μ * NICKEL OVERALL WITH 80-130μ * SELECT TIN	8 AWG (2) 12 AWG	7.42±0.5 .292±.020	5.84±0.5 .230±.020			63832-6300	FOR USE WITH BLADES 1.27/.050 THICK X 6.10/.240 MIN WIDE RECOMMENDED FOR 6 CIRCUITS AND ABOVE	1800 PARTS/ REEL
44262-4632	30μ * GOLD STRIPE OVER 50μ * NICKEL OVERALL WITH 80-130μ * SELECT TIN	10-12 AWG (2) 14 AWG	5.97±0.5 .235±.020	5.33±0.5 .210±.020	0.89/.035	3.33/.131 REF	63832-6000		2500 PARTS/ REEL
44262-4636	30μ * GOLD STRIPE OVER 50μ * NICKEL OVERALL WITH 80-130μ * SELECT TIN	14-16 AWG (2) 16 AWG (2) 18 AWG	5.20±0.5 .205±.020	5.33±0.5 .210±.020			63832-6100		

- NOTES:
1. MATERIAL: COPPER ALLOY .032 IN THICK
 2. FINISH: PER MOLEX PLATING SPECIFICATION ES-88 - SEE CHART
 3. FOR CRIMP APPLICATOR SEE CHART
 4. FOR CRIMP TOOLING CONTACT MOLEX OR VISIT THE MOLEX WEBSITE AT: WWW.MOLEX.COM
 5. STANDARD PACKAGE SIZE: SEE CHART
 6. SEE PRODUCT SPECIFICATION: PS-44262-001 FOR MORE INFORMATION
 7. PARTS ARE RoHS COMPLIANT
 8. FOR MATING CONTACT: SEE CHART
 9. FOR CRIMP SET UP INFORMATION SEE MOLEX APPLICATION SPECIFICATION DOCUMENT:
8 AWG - ATS-638326300
10/12 AWG - ATS-638326000
14/16 AWG - ATS-638326100

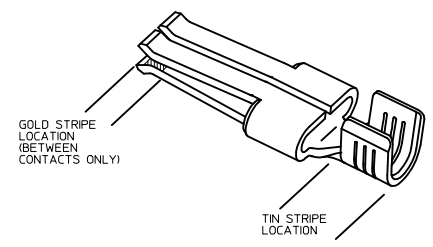

REMOVE THRU DIE PARTS FROM CHART

DEC NO: UCP2016-1882
DRAWN: SCHWEPER 2015/07/22
CHKD:
APPROPRIATE FOR 2015/11/20

QUALITY SYMBOLS	GENERAL TOLERANCES (UNLESS SPECIFIED)		DIMENSION STYLE		SCALE	DESIGN UNITS	THIRD ANGLE PROJECTION
	mm	INCH	MM/MIN	DATE	1:1	INCH	☉
▽=0	4 PLACES ±.010	±.005	BKOSTIC	2006/11/13			TERMINAL - RECEPTACLE POWER CONTACT
▽=0	3 PLACES ±.010	±.010	BKOSTIC	2006/11/13			
▽=0	2 PLACES ±.025	±.010	BKOSTIC	2006/11/13			
	1 PLACE ±.025	±.010	APATEL	2006/11/14			
	ANGULAR ±1/2°		DRAWN BY DATE		DRAWN BY DATE		
	DRAFT WHERE APPLICABLE MUST REMAIN WITHIN DIMENSIONS		CHECKED BY DATE		CHECKED BY DATE		
			APPROVED BY DATE		APPROVED BY DATE		
			MATERIAL NO.		MATERIAL NO.		
			SEE CHART		SEE CHART		
			SIZE D		SIZE D		
			THIS DRAWING CONTAINS INFORMATION THAT IS PROPRIETARY TO MOLEX INCORPORATED AND SHOULD NOT BE USED WITHOUT WRITTEN PERMISSION		THIS DRAWING CONTAINS INFORMATION THAT IS PROPRIETARY TO MOLEX INCORPORATED AND SHOULD NOT BE USED WITHOUT WRITTEN PERMISSION		

MATERIAL NO. SD-44262-100

DOCUMENT NO. SD-44262-100

SHEET NO. 1 OF 2

20 19 18 17 16 15 14 13 12 11 10 9 8 7 6 5 4 3 2 1

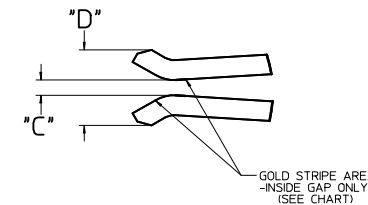
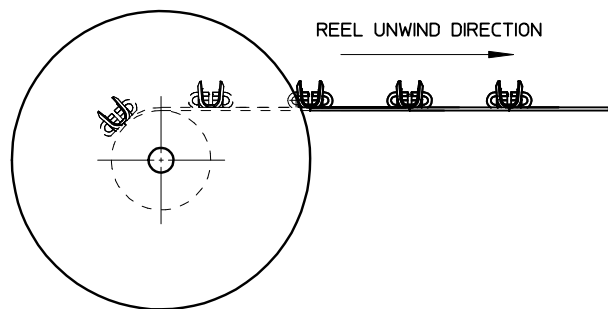
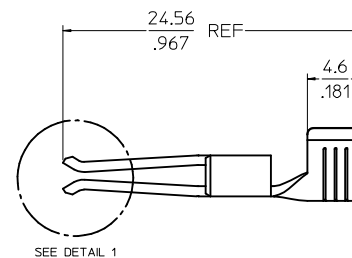
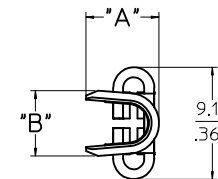
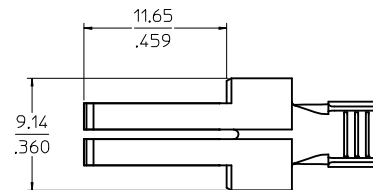
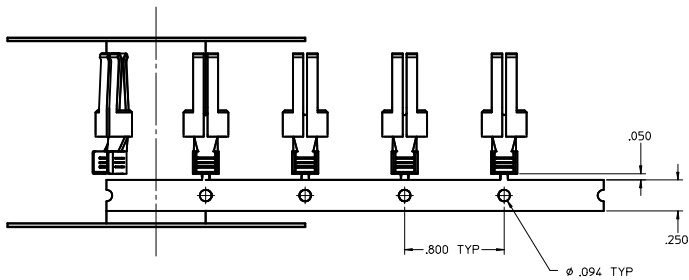

DETAIL 1
SCALE 10:1

SEE SHEET 1 IEC NO. UCP2016-1882 DRAWN: SCHAEFER 2015/07/22 CHKD: APPR: BPI/SZCZOR 2015/11/30 D0	QUALITY SYMBOLS	GENERAL TOLERANCES (UNLESS SPECIFIED)	DIMENSION STYLE	SCALE	DESIGN UNITS	THIRD ANGLE PROJECTION
	∇=0 ∇=0 ∇=0	4 PLACES ± .010 3 PLACES ± .010 2 PLACES ± 0.25 ± .010 1 PLACE ± 0.25 ± .010 ANGULAR ± 1/2°	MM/IN	5:1	INCH	DRAWN BY: BKOSTIC DATE: 2006/11/13 CHECKED BY: BKOSTIC DATE: 2006/11/13 APPROVED BY: APATEL DATE: 2006/11/14
DRAFT WHERE APPLICABLE MUST REMAIN WITHIN DIMENSIONS			SIZE D		MOLEX INCORPORATED SHEET NO. 2 OF 2	

19 18 17 16 15 14 13 12 11 10 9 8 7 6 5 4 3 2 1

PART NUMBER	PLATING	RECOMMENDED WIRE SIZE	DIM 'A' HEIGHT	DIM 'B' WIDTH	DIM 'C' GAP	DIM 'D' TIPS	RECOMMENDED CRIMP APPLICATOR	MATING CONTACT	PACKAGE SIZE
44262-4334	30μ * GOLD STRIPE OVER 50μ * NICKEL OVERALL WITH 80-130μ * SELECT TIN	8 AWG (2) 12 AWG	7.42±0.5 .292±.020	5.84±0.5 .230±.020			63832-6300	44262-6*** SEE MOLEX DRAWING SD-44262-026 OR WITH BLADES 0.64/.025 THICK X 6.10/.240 MIN WIDE	1800 PARTS/ REEL
44262-4332	30μ * GOLD STRIPE OVER 50μ * NICKEL OVERALL WITH 80-130μ * SELECT TIN	10-12 AWG (2) 14 AWG	5.97±0.5 .235±.020	5.33±0.5 .210±.020	0.10/.004	2.54/.100 REF	63832-6000		2500 PARTS/ REEL
44262-4336	30μ * GOLD STRIPE OVER 50μ * NICKEL OVERALL WITH 80-130μ * SELECT TIN	14-16 AWG (2) 16 AWG (2) 18 AWG	5.20±0.5 .205±.020	5.33±0.5 .210±.020			63832-6100		
44262-4434	30μ * GOLD STRIPE OVER 50μ * NICKEL OVERALL WITH 80-130μ * SELECT TIN	8 AWG (2) 12 AWG	7.42±0.5 .292±.020	5.84±0.5 .230±.020			63832-6300	FOR USE WITH BLADES 1.27/.050 THICK X 6.10/.240 MIN WIDE	1800 PARTS/ REEL
44262-4432	30μ * GOLD STRIPE OVER 50μ * NICKEL OVERALL WITH 80-130μ * SELECT TIN	10-12 AWG (2) 14 AWG	5.97±0.5 .235±.020	5.33±0.5 .210±.020	0.64/.025	3.07/.121 REF	63832-6000		2500 PARTS/ REEL
44262-4436	30μ * GOLD STRIPE OVER 50μ * NICKEL OVERALL WITH 80-130μ * SELECT TIN	14-16 AWG (2) 16 AWG (2) 18 AWG	5.20±0.5 .205±.020	5.33±0.5 .210±.020			63832-6100		
44262-4534	30μ * GOLD STRIPE OVER 50μ * NICKEL OVERALL WITH 80-130μ * SELECT TIN	8 AWG (2) 12 AWG	7.42±0.5 .292±.020	5.84±0.5 .230±.020			63832-6300	FOR USE WITH BLADES 0.81/.032 THICK X 6.10/.240 MIN WIDE RECOMMENDED FOR 6 CIRCUITS AND ABOVE	1800 PARTS/ REEL
44262-4532	30μ * GOLD STRIPE OVER 50μ * NICKEL OVERALL WITH 80-130μ * SELECT TIN	10-12 AWG (2) 14 AWG	5.97±0.5 .235±.020	5.33±0.5 .210±.020	0.30/.012	2.74/.108 REF	63832-6000		2500 PARTS/ REEL
44262-4536	30μ * GOLD STRIPE OVER 50μ * NICKEL OVERALL WITH 80-130μ * SELECT TIN	14-16 AWG (2) 16 AWG (2) 18 AWG	5.20±0.5 .205±.020	5.33±0.5 .210±.020			63832-6100		
44262-4634	30μ * GOLD STRIPE OVER 50μ * NICKEL OVERALL WITH 80-130μ * SELECT TIN	8 AWG (2) 12 AWG	7.42±0.5 .292±.020	5.84±0.5 .230±.020			63832-6300	FOR USE WITH BLADES 1.27/.050 THICK X 6.10/.240 MIN WIDE RECOMMENDED FOR 6 CIRCUITS AND ABOVE	1800 PARTS/ REEL
44262-4632	30μ * GOLD STRIPE OVER 50μ * NICKEL OVERALL WITH 80-130μ * SELECT TIN	10-12 AWG (2) 14 AWG	5.97±0.5 .235±.020	5.33±0.5 .210±.020	0.89/.035	3.33/.131 REF	63832-6000		2500 PARTS/ REEL
44262-4636	30μ * GOLD STRIPE OVER 50μ * NICKEL OVERALL WITH 80-130μ * SELECT TIN	14-16 AWG (2) 16 AWG (2) 18 AWG	5.20±0.5 .205±.020	5.33±0.5 .210±.020			63832-6100		

- NOTES:
1. MATERIAL: COPPER ALLOY .032 IN THICK
 2. FINISH: PER MOLEX PLATING SPECIFICATION ES-88 - SEE CHART
 3. FOR CRIMP APPLICATOR SEE CHART
 4. FOR CRIMP TOOLING CONTACT MOLEX OR VISIT THE MOLEX WEBSITE AT: WWW.MOLEX.COM
 5. STANDARD PACKAGE SIZE: SEE CHART
 6. SEE PRODUCT SPECIFICATION: PS-44262-001 FOR MORE INFORMATION
 7. PARTS ARE RoHS COMPLIANT
 8. FOR MATING CONTACT: SEE CHART
 9. FOR CRIMP SET UP INFORMATION SEE MOLEX APPLICATION SPECIFICATION DOCUMENT:
8 AWG - ATS-638326300
10/12 AWG - ATS-638326000
14/16 AWG - ATS-638326100

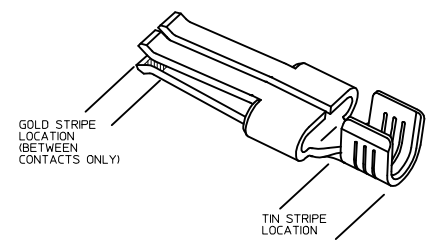

REMOVE THRU DIE PARTS FROM CHART

DEC NO: UCP2016-1882
DRAWN BY: SCHWABER
CHKD: SCHWABER
APPROVED: SZCZOR
REV: 2015/11/20

QUALITY SYMBOLS	GENERAL TOLERANCES (UNLESS SPECIFIED)		DIMENSION STYLE		SCALE	DESIGN UNITS	THIRD ANGLE PROJECTION
	mm	INCH	MM/MIN	DATE			
▽=0	4 PLACES ±.010	±.005	BKOSTIC	2006/11/13	1:1	INCH	TERMINAL - RECEPTACLE POWER CONTACT
▽=0	3 PLACES ±.010	±.010	BKOSTIC	2006/11/13			
▽=0	2 PLACES ±.025	±.010	BKOSTIC	2006/11/13			
▽=0	1 PLACE ±.025	±.010	BKOSTIC	2006/11/13			
	ANGULAR ±1/2°		APATEL		2006/11/14	MOLEX INCORPORATED	
	DRAFT WHERE APPLICABLE MUST REMAIN WITHIN DIMENSIONS		MATERIAL NO. SEE CHART		DOCUMENT NO. SD-44262-100	SHEET NO. 1 OF 2	

THIS DRAWING CONTAINS INFORMATION THAT IS PROPRIETARY TO MOLEX INCORPORATED AND SHOULD NOT BE USED WITHOUT WRITTEN PERMISSION

20 19 18 17 16 15 14 13 12 11 10 9 8 7 6 5 4 3 2 1

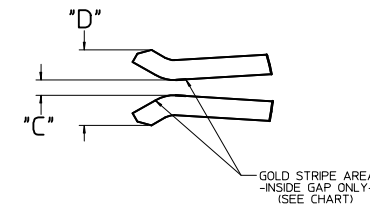
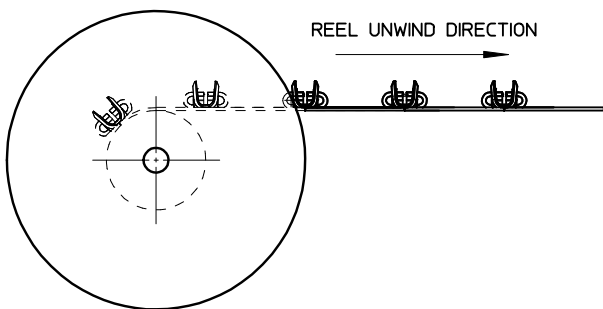
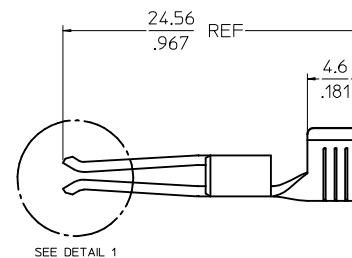
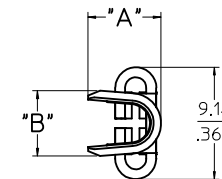
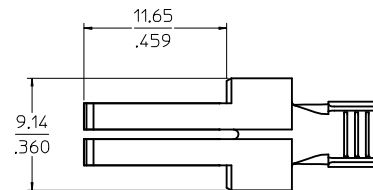
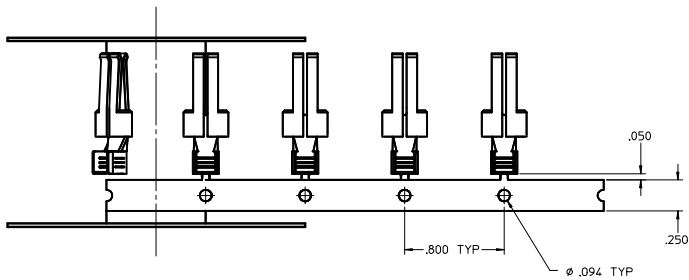

DETAIL 1
SCALE 10:1

SEE SHEET 1 IEC NO. UCP2016-1882 DRAWN: SCHAEFER 2015/07/22 CHKD: APPR: BPI/SZCZOR 2015/11/30	QUALITY SYMBOLS	GENERAL TOLERANCES (UNLESS SPECIFIED)	DIMENSION STYLE	SCALE	DESIGN UNITS	THIRD ANGLE PROJECTION	
	∇=0 ∇=0 ∇=0	4 PLACES ± .010 3 PLACES ± .010 2 PLACES ± 0.25 ± .010 1 PLACE ± 0.25 ± .010 ANGULAR ± 1/2°	MM/IN	5:1	INCH	DRAWN BY: BKOSTIC DATE: 2006/11/13 CHECKED BY: BKOSTIC DATE: 2006/11/13 APPROVED BY: APATEL DATE: 2006/11/14	TITLE: TERMINAL - RECEPTACLE POWER CONTACT MATERIAL NO. SEE CHART DOCUMENT NO. SD-44262-100
D0 SIZE D	DRAFT WHERE APPLICABLE MUST REMAIN WITHIN DIMENSIONS	THIS DRAWING CONTAINS INFORMATION THAT IS PROPRIETARY TO MOLEX INCORPORATED AND SHOULD NOT BE USED WITHOUT WRITTEN PERMISSION	MOLEX INCORPORATED				SHEET NO. 2 OF 2

19 18 17 16 15 14 13 12 11 10 9 8 7 6 5 4 3 2 1