

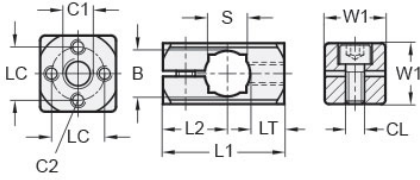

## MT15-CSBC-M8-A

Ruland Sensor Bracket Clamp Connector, Thru Hole 15mm, Thread M8, L 40mm, Aluminum



### Description

Ruland MT15-CSBC-M8-A is a sensor bracket clamp connector with a 15mm thru hole diameter, M8 center thread, M4 cross threads, 20mm width/height, and 40mm overall length. It is made with aluminum and has stainless steel cap screws. These clamp connectors are designed to fit with sensor brackets and mounting brackets with the same threading. Adjustable lever clamp kits with the same thread size can be attached to this clamp connector. The width/height of the bracket clamp must also be equal to the sleeve and stud length of the adjustable lever clamp kit. All bracket clamps from Ruland are RoHS3 and REACH compliant.

### Product Specifications

<b>Thru Hole Diameter B</b>	15 mm	<b>Thru Hole Tolerance</b>	+0.11/-0 mm
<b>Square Thru Hole S</b>	12 mm	<b>Center Thread C1</b>	M8
<b>Cross Thread C2</b>	M4 x 4	<b>Thread Depth LT</b>	12 mm
<b>Center To Center LC</b>	14 mm	<b>Edge To Center L2</b>	20.5 mm
<b>Width &amp; Height W1</b>	20 mm	<b>Overall Length L1</b>	40 mm
<b>Clamp Screw CL</b>	M6	<b>Weight (lbs)</b>	0.068300
<b>Material Specification</b>	Aluminum	<b>Manufacturer</b>	JW Winco/ Otto Ganter
<b>UPC</b>	634529245750	<b>Country of Origin</b>	Germany
<b>Tariff Code</b>	7609.00.0000	<b>UNSPC</b>	31162908