

PART NUMBER	CLASS 2r WIRE	CLASS 5f WIRE	WIRE STRIP LENGTH	PANDUIT DIE INDEX NO. FOR CLASS 2r WIRE CIRCUMFERENTIAL DIES	PANDUIT DIE INDEX NO. FOR CLASS 5f WIRE CIRCUMFERENTIAL DIES	PANDUIT DIE INDEX NO. FOR CLASS 5f WIRE NEST/INDENTOR DIES	l ± 2.76	o ± .50	i ± .50	a ± 2.25	m (ref)	c ± .50	e ± .50	n ± 2.25	d ± .50	b ± 2.25	t ± .70
LCMD6-5CD-Q	4-6mm ²	*4-6mm ²	11.0	P10	P10	---	52.5	5.50	3.80	9.5	7.8	22.00	25.00	6.2	5.50	10.5	1.20
LCMD10-6CD-Q	10mm ²	10mm ²	12.5	P21	---	---	55.8	6.20	4.50	11.0	9.8			6.0	6.60	11.5	1.20
LCMD16-6CD-Q	16mm ²	10mm ²	16.0	P21	P21	P29/1	59.5	7.20	5.50	14.5	10.3			6.5	6.60	13.5	1.30
LCMD25-8CD-Q	25mm ²	16mm ²	16.5	P29	P21	P29/1	62.0	8.80	6.90	15.0	10.0			8.0	9.00	16.0	1.50
LCMD35-8CD-Q	35mm ²	25mm ²	19.0	P29	P29	P42/2	67.0	10.40	8.20	17.5	12.3			8.5	9.00	16.0	2.00
**LCMD50-8CD-X	50mm ²	35mm ²	21.8	P37	P33	P50/2	71.5	12.30	9.80	20.3	11.5			10.0	9.00	18.5	2.30
LCMD50-10CD-X							71.5	12.30	9.80	20.3	11.5			10.0	11.00	18.5	2.30
LCMD70-10CD-X	70mm ²	50mm ²	24.8	P45	P37	P50/2	79.5	14.20	11.50	23.3	14.5			11.5	11.00	21.0	2.60
LCMD95-10CD-X	95mm ²	70mm ²	26.0	P54	P45	P62/4	85.5	16.50	13.50	24.5	15.0			13.5	11.00	25.0	2.80
LCMD120-10CD-X	120mm ²	95mm ²	26.0	P62	P50	P76/4	90.0	18.60	15.20	24.5	15.5			14.5	11.00	28.0	3.20
LCMD150-10CD-X	150mm ²	120mm ²	29.0	P66	---	P76/4	95.5	21.00	16.50	27.5	18.0			16.5	11.00	31.0	4.30
LCMD185-10CD-X	185mm ²	150mm ²	29.7	P76	---	P76/4	97.5	23.00	18.60	28.2	16.5			17.5	11.00	34.0	4.20
LCMD240-10CD-5	240mm ²	185mm ²	36.5	P87	---	P87/4	112.5	26.00	20.80	35.0	21.0			19.5	11.00	38.0	5.00
**LCMD300-10CD-5	300mm ²	240mm ²	41.8	P94	---	P106/6	119.5	29.00	23.50	40.3	22.0			20.0	11.00	43.0	5.30

* 4-6 mm² CLASS 5 ONLY.
 **cULus LISTED WIRE CONNECTOR

- NOTES:
1. Material: High conductivity seamless copper tube.
 2. Plating: Parts are annealed and tin plated.
 3. Wire Type: Class 2r/5f & 6f Stranded Copper per DIN VDE 0295, IEC 60228 and HD 383.
 4. UL Listed Wire Connector: Yes, for applications up to 35kv. Consult cable manufacturer for voltage stress relief instructions with applications greater than 2000 volts.
 5. UL Temperature Rating: 90° C
 6. C.S.A. Certified Wire Connector: Yes
 7. Parts are CE and tested per EN 61238-1:2003/IEC 61238-1:2003 Class B, with Class 2r wire 4mm² - 240mm².

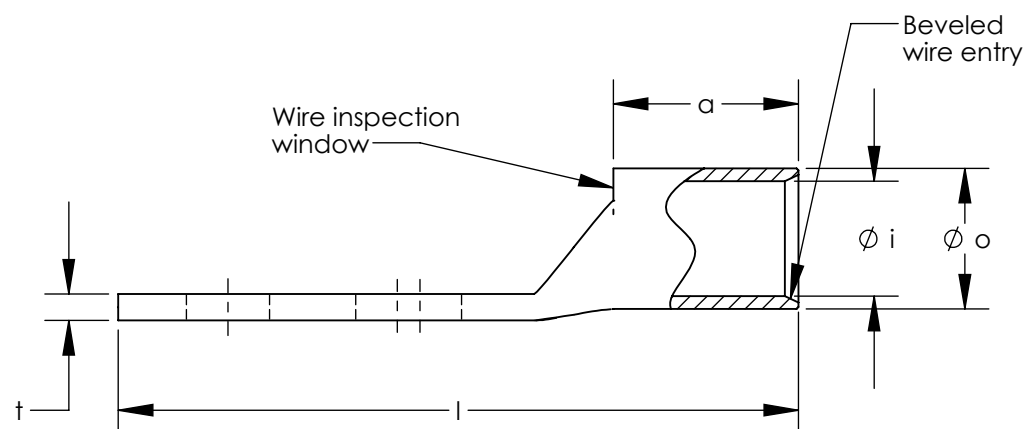
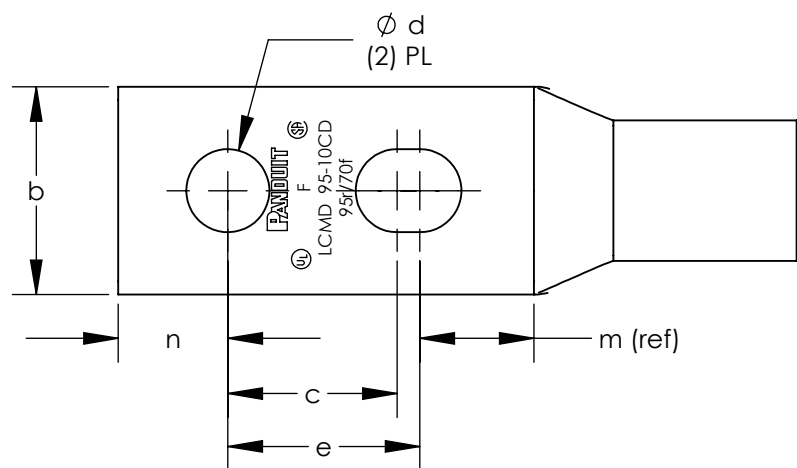

REV	DATE	BY	CHK	APR	DESCRIPTION	ECN
03	2/17	JHNU	TLCO	RGB	REVISED TONGUE WIDTH AND THICKNESS DIMENSIONS	13J059BC-JC
02	7/15	JHNU	TLCO	RGB	ADDED LCMD50-8CD-X, LCMD300-10CD-5	13J059BC-JC
01	6/14	JHNU	TLCO	RGB	REVISED I DIM: LCMD240-10CD WAS 111.5	13J059BC-JC
00	4/14	JHNU	TLCO	RGB	DRAWING RELEASED	

TITLE METRIC LUGS - LCMD SLOTTED SERIES 6-240mm STANDARD BARREL CUSTOMER DRAWING						
ITEM REVISION NAME 13J059BC/03						
DATASET FILE NAME 13J059BC-JC/03.SLDDRW						
UNLESS OTHERWISE SPECIFIED, DIMENSIONAL TOLERANCES ARE: IN [mm]						
.X ± .XXX ± .XX ± ANGLES ±						
THIRD ANGLE PROJECTION						
DRAWN BY: JHNU, DATE: 12/13, CHK: TLCO, SCALE: NONE						
MATERIAL: SEE NOTES						
DRAWING NUMBER: 13J059BC-JC						
SHEET 1 OF 1, SIZE: B						