

with prismatic window, technopolymer



**MATERIAL**

Polyamide based (PA) technopolymer, black colour, glossy finish.

**PRISMATIC WINDOW**

Transparent polyamide based (PA-T/AR) technopolymer. The window consists of a continuous series of prisms which provide a clear and immediate reading of the level of the oil contained in the reservoir.

**PACKING RING**

NBR synthetic rubber.

**MAXIMUM CONTINUOUS WORKING TEMPERATURE**

100°C at 3 bar pressure.

**NOTE**

For use with other fluids with special additives, please contact ELESA Sales Department.

**ACCESSORIES ON REQUEST**

Brass nut type GH. (see page 1746) for fitting to reservoirs with wall thickness smaller than 5 mm.

with prismatic window, high temperatures, technopolymer



**MATERIAL**

Polyamide based (PA) technopolymer, black colour, glossy finish.

**PRISMATIC WINDOW**

Transparent sulphonic based technopolymer. The window consists of a continuous series of prisms which provide a clear and immediate reading of the level of the oil contained in the reservoir.

**PACKING RING**

FKM type VITON®.

**MAXIMUM CONTINUOUS WORKING TEMPERATURE**

140°C at 7 bar pressure.

**NOTE**

For use with other fluids with special additives, please contact ELESA Sales Department.

**ACCESSORIES ON REQUEST**

Brass nut type GH. (see page 1746) for fitting to reservoirs with wall thickness smaller than 5 mm.

\* Registered trademark by DuPont Dow Elastomers.



ELESA Original design



ELESA Original design

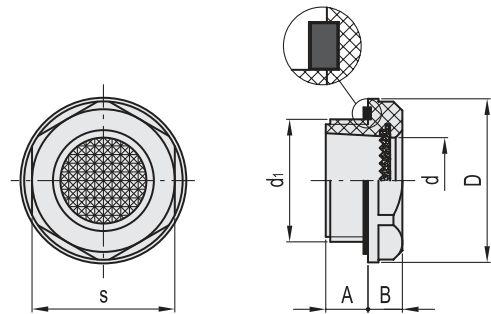
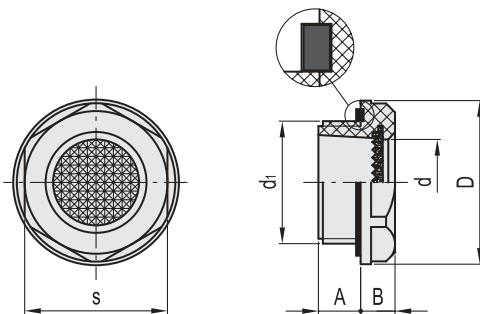

**BSP**

**METRIC**

Code	Description	d1	A	B	D	d	s	Tightening torque [Nm]	⚖️
14462	HGFT.13/PR-1/2-C9	G 1/2	10	8.5	28	14.5	24	6+8	5
14482	HGFT.16/PR-3/4-C9	G 3/4	9.5	8.5	35	18	32	8+10	9
14522	HGFT.21/PR-1-C9	G 1	11	9.5	42.5	23	38	10+12	14
14542	HGFT.25/PR-1¼-C9	G1 1/4	11	9	50	30	46	12+15	30

**BSP**

**METRIC**

Code	Description	d1	A	B	D	d	s	Tightening torque [Nm]	⚖️
14463-R	HGFT.13/HT-PR-1/2	G 1/2	10	8.5	28	14.5	24	6+8	5
14483-R	HGFT.16/HT-PR-3/4	G 3/4	9.5	8.5	35	18	32	8+10	9
14523-R	HGFT.21/HT-PR-1	G 1	11	9.5	42.5	23	38	10+12	14

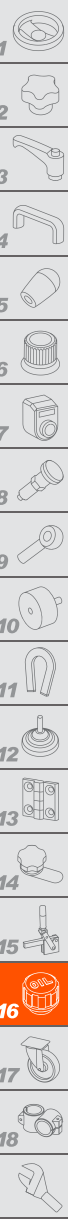

Accessories for hydraulic systems