

THIS IS A CONTROLLED DOCUMENT.

NO. 687917-2

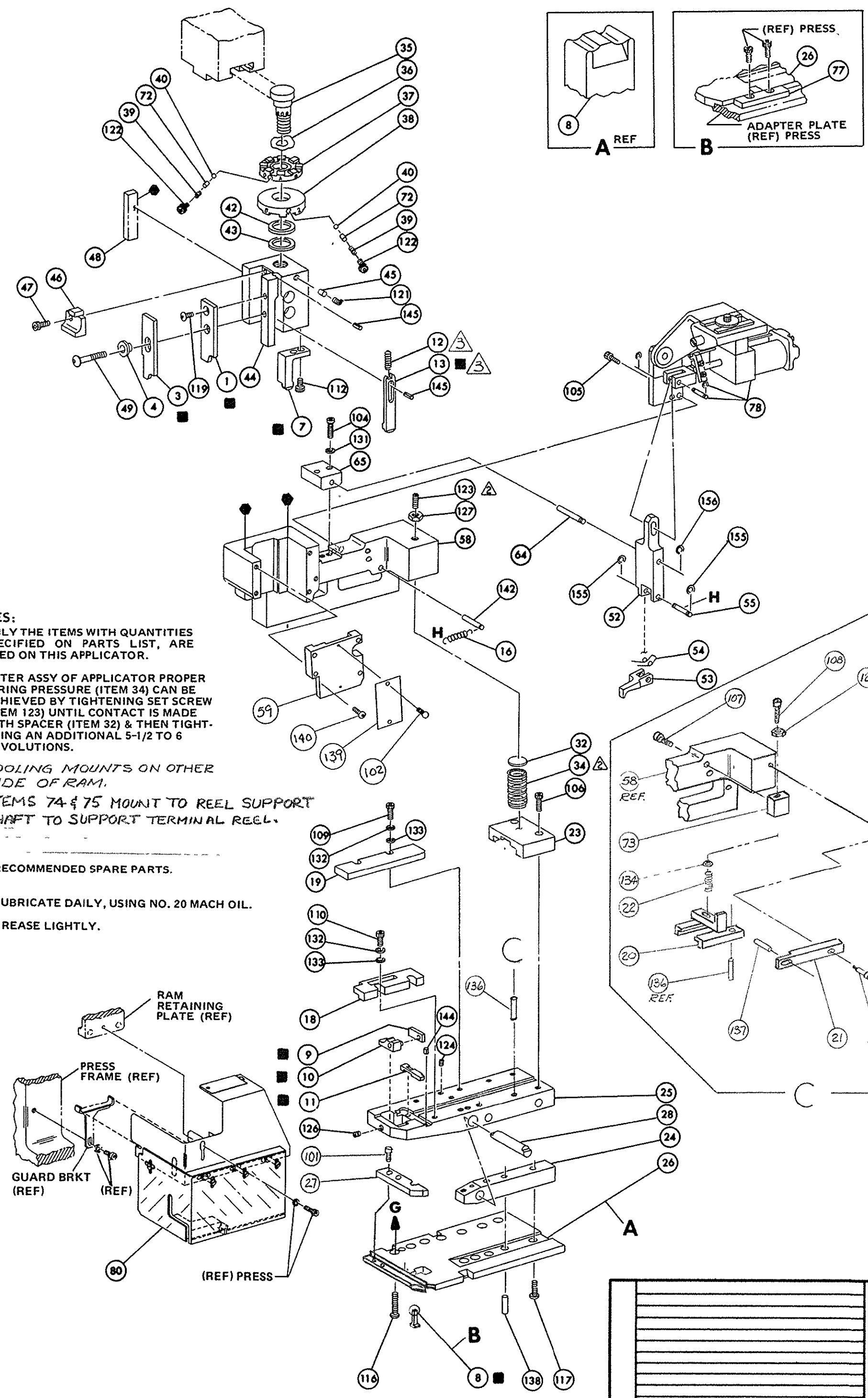

- NOTES:**
- ONLY THE ITEMS WITH QUANTITIES SPECIFIED ON PARTS LIST, ARE USED ON THIS APPLICATOR.
  - AFTER ASSY OF APPLICATOR PROPER SPRING PRESSURE (ITEM 34) CAN BE ACHIEVED BY TIGHTENING SET SCREW (ITEM 123) UNTIL CONTACT IS MADE WITH SPACER (ITEM 32) & THEN TIGHTENING AN ADDITIONAL 5-1/2 TO 6 REVOLUTIONS.
  - TOOLING MOUNTS ON OTHER SIDE OF RAM.
  - ITEMS 74 & 75 MOUNT TO REEL SUPPORT SHAFT TO SUPPORT TERMINAL REEL.
- KEY:**
- - RECOMMENDED SPARE PARTS.
  - ▼ - LUBRICATE DAILY, USING NO. 20 MACH OIL.
  - - GREASE LIGHTLY.

REQ.	PART NO.	DESCRIPTION	NO.	REQ.	PART NO.	DESCRIPTION	NO.
1	21986-2	RING RET "E" (3/16 DIA) PIVOT ARM	156	1	456987-1	BLOCK, PIVOT	65
2	21045-3	RING RET "C" (3/16 DIA) FEED PIN	155	1	457058-1	PIN, PIVOT	64
			154				63
			153				62
			152				61
			151				60
			150	1	455164-1	CAP, HOUSING	59
			149	1	458972-1	HOUSING	58
			148				57
			147				56
2	4- 21028-9	PIN SLOT SPG (1/8 DIA X .38) RAM	146	1	240624-1	PIN, FEED FINGER	55
1	3- 21028-2	PIN, SLOT SPG (3/32 DIA X .25) REAR SHEAR PL	145	1	691499-1	SPRING, FEED FINGER	54
			144	1	690584-5	FINGER, FEED	53
			143	1	457057-1	ARM, PIVOT	52
1	3- 22183-7	PIN, GROVE (.187 DIA X .88) FD RETURN SPG	142				51
			141				50
2	21017-2	SCR, DRIVE (#2 X .19)	140	1	3-21002-5	BOLT, CRIMPER	49
1	461264-4	PLATE, ID	139				48
1	21029-5	PIN, SLOTTED (3/16 DIA X .75) BASE PLATE	138	1	22353-8	SCREW, SHOULDER	47
1	21029-1	PIN, SLOT SPG (.187 DIA. X .50 LG.) DRAG	137	1	690578-2	BLOCK, INSUL ADJUSTMENT	46
2	1-21030-6	PIN, DOWEL (.187 DIA. X 1.25 LG.) DRAG	136	1	690191-1	PLUG, NYLON	45
			135	1	459732-1	RAM	44
1	21899-1	WASHER, FLAT (NO. 6) DRAG	134	1	690125-1	WASHER, LAMINATED	43
4	1- 21899-3	WASHER, FLAT (NO. 8) DRAG STUD & STR GDS	133	1	1-690124-1	WASHER, RAM	42
4	21024-4	WASHER, LOCK (No. 8) STRIP GUIDE	132				41
2	21024-5	WASHER, LOCK (No. 10) PIVOT BLOCK	131	2	23241-6	BALL, STEEL	40
			130	2	690170-1	SPRING, DISC.	39
2	21022-2	NUT, HEX (SLF LKG) (8-32) DRAG STUD	129	1	690142-1	DISC., INSULATION	38
1	21018-7	NUT, HEX MACH. (#10) DRAG	128	1	8-690141-1	DISC. WIRE	37
1	1- 22202-7	NUT, HEX MACH (5/16-24) SPRING HOUSING	127	1	22480-5	WASHER, SPRING	36
			126	1	690212-1	POST, RAM	35
1	21061-9	SCREW, SKT SET (8-32 X .25) ANVIL INSERT	125	1	3- 23846-5	SPRING, HINGE BAR	34
2	3- 21012-1	SCREW, SKT SET (6-32 X .38) DRAG	124				33
2	4- 21006-0	SCREW, SKT SET (8-32 X .25) HINGE PIN	123	1	690573-1	SPACER, SPRING	32
1	8- 21007-5	SCREW, SKT SET (5/16-24 X .75) SPRING HOUSING	122				31
2	23030-1	SCREW, SKT HD CAP (6-32 X .25) C.P. DISC.	121	2	22354-8	STUD, DRAG	30
1	21009-2	SCREW, SKT SET (1/4-20 X .25) C.P. RAM	120				29
1	2- 21002-1	SCREW, BTN HD SKT CAP (8-32 X .38) CRIMPER	119	1	690582-1	PIN, HINGE	28
			118	1	463874-1	ANVIL RETAINING	27
3	3- 21002-4	SCREW, BTN HD SKT CAP (1/4-20 X .62) BLK STAB	117	1	463873-1	PLATE, BASE	26
4	2-22733-2	SCREW, BTN HD SKT CAP (1/4-20 X .62) HOUSING	116	1	691535-2	BAR, HINGE	25
			115	1	690571-1	BLOCK, STABILIZER	24
			114	1	814222-1	BLOCK, PRESSURE	23
2	23030-3	SCREW, SKT HD CAP (6-32 X .50) NYLOK, SL BLADE	113	1	7-22282-5	SPRING, DRAG	22
1	1-22353-9	SCREW, SHLD. SLT. HD. (.250 DIA. X .250 LG.) DRAG	112	1	458960-1	LEVER, DRAG	21
2	2- 21000-7	SCREW, SKT HD CAP (8-32 X .50) FR STRIP GUIDE	111	1	458960-1	DRAG, STOCK	20
2	2- 21000-8	SCREW, SKT HD CAP (8-32 X .62) REAR STRIP GD	110	1	691530-4	GUIDE, STRIP, REAR	19
1	3-21000-9	SCREW, SKT, HD, CAP (10-32 X 1.00 LG.) DRAG	109	1	691529-2	GUIDE, STRIP, FRONT	18
2	4-21000-0	SCREW, SKT, HD, CAP (10-32 X 1.25 LG.) DRAG	108				17
4	2- 21000-9	SCREW, SKT HD CAP (8-32 X .75) PRESS BLOCK	107	1	2- 22287-5	SPRING, FEED RETURN	16
2	21001-3	SCREW, SKT HD CAP (1/4-20 X .62) AIR FD ASSY	106				15
2	3- 21000-8	SCREW, SKT HD CAP (10-32 X .88) PIVOT BLOCK	105				14
4	3- 21000-8	SCREW, SKT HD CAP (10-32 X .88) HSG CAP	104	1	692134-5	POSITIONER, TERMINAL	13
2	7-21000-6	SCR, SHC (10-32 X .31) ANVIL RETAINING	103	1	5- 22280-5	SPRING, TERM. POSITIONER	12
1	457244-2	GUARD ASSEMBLY	102	1	691525-5	PLATE, REAR SHEAR	11
			101	1	459730-1	INSERT, ANVIL	10
1	457098-1	AIR FEED ASSEMBLY	80	1	690569-9	PLATE, FRONT SHEAR	9
1	694427-1	PLATE, APPLICATOR, MOUNTING	79	1	691523-3	ANVIL	8
			78	1	691532-5	BLADE, SLUG	7
			77				6
			76			PLATE, ANVIL MOUNTING	5
2	21001-6	SCR, SHC (1/4-20 X 1.00)	75	1	690574-1	SPACER TUBULAR, INSUL CRIMPER	4
1	682131-1	WASHER, BEVELED	74	1	459728-1	CRIMPER, INSULATION	3
1	458969-1	SPRING, RET. DRAG	73				2
2	690603-1	SPRING, ASSIST	72	1	459731-1	CRIMPER, WIRE	1

CRIMPING DATA				THIS APPLICATOR WILL APPLY	
PAD LETTER	CRIMP HEIGHT	WIRE SIZE	WIRE STRIP LENGTH	60274	
A	.072	12			
B	.062	14			
C	.056	16			
D	.052	18			
CRIMP SIZE	TYPE	FEED	PRESS (REF)		
160	TAB LOK	.770	565435-5		
INSULATION RANGE	WIRE RANGE	APPLICATOR INSTRUCTION	A18037		
.110-.210	18-12	AMP-O-LECTRIC® PRESS (AIR FEED)			
REMARKS: TERM APPL SPEC 114-2078					
SET UP GAGE	LAYOUT NO.	667			
DRAWN	APPROVED	AMP INCORPORATED HARRISBURG, PENNA.			
5. Hoover	Ken Hantz	LOC	NO.	687917-2	
CHECKED	REL.	A	C		
10/11/77	9/6/78				
APPLICATOR, MINIATURE QUICK CHANGE HINGE BAR, E.F. (TAB-LOK, LEFT HAND)					
1250 FLAG FASTON					

REVISION RECORD	REVISION RECORD
N ECR-06-002442	WY/AL-02
M 0150-6960-96	02-17-96
L 0150-6866-96	03-28-96
K ECR A-400092	04-05-96
J ECR A-304791	04-18-96
H ECR A1708R	04-25-96
G REV PER ECR R-5616	05-01-96
F REV PER ECR	05-01-96
E REV PER ECR	05-01-96
D REV ITEM #1	05-01-96
C REVISED PER ECR	05-01-96
B REV PER ECR	05-01-96
A REV PER ECR	05-01-96
01 REV PER ECR	05-01-96