

LOCATOR/HOLDDOWN VARIATIONS

STYLE 1

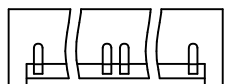

STYLE 5

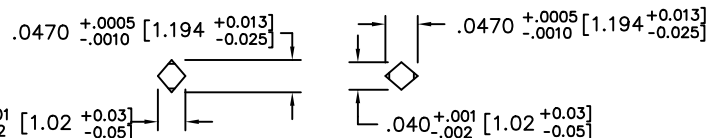
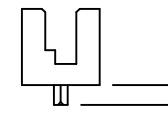
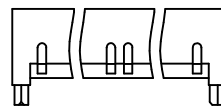

STYLE 2

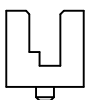
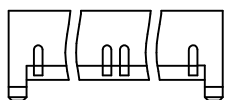

STYLE 6
SEE NOTE 9

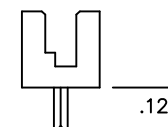
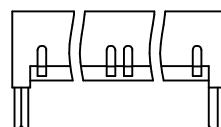

$\phi .0520$ [1.321]
 $\phi .040$ [1.02]
 $\phi .040 \pm .001$ [1.02 $\pm .03$] (ALL PEG CONFIGURATIONS)

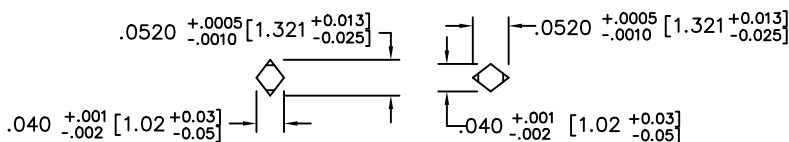

STYLE 3

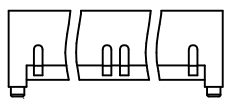

STYLE 7

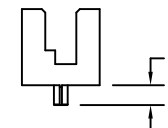
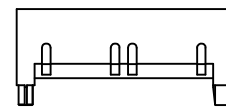

$R.0050$ [0.127]
 $\phi .0394$ [1.000]
 $.028$ [0.71]
 $.024$ [0.61]

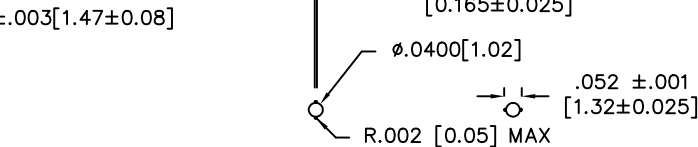

STYLE 4

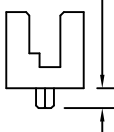
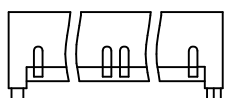

$\phi .034 \pm .001$ [0.86 ± 0.03]
 $\phi .0520 \pm .0005$ [1.321 ± 0.013]
 $\phi .030$ [0.076]
 $\phi .040 \pm .001$ [1.02 ± 0.03]
 $\phi .008 \pm .003$ [0.20 ± 0.08]
 $\phi .008$ [0.20] X 45°

mat'l. code		surface		tolerance		projection		product family	
-		ISO 1302		ISO 406		INCH/MM		RIBCAGE	
itr		ecn no		dr		date		title	
AH								RIBCAGE III SMT VERT. HEADER ASS'Y	
				angles		linear		scale 3:1	
				±2°		.xx±.01/0.3		dwg no	
						.xxx±.005/0.13		sheet 3 of 8	
				dr		ARTHUR.ZHAO 12/17/19		size	
				enrg		ARTHUR.ZHAO 12/17/19		A3	
				chr		LQ.LEI 12/17/19		95781	
				appd		TIM.YAO 12/17/19		type	
								Product Customer Drawing	
sheet index		revision sheet							

SIZE	DIM H	DIM J	DIM K	DIM L
2X5	.275/6.99	.200/5.08	.372/9.45	.320/8.13
2X10	.525/13.34	.450/11.43	.622/15.80	.570/14.48
2X15	.775/19.68	.700/17.78	.872/22.15	.820/20.83
2X20	1.025/26.03	.950/24.13	1.122/28.50	1.070/27.18
2X25	1.275/32.38	1.200/30.48	1.372/34.85	1.320/33.53
2X30	1.525/38.74	1.450/36.83	1.622/41.20	1.570/39.88
2X35	1.775/45.08	1.700/43.18	1.872/47.55	1.820/46.23
2X40	2.025/51.43	1.950/49.53	2.122/53.90	2.070/52.58
2X45	2.275/57.78	2.200/55.88	2.372/60.25	2.320/58.93
2X50	2.525/64.14	2.450/62.23	2.622/66.60	2.570/65.28

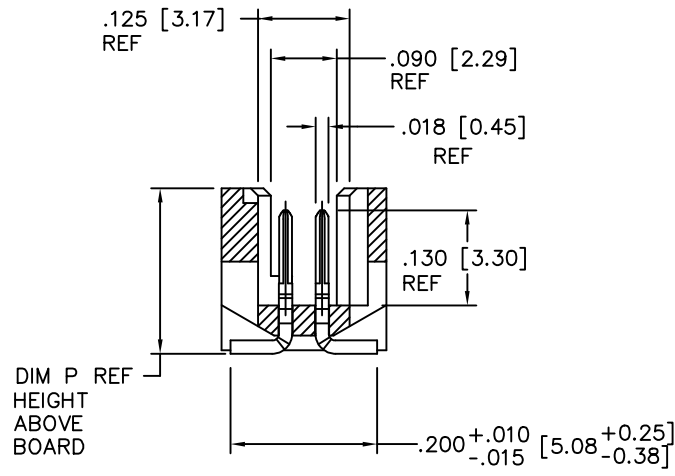

SECTION X-X
ROTATED 90° CW

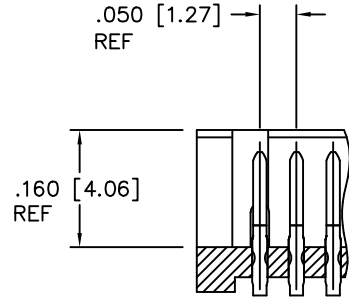

SECTION Y-Y

mat'l. code		surface		tolerance		projection		product family		
-		ISO 1302 ✓		ISO 406 ISO 1101				RIBCAGE		
ltr	ecn no	dr	date	tolerances unless otherwise specified		INCH/MM		title		
AH				angles	linear	.XX±.01/0.3 .XXX±.005/0.13 .XXXX±.0020/0.051		RIBCAGE III SMT VERT. HEADER ASS'Y		
				±2'		scale 3:1		dwg no sheet 2 of 8 size		
				dr	ARTHUR.ZHAO	12/17/19			95781 A3	
				enr	ARTHUR.ZHAO	12/17/19				
				chr	LQ.LEI	12/17/19				
				appd	TIM.YAO	12/17/19				
sheet index	revision sheet							type Product Customer Drawing		

RECOMMENDED PCB MOUNTING PAD PATTERN

STYLE 1

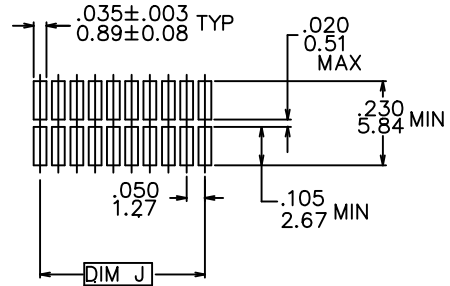

STYLE 5

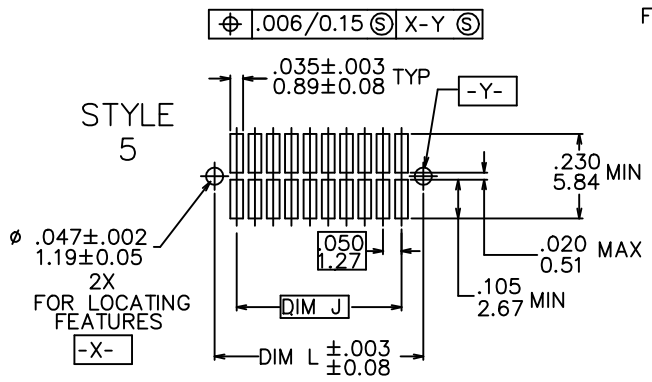

STYLE 4

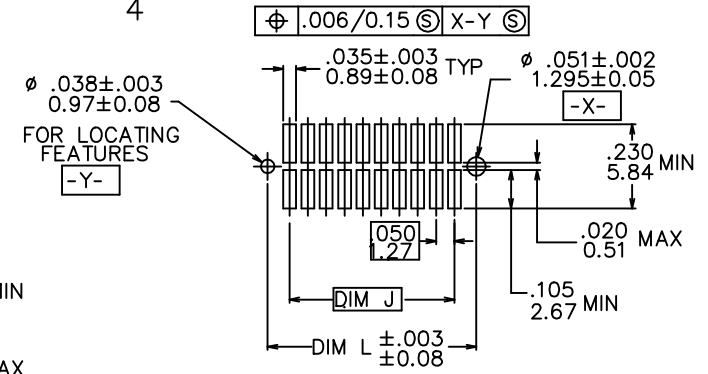

STYLE 2

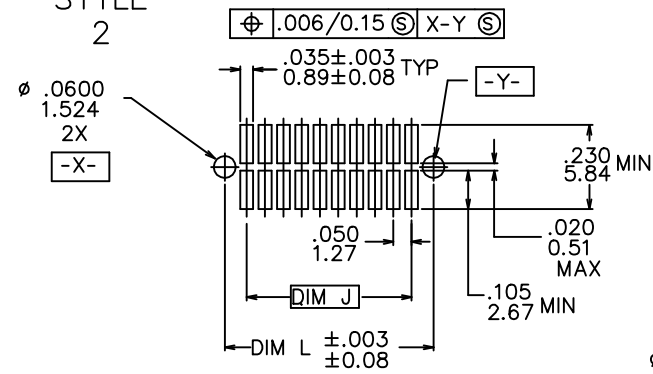

STYLE 7

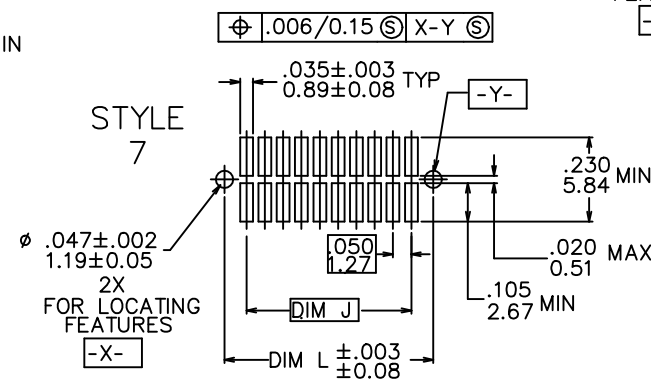

STYLE 6

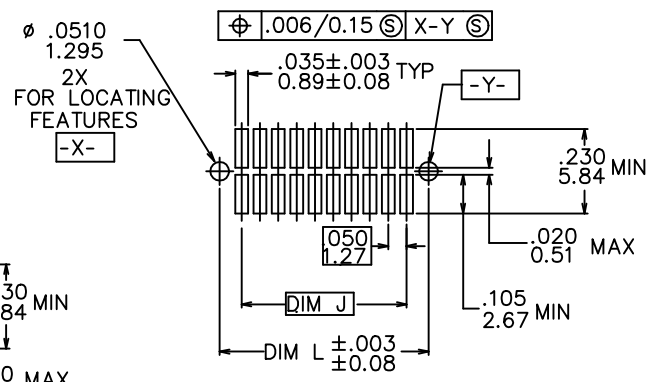

STYLE 3

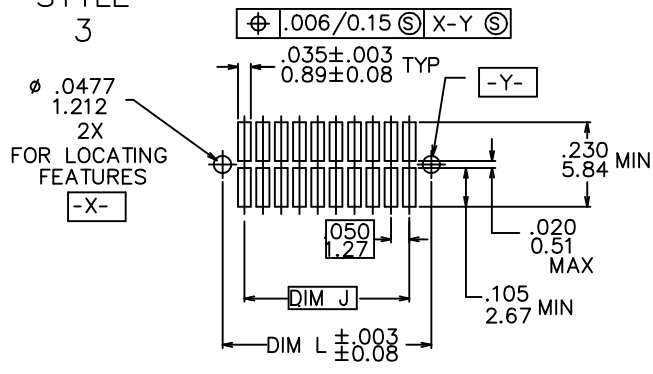

mat'l. code		surface		tolerance		projection		product family	
-		ISO 1302 ✓		ISO 406 ISO 1101				RIBCAGE	
ltr		ecn no		date		tolerances unless otherwise specified		title	
AH						.xx±.01/0.3 .xxx±.005/0.13 .xxx±.0020/0.051		RIBCAGE III SMT VERT. HEADER ASS'Y	
						linear ±2'		INCH/MM scale 3:1	
		dr		ARTHUR.ZHAO 12/17/19				dwg no	
		enrg		ARTHUR.ZHAO 12/17/19				sheet 4 of 8	
		chr		LQ.LEO 12/17/19				size	
		appd		TIM.YAO 12/17/19				95781 A3	
sheet index		revision sheet						type Product Customer Drawing	

PRODUCT NUMBER NOTE 1,4A & 4B	DIM P HEIGHT ABOVE BOARD (REF.)	HOLDDOWN STYLE
72428-1XX	.244/6.20	1
73546-1XX	.364/9.25	1
73547-1XX	.364/9.25	2
73548-1XX	.364/9.25	4
84700-1XX	.226/5.74	7
84701-1XX	.298/7.57	7
84734-1XX	.364/9.25	7
87401-1XX	.226/5.74	6
87409-1XX	.226/5.74	2
87849-1XX	.226/5.74	1
88566-1XX	.260/6.60	2
90098-1XX	.298/7.57	2
90863-1XX	.226/5.74	1
91036-1XX	.364/9.25	5
91423-1XX	.226/5.74	2
91855-1XX	.226/5.74	5
92099-1XX	.226/5.74	4
92412-1XX	.298/7.57	4
93206-1XX	.226/5.74	3
93221-1XX	.298/7.57	1
93289-1XX	.298/7.57	5
87409-2XX	.226/5.74	2

OBSOLETE

OBSOLETE

OBSOLETE

OBSOLETE

SEE NOTE 10

* OBSOLETE

OBSOLETE

OBSOLETE

OBSOLETE

A

A

B

B

C

C

Copyright FCI

D

D

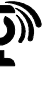

FCIconnect.com



form: A3

TABLE A

CUSTOMER SPECIAL

mat'l. code		surface		tolerance		projection		product family	
-		ISO 1302 ✓		ISO 406		ISO 1101		RIBCAGE	
ltr	ecn no	dr	date	tolerances unless otherwise specified			title		
AH				angles	linear	.XX±.01/0.3	INCH/MM		RIBCAGE III SMT
				±2'		.XXX±.005/0.13	scale 3:1		VERT. HEADER ASS'Y
						.XXX±.0020/0.051			sheet 5 of 8
		dr	ARTHUR.ZHAO	12/17/19			FCI		size A3
		enrg	ARTHUR.ZHAO	12/17/19					95781
		chr	LQ.LEI	12/17/19					type Product Customer Drawing
		appd	TIM.YAO	12/17/19					
sheet index	revision sheet								

PRODUCT NUMBER NOTE 11,4C	QTY. REEL	TAPE WIDTH PITCH MM	CONNECTOR ORIENTATION IN TAPE POCKET
72428-120TR	500	44/12	VIEW 1
73546-105TR		24/12	
73546-110TR		32/12	
73546-115TR		44/12	
73546-120TR		44/12	
73546-125TR		56/12	
73546-130TR		56/12	
73546-135TR		72/12	
73546-140TR		72/12	
73546-145TR		72/12	
73546-150TR		88/12	
73547-105TR		24/12	
73547-110TR		32/12	
73547-115TR		44/12	
73547-120TR		44/12	
73547-125TR		56/12	
73547-130TR		56/12	
73547-135TR		72/12	
73547-140TR		72/12	
73547-145TR		72/12	
73547-150TR	500	88/12	
84700-105TR	400	24/12	
84700-135TR	500	72/12	
87409-105TR		24/12	
87409-110TR		24/12	
87409-115TR		44/12	
87409-120TR		44/12	
87409-125TR		56/12	
87409-130TR		56/12	
87409-210TR	500	24/12	VIEW 1

TABLE C

OBSOLETE

OBSOLETE
OBSOLETE

REFERENCE ONLY :
TAPE WIDTH 32mm AND ABOVE HAS BOTH FEED TRACKS,
BELOW 32mm HAS TOP FEED TRACK ONLY.

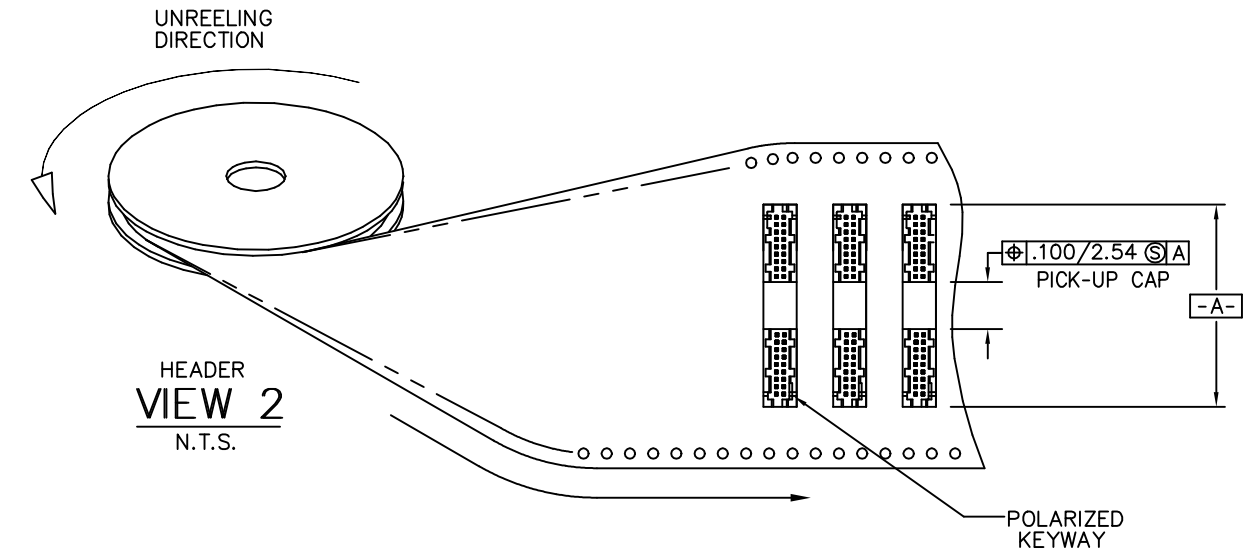
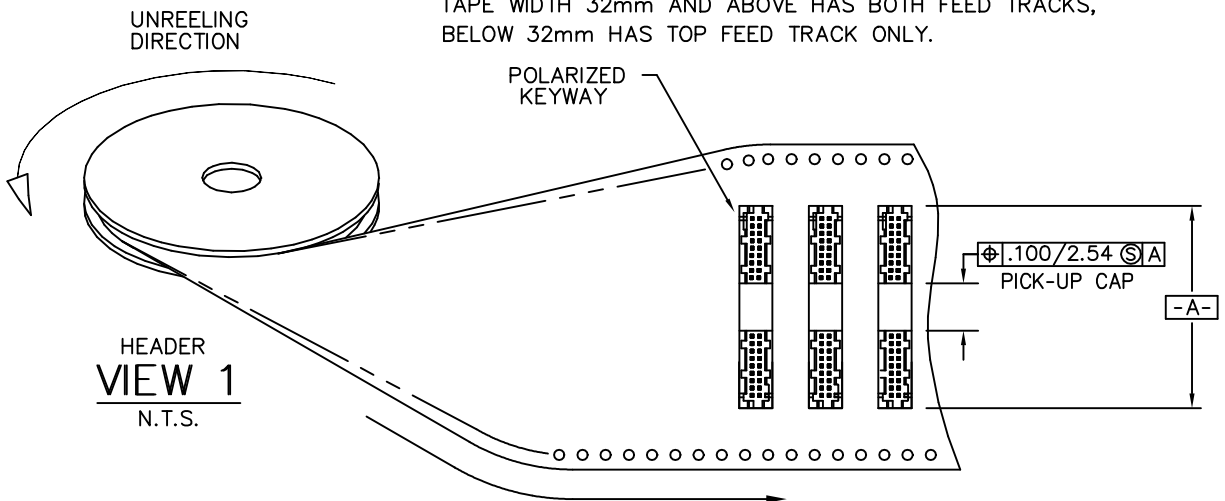

mat'l. code		surface		tolerance		projection		product family	
-		ISO 1302		ISO 406		ISO 1101		RIBCAGE	
ltr	ecn no	dr	date	tolerances unless otherwise specified		INCH/MM		title	
AH				angles	linear	.XX±.01/0.3		RIBCAGE III SMT	
				±2'		.XXX±.005/0.13		VERT. HEADER ASS'Y	
						.XXX±.0020/0.051		dwg no	
		dr	ARTHUR.ZHAO	12/17/19		scale 3:1		sheet 6 of 8	
		enr	ARTHUR.ZHAO	12/17/19		FCI		size	
		chr	LQ.LEI	12/17/19				95781	
		appd	TIM.YAO	12/17/19				A3	
sheet index		revision sheet						type Product Customer Drawing	

1

2 3

4

5

6

PRODUCT NUMBER NOTE 11,4C	QTY. REEL	TAPE WIDTH PITCH MM	CONNECTOR ORIENTATION IN TAPE POCKET
87409-135TR	500	72/12	VIEW 1
87409-140TR	↑	72/12	↑
87409-145TR	↑	72/12	
87409-150TR	↑	88/12	
87849-105TR	↑	24/12	
87849-110TR	↑	24/12	
87849-115TR	↑	44/12	
87849-120TR	↑	44/12	
87849-125TR	↑	56/12	
87849-130TR	↑	56/12	
87849-135TR	↑	72/12	
87849-140TR	↑	72/12	
87849-145TR	↑	72/12	
87849-150TR	↑	88/12	
88566-110TR	↑	24/12	
88566-115TR	↑	44/12	
88566-130TR	500	56/12	
90098-105TR	400	24/12	
90098-110TR	400	32/12	
90098-115TR	500	44/12	
90098-120TR	500	44/12	
90098-125TR	400	56/12	
90098-130TR	500	56/12	
90098-135TR	↑	72/12	
90098-140TR	↑	72/12	
90098-145TR	↑	72/12	
90098-150TR	↑	88/12	
90863-110	↑	24/12	↑
90863-115	500	44/12	VIEW 1

TABLE C

A

B

C

D

A

B

C

D



Copyright FCI

mat'l. code		surface		tolerance		projection		product family	
-		ISO 1302 ✓		ISO 406 ISO 1101				RIBCAGE	
ltr	ecn no	dr	date	tolerances unless otherwise specified				title	
AH				angles	linear	.XX±.01/0.3 .XXX±.005/0.13 .XXXX±.0020/0.051		RIBCAGE III SMT VERT. HEADER ASS'Y	
				±2'		INCH/MM		scale 3:1	
		dr	ARTHUR.ZHAO	12/17/19				dwg no	
		enrg	ARTHUR.ZHAO	LQ.LEI	sheet 7 of 8 size				
		chr	LQ.LEI	12/17/19	95781 A3				
		appd	TIM.YAO	12/17/19	type		Product Customer Drawing		
sheet index	revision sheet								

PRODUCT NUMBER NOTE 11,4C	QTY. REEL	TAPE WIDTH PITCH MM	CONNECTOR ORIENTATION IN TAPE POCKET
90863-115REV	500	44/12	VIEW 2
90863-120	↑	44/12	VIEW 1
90863-125	↑	56/12	↑
90863-130	↑	56/12	↑
91036-110P	↓	24/16	↓
93206-110TR	↓	24/12	↓
93206-115TR	500	44/12	↓
93221-105TR	400	24/12	↓
93221-110TR	400	32/12	↓
93221-115TR	500	44/12	↓
93221-120TR	500	44/12	↓
93221-125TR	400	56/12	↓
93221-130TR	500	56/12	↓
93221-135TR	↑	72/12	↓
93221-140TR	↑	72/12	↓
93221-145TR	↓	72/12	↓
93221-150TR	500	88/12	VIEW 1

NOTES:

① XXXXX-XXXLF



2. NUMBER OF POSITIONS = 05 THRU 50 IN 5 POS INCREMENTS.
(EXAMPLE : 05=10 POS., 10=20 POS. ETC.)

③ REQUIRED ON -X40,-X45 & -X50 POSITION PARTS ONLY.

④ PACKAGING :

A. ANTISTATIC TUBES. SEE TABLE A
B. ADD "CT" TO END OF DASH NUMBER FOR CONNECTOR WITH VACUUM CAP IN ANTISTATIC TUBES.
EX. : XXXXX-1XXCT

C. PRESSURE SEALED TAPE AND REEL. SEE TABLE C FOR AVAILABLE PART NUMBERS.

5. HOUSING MATERIAL :
GLASS FILLED THERMOPLASTIC FLAME RETARDANT PER UL 94V-0.
COLOR : NATURAL/BLACK

6. TERMINAL PLATING :
30u"/.76u HARD GOLD OR GXT OVER 50u"/1.27u NI ON CONTACT ZONES.
100u"/2.54u PURE TIN OVER 50u"/1.27u Ni IN SOLDERING ZONES.

⑦ MOLDING FLOW RESTRICTOR QUANTITY AND LOCATION IS MANUFACTURING OPTION.

⑧ VACUUM CAP SLOT REQUIRED ON ALL SIZES, SLOT MAY BE LOCATED ON OPPOSITE SIDE FOR 2 X 5.

⑨ STYLE 6 IS NOT AVAILABLE IN TAPE AND REEL.

⑩ 90863-1XX IS PACKAGED ONLY IN TAPE AND REEL.

⑪ ADD LF SUFFIX AT THE END OF PART NUMBER FOR LEAD FREE OPTION.

12. THE HOUSING WILL WITHSTAND EXPOSURE TO 260°C PEAK TEMPERATURE FOR 20 SECONDS IN A CONVECTION, INFRA-RED OR VAPOR PHASE REFLOW OVEN. SEE APPLICATION NOTE/PROCEDURES IF THEY ARE AVAILABLE.

13. THIS PRODUCT MEETS EUROPEAN UNION DIRECTIVES AND OTHER COUNTRY REGULATION AS DESCRIBED IN GS-22-008.

14. PRODUCT SPECIFICATION SEE BUS-12-087.

TABLE C

mat'l. code		surface		tolerance		projection		product family	
-		ISO 1302 ✓		ISO 406		ISO 1101		RIBCAGE	
ltr	ecn no	dr	date	tolerances unless otherwise specified		INCH/MM		title	
AH				angles	linear	.XX±.01/0.3		RIBCAGE III SMT	
				±2'		.XXX±.005/0.13		VERT. HEADER ASS'Y	
						.XXX±.0020/0.051		scale 3:1	
		dr	ARTHUR.ZHAO	12/17/19			FCI		dwg no
		enrg	ARTHUR.ZHAO	12/17/19					sheet 8 of 8
		chr	LQ.LEI	12/17/19					size
		appd	TIM.YAO	12/17/19					A3
sheet index		revision sheet						type Product Customer Drawing	