

**Insertion and
Extractor Tool
(HTA60615)**

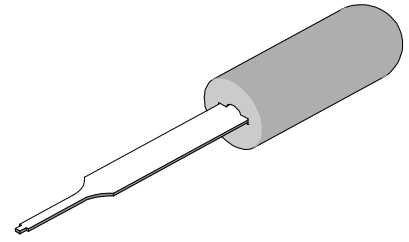

**Application Tooling
Specification Sheet**



Order No. 11-02-0022

FEATURES

- This tool is designed to insert series 70021, 70028, 70058, 70110, and 71851 terminals into crimp housings (Series 70066 and 70107)
- This tool is designed to extract series 91821 terminals from crimp housings (Series 91935)

SCOPE

Products: 2.54mm (.100") Pitch SL™ and Picoflex® Discrete Wire Crimp Terminals.

Terminal Series No.	Terminal Order No.							
	56134-8000	56134-8100	56134-9000	56134-9100				
56134	56134-8000	56134-8100	56134-9000	56134-9100				
70021	16-02-0077	16-02-0078	16-02-0079	16-02-0080	16-02-0081	16-02-0091	16-02-0092	16-02-0093
	16-02-0105	16-02-0106	16-02-0107	16-02-0108	16-02-0109	16-02-0110	16-02-0111	16-02-0112
	16-02-0113	16-02-0114	16-02-0115	16-02-0116	16-02-0117	70021-0081	70021-0114	70021-0117
	40-08-0871	40-08-0872	40-08-0873	40-08-0874				
70028	40-08-4832	40-08-4833	40-08-4834	40-08-4860	40-12-4831	40-12-4832	40-12-4833	40-12-4834
	40-12-4835	40-12-4836	40-12-4943	40-12-4944	70028-0005			
70058	16-02-0069	16-02-0074	16-02-0082	16-02-0083	16-02-0084	16-02-0085	16-02-0086	16-02-0087
	16-02-0088	16-02-0096	16-02-0097	16-02-0098	16-02-0099	16-02-0100	16-02-0101	16-02-0102
	16-02-0103	16-02-0104	16-02-0131	16-02-0135	16-02-0137	16-02-0139	16-02-0140	16-02-0143
	16-02-0144	16-02-0147	16-02-0150	16-02-0151	16-02-0152			
	70058-0069	70058-0082	70058-0083	70058-0084	70058-0086	70058-0087	70058-0088	70058-0096
	70058-0097	70058-0099	70058-0102	70058-0103	70058-0104	70058-4069	70058-4084	70058-4086
	70058-4096	70058-4099	70058-4102	70058-5001				
70110	40-07-4826	40-07-4827	40-07-4828	40-07-4829	40-08-0827	40-08-4827	40-08-4828	40-08-4829
	40-08-4877	40-08-4878	40-12-4827	40-12-4828	40-12-4829	40-12-4847	40-12-4848	40-12-4849
	40-12-4907	40-12-4908						
71851	16-02-0119	16-02-1109	16-02-1110	16-02-1111	16-02-1112	16-02-1113	16-02-1114	16-02-1115
	16-02-1116	16-02-1117	16-02-1118	16-02-1119	16-02-1120	16-02-1121	16-02-1122	16-02-1123
	16-02-1124	16-02-1125						
	71851-0119	71851-1110	71851-1112	71851-1114	71851-1115	71851-1116	71851-1118	71851-1119
	71851-4110	71851-4112	71851-4114	71851-4116	71851-4118	71851-4119	71851-8022	
91821	91821-0001	91821-0003						

OPERATION:

For Insertion of 56134 Terminal Series:

Individual terminals may be inserted in the housing using this Insertion tool.

1. The terminal should be partially inserted into the housing. See Figure 1.
2. Position tip of insertion tool near the top of the terminal as shown in the picture above.
3. Push the terminal straight into the housing until an audible click is heard, or until the locking tang is visible on the opposite side of the housing.

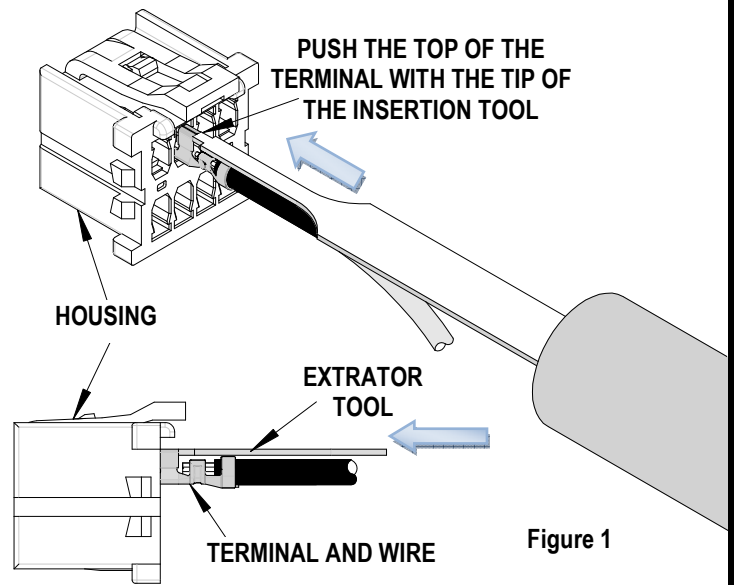

Figure 1

Note: Please do not forcefully insert, insert at an angle, or insert with a twisting action. It may damage the terminal or housing.

Note: Please do not forcefully insert, insert on an angle, or insert with twisting action. It may damage the tool or the housing.

For Insertion of 70021, 70028, 70058, 70110, and 71851 Terminal Series:

Individual terminals may be inserted in the housing using this Insertion tool.

1. To properly use this tool, with the flat side facing up, place the step of the tool into the terminal under the locking tangs. See Figure 1. Push the terminal into the housing until the locking tangs are visible through the window. The terminal then should be locked in place.

Optional: The terminal can be partially inserted in the terminal housing first, and then the Insertion tool can be used to firmly seat the terminal.

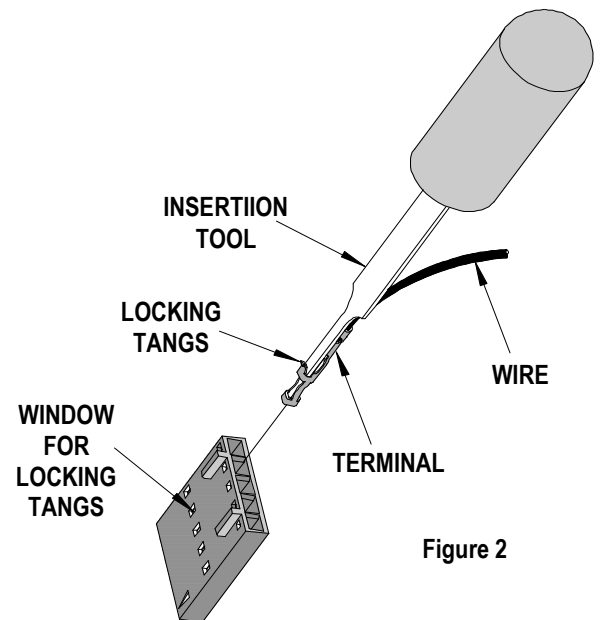

Figure 2

Note: Please do not forcefully insert, insert on an angle, or insert with twisting action. It may damage the tool or the housing.

For **Extraction** of 91821 Terminal Series:

Individual terminals may be extracted from the housing using this Tool.

1. Push the terminal and the wire forward in the arrow direction before using this Tool. Insert the Tool into the slot above the locking tang of the terminal. Push the tool down until the locking tang is even with the rest of the terminal. This will free the terminal from the housing.
2. Holding the wire and the tool together, pull the wire back through the connector slot in the arrow direction as shown in Figure 3.

Molex does not offer repair parts for this Tools due to the inexpensive nature of the tool

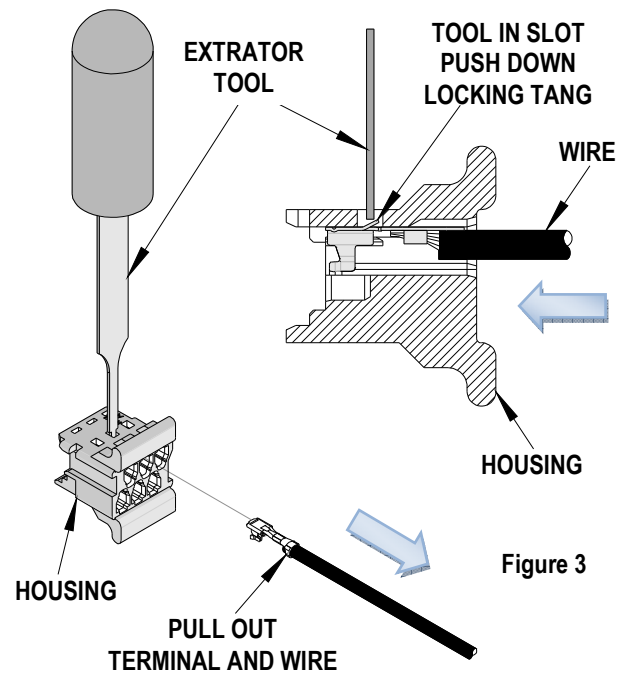

CAUTION: This extractor tool should be used to extract the terminal only. Using it for unintended purposes may cause injury or damage to parts. Be careful not to deform the end of the terminal.

CAUTION: Molex specifications are valid only when used with Molex terminals, applicators and tooling.

Contact Information

For more information on Molex application tooling please contact Molex at 1-800-786-6539.

Visit our Web site at <http://www.molex.com>