

PART NUMBER 938263020

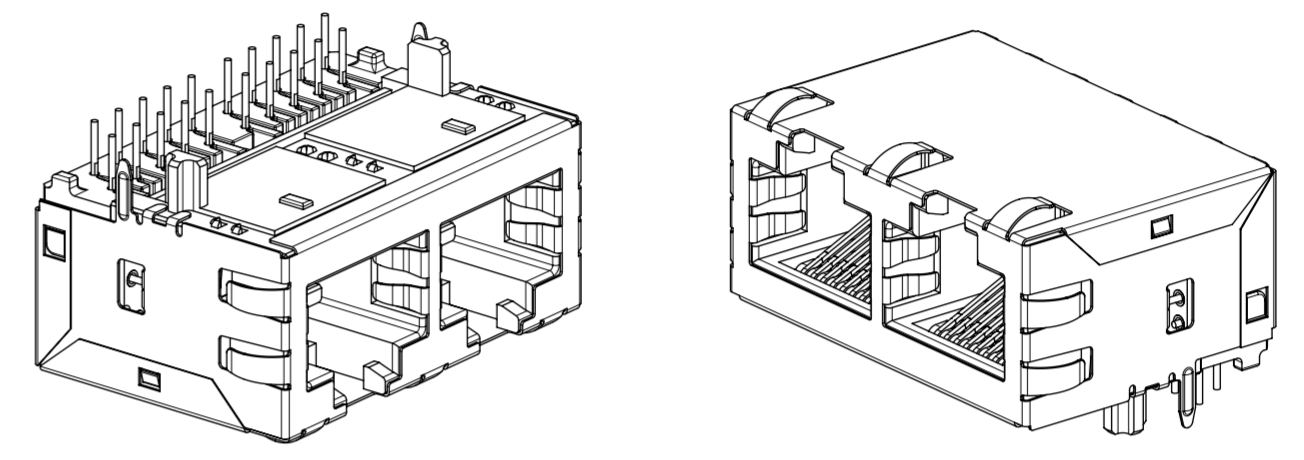

INVERTED PROFILE DUAL PORT MAGNETIC JACK  
GIGABIT ETHERNET  
WITH SHIELD TABS

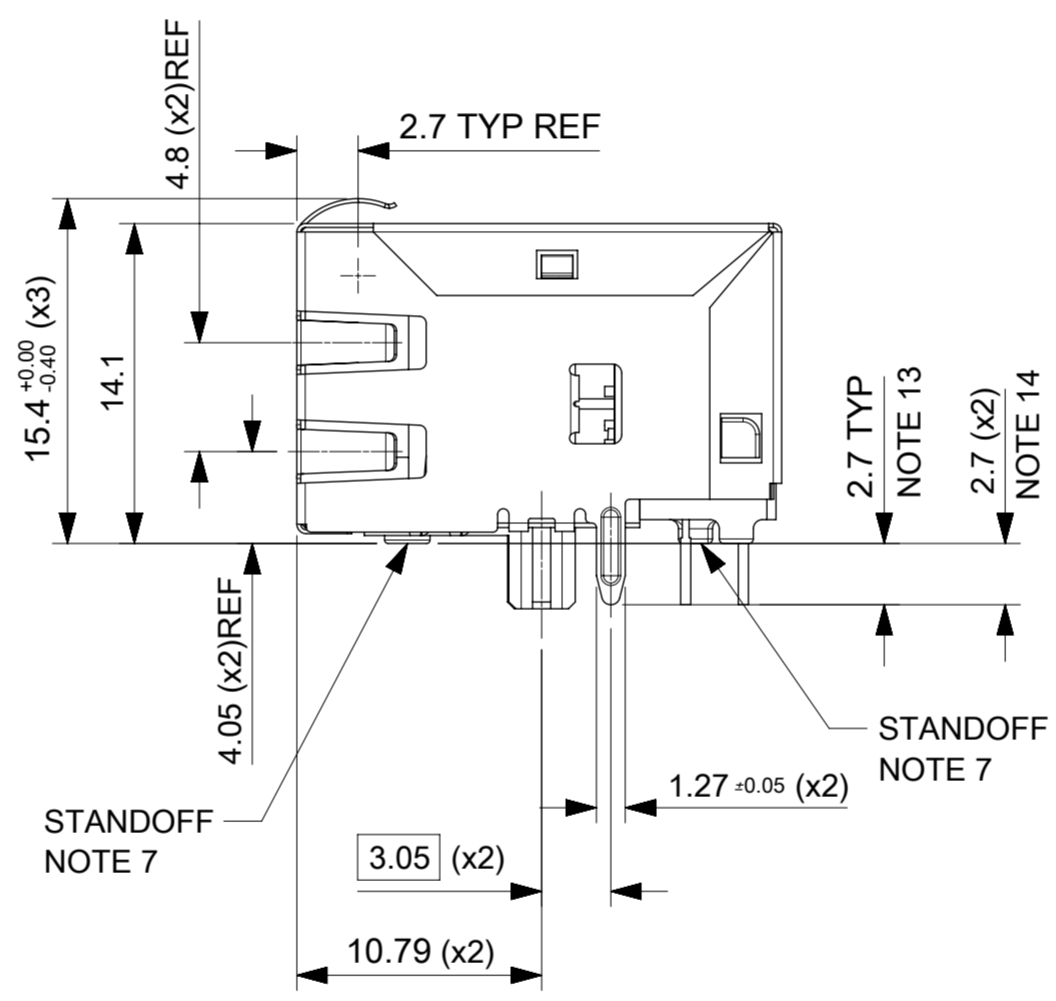
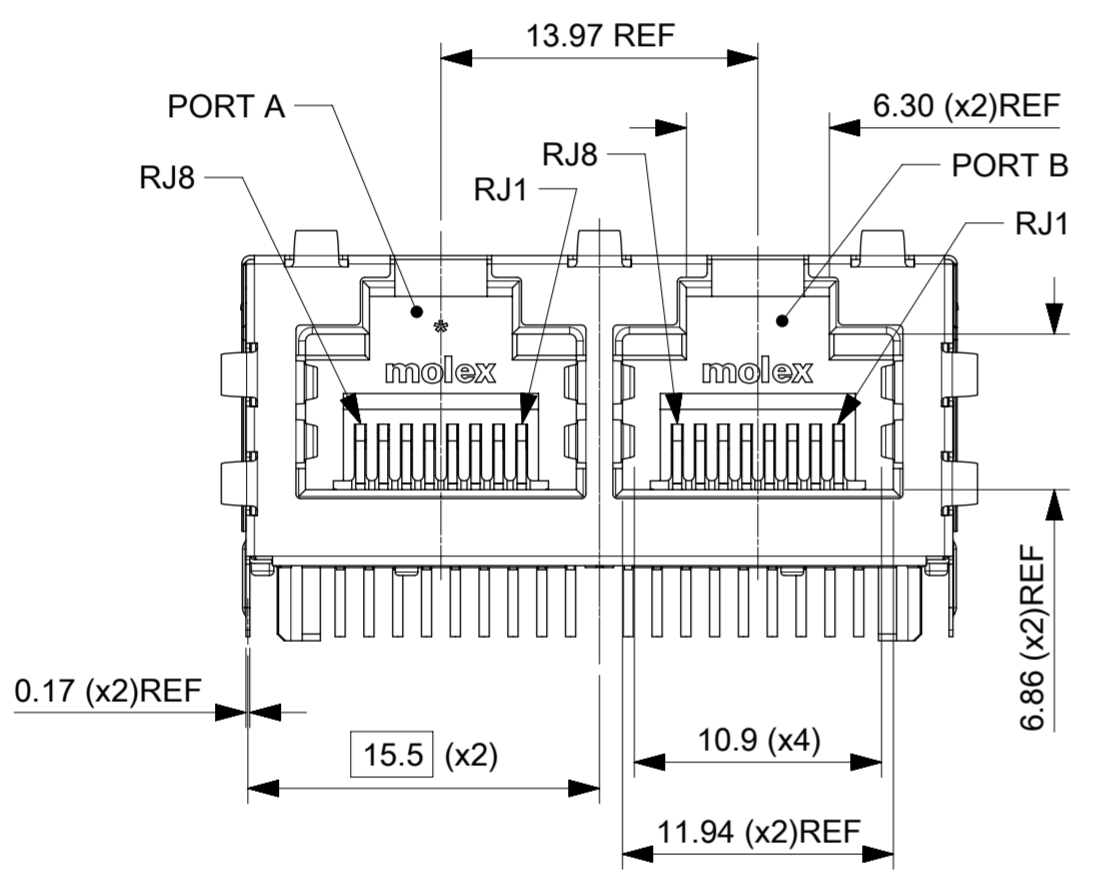

- NOTES:
- SHIELD MATERIAL: 0.17 mm THICK BRASS PRE-PLATED WITH NICKEL  
SOLDER TABS POST DIPPED WITH MIN. 1.27 μm TIN
  - HOUSING MATERIAL: LCP, BLACK, UL 94V-0
  - TERMINALS MATERIAL: PHOSPHOR BRONZE  
RJ45 CONTACTS PLATING: BASE NICKEL PLATED WITH GOLD  
FLASH OVER PALLADIUM NICKEL. REFER TO 934620001 PSP  
PHY SOLDER TAILS: COPPER ALLOY
  - MATING INTERFACE ACCORDING TO IEC 60603-7 & TIA-1096-A
  - PRODUCT SPECIFICATION: 934620001 PSP
  - PACKAGING SPECIFICATION: 938240001 PSK TRAY
  - STAND OFF TO SYSTEM BOARD 0.30 mm MIN
  - RECOMMENDED PCB THICKNESS: 1.6 mm
  - SHIELD: AVOID ROUTING TRACES  
OR PLACING ANY VIAS BELOW THESE AREAS.
  - MATERIAL COMPLIANT TO RoHS DIRECTIVE 2002/95/EC
  - INSCRIPTION MARKED BY LASER:  
1st: MOLEX  
2nd: PART NUMBER
  - INSCRIPTION MARKED BY LASER:  
DATE CODE (DAY/WEEK/YEAR)
  - PHY PIN LENGTH
  - SHIELD SOLDER TAB LENGTH

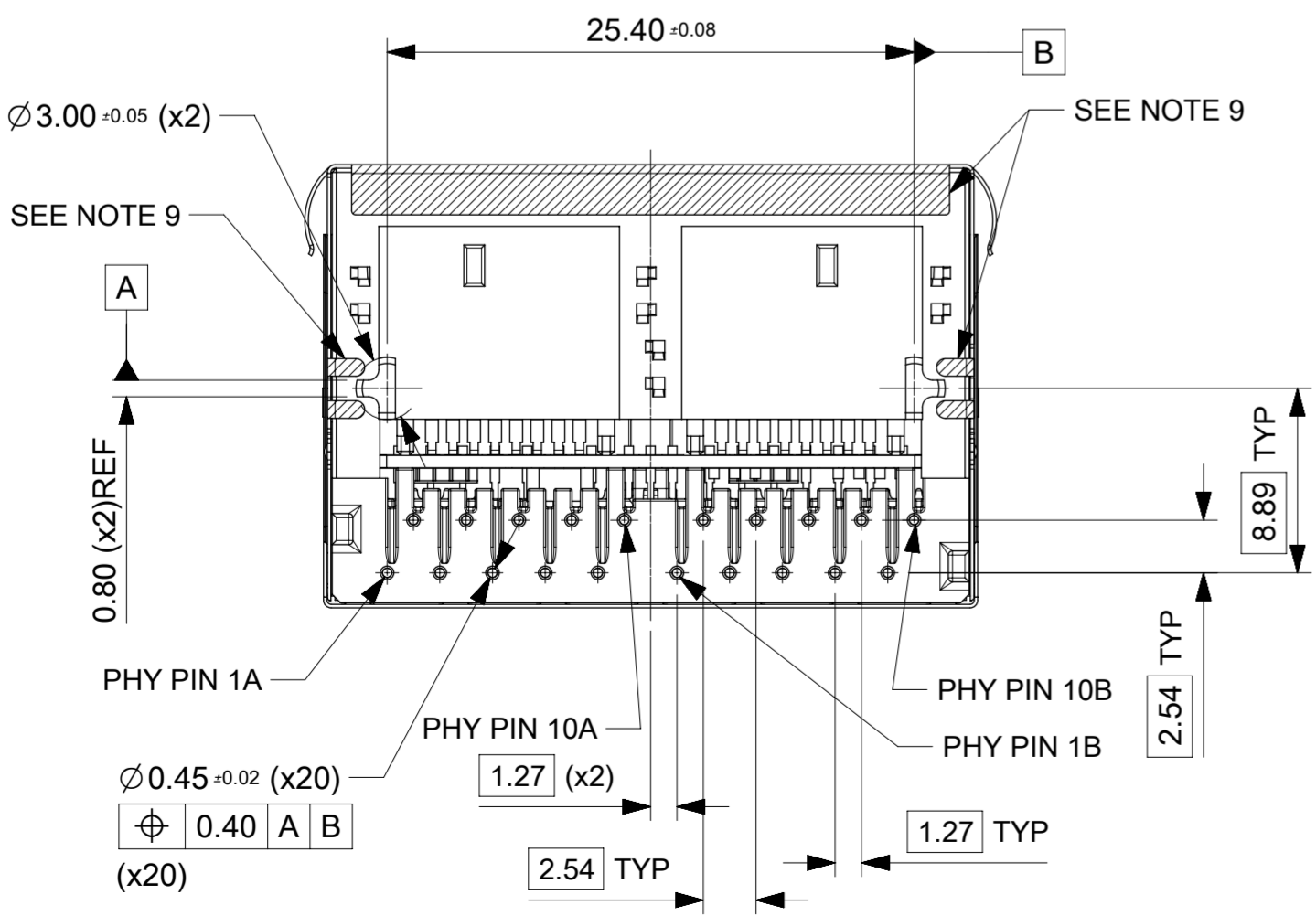

THIS DRAWING CONTAINS INFORMATION THAT IS PROPRIETARY TO MOLEX ELECTRONIC TECHNOLOGIES, LLC AND SHOULD NOT BE USED WITHOUT WRITTEN PERMISSION											
ORIGINAL RELEASE EC NO: 123046 DRWN: DSHEA CHKD: SMCGREEVY REV: APPR: DBYRNES	2017/10/17	2017/10/23	2017/11/07	GENERAL TOLERANCES (UNLESS SPECIFIED)	DIMENSION UNITS	SCALE					
				mm	3:1						
				ANGULAR TOL ± 2.0 °	DRWN BY	DATE	<b>MXMAG DUAL PORT 8C GIG COMMERCIAL W/O LED</b>				
				4 PLACES ±	DSHEA	2017/05/31					
			3 PLACES ±	CHK'D BY	DATE						
			2 PLACES ± 0.1	SMCGREEVY	2017/10/23						
			1 PLACE ± 0.2	APPR BY	DATE	PRODUCT CUSTOMER DRAWING					
			0 PLACES ±	DBYRNES	2017/11/07	SERIES	MATERIAL NUMBER	CUSTOMER			
			DRAFT WHERE APPLICABLE MUST REMAIN WITHIN DIMENSIONS	DRAWING SIZE	THIRD ANGLE PROJECTION	93826	SEE CHART	GENERAL MARKET			
A				A2		DOCUMENT NUMBER	938260001	DOC TYPE	PSD	DOC PART	SHEET NUMBER
								000			1 OF 3

RECOMMENDED PCB LAYOUT  
GIG VERSION W/O LED  
COMPONENT SIDE  
ALL DIMENSIONS REF DIMENSIONS

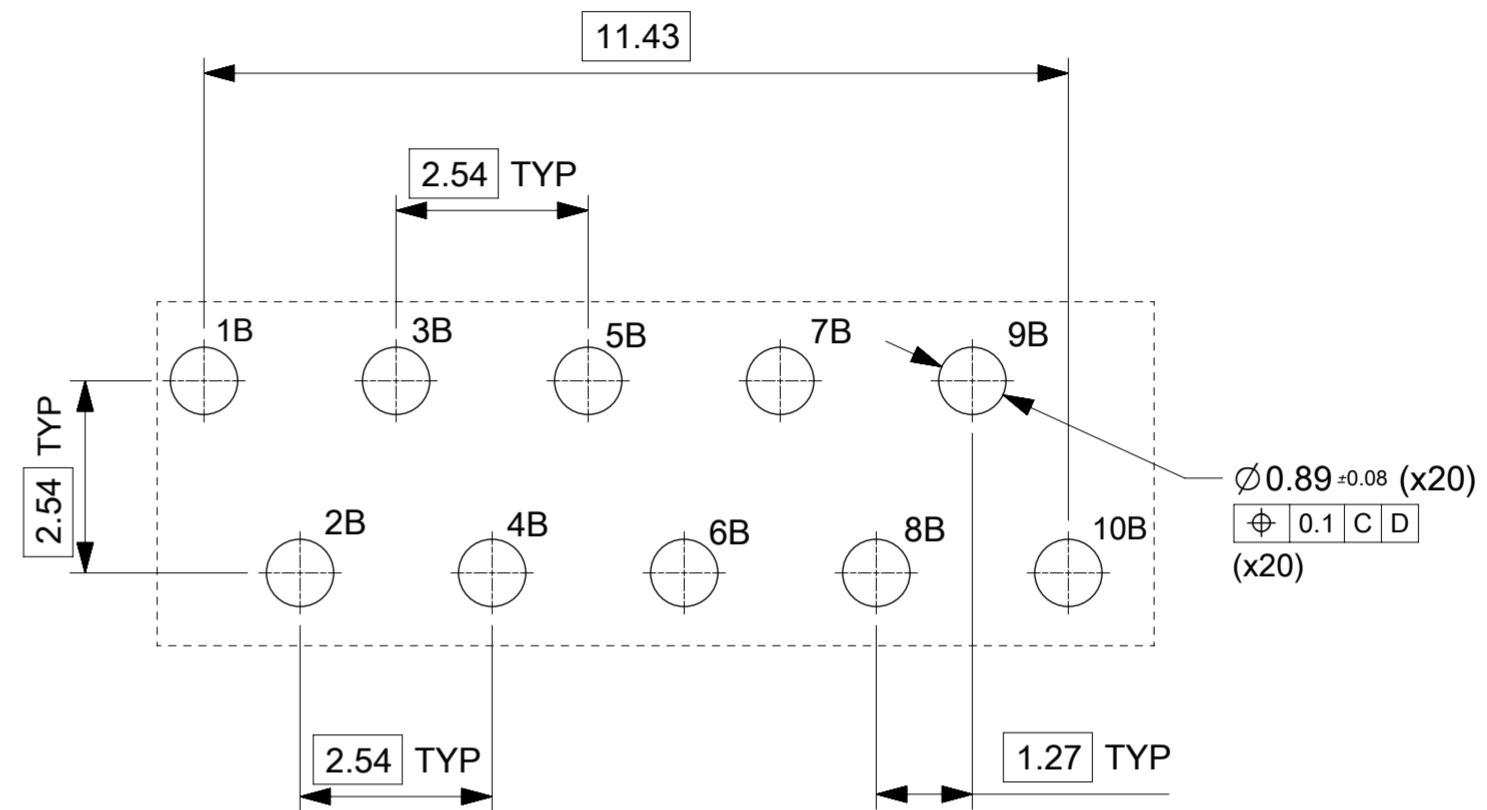
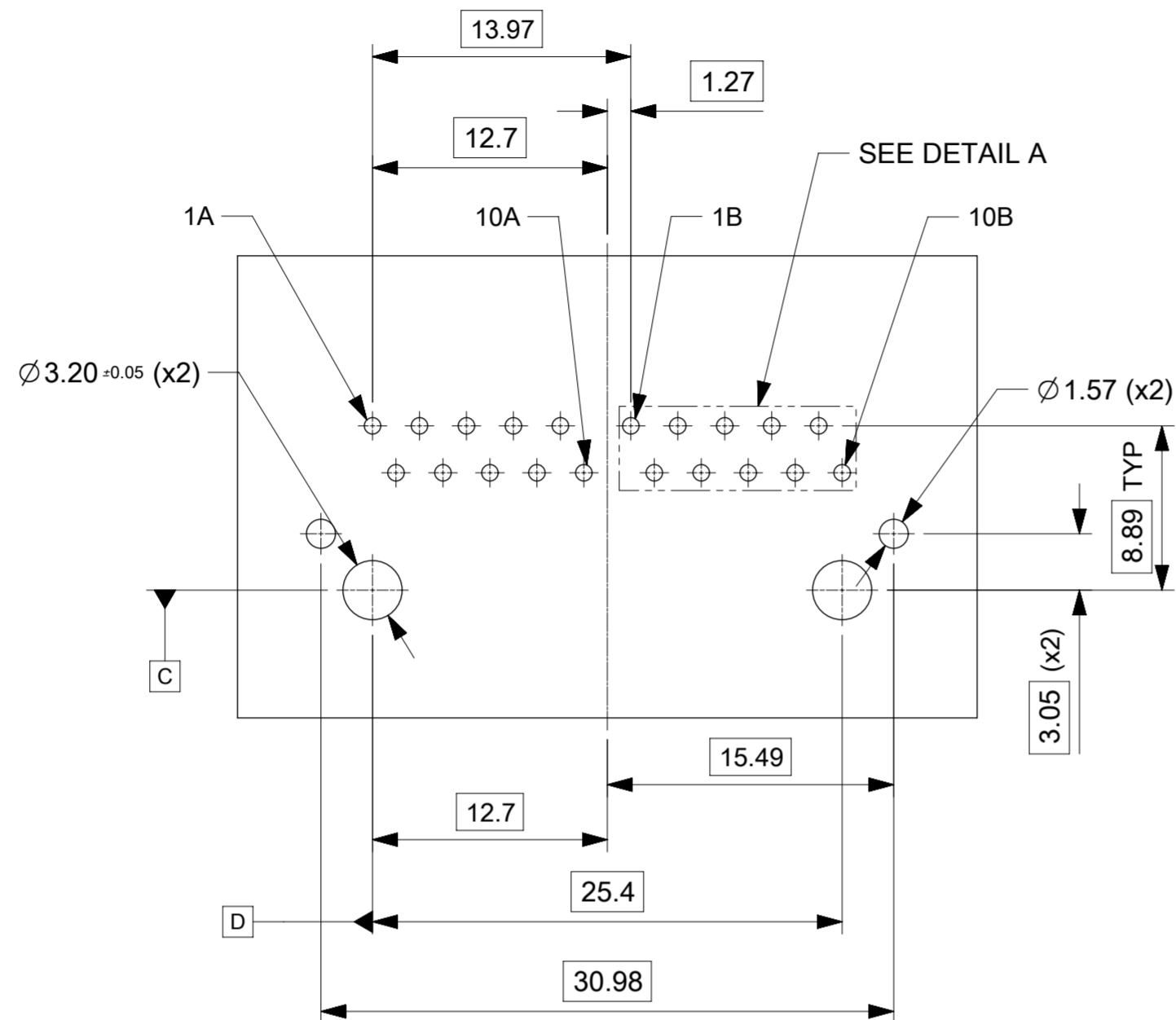

DETAIL A  
SCALE 10:1

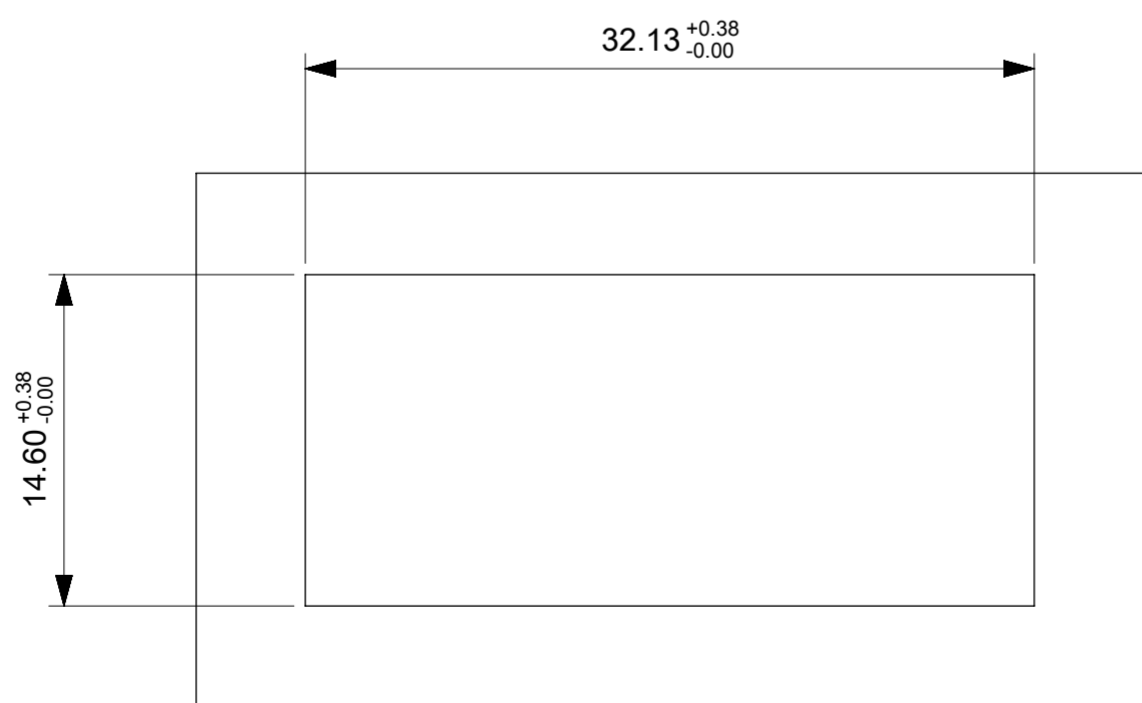

SUGGESTED PANEL CUTOUT

THIS DRAWING CONTAINS INFORMATION THAT IS PROPRIETARY TO MOLEX ELECTRONIC TECHNOLOGIES, LLC AND SHOULD NOT BE USED WITHOUT WRITTEN PERMISSION

ORIGINAL RELEASE EC NO: 123046 DRWN: DSHEA CHKD: SMCGREEVY REV: A	2017/10/17	2017/10/23	2017/11/07	GENERAL TOLERANCES (UNLESS SPECIFIED)	DIMENSION UNITS	SCALE			
	2017/10/17	2017/10/23	2017/11/07		mm	3:1			
	4 PLACES	±	±		DRWN BY	DATE		DSHEA	2017/05/31
	3 PLACES	±	±		CHK'D BY	DATE		SMCGREEVY	2017/10/23
	2 PLACES	±	± 0.1		APPR BY	DATE		DBYRNES	2017/11/07
1 PLACE	±	± 0.2	DRAWING SIZE	THIRD ANGLE PROJECTION	A2		SERIES: 93826 MATERIAL NUMBER: SEE SHEET 1 CUSTOMER: GENERAL MARKET		
0 PLACES	±	±	DRAFT WHERE APPLICABLE MUST REMAIN WITHIN DIMENSIONS				DOCUMENT NUMBER: 938260001 DOC TYPE: PSD DOC PART: 000 SHEET NUMBER: 2 OF 3		

MXMAG DUAL PORT 8C GIG COMMERCIAL W/O LED

PRODUCT CUSTOMER DRAWING



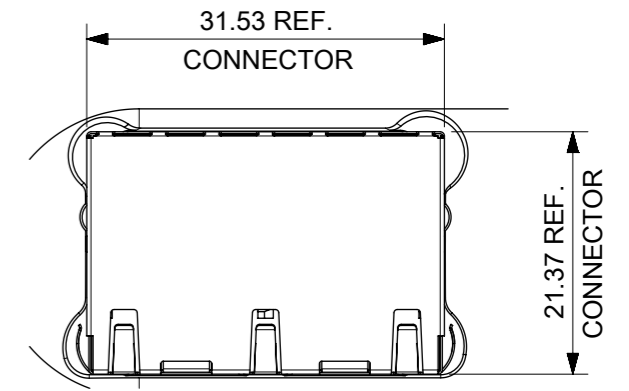
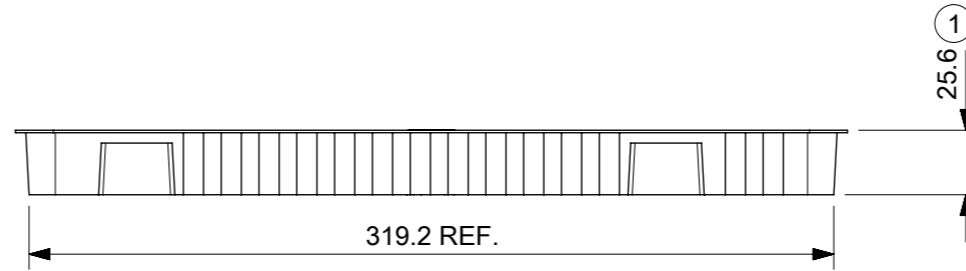
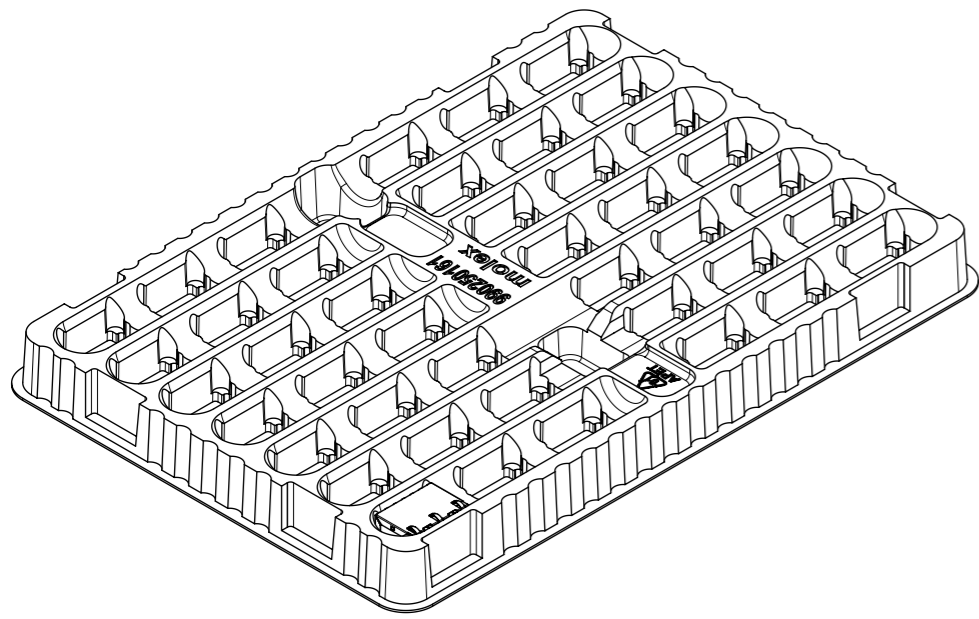

DETAIL B  
SCALE 3:2

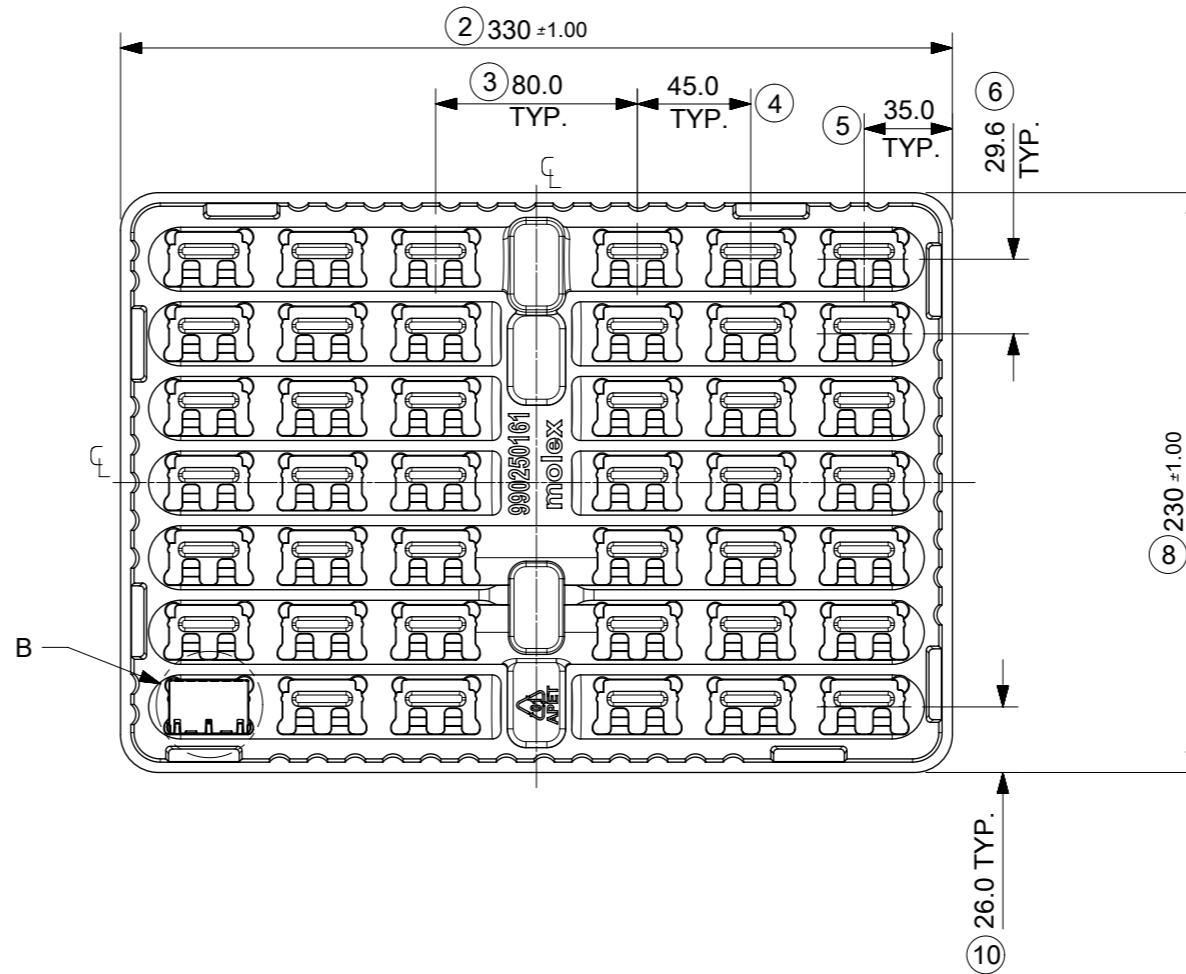
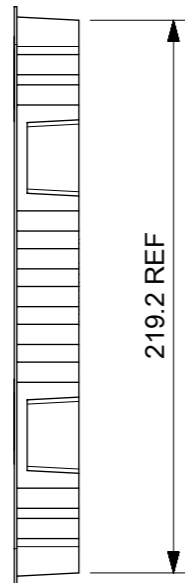

NOTES:

1. MATERIAL: PETA ANTISTATIC
2. THICKNESS: 0.9 mm REF
3. COLOUR: CLEAR
4. BOW 2 mm MAXIMUM PER 330 mm
5. TWIST 2 mm MAXIMUM PER 330 mm
6. TRAY PART NO. AND RECYCLE LOGO TO BE CLEARLY MARKED ON TRAY  
RECYCLE LOGO SHOULD BE APPROPRIATE TO MATERIAL USED
7. WHERE RELEVANT, DIMENSIONS SHOULD BE SYMMETRICAL ABOUT THE CENTRELINE
8. GENERAL PROFILE TOLERANCE  $\frac{\text{R}}{0.40}$  ON NON DIMENSIONED FEATURES
9. PACKAGING SPECIFICATION: 938240001 PSK

DIMENSION NUMBERS DELETED: 7, 9, 11, 12  
LAST INSPECTION NUMBER USED: 10

THIS DRAWING CONTAINS INFORMATION THAT IS PROPRIETARY TO MOLEX ELECTRONIC TECHNOLOGIES, LLC AND SHOULD NOT BE USED WITHOUT WRITTEN PERMISSION

ORIGINAL RELEASE EC NO: 123046 DRWN: DSHEA CHK'D: SMCGREEVY APPR: DBYRNES	2017/10/17	2017/10/23	GENERAL TOLERANCES (UNLESS SPECIFIED) ANGULAR TOL ± 1.0 ° 4 PLACES ± 3 PLACES ± 2 PLACES ± 0.2 1 PLACE ± 0.5 0 PLACES ± DRAFT WHERE APPLICABLE MUST REMAIN WITHIN DIMENSIONS	DIMENSION UNITS	SCALE					
				mm	1:3					
				DRWN BY	DATE		SMCGREEVY	2017/06/15		
				CHK'D BY	DATE		SMCGREEVY	2017/10/23		
				APPR BY	DATE	PRODUCT CUSTOMER DRAWING				
				DBYRNES	2017/11/07	SERIES	MATERIAL NUMBER	CUSTOMER		
						99025	990250150	GENERAL MARKET		
				DRAWING SIZE	THIRD ANGLE PROJECTION	DOCUMENT NUMBER				
				A3		990250161		DOC TYPE	DOC PART	SHEET NUMBER
								PSD	000	1 OF 1

RELEASE STATUS	P1	RELEASE DATE	07.11.2017	10:13:22
----------------	----	--------------	------------	----------