

Panel Thickness  
Screw L=5.0 For Panel Thickness  
Under 1.2mm  
Screw L=6.0 For Panel Thickness  
Between 1.2-2.0mm

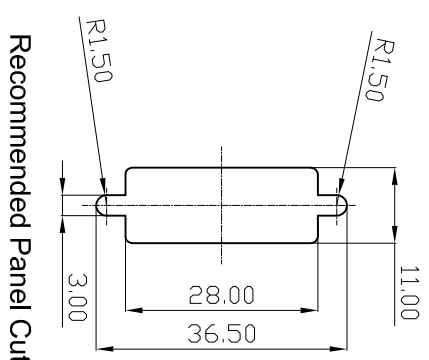

Recommended Panel Cut-Out

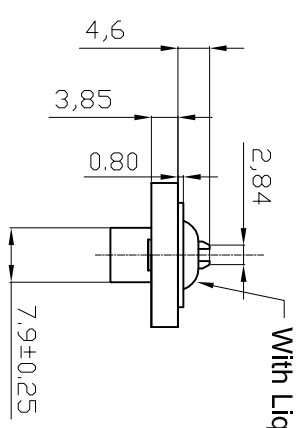

With Liquid Glue

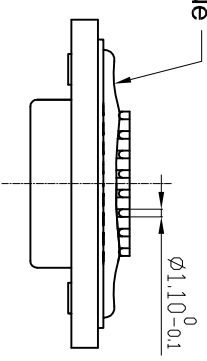

- NOTES:**
- MATERIAL**
1. Insulator Material: Black, NYLON+G/F
  2. Contact Material : Copper Alloy
  3. Plating : Gold Plating
  4. Waterproof Rate: IP67
  5. Applicable Wire Range: 22AWG-26AWG
  6. Do Mating Test After Glued

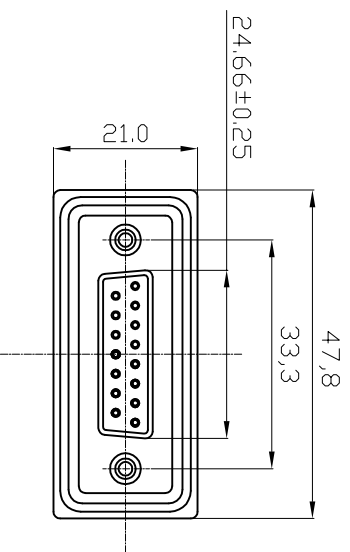
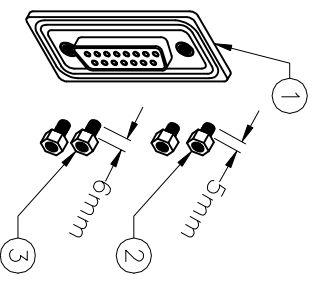

**ROHS compliant**  
Unit: mm

Scale	Free				
TOLERANCE	±0.25				
X.X	±0.10				
X.XXX	±0.05				
DIM	TOL	②	Cancel LOGO		
ANGLE	±1°	①	Drawn	24.01.2018	Tom
X.X°	±X°			24.12.2008	JACK
Angle	TOL	Id.	Modification	Date	Name



Customer-No.  
ASSMANN WSW-No.  
**A-DF 15 LL-WP**

Drawing-No.  
**ASS 3253 CO**

Replace  
rev02  
Sheet

1	2	3	4	5	6	7	A
1	2	3	4	5	6	7	B
1	2	3	4	5	6	7	C
1	2	3	4	5	6	7	D
1	2	3	4	5	6	7	E
1	2	3	4	5	6	7	F
1	2	3	4	5	6	7	G
1	2	3	4	5	6	7	H