

EN Zone für durchkontaktierte Löcher $\phi 0,6 \pm 0,05$
 compliant zone for thru hole $\phi 0,6 \pm 0,05$

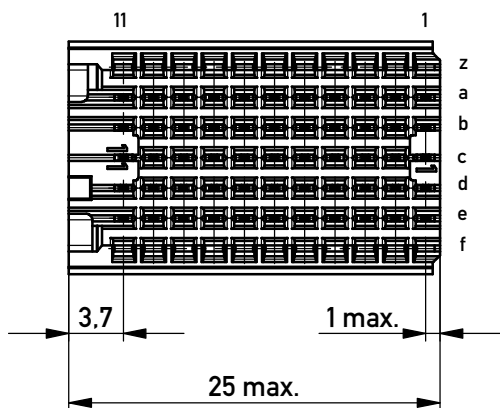

Bestückungsplan / contact layout

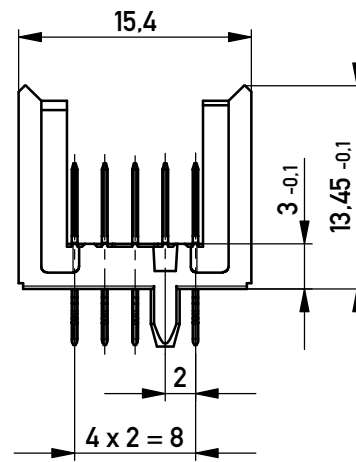
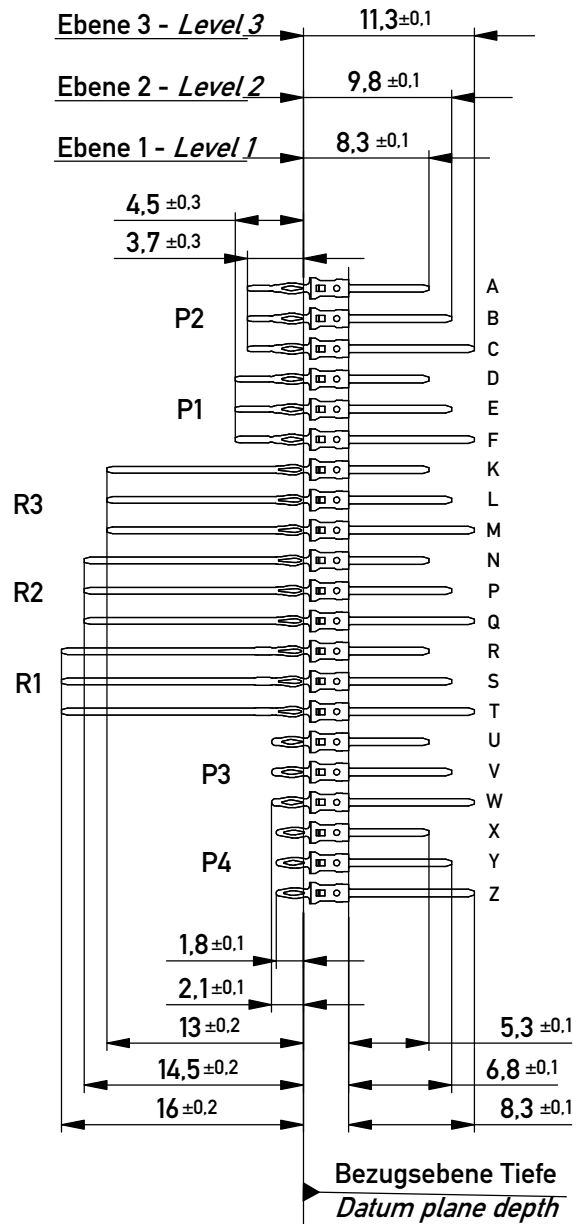
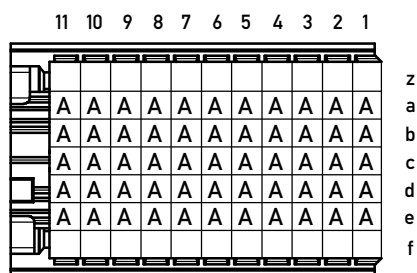

Lochbild für Leiterplatte (Bestückungsseite)

board hole pattern (component mounting side)

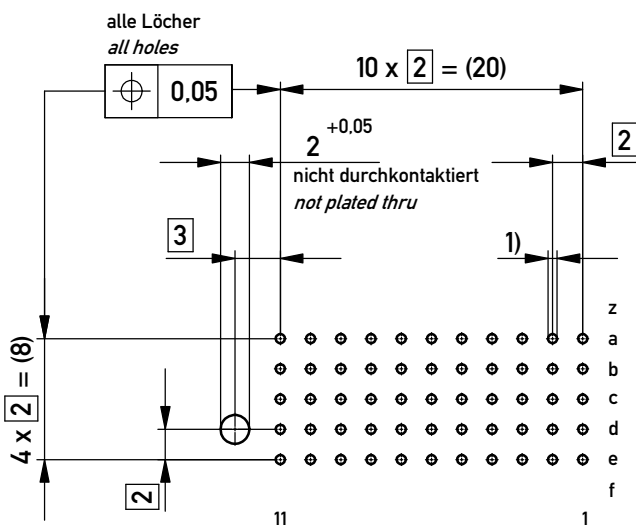

1) $\phi 0,6 \pm 0,05$ Durchmesser des metallisierten Loches
 $\phi 0,6 \pm 0,05$ Diameter of finished plated-through hole

Schichtaufbau im metallisierten Loch siehe Zeichnung 164062 Nr.1
 Metal plating of plated-through hole according to 164062 No.1

Fehlende Maße und Angaben nach IEC 61076-4-101
 Missing information and dimensions per IEC 61076-4-101

Au-plating!

Copyright by ERNI Production GmbH & Co. KG
 Proprietary notice pursuant to ISO 16016 to be observed.

Information:
 P2 Level 1
 siehe Bestückungsplan / see contact layout
 Anforderungsstufe 2 / class 2

All rights reserved.
 Only for Information.
 To ensure that this is the latest version of this drawing, please contact one of the ERNI companies before using.

Tolerances

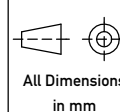

Scale 2:1

Subject to modification without prior notice.
 Drawing will not be updated.

Designation

ERmet Messerleiste C
ERmet Male Wide Type C

ERNI www.ERNI.com

223980

I
 A3

| | |
|-------|------------|
| b | 28.02.2018 |
| Index | Date |

Class ERMC