

Verpackt in Gurtverpackung
Tape on Reel Packaging
Verpackungseinheit: 320 Stück
Packaging unit: 320 pcs

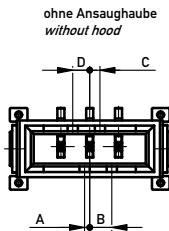

Leiterplatten-Layout Vorschlag für SMT
PCB-Layout Proposal for SMT

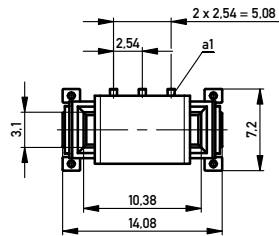
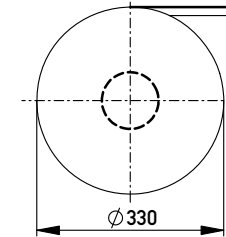
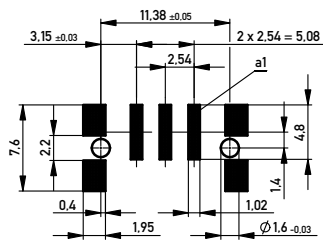

Anforderungsstufe 1
Performance Level 1

Kontaktbereich vergoldet
Mating Area gold plating

Anschlussbereich verzinkt 4-6 µm
Terminal Area 4-6 µm tin plating

Koplanarität der Anschlüsse ≤ 0.1 mm
Coplanarity Area of Termination ≤ 0.1 mm

Abspulrichtung - Reel off Direction

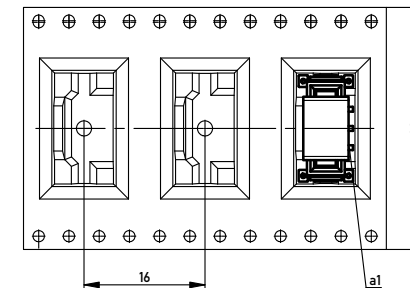

454201		weiß white	0,45	1,95	0,9	1,5	Codierung wie Variante schwarz Encoding such variant black
284659		rot red	3,15	0,75	3,6	1,2	
284658		grün green	2,25	0,15	2,7	0,3	
284657		blau blue	1,35	1,05	1,8	0,6	
284656		schwarz black	0,45	1,95	0,9	1,5	
Ident-Nr. part-no.	Codierung coding	Farbe color	A	B	C	D	Bemerkung note

Information:	Tolerances		Scale	3:1
All rights reserved. Only for Information. To ensure that this is the latest version of this drawing, please contact one of the ERNI companies before using.	Subject to modification without prior notice. Drawing will not be updated.	Designation M 2.54 SRC-P, 3-polig		
g	24.04.2013	ERNI	www.ERNI.com	224984
Index	Date	Class		SRCP