

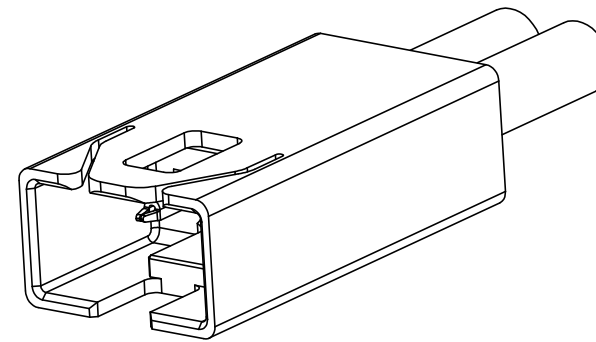

REVISIONS			
REV	DESCRIPTION, ECN, EAR NO.	DATE	APP'D
C	UPDATED WIDTH DIMENSION	MAR31/21	S.M.
D	DWV UPDATED	MAY04/21	S.M.

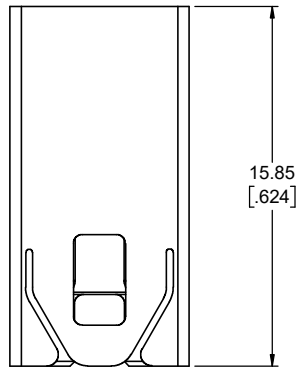

APPLICATION VIEW

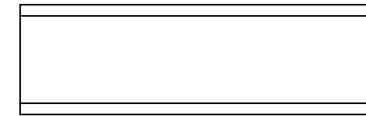
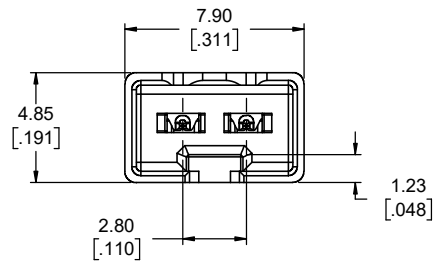

**NOTES:**

- MATERIALS: ALL MATERIALS ARE RoHS COMPLIANT PER EU DIRECTIVE 2011/65/EU & AMENDMENTS
  - HOUSING: ENGINEERING THERMOPLASTIC, UL FLAMMABILITY RATING 94V-0, COLOUR BLACK
  - CONTACTS: COPPER ALLOY, PLATED WITH TIN OVER NICKEL
- ELECTRICAL CHARACTERISTICS
  - CURRENT RATING: 7A (18 AWG) OR 5A (20 AWG) OR 3A (22 AWG) PER CONTACT
  - DIELECTRIC WITHSTANDING VOLTAGE: 1500 VAC
  - INSULATION RESISTANCE: 500 MEGAOHMS
  - OPERATING TEMPERATURE: -40 °C TO +105 °C
- INSERT SOLID OR TIN DIPPED STRANDED WIRE, 3.5±0.25 MM STRIPPED LENGTH

AMPHENOL PART NUMBER: **FLM-P23-XX**

XX = 00 - BLACK HOUSING (STANDARD)  
 XX = W0 - WHITE HOUSING  
 XX = 01-99 CUSTOM CONFIGURATIONS

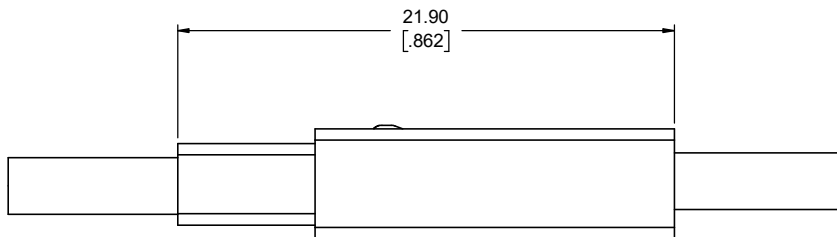

MATED ASSEMBLY WITH FLM-S23-00 WIRES ASSEMBLED

UNLESS SPECIFIED OTHERWISE	DRAWN	I.NELSON	AUG25/20
PRIMARY UNITS MILLIMETERS	CHECKED	S.MUGAN	OCT0820
SECONDARY UNITS INCHES	M.E. APP'D		
REFERENCE IN PARENTHESES	Q.A. APP'D		
GENERAL TOLERANCES	DWG APPR.		
1 DECIMAL PLACE	ENG. REL. NO.		
2 DECIMAL PLACES ±0.10	REF.		
3 DECIMAL PLACES	THIRD ANGLE PROJECTION		
ANGULAR DEGREES	DO NOT SCALE DRAWING		

<b>Amphenol Canada Corp.</b> Commercial Products			
FLM SERIES RECEPTACLE WITH WIRE POKE IN CONTACT RoHS COMPLIANT			
DWG. NO.	P-FLM-P23-XX		REV D
CODE ID NO. 03554	DWG SIZE: X	SCALE: 5:1	SHEET 1 OF 1