

APPROVED: \_\_\_\_\_  
 DATE: \_\_\_\_\_ TITLE: \_\_\_\_\_

Rev	AWO #	Description	Date	Appr
-		RELEASED	11/7/16	
A		UPDATED CHART	8/5/22	SS

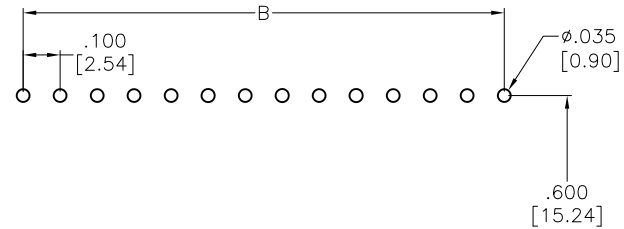

RECOMMENDED PCB LAYOUT

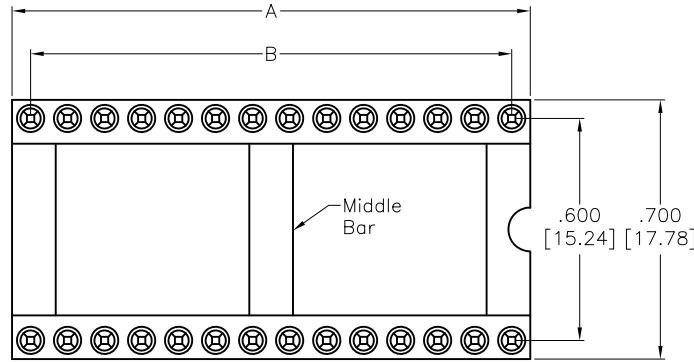
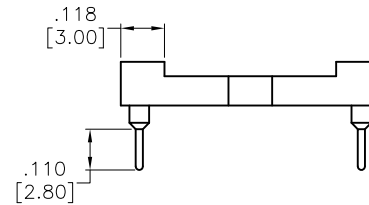
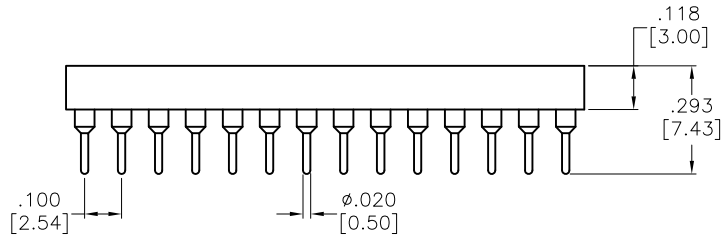

**SPECIFICATIONS:**

Material:  
 Insulator: (PPS) Hi-Temp Thermoplastic, rated UL 94V-0  
 Insulator color: Black  
 Pin (Outer Sleeve): Brass  
 Clip (Contact 4 finger): Beryllium Copper  
 Plating:  
 Inner contact: Gold flash over Nickel underplate  
 Outer sleeve: Tin over Nickel underplate overall  
 Electrical:  
 Operating voltage: 60VAC/DC  
 Current rating: 3 Amps/contact max.  
 Current resistance:  $\cong 4\text{m}\Omega$  / contact  
 Insulation resistance:  $\cong 1,000\text{M}\Omega$  at 100 V  
 Mechanical:  
 Operating temperature: Gold plated: -55°C to + 105°C  
 Tin plated: -40°C to + 105°C  
 Average insertion force: < 250g  
 With steel pin of Ø.017 [0.43mm]  
 Average withdrawal force: > 90g min.  
 With steel pin of Ø.017 [0.43mm]  
 Mechanical life: 200 Cycle min.  
 Environmental:  
 Lead free, RoHS compliant



P/N	POSITION	A	B	MIDDLE BAR
ICM-620-1-GT-HT	20	1.000 [25.40]	.900 [22.86]	WITH
ICM-624-1-GT-HT	24	1.200 [30.48]	1.100 [27.94]	
ICM-628-1-GT-HT	28	1.400 [35.56]	1.300 [33.02]	
ICM-632-1-GT-HT	32	1.600 [40.64]	1.500 [38.10]	
ICM-640-1-GT-HT	40	2.000 [50.80]	1.900 [48.26]	
ICM-642-1-GT-HT	42	2.100 [53.34]	2.000 [50.80]	
ICM-648-1-GT-HT	48	2.400 [60.96]	2.300 [58.42]	
ICM-664-1-GT-HT	64	3.200 [81.28]	3.100 [78.74]	

UNLESS OTHERWISE SPECIFIED  
 ALL DIMENSIONS ARE INCHES [MM]  
 TOLERANCES: EXCEPT AS NOTED  
 INCHES HOLES  
 .X ± .10 Ø.X ± .10  
 .XX ± .020 Ø.XX ± .015  
 .XXX ± .015 Ø.XXX ± .010

**ADAM TECH**

909 Rahway Avenue, Union, NJ 07083  
 Phone: 908-687-5000 Fax: 908-687-5710

TITLE		SCREW MACHINE IC SOCKET .600" ROW SPACING, HI-TWMP	
SIZE	PART NO.	REV.	
X	ICM-6XX-1-GT-HT	A	
REF:	S00145C	SCALE:	NTS
		SHEET 1 OF 1	

APPROVALS		DATE
DRAWN	AY	11/7/16
CHECKED	DH	11/7/16
APPROVED		