

TSW-SERIES

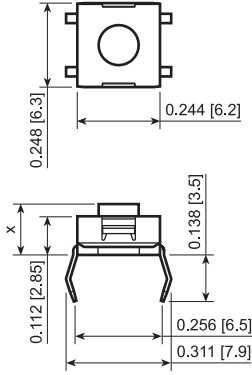

Suggested PCB Layout

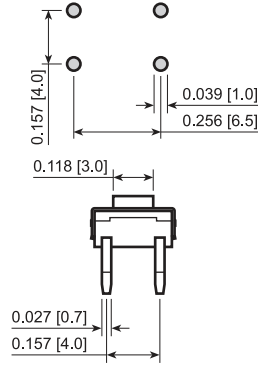

Actuator Options

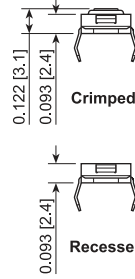

FEATURES:

- Washable
- Reliable and Economical
- Tube or Tape and Reel Packaging

SPECIFICATIONS:

RATING: 50mA 12VDC
TEMPERATURE: -20°C to 70°C (Operating)
 -30°C to 80°C (Storage)
ELECTRICAL LIFE: *For Silicone Actuators:*
 500,000 Cycles
For Crimped and Recessed:
 100,000 Cycles
CONTACT RESISTANCE: 100mΩ Max. at 5VDC
INSULATION RESISTANCE: 100MΩ Min. at 500VDC
DIELECTRIC STRENGTH: 250VAC for 1 Minute
VIBRATION TEST: MIL-STD-202 METHOD 201A
SHOCK TEST: MIL-STD-202 METHOD 213B
OPERATION FORCE: Varies

MATERIALS:

BASE: Polyamide 6/6, UL94 V-0
COVER: Stainless Steel
 Tin Plated Steel
ACTUATOR: Silicone Rubber
 Polyamide 6/6, UL94 V-0
 Nickel Plated Brass
CONTACTS: Silver Plated Phosphor Bronze
 Stainless Steel
TERMINALS: Silver Plated Brass

TSAMW-SERIES

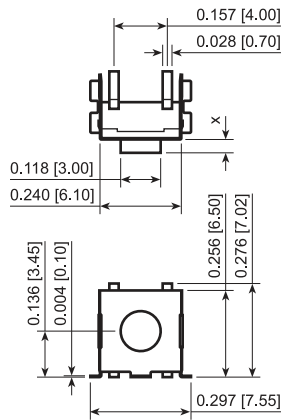

Suggested PCB Layout

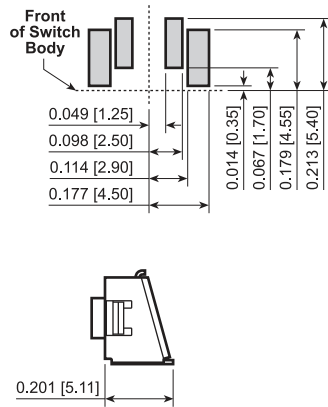

Options

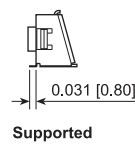

TSW-3.8-180-B

TSMW-SERIES and TSJW-SERIES

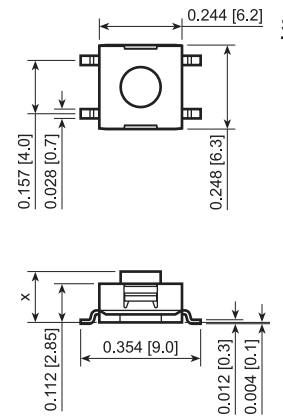

Suggested PCB Layout

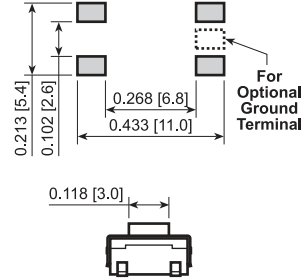

Terminal Options

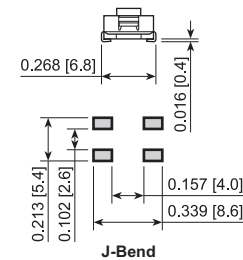

Actuator Options

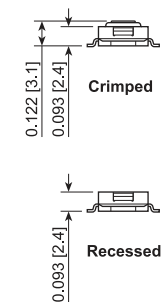

TSAMW-3.3-260-S-TR

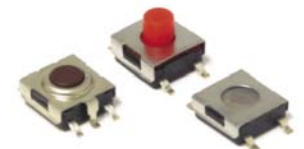

TSM9W-3.1CG-160-TR
 TSM9W-5.2-260-TR
 TSM9W-2.3R-160-TR

Series	Actuator Height (X Dimension)	Actuation Force	Options	Packaging
<input type="checkbox"/> <input type="checkbox"/> <input type="checkbox"/> <input type="checkbox"/> <input type="checkbox"/>	<input type="checkbox"/> <input type="checkbox"/> <input type="checkbox"/> <input type="checkbox"/>	<input type="checkbox"/> <input type="checkbox"/> <input type="checkbox"/> <input type="checkbox"/>	<input type="checkbox"/>	<input type="checkbox"/> <input type="checkbox"/>
TSW - Through Hole, Washable TSAMW - Right Angle SMT, Washable TSM9W - Gull Wing SMT, Washable TSJW - J-Bend SMT, Washable	For TSW, TSMW, and TSJW Series: 2.3R - Recessed 3.1C - Crimped 3.1CG - Crimped, Grounded 3.5 3.8 4.5 5.2 For TSAMW Series: 0.0 0.8 1.0 2.35 3.3	For TSW, TSMW, and TSJW Series: 160 - 160gf (*) 180 - 180gf (**) 260 - 260gf 360 - 360gf For TSAMW Series: 180 - 180gf 260 - 260gf	For TSW, TSMW, and TSJW Series: None For TSAMW Series: U - Not Supported S - Supported	For TSW Series: B - Tube For TSM9W and TSJW Series: B - Tube TR - Tape and Reel For TSAMW Series: None - Bulk TR - Tape and Reel

Notes:
 * = Available with 2.3R, 3.1C, and 3.1CG Actuators Only.
 ** = Available with 3.5, 3.8, 4.5, and 5.2 Actuators Only.

EXAMPLE PART NUMBERS:

TSM9W-3.1C-160-TR **3.1mm**
 9.0mm Gull Wing SMT, Crimped Actuator
 TSJW-3.1C-160-TR **3.1mm**
 J-Bend SMT, Crimped Actuator