

- NOTES:
- MATERIAL: HOUSING: LCP, FIBER GLASS FILLED, UL94V-0, COLOR:BLACK. TERMINAL: PHOSPHOR BRONZE. METAL SHELL: BRASS.
 - FINISH: TERMINAL: SELECTIVE GOLD(Au) IN CONTACT AREA, THICKNESS=30 MICROINCH MINIMUM; SELECTIVE TIN IN SOLDER TAIL AREA, THICKNESS=120 MICROINCH MINIMUM; NICKEL(Ni) OVERALL. METAL SHELL: NICKEL(Ni) OVERALL; THICKNESS=40 MICROINCH MINIMUM; UNDER PLATED: COPPER(Cu) OVERALL.
 - PRODUCT SPECIFICATION REFER TO PS-48258-001.
 - PACKAGE SPECIFICATION REFER TO PK-48258-001.
 - TEST SUMMARY REFER TO TS-48258-001
 - COPLANARITY TO BE 0.10 mm MAX.
 - LEAD FREE AND RoHS COMPLIANT PRODUCT.
 - DATE CODE: X X X X X
 X X X X X
 DAY
 WEEK
 YEAR

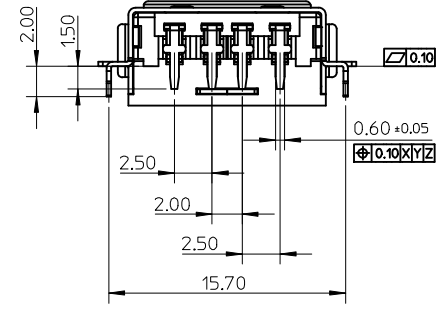
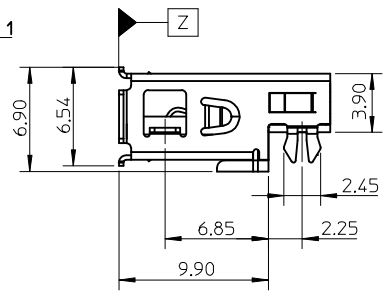
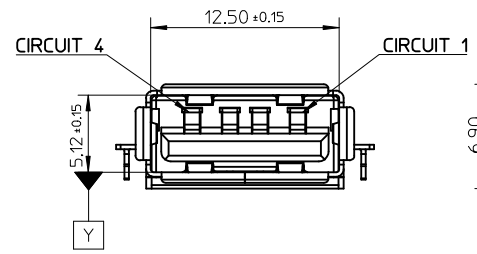

NEW RELEASE IEC NO: SH2013-0324 DRW: F YANG05 2013/03/30 CHKD: APPR: RZHANG 2013/05/17 REV DESCRIPTION	QUALITY SYMBOLS	GENERAL TOLERANCES (UNLESS SPECIFIED) mm INCH 4 PLACES ± --- ± --- 3 PLACES ± --- ± --- 2 PLACES ± 0.25 ± --- 1 PLACE ± 0.25 ± --- ANGULAR ± 3° DRAFT WHERE APPLICABLE MUST REMAIN WITHIN DIMENSIONS	DIMENSION STYLE	SCALE	DESIGN UNITS	THIRD ANGLE PROJECTION	
			MM ONLY	1:1	METRIC		
			DRAWN BY	DATE	TITLE		
			CHECKED BY	DATE	USB A SINK REVERSE TYPE (LEAD-FREE VERSION)		
	APPROVED BY	DATE	MOLEX MOLEX INCORPORATED				
	MATERIAL NO.	48258-0001	DOCUMENT NO.	SD-48258-001	SHEET NO.	1 OF 1	
	SIZE	THIS DRAWING CONTAINS INFORMATION THAT IS PROPRIETARY TO MOLEX INCORPORATED AND SHOULD NOT BE USED WITHOUT WRITTEN PERMISSION					