

LOADING PATTERN MATING SIDE

f	0	0	0	0	0	0	0	0	0	0					0	0	0	0	0	0	0	0	0	0	0	0	0
e	4	4	4	4	4	4	4	5	4	4					5	4	4	4	4	4	4	4	4	4	4	4	4
d	4	4	4	4	4	4	4	5	4	4	5				4	4	4	4	4	4	4	4	4	4	4	4	4
c	4	4	4	4	4	4	4	4	4	5	4				4	4	4	4	4	4	4	4	4	4	4	4	4
b	4	4	4	4	4	4	4	4	5	4	4				5	4	4	4	4	4	4	4	4	4	4	4	4
a	4	4	4	4	4	4	4	5	4	4	5				4	4	4	4	4	4	4	4	4	4	4	4	4
z	0	0	0	0	0	0	0	0	0	0	0				0	0	0	0	0	0	0	0	0	0	0	0	0
POS	0														1												
	1														5												

LOADED CONNECTOR ASSEMBLY (FOR EXAMPLE)

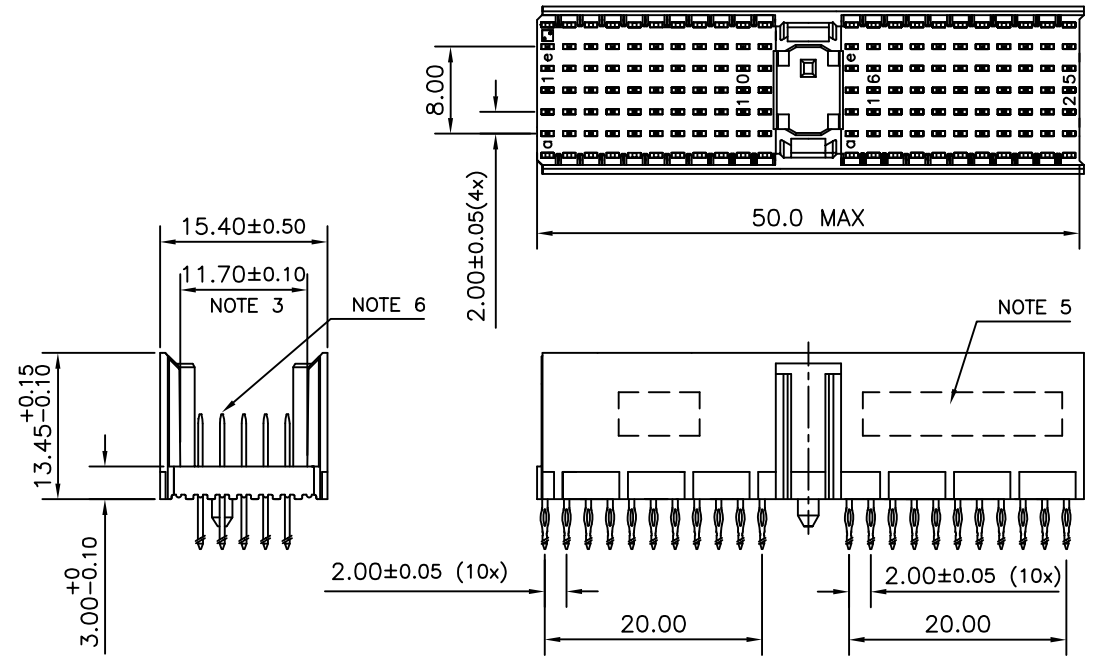

CONTACT OVERVIEW

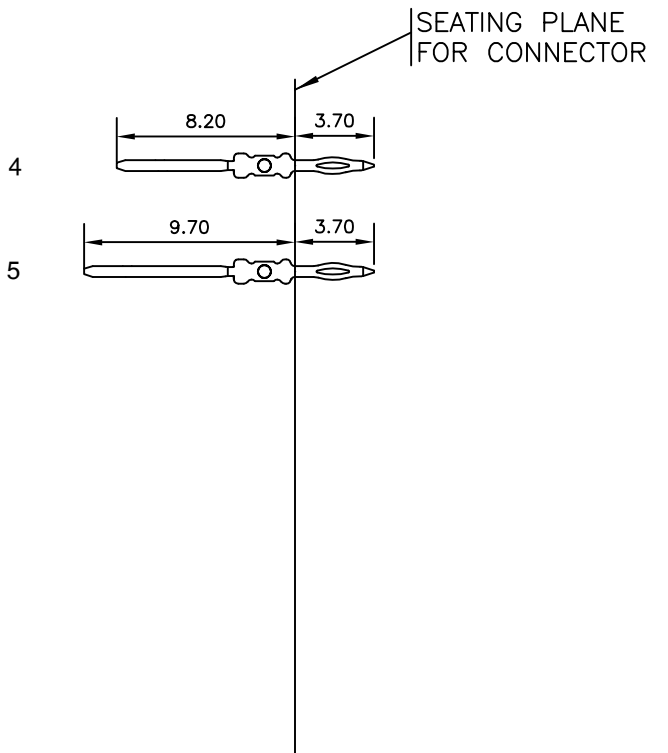

LAY-OUT P.C.B.-HOLE

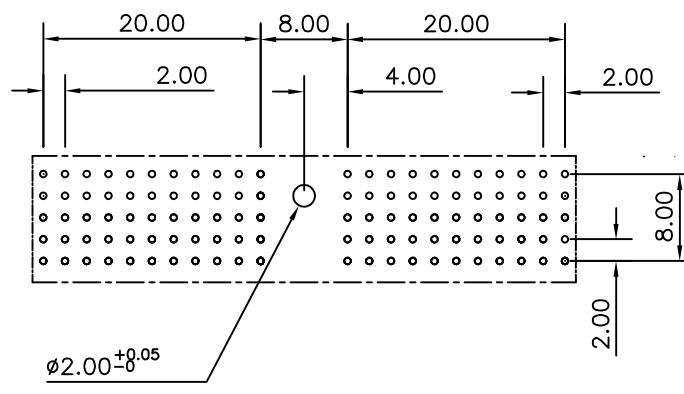

LEAD FREE INDICATOR : LF = LEAD FREE (DIGIT 15 & 16)

HM2P07PDP120

PLATING CODE (DIGIT 13 AND 14) (REF DRW NO. BS,C , 201844 , 003)

NOTES

1. THIS PRODUCT IS CSA APPROVED.
2. THIS PRODUCT IS UL RECOGNIZED.
3. MEASURED AT THE BOTTOM.
4. MATERIAL CONTACT: PHOSPHORBRONZE  
HOUSING: CREAM WHITE GLASS FILLED POLYESTER UL-94V0
5. CONNECTOR PRINTED WITH P/N AND DATE CODE.
6. FOR ACTUAL CONTACT LOADINGS, SEE LOADING PATTERN MATING SIDE.
7. SHAPE OF CONNECTOR HOUSING CAN ALTER DEPENDING ON PRODUCTION LOCATION
8. THE PRODUCT (LF) MEETS EUROPEAN UNION DIRECTIVES AND OTHER COUNTRY REGULATIONS AS DESCRIBED IN GS-22-008
9. FOR RECOMMENDED PTH DIMENSIONS REFER DRAWING : BS, A , 201572 , 001

CATALOG NO: HM2P07PDP120- - -

mat'l. code SEE NOTE 4				surface ISO 1302 ✓	tolerance ISO 406 ISO 1101	projection MM	product family MLLIPACS
litr				tolerances unless otherwise specified		MM	title MPACS 5+2R STR HDR PF CONN TYPE A
A	I05-0262	MINI	2005-12-02	angles	linear		
B	I06-0141	MINI	2006-08-04	0°±1°			
dr				MINI K VANDANATH	2005-12-02	dwg no sheet 1 of 1 size 5	
enr				BIJU K PAUL	2005-12-02	BS, C ,203028, 610 A3	
chr				BIJU K PAUL	2006-08-04	type Product Customer Drawing	
appd				BIJU K PAUL	2006-08-04		
sheet index	revision sheet	B	1				

FCIconnect.com  
 Copyright FCI