

75 Ω SMB TO 4 GHz

SMB Cable Assemblies RF179



SERIES	END 1 CONNECTOR	END 2 CONNECTOR	OVERALL LENGTH
RF179 = RG 179 Cable	-77SP1 = 75 Ω SMB Straight Plug -77RP1 = 75 Ω SMB Right-angle Plug		-“XXXX” = Overall Length in millimeters -0100 (100 mm) 3.94" minimum

ALSO AVAILABLE

75 Ω: DIN 1.0/2.3, BNC, MCX, MMCX = RF179

SMB Cable Connectors SMB7H-CA



CONNECTORS FOR INDUSTRY STANDARD CABLES	
SMB7H -P-C-H-ST-CA3	RG 179 Cable
SMB7H -P-C-HF-RA-CA3	RG 179 Cable

P-C = Cable Plug
H or HF = Plating (30 μ" Gold center contact, 3 μ" Gold outer contact)
ST = Straight
RA = Right-angle

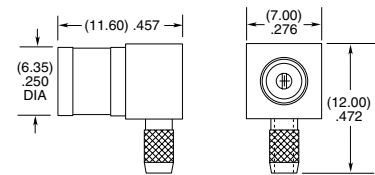

-P-RA

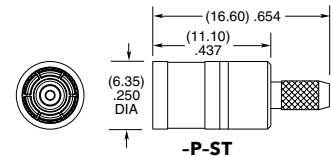

-P-ST

Supplied with pins and ferrules.
See website for dimensions

SMB Board Connectors SMB7H-TH, SMB7H-EM

Cable Mates:
RF179, GRF7H-C



SMB7H	GENDER	TYPE	PLATING	ORIENTATION	TERMINATION
	-J = Jack	-P = PCB Mount	-H = 30 μ" (0.76 μm) Gold center contact, 3 μ" (0.08 μm) Gold outer contact	-ST = Straight -RA = Right-angle	-TH1 = Through-hole ((0.90 mm) .035" DIA Signal Pin) -TH2 = Through-hole ((0.51 mm) .020" DIA Signal Pin) (-ST only) -EM1 = Edge Mount (-ST only)

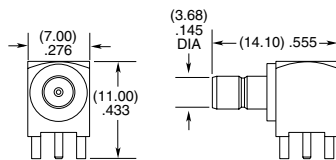

-RA-TH1

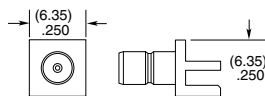

-ST-EM1

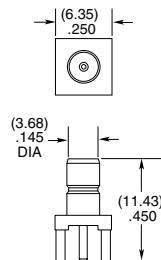

-ST-TH1 & -ST-TH2

Note:
Additional plating options available on Cable Assemblies, Cable Connectors and Board Connectors.
Contact RFGGroup@samtec.com