

THIS DRAWING IS UNPUBLISHED. RELEASED FOR PUBLICATION
 © COPYRIGHT BY TYCO ELECTRONICS CORPORATION. ALL INTERNATIONAL RIGHTS RESERVED.

LOC	DIST	REVISIONS					
		P	LTR	DESCRIPTION	DATE	DWN	APVD
—	—		A	REV PER ECO-10-020463	16DEC10	PY	DW

DESIGNED FOR USE WITH
.085 S.R.(RG 405/U)

CABLE ENTRY DIAMETER
MINIMUM

HOUSING	.088
CONTACT	.021

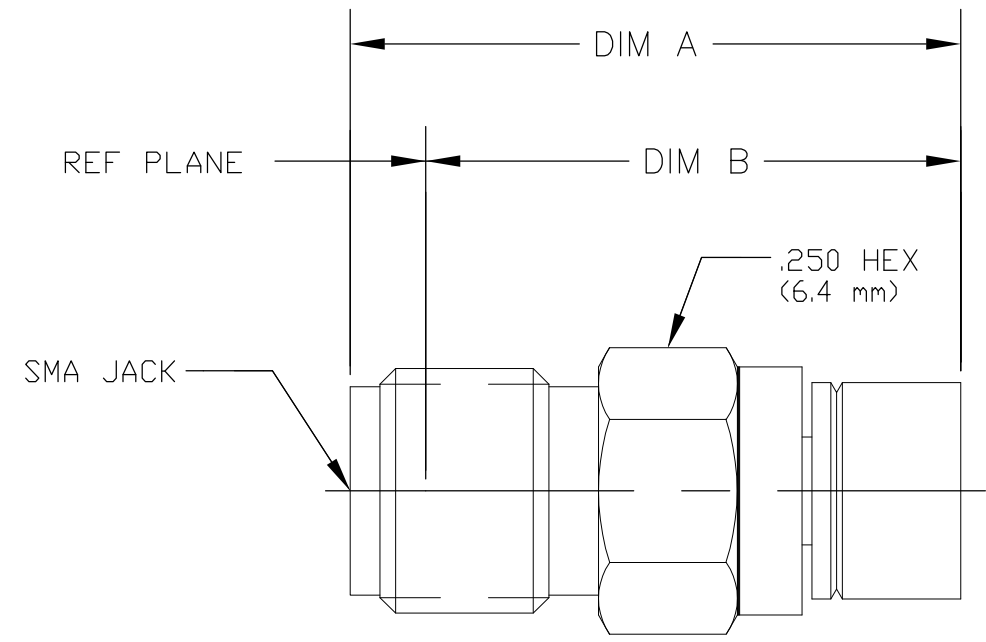

- NOTES:
1. PICTORIAL VIEW IS AFTER CRIMPING
 2. MIN STRAIGHT CABLE LENGTH: .292
 3. IT IS SUGGESTED TO BEND CABLE PRIOR TO CRIMPING
 4. CRIMP BUSHING MAY BE SHIPPED UNASSEMBLED

BEFORE CRIMPING	.721 REF (18.3 mm)	.645 REF (16.4 mm)
AFTER CRIMPING	.620 MAX (15.7 mm)	.535 REF (13.6 mm)
 	DIM "A"	DIM "B"

ELECTRICAL	MECHANICAL	ENVIRONMENTAL
Nominal Impedance (Ohms) <u>50</u>	Interface Dimensions <u>MIL-STD-348 Fig 310.2</u>	TEMPERATURE RATING <u>-65° TO +165°C</u>
Frequency Range (GHz) <u>DC to 18</u>	Recommended Mating Torque <u>7-10 In-lbs</u>	Vibration MIL-STD-202, Method 204, Condition D
Volt Rating (VRMS MAX) @ Sea Level <u>335</u>	Center Contact Captivation Axial (Lbs) <u>6</u>	Shock MIL-STD-202, Method 213, Condition I
VSWR <u>1.07+.01f(GHz)</u>	Radial (In/Dz) <u>NONE</u>	Thermal Shock MIL-STD-202, Method 102, Condition C
Insertion Loss (dB MAX) <u>.03x √ f(GHz)</u>	Cable Retention Axial Force (Lbs) <u>30</u>	EXCEPT HIGH TEMP +115°C
RF Leakage (dB MIN) <u>-90 @ 2-3 GHz</u>	Torque (In/Dz) <u>16</u>	Moisture Resistance MIL-STD-202, Method 106
Corona, 70,000 Ft (VRMS MIN) <u>250</u>	Weight (Grams) <u>2.1</u>	Corrosion - MIL-STD-202, Method 101, Condition B
Dielectric Withstanding Voltage (VRMS MIN) @ Sea Level <u>1000</u>	Mating Characteristics Insertion (Max Lbs) <u>3</u>	
Contact Resistance (Milliohms MAX) Center Contact <u>3.0</u>	Withdrawal (Min Oz) <u>1</u>	
Outer Contact <u>2.0</u>	Connector Engagement and Disengagement (In/Lbs Max) <u>2</u>	
Cable to Housing <u>0.5</u>		
RF High Potential @ Sea Level (VRMS MIN @ 5 MHz) <u>670</u>		
I.R.(Megohms MIN) <u>5000</u>		

COMPONENT	MATERIAL	FINISH	PART NUMBER																									
HOUSING BUSHING	STAINLESS STEEL PER ASTM-A484 AND ASTM- A582, TYPE 303	PASSIVATE PER ASTM-A380	1050934-1																									
DIELECTRIC	TFE FLUOROCARBON PER MIL-P-19468 AND FED SPEC L-P-403	N/A																										
CENTER CONTACT	BERYLLIUM COPPER PER ASTM B196, ALLOY 173	GOLD PLATE PER MIL-G-45204 OVER COPPER PLATE PER MIL-C-14550																										
THIS DRAWING IS A CONTROLLED DOCUMENT.		<table border="1"> <tr> <td>DWN</td> <td>P. YEAGER</td> <td>16DEC2010</td> <td rowspan="4"> Tyco Electronics Corporation Harrisburg, PA 17105-3608 </td> </tr> <tr> <td>CHK</td> <td>D. WILSON</td> <td>16DEC10</td> </tr> <tr> <td>APVD</td> <td>D. WILSON</td> <td>16DEC10</td> </tr> <tr> <td>PRODUCT SPEC</td> <td colspan="2">NAME</td> </tr> <tr> <td colspan="3">APPLICATION SPEC</td> <td> SMA STRAIGHT CABLE JACK COMPRESSION CRIMP ATTACHMENT M39012/81-3207 CAT F </td> </tr> <tr> <td colspan="3">WEIGHT</td> <td>RESTRICTED TO</td> </tr> <tr> <td colspan="3">CUSTOMER DRAWING</td> <td> SIZE: A3 CAGE CODE: 00779 DRAWING NO: C-1050934 </td> </tr> </table>		DWN	P. YEAGER	16DEC2010	Tyco Electronics Corporation Harrisburg, PA 17105-3608	CHK	D. WILSON	16DEC10	APVD	D. WILSON	16DEC10	PRODUCT SPEC	NAME		APPLICATION SPEC			SMA STRAIGHT CABLE JACK COMPRESSION CRIMP ATTACHMENT M39012/81-3207 CAT F	WEIGHT			RESTRICTED TO	CUSTOMER DRAWING			SIZE: A3 CAGE CODE: 00779 DRAWING NO: C-1050934
DWN	P. YEAGER	16DEC2010	Tyco Electronics Corporation Harrisburg, PA 17105-3608																									
CHK	D. WILSON	16DEC10																										
APVD	D. WILSON	16DEC10																										
PRODUCT SPEC	NAME																											
APPLICATION SPEC			SMA STRAIGHT CABLE JACK COMPRESSION CRIMP ATTACHMENT M39012/81-3207 CAT F																									
WEIGHT			RESTRICTED TO																									
CUSTOMER DRAWING			SIZE: A3 CAGE CODE: 00779 DRAWING NO: C-1050934																									
DIMENSIONS: INCHES	TOLERANCES UNLESS OTHERWISE SPECIFIED:	<table border="1"> <tr> <td>0 PLC</td> <td>± -</td> </tr> <tr> <td>1 PLC</td> <td>± -</td> </tr> <tr> <td>2 PLC</td> <td>± -</td> </tr> <tr> <td>3 PLC</td> <td>± .005</td> </tr> <tr> <td>4 PLC</td> <td>± -</td> </tr> <tr> <td>ANGLES</td> <td>± -</td> </tr> </table>		0 PLC	± -	1 PLC	± -	2 PLC	± -	3 PLC	± .005	4 PLC	± -	ANGLES	± -													
0 PLC	± -																											
1 PLC	± -																											
2 PLC	± -																											
3 PLC	± .005																											
4 PLC	± -																											
ANGLES	± -																											
MATERIAL SEE TABLE	FINISH SEE TABLE	SCALE: 6:1 SHEET: 1 OF 1 REV: A																										