

LOC	QTY	REV	DESCRIPTION	DATE	BY	APP
CM	00					
P			REVISED PER ECR-20-000721	04MAR2020	PC	SW

- 1 MATERIAL: CONNECTOR-NYLON UL94V-2 (WHITE).
 CONTACTS-0.30 [.012] THICK COPPER ALLOY
 BRIGHT TIN-LEAD 0.00203 [.000080] MINIMUM THICK FOR CONTACTS
 641535-2 THRU 641535-6,
 MATTE WHISKER MITIGATED TIN PLATE 0.00203 [.000080] MINIMUM THICK OVER
 NICKEL UNDERPLATE FOR CONTACTS 3-641535-2 THRU 3-641535-6.
- 2. CONTACTS ACCEPT 24 AWG WIRE WITH 1.52 [.060] MAXIMUM INSULATION DIAMETER.
- 3. CONTACTS MUST ACCEPT 0.36-0.51 [.014-.020] SQUARE OR ROUND POST AND
 REMAINED LOCKED IN POSITION.
- 4 IDENTIFICATION NUMBER FOR LAST CIRCUIT MAY NOT APPEAR ON ALL ASSEMBLIES.
- 5. DIMENSIONS IN BRACKETS ARE IN INCHES.
- 6. HOUSING FEATURES ARE: CLOSED END WITH LOCKING RAMP & LED CONTACT.
- 7 OBSOLETE PARTS: OBSOLETE CIS STREAMLINING PER D.RENAUD/D.SINIS
- 8 OBSOLETE PARTS

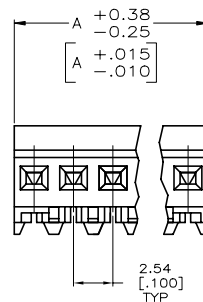
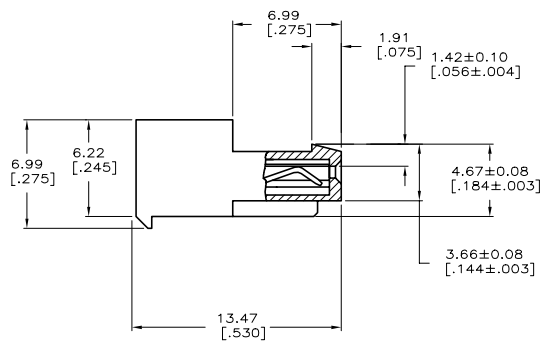
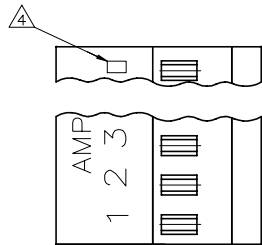

LEAD FREE	DIM A	NO.OF POSN	ASSEMBLY
	15.24 [.600]	6	3-641535-6
	12.70 [.500]	5	3-641535-5
	7.62 [.300]	3	3-641535-3
	5.08 [.200]	2	3-641535-2

CONTAINS LEAD	DIM A	NO.OF POSN	ASSEMBLY
8 SUPERSEDED	15.24 [.600]	6	641535-6
7 SUPERSEDED	12.70 [.500]	5	641535-5
7 SUPERSEDED	7.62 [.300]	3	641535-3
OBSOLETE	5.08 [.200]	2	641535-2

THIS DRAWING IS A CONTROLLED DOCUMENT. DR: S. HOOVER 10-DEC-2004
 CH: B. BOSSI 10-DEC-2004
 DIMENSIONS: mm (INCHES)
 DIMENSIONS: 0.13 [.005]
 FINISH: 1
 MATERIAL: 1
 WEIGHT: 114-1019
 SCALE: 5:1
 SHEET: 1 of 1
 REV: P
 CUSTOMER DRAWING

TE Connectivity
 MTA-100 CONNECTOR ASSEMBLY,
 24 AWG, FOR .014 TO .020 POST, SPECIAL
 PRODUCT SPEC: 108-1050
 APPLICATION SPEC: 114-1019
 SIZE: A1
 DRAWING NO: 00779
 C=641535