

LTR	DESCRIPTION	DATE	BY
-	Released	9/13/02	JCL

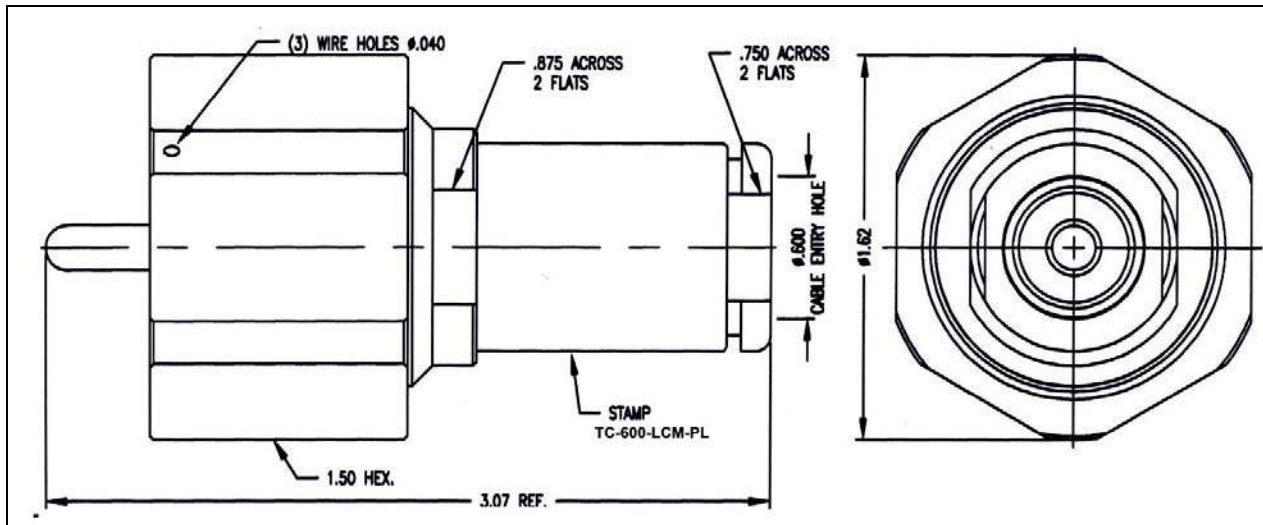

I. MATERIALS & FINISHES

- center contact: Gold Plated Brass
- outer contact: Nickel Plated Phosphor Bronze
- body: Nickel Plated Brass
- dielectric: Teflon® PTFE
- gasket: Silicone Rubber
- shrink sleeve: Adhesive Lined Polyolefin
- attachment: braid clamp

II. ELECTRICAL PROPERTIES

- impedance: 50 ohms
- working voltage: 5000 vrms (max)
- vswr: 1.25:1 (max) up to 1 GHz
- insertion loss: 0.10 x √Fghz

Unless otherwise specified, dimensions are in inches. Tolerances are applicable when specified.

These drawings and specifications contain proprietary information which is the property of Times Microwave Systems.

Approvals		
Drawn	JCL	9/13/02

TIMES MICROWAVE SYSTEMS
 Wallingford, CT 06492
 (203) 949-8400; (203) 949-8423.Fax
 www.timesmicrowave.com

TC-600-LCM-PL
 Type-LC male plug
 for LMR-600-LLPL Cable

Size A	CAGE CODE 68999	Drawing No.: 3190-1221
Scale: NA	Rev. (-)	Sheet: 1 of 1