

THIS DRAWING IS A CONTROLLED DOCUMENT FOR AMP INC. IT IS SUBJECT TO CHANGE AND THE USER IS ADVISED TO CHECK THE DRAWING BEING CONTACTED FOR THE LATEST REVISION.

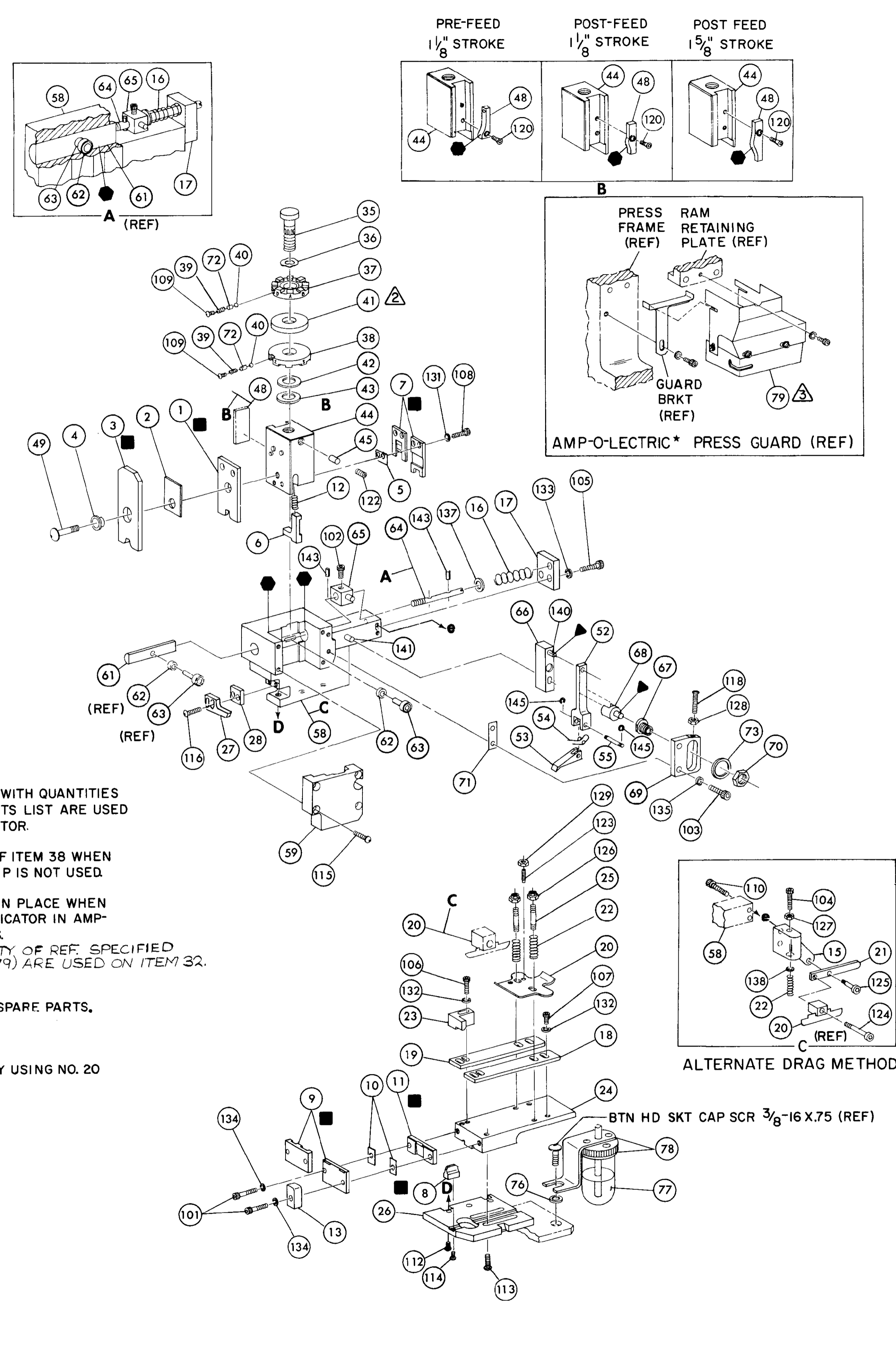

- NOTES:**
- 1. ONLY THE ITEMS WITH QUANTITIES SPECIFIED ON PARTS LIST ARE USED ON THIS APPLICATOR.
 - 2. USED IN PLACE OF ITEM 38 WHEN INSULATION CRIMP IS NOT USED.
 - 3. GUARD MUST BE IN PLACE WHEN OPERATING APPLICATOR IN AMP-O-LECTRIC PRESS.
 - 4. PARTS WITH QTY OF REF. SPECIFIED (EXCEPT ITEM 79) ARE USED ON ITEM 32.
- KEY:**
- RECOMMENDED SPARE PARTS.
 - ▲ LUBRICATE DAILY USING NO. 20 MACHINE OIL.
 - GREASE LIGHTLY.

REF.	QTY	PART NO	DESCRIPTION	ITEM NO
REF.	145	21045-3	RING, RETAINING 'C' (.187 DIA) FEED PIN	59
REF.	144	454220-1	CAP, RAM	58
REF.	143	5-21028-1	PIN, SLOT SPG (.12 DIA X .50) FD ADJ ROD	57
REF.	142			56
REF.	141	1-21030-7	PIN, DOWEL (.187 DIA X 1.50) HOUSING	55
REF.	140	1-21030-1	PIN, DOWEL (.187 DIA X .50) LEVER	54
REF.	139	REF. 240624-1	PIN, FEED FINGER	53
REF.	138	REF. 691499-1	SPRING, FEED FINGER	52
REF.	137	REF. 240635-1	FINGER, FEED	51
REF.	136	REF. 240634-1	LEVER, TERMINAL	50
REF.	135	7-21002-9	WASHER, FLAT (NO 6) DRAG SPRING	49
REF.	134	1 690602-5	WASHER, FLAT (5/16 DIA) SCR ADJ	48
REF.	133			47
REF.	132			46
REF.	131	1 690191-1	WASHER, LOCK (NO 10) FEED ADJ PLATE	45
REF.	130	1 455674-1	WASHER, LOCK (NO 10) SHEAR PLATES	44
REF.	129	1 690125-1	WASHER, LOCK (NO 10) FEED ROD GUIDE	43
REF.	128	1 690124-1	WASHER, LOCK (NO 8) STRIP GUIDE	42
REF.	127		WASHER, LOCK (NO 8) SHEAR BLADE	41
REF.	126	2 23241-6	NUT, HEX MACH (4-40) DRAG	40
REF.	125	2 690170-1	NUT, HEX MACH (6-32) FD ADJ PLATE	39
REF.	124	1 690142-1	NUT, HEX MACH (10-32) DRAG SPRING	38
REF.	123	1 9-690692-9	NUT, HEX SELF-LKG (8-32) DRAG STUD	37
REF.	122	1 22480-5	SCR, SKT HD SHLD (250 DIA X .25) DRAG ARM	36
REF.	121	1 690212-1	SCR, SKT HD SHLD (250 DIA X 1.00) DRAG	35
REF.	120		SCR, SKT SET OVAL POINT (4-40 X .75) DRAG	34
REF.	119		SCR, SKT SET (1/4-20 X 25) (LOC-WEL) RAM	33
REF.	118	1 458980-1	SCR, BTN HD SKT CAP (6-32 X .38) CAM	32
REF.	117		SCR, RD HD MACH (6-32 X 1.50) FEED ADJ	31
REF.	116	2 2-21002-2	SCR, BTN HD SKT CAP (8-32 X .50) STRIPPER	30
REF.	115	2 2-21002-9	SCR, BTN HD SKT CAP (10-32 X .75) HSG CAP	29
REF.	114	1 22733-8	SCR, BTN HD SKT CAP (8-32 X .38) (LOC-WEL) ANVIL	28
REF.	113	4 3-21002-3	SCR, BTN HD SKT CAP (1/4-20 X .50) STR GDE PL	27
REF.	112	REF. 2-22733-9	SCR, BTN HD SKT CAP (1/4-20 X .75) BASE PL	26
REF.	111		SCR, SKT HD CAP (6-32 X 1.00) DRAG ADAPTOR	25
REF.	110	2 23030-1	SCR, SKT HD CAP (6-32 X .25) (LOC-WEL) CP DISC	24
REF.	109	2 2-21000-6	SCR, SKT HD CAP (8-32 X .38) SHEAR BLADE	23
REF.	108	3 7-21000-4	SCR, SKT HD CAP (8-32 X .31) STRIP GUIDE	22
REF.	107	2 2-21000-8	SCR, SKT HD CAP (8-32 X .62) STRIP GUIDE	21
REF.	106	1 2-21000-7	SCR, SKT HD CAP (10-32 X .75) FD ROD GUIDE	20
REF.	105	1 3-21000-9	SCR, SKT HD CAP (10-32 X 1.00) DRAG SPRING	19
REF.	104	1 3-21000-6	SCR, SKT HD CAP (10-32 X .62) FD ADJ PLATE	18
REF.	103	REF. 3-21000-4	SCR, SKT HD CAP (10-32 X .38) PIVOT BLK	17
REF.	102	REF. 3-21000-8	SCR, SKT HD CAP (10-32 X .88) SHEAR PLATE	16
REF.	101	REF. 455745-1	SCR, SKT HD CAP (10-32 X .75) PIVOT BLK	15
REF.	79		GUARD, WINDOW	14
REF.	78	465184-9	LUBRICATOR ASSY	13
REF.	77	455985-1	LUBRICATING	12
REF.	76	454406-1	OIL, LUBRICATING	11
REF.	75		SPACER, LUB BRACKET	10
REF.	74	1 3-690482-4	SPACER, HOLD DOWN	9
REF.	73	1 7-240655-8	SPRING, HOLD DOWN	8
REF.	72	1 690474-6	PLATE, REAR SHEAR	7
REF.	71	1 1-455892-9	SPACER, SHEAR PLATE	6
REF.	70	1 4-240641-8	PLATE, FRONT SHEAR	5
REF.	69	1 238009-1	ANVIL	4
REF.	68	1 1-456134-4	BLADE, SLUG	3
REF.	67	1 455888-7	HOLD DOWN, TERMINAL	2
REF.	66	1 1-456404-8	SPACER, SHEAR BLADE	1
REF.	65		SPACER, TUBULAR	
REF.	64		CRIMPER, INSULATION	
REF.	63		CRIMPER, INSULATION	
REF.	62		CRIMPER, WIRE	
REF.	61		CRIMPER, WIRE	
REF.	60		CRIMPER, WIRE	

QTY	PART NO	DESCRIPTION	ITEM NO
REF.	458109-1	WASHER, FLAT (SPECIAL)	74
REF.	690603-1	SPRING, ASSIST	73
REF.	690517-1	SPACER	72
REF.	22594-8	NUT, HEX	71
REF.	240628-1	PLATE, ADJ	70
REF.	240626-1	SHAFT, PIVOT	69
REF.	240633-1	BUSHING	68
REF.	455680-1	LEVER, INTERMEDIATE	67
REF.	240629-1	BLOCK, PIVOT	66
REF.	240632-2	SCREW, ADJ	65
REF.	240659-3	PIN, CAM ROLLER	64
REF.	240658-1	CAM, ROLLER	63
REF.	454398-1	ROD, FEED	62

CRIMPING DATA				APPLICATOR WILL APPLY	
PAD LTR	CRIMP HEIGHT	WIRE SIZE	WIRE STRIP LENGTH		
A	.053	18			36068
B	.047	20			62886
C	.044	22			63021
D	NOT USED				

CRIMP	SIZE	TYPE	FEED	APPL INST
WIRE	.070	"F"		
INSUL	.140	"F"	.705	A1 8039
WIRE RANGE	18			
INSULATION RANGE	.090-.130			
PRESS NO				565435-5

REMARKS	NO	REV
APPL USED ON MACHINE PART NO	MACH SERIAL NO	DISTRIBUTION
CUSTOMER NAME	APPL SERIAL NO	ORIGINAL
ADDRESS	PURCHASE ORDER	CUSTOMER COPY
CITY	ENG APP	FIELD ENG COPY

REVISION RECORD	APP DATE	REVISION RECORD	APP DATE
E1	015A-0485-99	JM	11-09
E	0150-6015-96	WJ	05-98
D	0150-6015-96	WJ	05-98
C	REV PER ECU R-5503	JM	11-04
B	REV PER ECU R-3858	JM	02-93
A	REV PER ECU R-3499	JM	11-90
A	REV PER ECU R-3341	JM	12-89