

REVISIONS					
P	LTR	DESCRIPTION	DATE	OWN	APVD
J2		ECO-20-004921	13APR2020	RR	SH

03FEB10 KK HMR

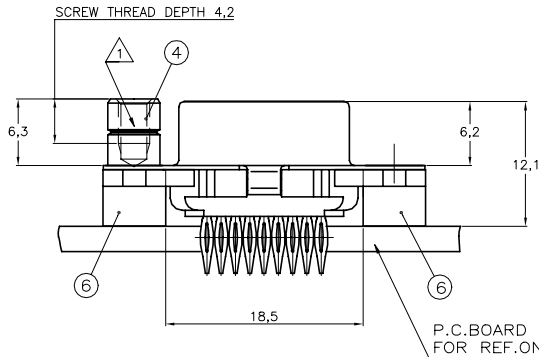
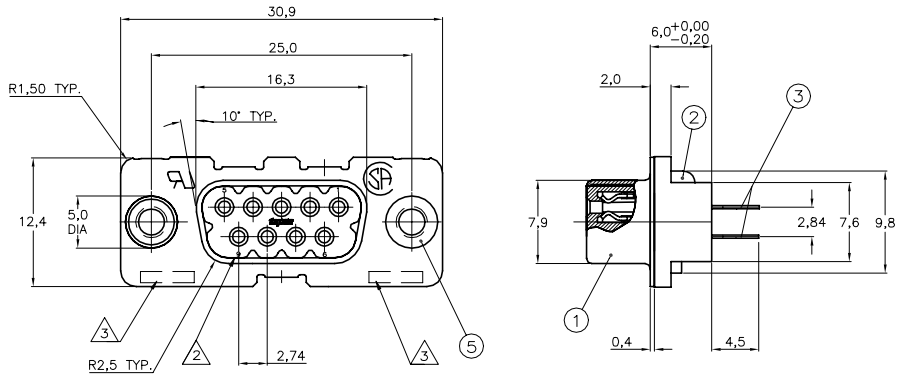

P.C.B. HOLE DIM. FOR CONTACTS	
DRILLED HOLE	: 1,15 ±0,025 mm
FIN. HOLE	: 0,94 to 1,09 mm
AFTER REFLOW	: 0,91 to 1,09 mm
Cu-thks	: 0,025 to 0,075 mm
SnPb-thks	: 0,004 to 0,010 mm

6 OBSOLETE PARTS: OBSOLETE CIS STREAMLINING PER D.RENAUD/D.SINISI

RECOMMENDED P.C. BOARD HOLE-LAYOUT

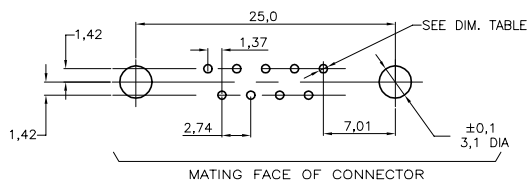

ACCESSORIES PREFIX "Z"	ITEM NO	DESCRIPTION OF ACCESSORY	2	3	4
5		BUSHING WITH THROUGH HOLE 3,1 DIA.	2	2	2
5		BUSHING WITH THREAD 4-40 UNC	2	2	2
5		BUSHING WITH THREAD M3	2	2	2
4		FEMALE SCREWLOCK WITH 4-40 UNC	2	2	2
4		FEMALE SCREWLOCK WITH M3	2	2	2

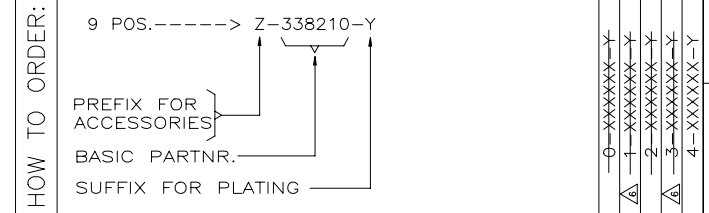

PLATING SUFFIX "Y"

GOLD OVER NICKEL AS PER PERFORMANCE LEVEL 2 (DIN 41652)
PRESS-FIT PART: TIN-PLATING 3µm } -Y = -2

- NOTES :
- △ GROOVE INDICATES VERSION WITH 4-40 UNC INNER THREAD; WITHOUT GROOVE INDICATES VERSION WITH M3 INNER THREAD.
 - △ CAVITY IDENTIFICATION AT FRONT SIDE ONLY.
 - △ PARTNUMBER AND DATE CODE.
 - 4 CONNECTOR CAN BE USED FOR PCB THICKNESS OF 1,6 mm MINIMUM AND THICKER.
 - 5 AIR AND CREEPAGE DISTANCES ACCORDING TO DIN 41652.

- ITEM NRS./MATERIAL :
- 1 SHELL = BRIGHT TINPLATED STEEL
 - 2 HOUSING = GLASSFILLED POLYESTER, COLOR : BLACK
 - 3 CONTACTS = PHOSPHORBRONZE (PLATING : SEE TABLE ABOVE)
 - 4 FEMALE SCREWLOCK = TINPLATED STEEL (INNER THREAD 4-40 UNC OR M3)
 - 5 BUSHING = TINPLATED STEEL (INNER THREAD 4-40 UNC OR M3 OR 3,1 DIA. THROUGH HOLE)
 - 6 STAND OFF = MAT: ULTRAMID V0 COLOR BLACK.

THIS DRAWING IS A CONTROLLED DOCUMENT.		OWN: D. KESSLER 25FEB99		TE Connectivity	
DIMENSIONS: mm		CHK: W. SOOMERS 24AUG00		NAME: HDP-20 SIZE 1 VERTICAL+ RECEPTACLE HEADER; PRESS-FITVERSION	
TOLERANCES UNLESS OTHERWISE SPECIFIED:		APVD: -	RESTRICTED TO: -		
0 PLC ± -		PRODUCT SPEC: -	SIZE: A2		
1 PLC ± -		APPLICATION SPEC: -	CAGE CODE: 00779		
2 PLC ± -		WEIGHT: 0,000000	DRAWING NO: 338210		
3 PLC ± -		CUSTOMER DRAWING	SCALE: - SHEET: 1 of 1 REV: J2		
4 PLC ± -					
ANGLES ± -					