

LTR	EN	DESCRIPTION	APPR	BY	DATE
A	-	INITIAL RELEASE	RB	EM	2-04-04

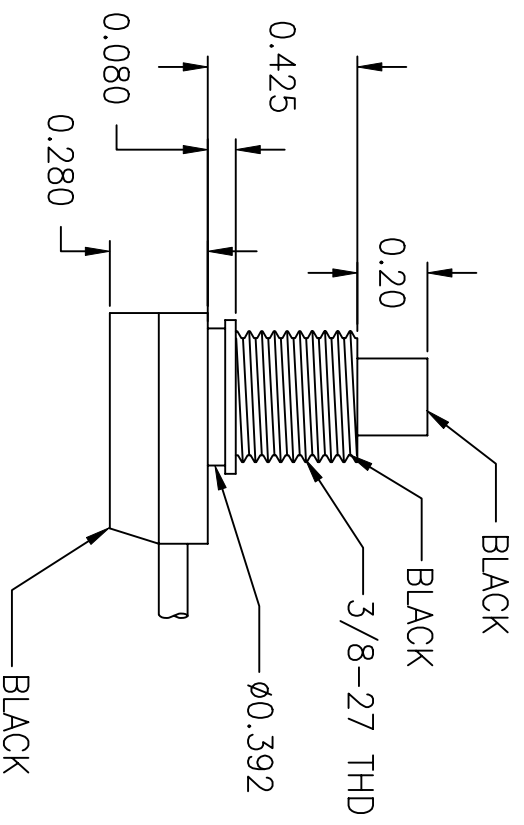
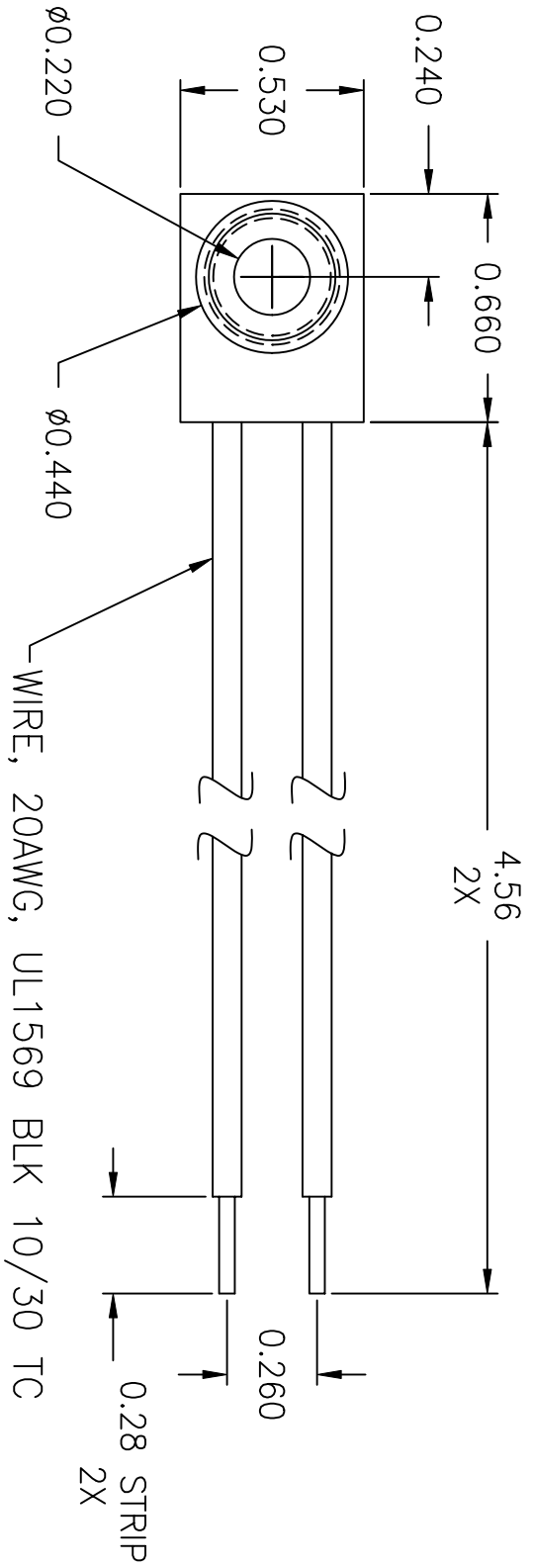

JUDCO INVENTORY NO. 40-2385-01
 SWITCH TYPE: PUSH ON-PUSH OFF, SPST
 NUTS PACKED SEPARATELY

CUSTOMER: DIGI KEY
 CUST. PN: 504 PB-ND
 APPROVED: _____
 DATE: _____

DIMENSIONS IN INCHES
 DIMENSIONS ARE REFERENCE

DRAWN: EM 02-04-04
 APPR: KJ 02-04-04

1415US562A.DWG

HARBOR CITY CALIFORNIA
 TITLE: OUTLINE
 J-188A-1

DWG. NO. 1415-562
 SHEET 1 OF 1

This document embodies a product, component, and/or design proprietary to JUDCO MANUFACTURING INC., and which is protected either as a trade secret, by U.S. Patent, or by copyright. It may not be used in any way without written express consent of JUDCO MANUFACTURING INC.