

REVISIONS			
REV	DESCRIPTION, ECN, EAR NO.	DATE	APP'D
A	PROPOSAL	06/03/01	L.CHAN
B	CORRECT THE DRAWING	DEC05/22	KELVIN

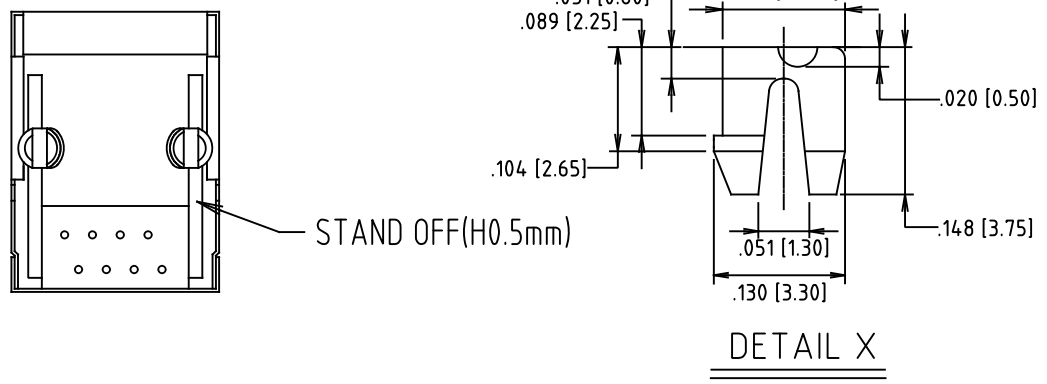
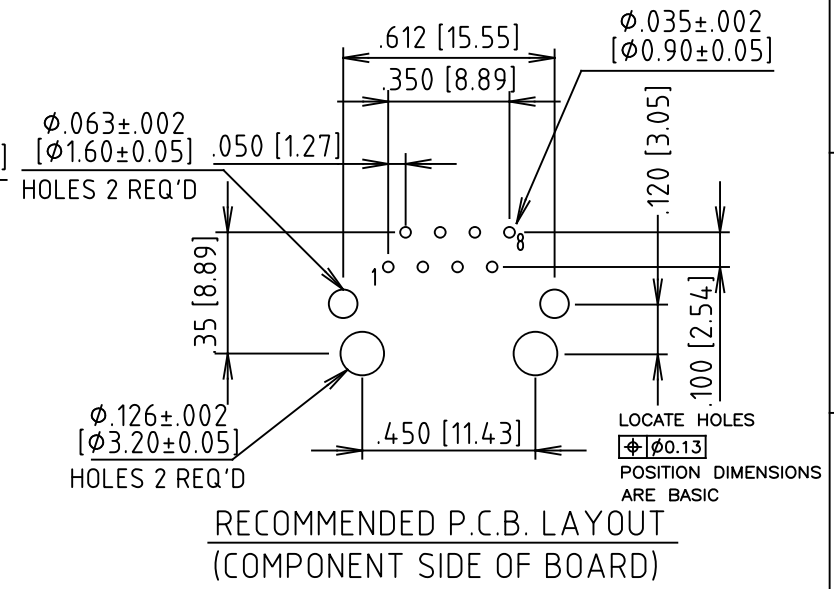
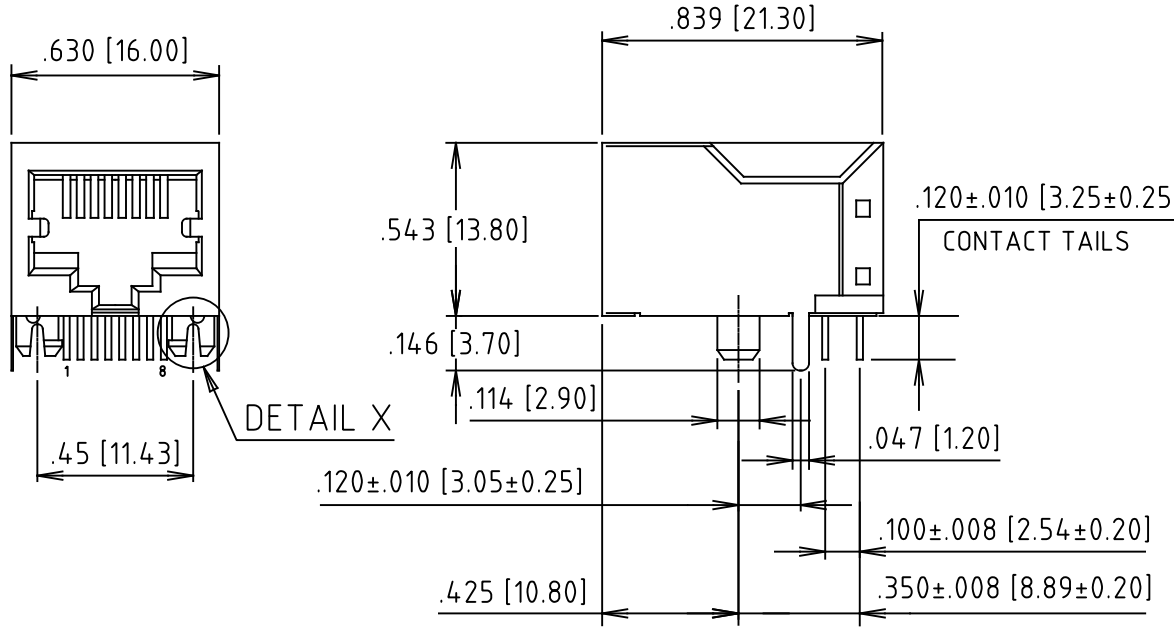

MATERIALS:
 PLASTIC HOUSING: HIGH TEMPERATURE THERMOPLASTIC
 FLAMMABILITY RATING UL94V-0, COLOR: BLACK

CONTACTS:
 PHOSPHOR BRONZE
 PLATING: REFER TO PART NUMBER
 FOR GOLD THICKNESS ON MATING SURFACES.
 50μ" [1.27 MICRONS] MIN. NICKEL UNDERPLATE.
 GOLD FLASH ON CONTACT TAILS.

SHIELD:
 COPPER ALLOY
 PLATING: NICKEL

RECOMMENDED SOLDERING TEMPERATURE:
 WAVE SOLDERING AT 260°C MAXIMUM FOR 5 TO 8 SECONDS,
 OR REFLOW SOLDERING AT 260°C MAXIMUM FOR 10 SECONDS MAXIMUM.

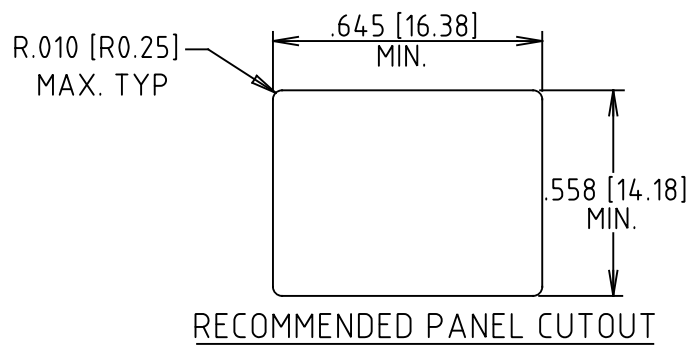

PART NUMBER: RJE09-188-1X10-H

GOLD PLATING
 1 = 6 MICRINCH
 2 = 15 MICRINCH
 3 = 30 MICRINCH
 4 = 50 MICRINCH

UNLESS SPECIFIED OTHERWISE	DRAWN PAULW	06/03/01	Amphenol Canada Corp. Commercial Products
PRIMARY UNITS INCHES	CHECKED CHIGOW	06/03/01	
SECONDARY MILLIMETERS	M.E. APP'D		RJE09 SERIES MODULAR JACK, 8 POSITION, 8 CONTACTS, WITH HIGH TEMP. MATERIAL WITH SHIELD - RoHS COMPLIANT
REFERENCE IN PARENTHESES	Q.A. APP'D		
GENERAL TOLERANCES	DWG APP'D		DWG NO. P-RJE09-188-1X10-H
1 DECIMAL PLACE ±0.025	ENG. REL. NO.		
2 DECIMAL PLACES ±0.020	REF.		REV B
3 DECIMAL PLACES ±0.015			
ANGULAR DEGREES ±1°	THIRD ANGLE PROJECTION	DO NOT SCALE DRAWING	CODE ID NO. 03554 DWG SIZE X SCALE N/A SHEET 1 OF 1