

REVISIONS			
REV	DESCRIPTION, ECN, EAR NO.	DATE	APP'D
C	PROPOSAL	AUG 01/05	L.CHAN
D	UPDATE DRAWINGS	MAY 23/17	L.CHAN

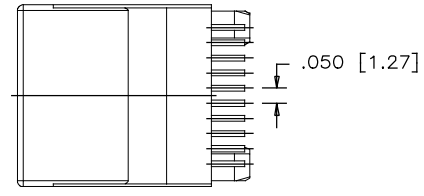

TOP VIEW

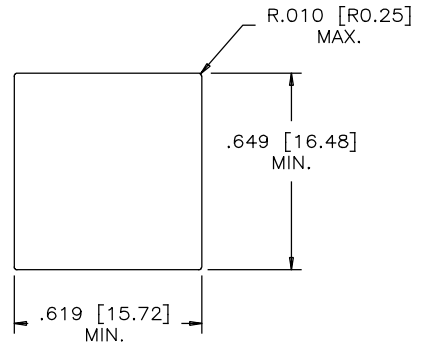

RECOMMENDED PANEL CUTOUT

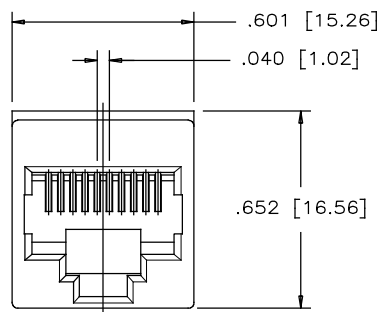

FRONT VIEW

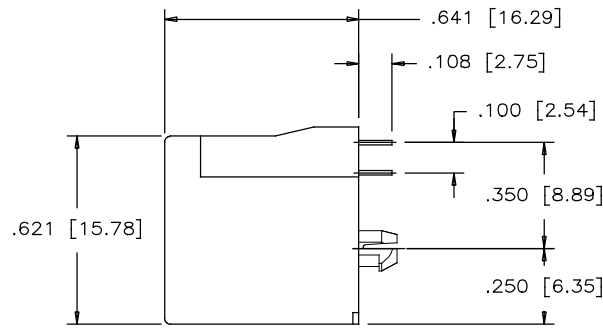

SIDE VIEW

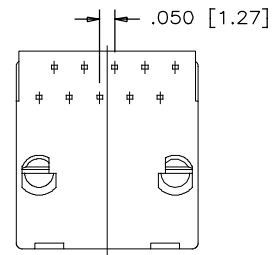

BACK VIEW

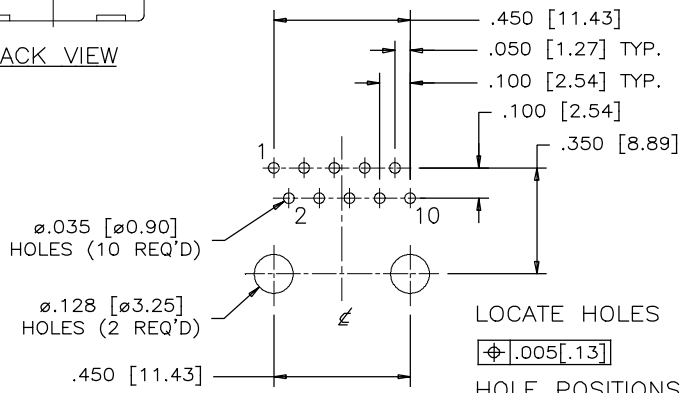

LOCATE HOLES
 $\phi .005 [.13]$
 HOLE POSITIONS ARE BASIC

RECOMMENDED P.C.B. LAYOUT
 (COMPONENT SIDE OF BOARD)
 TOLERANCE: ± 0.05 (TOP VIEW)

MATERIALS:

HOUSING: ENGINEERING THERMOPLASTIC
 FLAMMABILITY RATING UL 94V-0
 COLOUR: BLACK.

CONTACTS: PHOSPHOR BRONZE

PLATING: SELECTIVE GOLD PLATING ON MATING SURFACES
 SEE AMPHENOL PART NUMBER FOR DETAIL.
 50U" MIN. NICKEL OVERALL
 GOLD FLASH ON CONTACT TAILS.

RECOMMENDED SOLDERING TEMPERATURE:
 WAVE SOLDERING AT 260°C MAXIMUM FOR 5 SEC MAXIMUM.

AMPHENOL PART NO: RJE08-1AA-0X10

GOLD PLATING:
 1 = 6 μ "
 2 = 15 μ "
 3 = 30 μ "
 4 = 50 μ "



UNLESS SPECIFIED OTHERWISE	DRAWN PAUL WANG	DATE MAR04/05
PRIMARY UNITS INCH	CHECKED L.CHAN	MAR04/05
SECONDARY MILLIMETER	M.E. APP'D	
REFERENCE IN PARENTHESES	Q.A. APP'D	
GENERAL TOLERANCES	DWG APPR.	
1 DECIMAL PLACE ± 0.025	ENG. REL. NO.	
2 DECIMAL PLACES ± 0.020	REF.	
3 DECIMAL PLACES ± 0.015	THIRD ANGLE PROJECTION	DO NOT SCALE DRAWING
ANGULAR DEGREES $\pm 1.0^\circ$		

Amphenol Canada Corp. www.amphenolcanada.com	
TITLE RJ45 CONNECTOR, TOP ENTRY 10P 10C, P.C.B. MOUNT, WITHOUT SHIELD-ROHS COMPLIANT	
DWG. NO.	REV
P-RJE08-1AA-0X10	D
CODE ID NO. 03554	SCALE: N/A
DWG SIZE: C	SHEET 1 OF 1