

Verpackt in Gurtverpackung - Tape on Reel Packaging
 Verpackungseinheit: 220 Stück - Packaging unit: 220 pcs

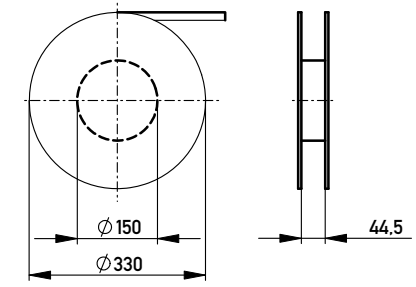

Abspulrichtung - Reel off Direction

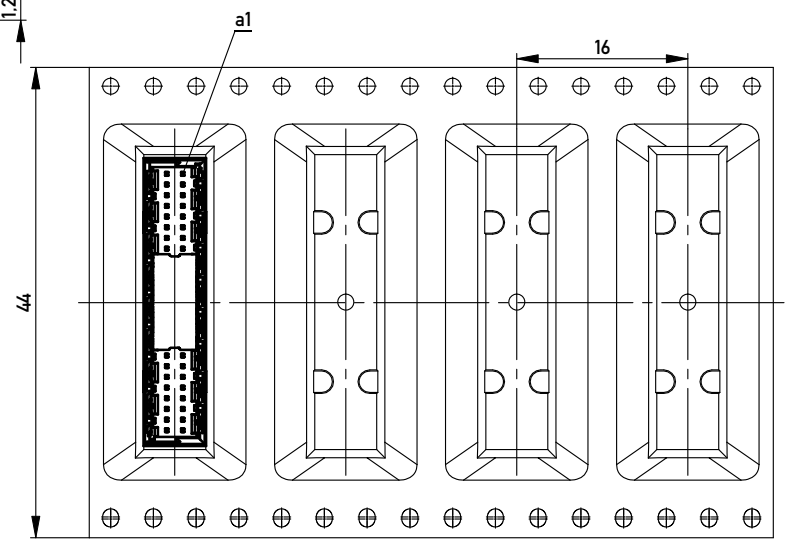

Anforderungsstufe 1
 Performance Level 1

Kontaktbereich vergoldet
 Mating Area gold plating

Anschlussbereich verzinkt 4-6 µm
 Terminal Area 4-6 µm tin plating

Koplanarität der Anschlüsse ≤ 0,1 mm
 Coplanarity Area of Termination ≤ 0,1 mm

Leiterplatten-Layout Vorschlag / PCB-Layout Proposal

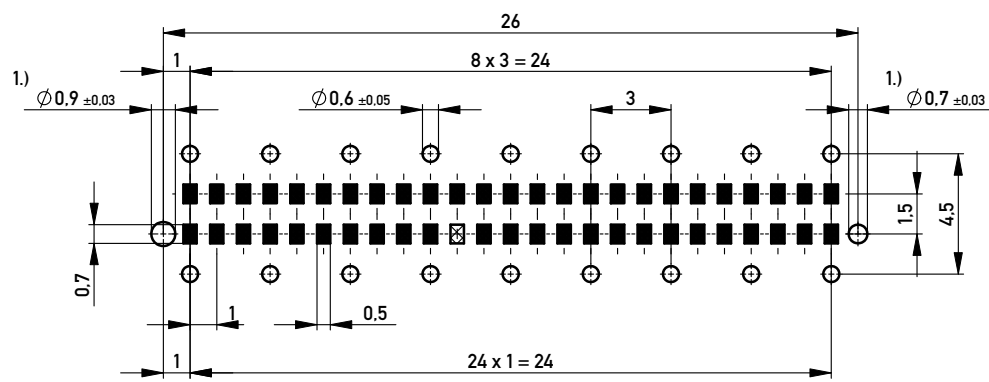

1.) Durchmesser des Bohrers / Drill tool

Information: All rights reserved. Only for Information. To ensure that this is the latest version of this drawing, please contact one of the ERNI companies before using.	Tolerances All Dimensions in mm	Scale 5:1	
		Designation Messerleiste 10mm THR, 50 polig Male 10mm THR, 50 contacts	
www.ERNI.com	224562		1 A3
g Index	29.09.2010 Date	Class MSPEED	

Copyright by ERNI GmbH
 Proprietary notice pursuant to ISO 16016 to be observed.