

PRODUCT NUMBER

77316-YXXLF

RoHS COMPATIBLE
SEE NOTE 7

PIN STYLE SEE SHEET 2

PLATING SEE SHEET 2

TOP VIEW

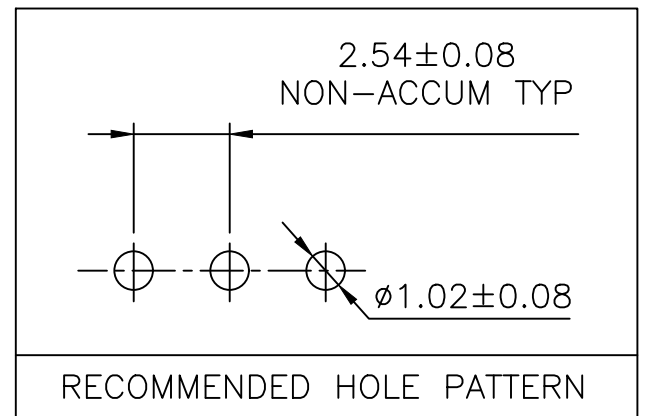
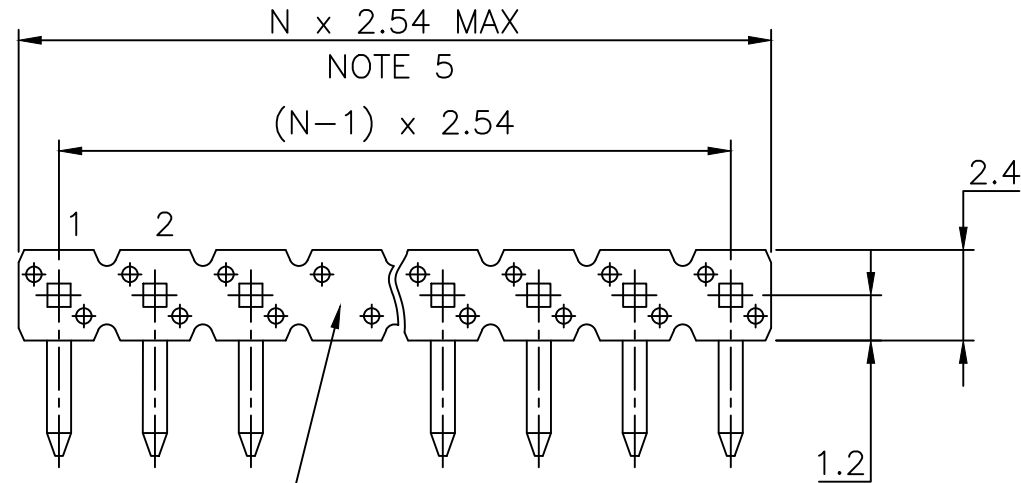

NOTES:

1. HOUSING MAT'L : HIGH TEMPERATURE THERMOPLASTIC. UL94V-0 COLOR: BLACK
2. PIN MATERIAL : PHOSPHOR BRONZE
3. PRODUCT PACKAGED IN POLY BAGS.
4. 9N MIN RETENTION IN EITHER DIRECTION
5. TO DETERMINE DIMENSIONS :
N = NUMBER OF POSITIONS PER ROW
EXAMPLE : 8 POS N x 2.54 = 20.32mm
6. UNDERPLATING : 1.27µm Ni MIN
7. RoHS COMPATIBLE PRODUCT SPECIFICATIONS
 - a - PLATING:
 - "LF" MEANS THE PRODUCT IS LEAD-FREE, 2µm MINIMUM MATTE TIN OVER 1.27µm MINIMUM NICKEL UNDERPLATE.
 - b - MANUFACTURING PROCESS COMPATIBILITY
 - THE HOUSING WILL WITHSTAND EXPOSURE TO 260°C ±5°C SOLDER BATH TEMPERATURE FOR 5 SECONDS IN A WAVE SOLDER APPLICATION WITH A 1.6mm MIN THICK CIRCUIT BOARD.
 - c - LABELING:
 - MEETS PACKAGING SPECS AS PER GS-14-920
 - d - LEGAL STATEMENT: SEE GS-47-0004

EXAMPLE OF MISSING PIN

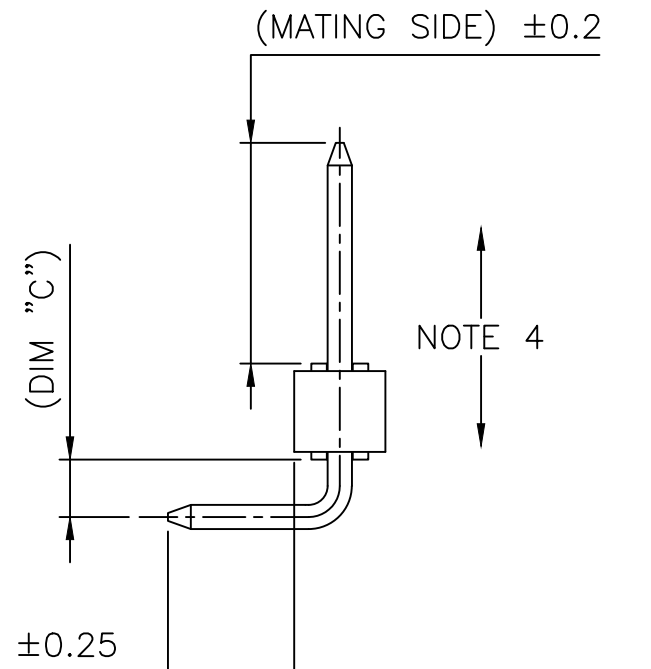
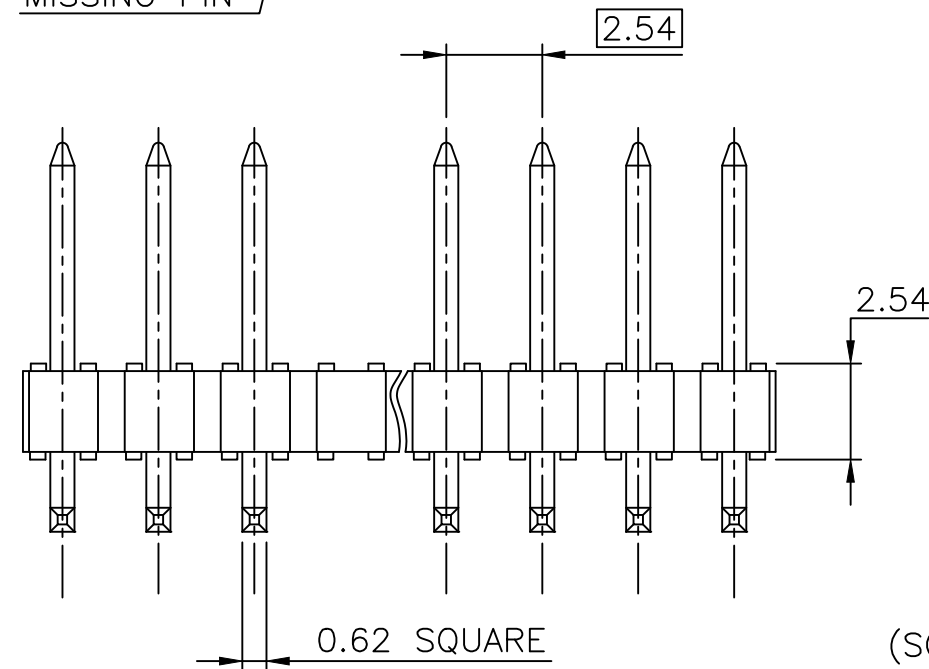

mat'l. code SEE P/N		surface ISO 1302 ✓		tolerance ISO 406 ISO 1101		projection mm		product family BERGSTIK			
ltr		ecn no		dr		date		tolerances unless otherwise specified		title UNSHR.HEADER RA SR TMT POL	
AP		B-26203		JCA		17.02.28		angles linear		.X ±0.3	
AR		F-28530		LMU		17.10.24				.XX ±0.15	
AS		F-47092		DDE		23.01.23				.XXX ±0.05	
						dr		O. MATHEVON		96.04.09	
						engr		COMPAGNON J		96.04.09	
						chr		COMPAGNON J		96.04.09	
						appd		JMC		96.04.09	
sheet index		revision sheet		AS W		AH B					
		1 2		3 4							
										sheet 1 of 4 size A3	
										77316	
										type CUSTOMER Drawing	

PIN STYLE	NB OF POS	PRODUCT DEFINITION			TOP VIEW OF HEADER SHOWING MISSING PIN POSITIONS							
		"MATING SIDE" ±0.2	"SOLDER SIDE" ±0.35	"C" REF	1	5	10	15	20	25	30	35
01	1x5	5.72	2.57	1.4								
02	1x6	5.72	2.57	1.4								
03	1x6	5.72	5.11	3.94								
04	1x21	5.72	3.45	1.4								
06	1x5	5.72	2.57	1.4								
07	1x3	5.72	3.45	1.4								
08	1x21	5.72	3.45	1.4								
10	1x13	5.72	3.45	1.4								
17	1x7	5.72	3.45	1.4								
18	1x10	5.72	3.45	1.4								
20	1x12	5.84	2.29	1.4								
21	1x12	5.72	2.57	1.4								
22	1x8	5.72	3.45	1.4								
23	1x6	5.72	3.45	1.4								
26	1x6	5.72	3.45	1.4								
27	1x6	5.72	3.45	1.4								
28	1x9	5.72	3.45	1.4								
29	1x4	5.72	3.45	1.4								
30	1x13	5.72	3.45	1.4								
31	1x7	5.72	3.45	1.4								
32	1x10	5.72	3.45	1.4								
33	1x9	5.72	3.45	1.4								
34	1x5	5.72	3.45	1.4								
35	1x15	5.72	2.57	1.4								

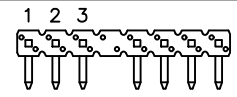

A

A

B

B

C

C

D

D



Copyright FCI

77316-GXXLF	0.76µm GXT FULL PLATED	
77316-9XXLF	0.2µm Au / GXT	2.0-7.5 Sn MATTE
77316-8XXLF	0.38µm Au/GXT	2.0-7.5 Sn MATTE
77316-5XXLF	0.25µm Au/GXT	2.0-7.5 Sn MATTE
77316-4XXLF	2.0-7.5 Sn MATTE	
77316-2XXLF	1.27µm Au	2.0-7.5 Sn MATTE
77316-1XXLF	0.76µm Au/GXT	2.0-7.5 Sn MATTE
PLATING CODE	CONTACT AREA	REMAINDER
	PLATING THICKNESS OVER 1.27µm Ni	

ONLY AVAILABLE UPON REQUEST

mat'l. code		surface		tolerance		projection		product family	
		ISO 1302		ISO 406 ISO 1101				BERGSTIK	
ltr		ecn no		dr		date		title	
R		F06-0207		LMU		06.07.27		UNSHR.HEADER	
S		F08-0148		RTR		08.03.31		RA SR TMT POL	
T		F11-0052		LMU		11.04.22		scale N/A	
U		B-18916		LMU		14.09.29		dwg no	
V		F-24542		AMA		16.07.20		sheet 2 of	
W		F-47092		DDE		23.01.23		size	
				app		JMC		77316	
								A3	
								type	
								CUSTOMER Drawing	
sheet index		revision sheet							



PIN STYLE	NB OF POS	PRODUCT DEFINITION			TOP VIEW OF HEADER SHOWING MISSING PIN POSITIONS									
		"MATING SIDE" ±0.2	"SOLDER SIDE" ±0.35	"C" REF	1	5	10	15	20	25	30	35		
36	1x08	3.05	5.00	1.4										
37	1x04	6.75	2.85	1.4										
38	1x09	5.72	2.54	1.4										
39	1x09	5.72	2.54	1.4										
40	1x36	5.72	2.57	1.4										
41	1x05	5.72	3.45	1.4										
42	1x03	5.72	3.45	1.4										
43	1x12	3.10	4.00	1.4										
44	1x07	5.00	4.00	1.4										
45	1x05	14.20	3.20	1.4										
46	1x11	6.75	2.85	1.4										
47	1x18	5.72	2.57	1.4										
48	1x03	11.70	2.80	1.5										
49	1x05	10.00	3.45	1.5										
50	1x07	5.72	3.45	1.4										
51	1x13	5.84	3.05	1.4										
52	1x09	10.00	3.45	1.5										
53	1x16	2.54	4.70	1.5										
54	1x05	3.05	2.52	7.61										
55	1x16	5.84	7.37	1.52										
56	1x10	5.84	7.37	1.52										
57	1x17	2.54	4.70	1.5										
58	1x07	8.08	3.05	1.5										
59	1x05	17.00	3.00	1.52										
60	1x03	3.50	3.05	1.52										
61	1x11	3.50	3.05	1.52										
62	1x03	14.50	5.00	1.52										

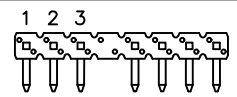

SEE NOTE 1

NOTES :
 1. FOR PIN STYLE 62 ONLY, PIN MATERIAL USED IS CuFe2P

mat'l. code		surface ISO 1302 <input checked="" type="checkbox"/>		tolerance ISO 406 ISO 1101		projection 		product family BERGSTIK	
ltr	ecn no	dr	date	tolerances unless otherwise specified		mm		title UNSHR.HEADER RA SR TMT POL	
AG	F-25362	DDE	16.11.16	angles	linear	scale N/A		dwg no 77316	
AH	B-26203	JCA	17.02.28					sheet 3 of A3	
AC	B-17992	LMU	14.06.18	dr	O. MATHEVON	96.04.09		type CUSTOMER Drawing	
AD	B-19156	LMU	14.10.22	engr	COMPAGNON J	96.04.09			
AE	F-24542	AMA	16.07.20	chr	COMPAGNON J	96.04.09			
AF	F-25333	DDE	16.11.15	app	JMC	96.04.09			
sheet	revision								
index	sheet								



FCIconnect.com

Copyright FCI

PIN STYLE	NB OF POS	PRODUCT DEFINITION			TOP VIEW OF HEADER SHOWING MISSING PIN POSITIONS	
		"MATING SIDE" ±0.2	"SOLDER SIDE" ±0.35	"C" REF	1 2 3	
63	1x07	5.72	5.11	3.9		
64	1x22	5.72	3.05	1.5		
65	1x20	5.72	3.05	1.5		
66	1x05	3.10	3.10	1.5		
67	1x05	20.00	3.05	1.85		
68	1x08	3.50	3.05	1.52		

A

A

B

B

C

C

D

D



Copyright FCI

mat'l. code		surface ISO 1302 <input checked="" type="checkbox"/> ISO 406 <input type="checkbox"/> ISO 1101 <input type="checkbox"/>		tolerance tolerances unless otherwise specified		projection 		product family BERGSTIK	
ltr	ecn no	dr	date	angles		mm		title UNSHR.HEADER RA SR TMT POL	
A	F-28530	LMU	17.10.24	linear		scale N/A		dwg no 77316	
B	F-47092	DDE	23.01.23					sheet 4 of A3	
				dr	L.MULIN	17.10.24			type CUSTOMER Drawing
				engr	L.MULIN	17.10.24			
				chr					
				app	A.SOUDY	17.10.24			
sheet index	revision sheet								