

PRODUCT PARTNUMBER
10149641-XXXXX0LF

PARTNO &
DATECODE

#AI IDENTIFIER

(0.30)

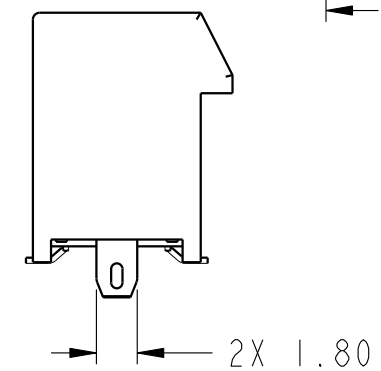
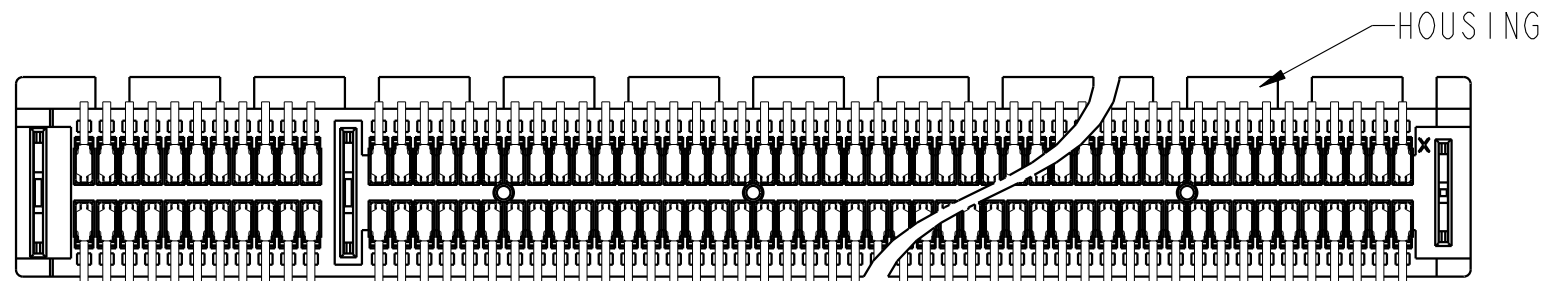
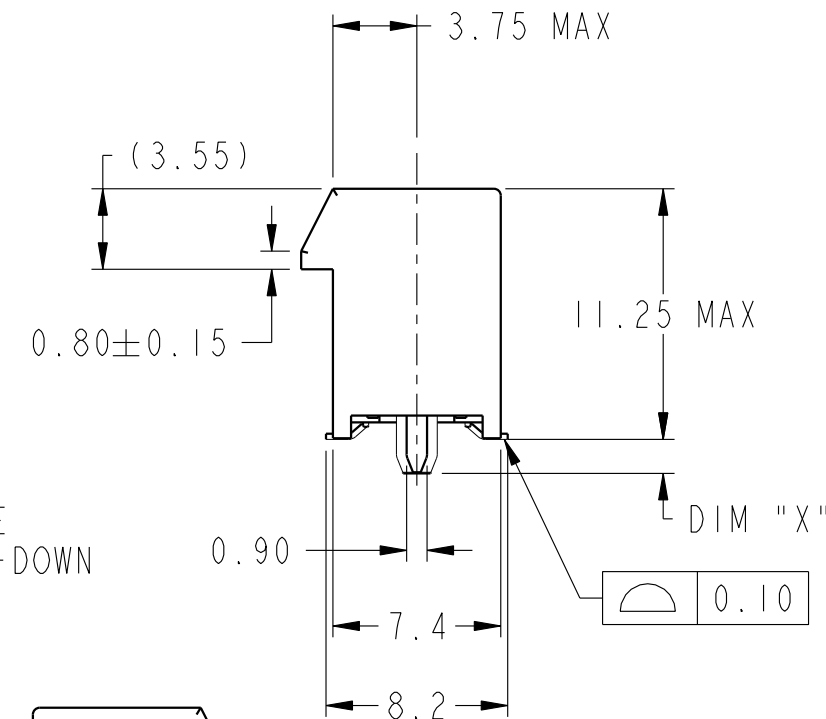
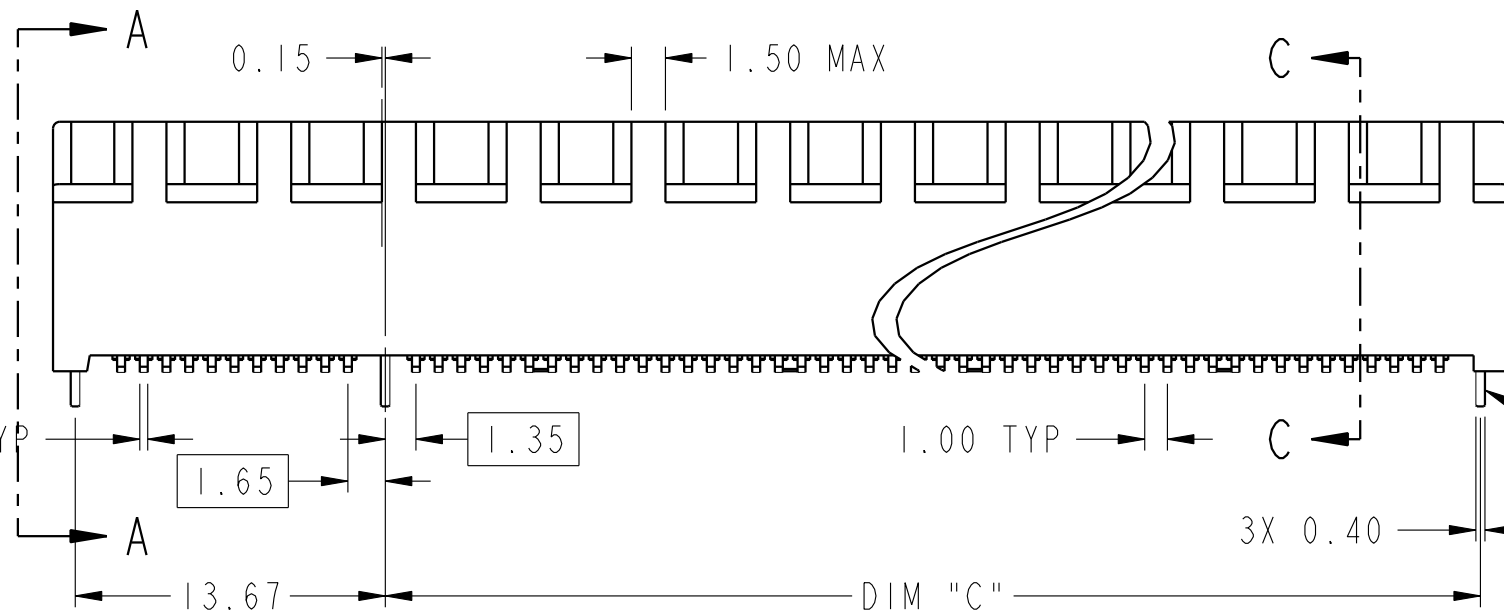
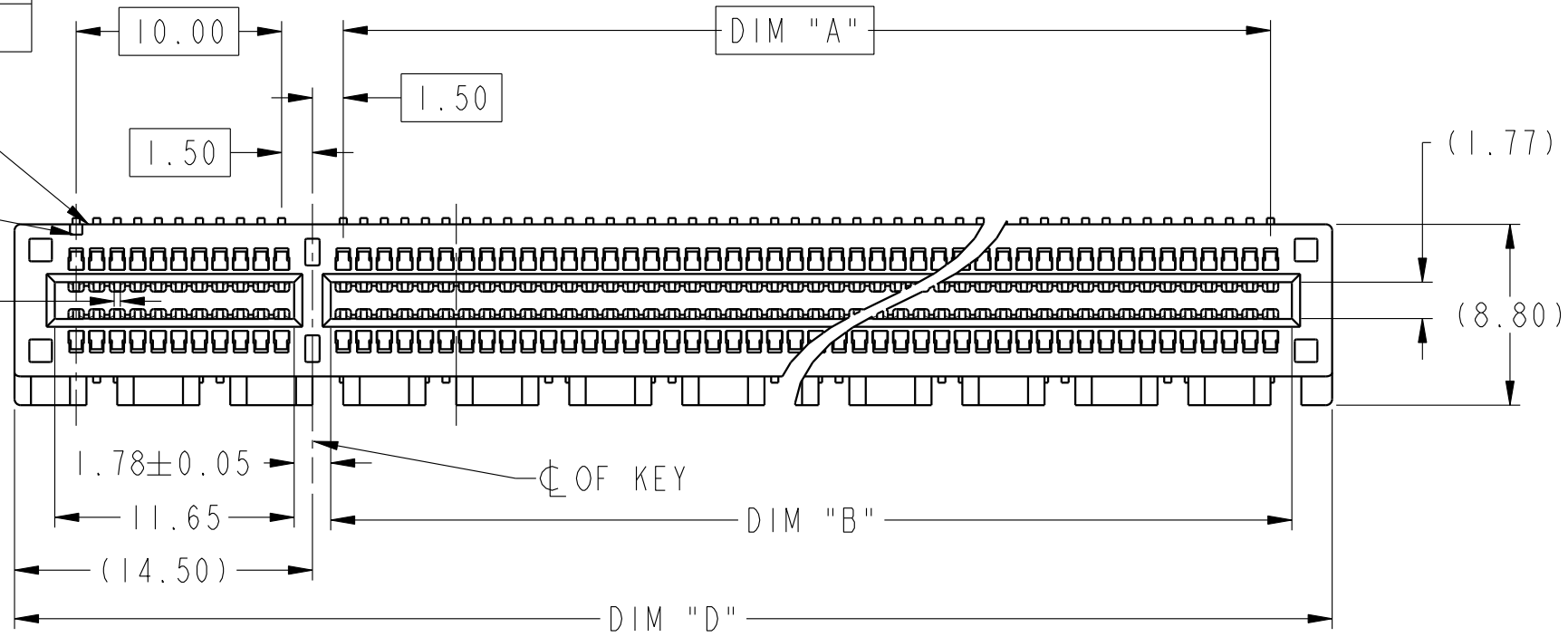

SECTION A-A
SCALE 3:1

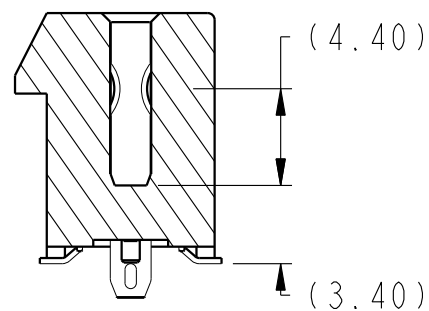

SECTION C-C
SCALE 3:1

spec ref	-	dr	Cheong, Matthe	2019/01/21
tolerance std	ISO 406 ISO 1101	eng	Cheong, Matthe	2020/06/23
	TOLERANCES UNLESS OTHERWISE SPECIFIED	chr	-	-
surface		appr	Koon-Poh Tay	2020/06/23
	linear	0.X	±0.30	
		0.XX	±0.20	
		0.XXX	±0.1	
	angular	0°	±2°	

Amphenol FCI

www.fci.com

projection	MM	size	A3	scale	3:1
product family	PCI express	ecn no	-	rel level	Released
part no	PCI Express 4.0	dwg no	10149641	rev	A
cat. no.	SMT Type- CUST SP BLADE	Product - Customer Drw	sheet 1 of 4		

projection	MM	size	A3	scale	3:1
product family	PCI express	ecn no	-	rel level	Released
part no	PCI Express 4.0	dwg no	10149641	rev	A
cat. no.	SMT Type- CUST SP BLADE	Product - Customer Drw	sheet 1 of 4		

CONNECTOR LINK WIDTH	POSITION	N	DIM "G"	DIM "F"	PIN "L"
X8	98	37	39.15	37.00	B48
X16	164	70	72.15	70.00	B81

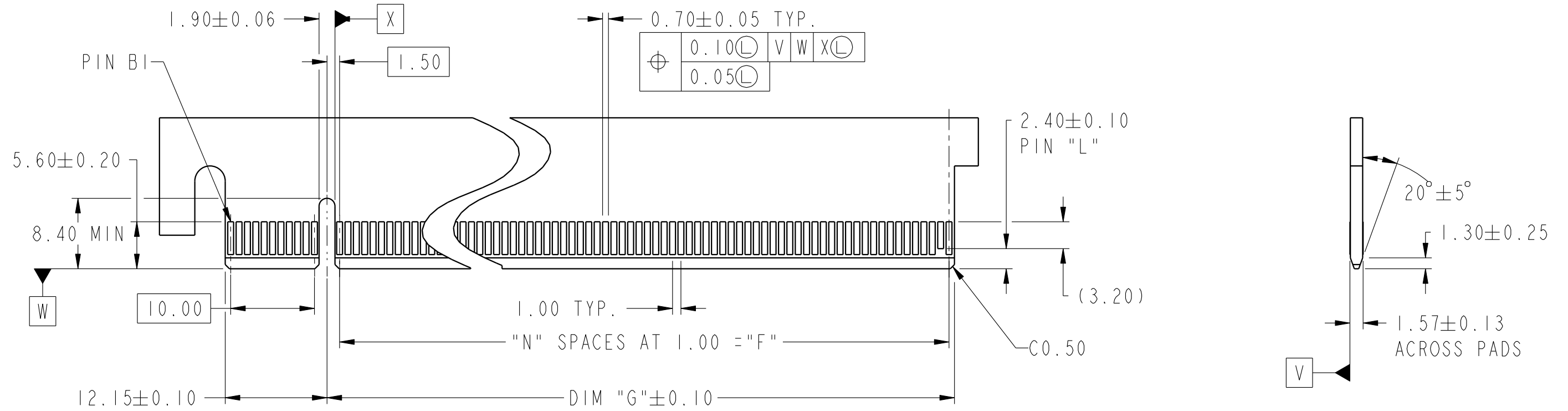

← I/O PANEL DIRECTION
PRIMARY (COMPONENT) SIDE

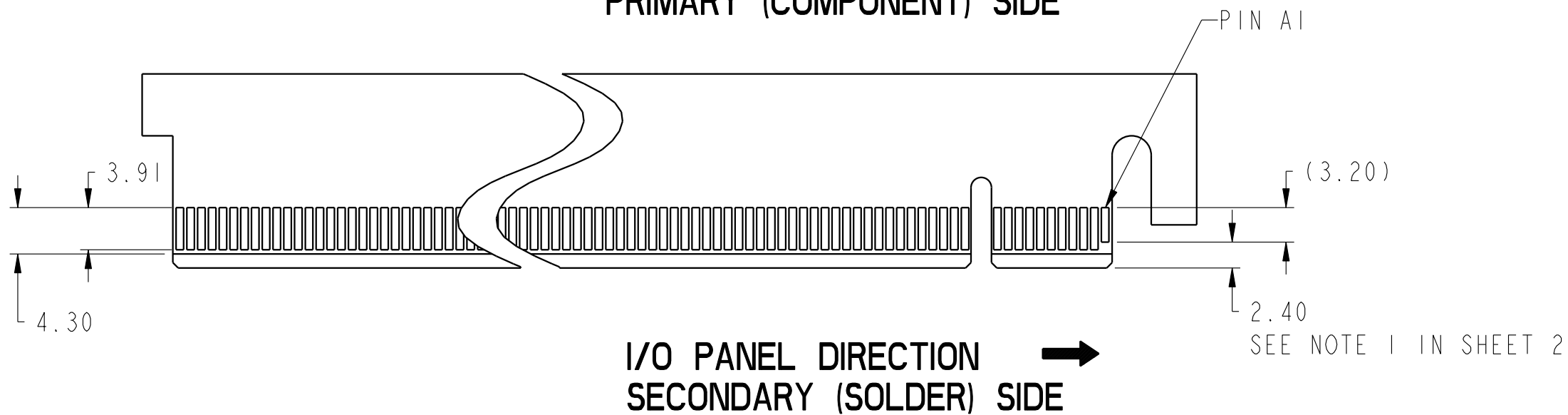

I/O PANEL DIRECTION →
SECONDARY (SOLDER) SIDE

- NO TIE BAR PERMITTED FROM CARD EDGE TO LEADING EDGE OF PAD FOR PIN A1 AND PIN "L".
- CHAMFER EDGES MUST BE FREE OF CUTTING BURRS.
- TOLERANCE : ± 0.13

spec ref	-	dr	Cheong, Matthe	2019/01/21	projection	MM	size	A3	scale	2:1
tolerance std	ISO 406 ISO 1101	eng	Cheong, Matthe	2020/06/23			ecn no	-	rel level	Released
TOLERANCES UNLESS OTHERWISE SPECIFIED		chr	-	-			product family	PCI express		
surface	linear	appr	Koon-Poh Tay	2020/06/23	PCI Express 4.0		cat. no.	10149641	rev	A
ISO 1302	angular	www.fci.com		SMT Type- CUST SP BLADE		Product - Customer Drw		sheet 2 of 4		

A

B

C

D

A

B

C

D

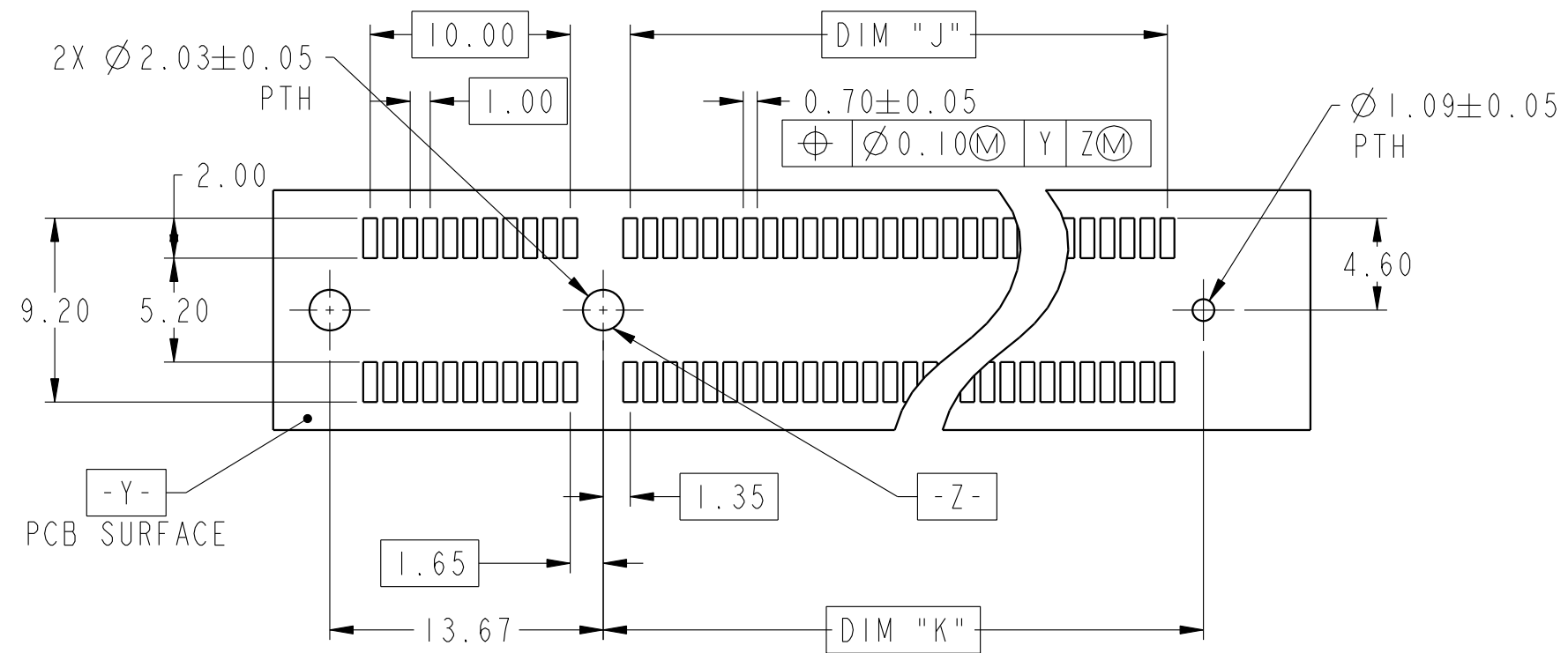

RECOMMENDED PCB LAYOUT, PAD TYPE

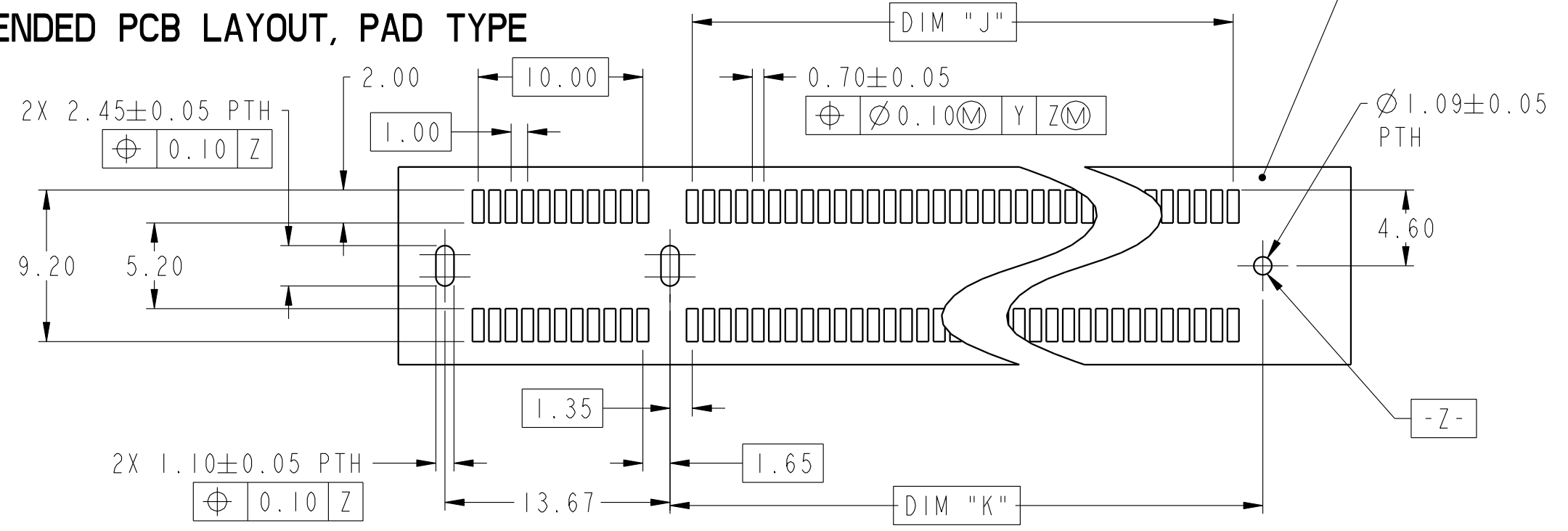

ALTERNATE PCB LAYOUT, PAD TYPE

DIMENSIONS						
POSITION	A	B ^{+0.15} / _{-0.05}	C ±0.10	D ±0.23	J	K ± 0.1
98	37.00	38.65	40.15	56.00	37.00	40.15
164	70.00	71.65	73.15	89.00	70.00	73.15

spec ref	-	dr	Cheong, Matthe	2019/01/21	projection	MM	size	A3	scale	4:1
tolerance std	ISO 406 ISO 1101	eng	Cheong, Matthe	2020/06/23	chr	-	ecn no	-	rel level	Released
surface	-	appr	Koon-Poh Tay	2020/06/23	product family	PCI express	rel level	Released		
ISO 1302	linear	0.X	±0.30	Amphenol FCI		PCI Express 4.0	dwg no	10149641	rev	A
	angular	0°	±2°	www.fci.com		SMT Type- CUST SP BLADE	cat. no.	-	Product - Customer Drw	sheet 3 of 4

PRODUCT NUMBER CODE

10149641 - □□□□□ 0LF

HOUSING COLOR

1: BLACK

CONTACT AREA PLATING

1: 30u" Au
2: 15u" Au

PACKAGING OPTIONS

Y: HARD TRAY (DIM: 330x235x19.3) WITH KAPTON TAPE (98 & 164 POS)

HOLDDOWN BLADE LENGTH, DIM "X"

1: 1.5
2: 1.8
3: 2.6

NO. OF POSITION

2: 98 POSITIONS
3: 164 POSITIONS

POSITION OF KAPTON TAPE

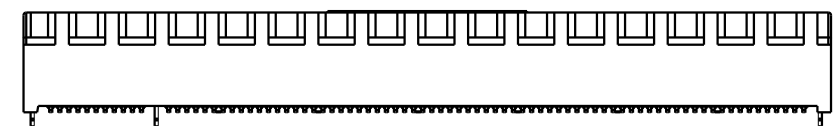
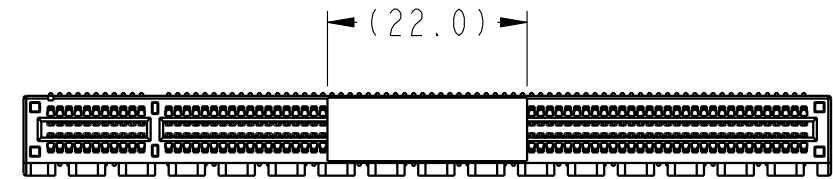

SCALE 6:5

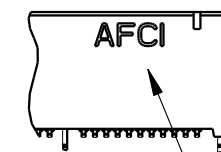

DATE CODE & PARTNO

NOTES:

- MATERIAL:
HOUSING: HIGH PERFORMANCE RESINS, GLASS FILLED, UL94V-0
CONTACT: COPPER ALLOY.
METAL PADS: COPPER ALLOY
- PLATING:
CONTACT: UNDERPLATE: 50u" NICKEL OVER ALL.
SOLDER AREA: 100u" TIN (LEAD FREE).
MATING AREA: SEE PRODUCT NUMBER CODE.
HOLDDOWN CLIP: 100u" TIN OVER 50 u" NICKEL.
- PRODUCT SPECIFICATION: GS-12-1406
- DATE CODE "MMDDYYL", MMDDYY IS ASSEMBLY DATE.
L IS AFCI PRODUCTION SITE.
- THIS PRODUCT MEETS EUROPEAN UNION DIRECTIVES AND OTHER COUNTRY REGULATIONS AS DESCRIBED IN GS-47-004.
- THE HOUSING WILL WITHSTAND EXPOSURE TO 260° PEAK TEMPERATURE FOR 10 SECONDS IN A CONVECTION, INFRA-RED OR VAPOR PHASE REFLOW OVEN.

spec ref -		dr	Cheong, Matthe	2019/01/21	projection	MM	size	A3	scale	2:1
tolerance std		eng	Cheong, Matthe	2020/06/23			ecn no -		rel level Released	
ISO 406 ISO 1101		chr	-	-			product family PCI express		-	
surface		appr	Koon-Poh Tay	2020/06/23	PCI Express 4.0		dwg no		10149641	
ISO 1302				SMT Type- CUST SP BLADE		rev		A		
linear		www.fci.com		cat. no.		Product - Customer Drw		sheet 4 of 4		
angular										
0.X ±0.30										
0.XX ±0.20										
0.XXX ±0.1										
0° ±2°										