

PART NO. AND WEEK/YEAR DATE CODE TO BE PRINTED ON BACK OF CAGE APPROXIMATELY AS SHOWN. SEE TABE BELOW FOR DATE CODE INFORMATION.(P/N FOR LIGHT PIPE COVER)

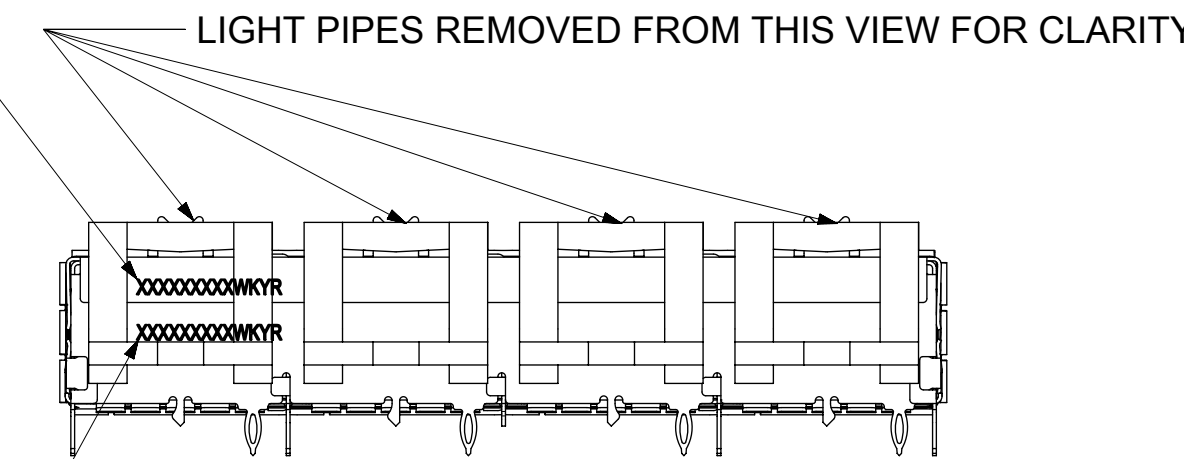

- NOTES:
- MATERIAL:
 CAGE: NICKEL PLATED COPPER ALLOY, THICKNESS 0.25mm.
 SPRING FINGER: STAINLESS STEEL.
 LIGHT PIPE COVER: NICKEL PLATED COPPER ALLOY.
 LIGHT PIPE: POLYCARBONATE (94-V0 RATED)
 - PRESS FIT LEGS 3.05 LONG -
 3.00 MINIMUM PCB THICKNESS FOR BELLY TO BELLY USE.
 1.57 MINIMUM PCB THICKNESS FOR SINGLE SIDE USE.
 INSERTION FORCE INTO PCB < 100 LBS.
 - PORTS ARE DESIGNED FOR SFP+ TRANSCEIVERS AND ARE COMPATIBLE WITH SFP TRANSCEIVERS.
 - WELD SPOTS WILL SHOW SLIGHT DISCOLORATION.
 - IT IS NOT RECOMENDED TO PRESS ON LIGHT PIPES WHEN INSTALLING CAGE.
 - NO RoHS EXEMPTIONS.

WEEK/YEAR DATE CODE	
WK	01 THRU 52. EXAMPLE: 01 = FIRST WEEK OF YEAR 52 = LAST WEEK OF YEAR
YR	22, 23, 24. EXAMPLE: 2022 = 22

FUNCTIONAL SYMBOLS	THIS DRAWING CONTAINS INFORMATION THAT IS PROPRIETARY TO MOLEX ELECTRONIC TECHNOLOGIES, LLC AND SHOULD NOT BE USED WITHOUT WRITTEN PERMISSION		CURRENT REV DESC: SEE REVISION TABLE			
	$\nabla_A = 0$ $\nabla_E = 0$ $\nabla_P = 0$	DIMENSION UNITS: mm SCALE: 2:1	GENERAL TOLERANCES (UNLESS SPECIFIED) ANGULAR TOL $\pm 1.0^\circ$			EC NO: 707270 DRWN: PKH CHK'D: TKUMARKC APPR: SCHIEN
DIVISIONAL SYMBOLS	4 PLACES \pm	3 PLACES \pm	2 PLACES ± 0.15	1 PLACE ± 0.25	0 PLACES \pm	PRODUCT CUSTOMER DRAWING DOCUMENT NUMBER: 747548704 DOC TYPE: PSD DOC PART: ASY REVISION: A
	DRAFT WHERE APPLICABLE MUST REMAIN WITHIN DIMENSIONS		THIRD ANGLE PROJECTION	DRAWING: C-SIZE	SERIES: 74754	MATERIAL NUMBER: 747548704 CUSTOMER:

PCB LAYOUT FOR BELLY TO BELLY MOUNTING

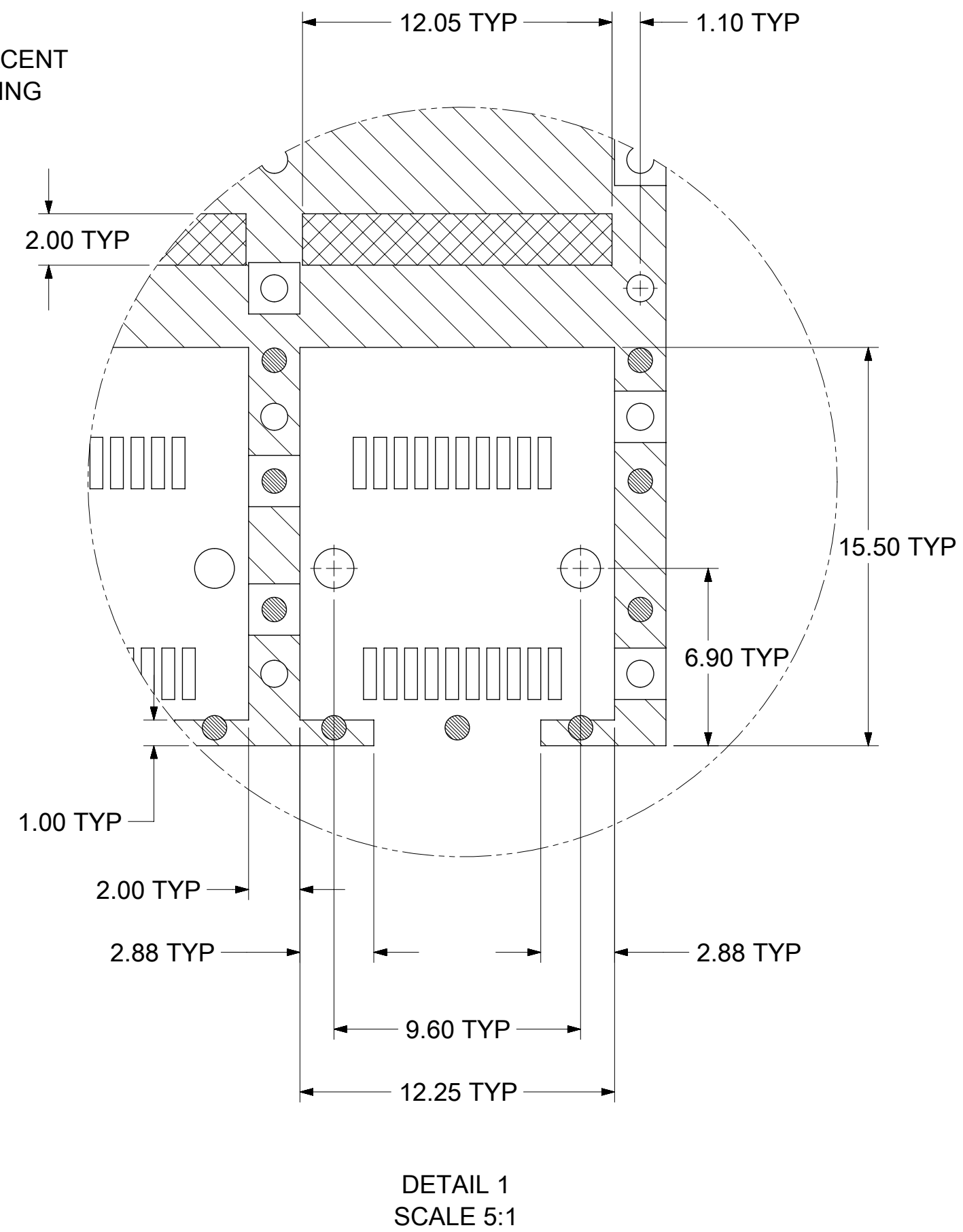
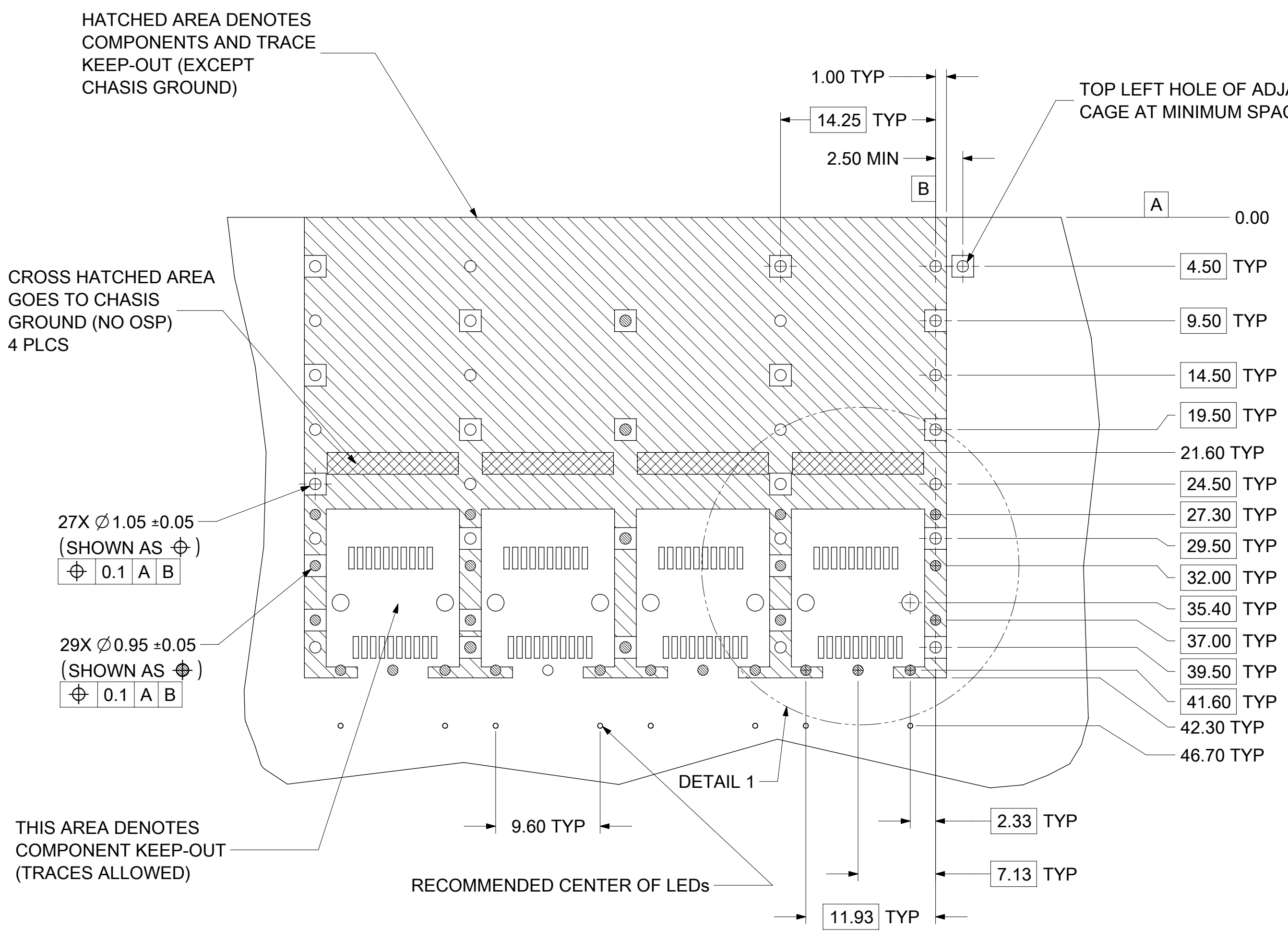

- NOTES:
1. PADS AND VIAS CONNECT TO CHASSIS GROUND (RECOMMEND PADS TO BE 2.00mm SQUARE).
 2. RECOMMENDED THRU HOLE PLATING INCLUDES HASL, OSP, OR IMMERSION (GOLD, SILVER, OR TIN).
 3. CONNECTOR PAD LAYOUT PER SFP+ MSA WILL ACCOMMODATE MOLEX CONNECTOR SERIES 74441 OR EQUIVALENT.
 4. HOLE PATTERN REPEATS FOR EACH PORT. SPACING BETWEEN PORTS IS 14.25mm.

FUNCTIONAL SYMBOLS	THIS DRAWING CONTAINS INFORMATION THAT IS PROPRIETARY TO MOLEX ELECTRONIC TECHNOLOGIES, LLC AND SHOULD NOT BE USED WITHOUT WRITTEN PERMISSION		CURRENT REV DESC: SEE REVISION TABLE		
	DIMENSION UNITS	SCALE			
$\nabla_A = 0$	mm	3:1			SFP+ 1X4 GANGED CAGE ASSY WITH SUS SPRING FINGERS ULTRA LOW PROFILE DUAL LIGHT PIPE
$\nabla_C = 0$	GENERAL TOLERANCES (UNLESS SPECIFIED)				
$\nabla_P = 0$	ANGULAR TOL $\pm 1.0^\circ$				PRODUCT CUSTOMER DRAWING
DIVISIONAL SYMBOLS	4 PLACES	\pm	EC NO: 707270	2022/04/14	
	3 PLACES	\pm	DRWN: PKH	2022/05/27	
	2 PLACES	± 0.15	CHK'D: TKUMARKC	2022/06/01	
	1 PLACE	± 0.25	APPR: SCHIEN		
	0 PLACES	\pm	INITIAL REVISION:		
	DRAFT WHERE APPLICABLE MUST REMAIN WITHIN DIMENSIONS		DRWN: PKH	2022/04/14	DOCUMENT NUMBER
	THIRD ANGLE PROJECTION		APPR: SCHIEN	2022/06/01	747548704
	DRAWING		SERIES	MATERIAL NUMBER	CUSTOMER
	C-SIZE		74754	747548704	
					DOC TYPE DOC PART REVISION
					PSD ASY A
					SHEET NUMBER
					2 OF 5

PCB LAYOUT FOR SINGLE SIDED MOUNTING

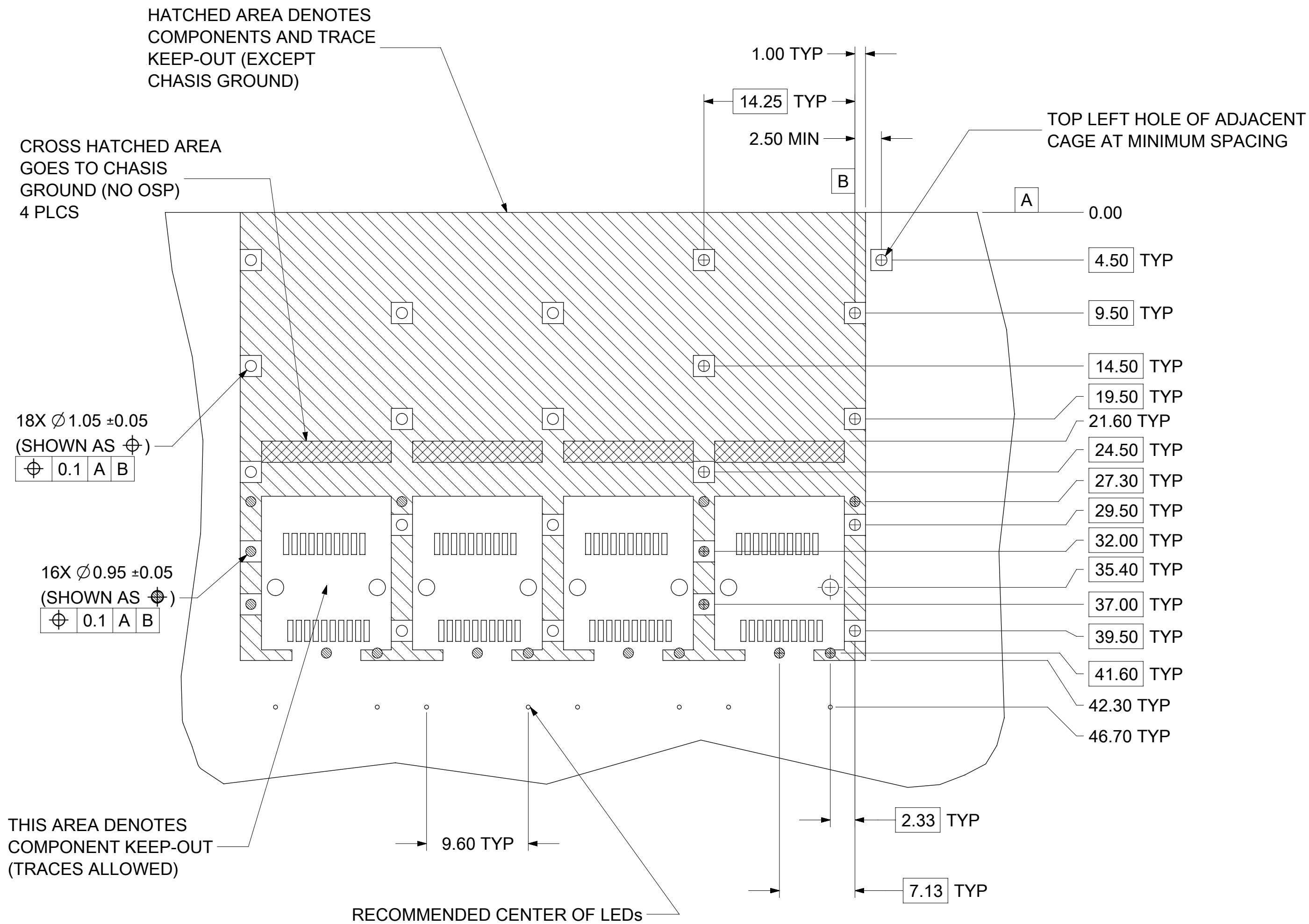

NOTE:
SEE SHEET 2 FOR HOST CONNECTOR DETAIL

- NOTES:
- PADS AND VIAS CONNECT TO CHASSIS GROUND (RECOMMEND PADS TO BE 2.00mm SQUARE).
 - RECOMMEND THRU HOLE PLATING INCLUDES HASL, OSP, OR IMMERSION (GOLD, SILVER OR TIN).
 - CONNECTOR PAD LAYOUT PER SFP+ MSA WILL ACCOMODATE MOLEX CONNECTOR SERIRS 74441 OR EQUIVALENT.
 - HOLE PATTERN REPEATS FOR EACH PORT. SPACING BETWEEN PORTS IS 14.25mm.

FUNCTIONAL SYMBOLS	THIS DRAWING CONTAINS INFORMATION THAT IS PROPRIETARY TO MOLEX ELECTRONIC TECHNOLOGIES, LLC AND SHOULD NOT BE USED WITHOUT WRITTEN PERMISSION		CURRENT REV DESC: SEE REVISION TABLE		
	DIMENSION UNITS	SCALE			
$\frac{F}{A} = 0$	mm	3:1			SFP+ 1X4 GANGED CAGE ASSY WITH SUS SPRING FINGERS ULTRA LOW PROFILE DUAL LIGHT PIPE
$\frac{F}{C} = 0$	GENERAL TOLERANCES (UNLESS SPECIFIED)				
$\frac{F}{P} = 0$	ANGULAR TOL $\pm 1.0^\circ$				PRODUCT CUSTOMER DRAWING
DIVISIONAL SYMBOLS	4 PLACES	\pm	EC NO: 707270	2022/04/14	
	3 PLACES	\pm	DRWN: PKH	2022/05/27	
	2 PLACES	± 0.15	CHK'D: TKUMARKC	2022/06/01	
	1 PLACE	± 0.25	APPR: SCHIEN		
0 PLACES	\pm	INITIAL REVISION:			
DRAFT WHERE APPLICABLE MUST REMAIN WITHIN DIMENSIONS		THIRD ANGLE PROJECTION	DRAWING	SERIES	DOCUMENT NUMBER
			C-SIZE	74754	747548704
					MATERIAL NUMBER
					CUSTOMER
					DOC TYPE
					DOC PART
					REVISION
					PSD
					ASY
					A
					SHEET NUMBER
					3 OF 5

DOCUMENT STATUS	P1	RELEASE DATE	2022/06/01	06:40:55
-----------------	----	--------------	------------	----------

BEZEL AND BOARD POSITION DIMENSIONS FOR BELLY TO BELLY MOUNTING (SPRING FINGER)

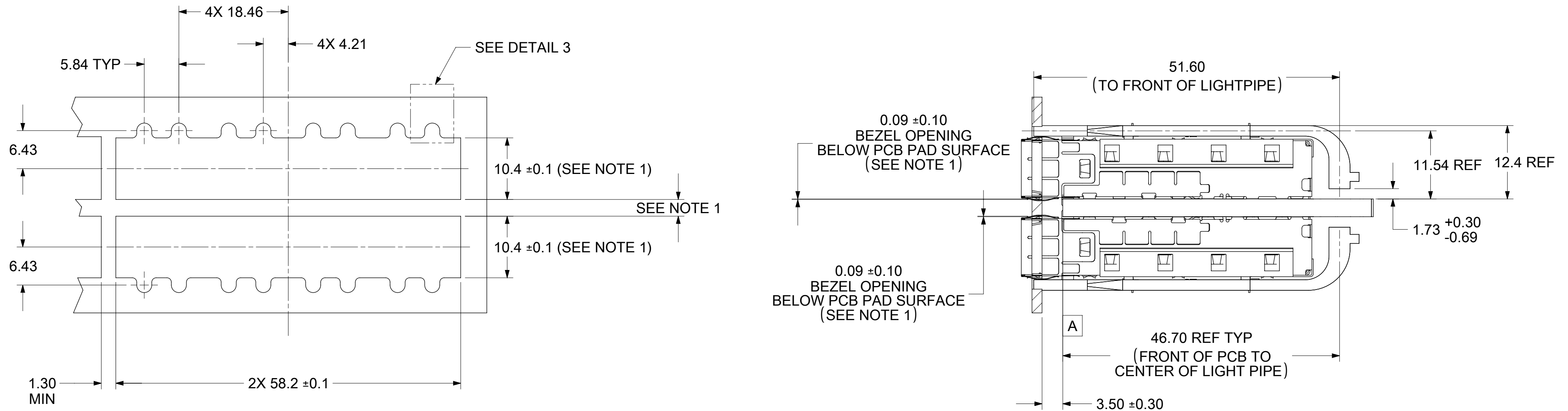

BEZEL AND BOARD POSITION DIMENSIONS FOR SINGLE SIDED MOUNTING (SPRING FINGER)

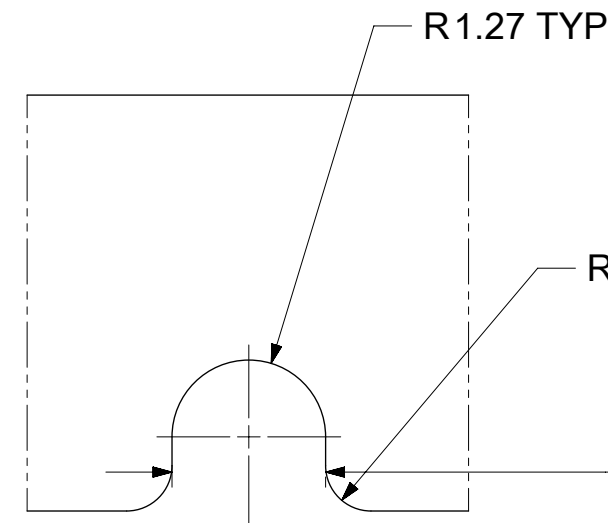
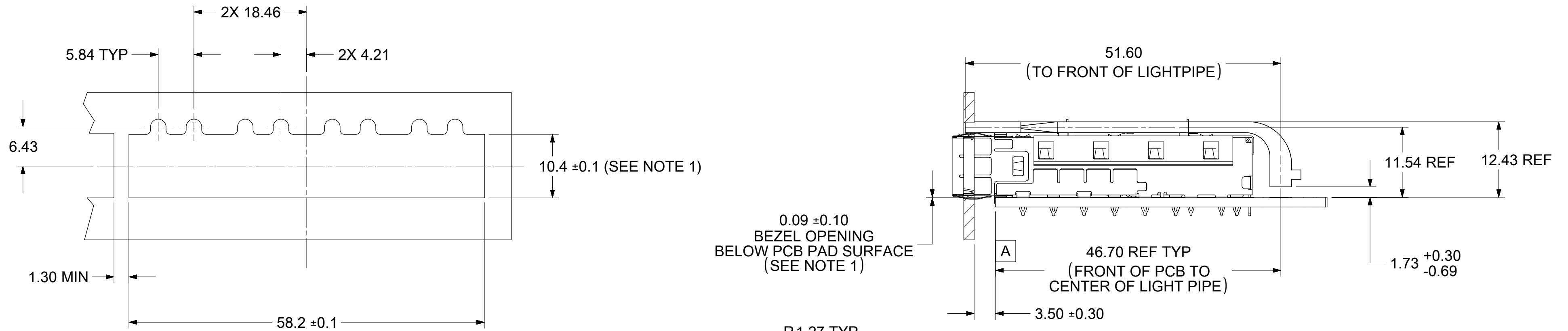

DETAIL 3
SCALE 8:1

PROFILE FOR BOTH
SINGLE SIDED AND BELLY-TO-BELLY

NOTES:
1. PCB THICKNESS VARIATION MUST BE CONSIDERED WHEN DETERMINING BEZEL OPENING, SIZE, AND LOCATION.

THIS DRAWING CONTAINS INFORMATION THAT IS PROPRIETARY TO MOLEX ELECTRONIC TECHNOLOGIES, LLC AND SHOULD NOT BE USED WITHOUT WRITTEN PERMISSION											
FUNCTIONAL SYMBOLS	DIMENSION UNITS	SCALE	CURRENT REV DESC: SEE REVISION TABLE								
▽ = 0	mm	2:1	molex								
∠ = 0	GENERAL TOLERANCES (UNLESS SPECIFIED)		SFP+ 1X4 GANGED CAGE ASSY WITH SUS SPRING FINGERS ULTRA LOW PROFILE DUAL LIGHT PIPE								
∇ = 0	ANGULAR TOL ± 1.0°		EC NO: 707270			2022/04/14			PRODUCT CUSTOMER DRAWING		
∇ = 0	4 PLACES ±		DRWN: PKH			2022/05/27			DOCUMENT NUMBER		
∇ = 0	3 PLACES ±		CHK'D: TKUMARKC			2022/06/01			747548704		
∇ = 0	2 PLACES ± 0.15		APPR: SCHIEN			2022/06/01			PSD ASY A		
∇ = 0	1 PLACE ± 0.25		INITIAL REVISION:			2022/04/14			DOC TYPE		
∇ = 0	0 PLACES ±		DRWN: PKH			2022/06/01			DOC PART		
DRAFT WHERE APPLICABLE MUST REMAIN WITHIN DIMENSIONS			THIRD ANGLE PROJECTION			DRAWING			SERIES		
⊕			C-SIZE			74754			MATERIAL NUMBER		
⊕			C-SIZE			74754			CUSTOMER		
⊕			C-SIZE			74754			SHEET NUMBER		
⊕			C-SIZE			74754			4 OF 5		

