

Type CNA-03
PC Board Type Fuse Clip
1/4" (6.35mm) Fuses
Mounting Pins Type – no End Stops



www.optifuse.com

(619) 593-5050

Specifications:

- Rating:** 15A, 250V AC
- Body Material:** Bronze
- Finish:** Tin-plated or Nickel-plated
- With Mounting Pins
- No End Stops

For use with **1/4" (6.35mm) Fuses**

Mechanical Dimensions: Inches [mm]

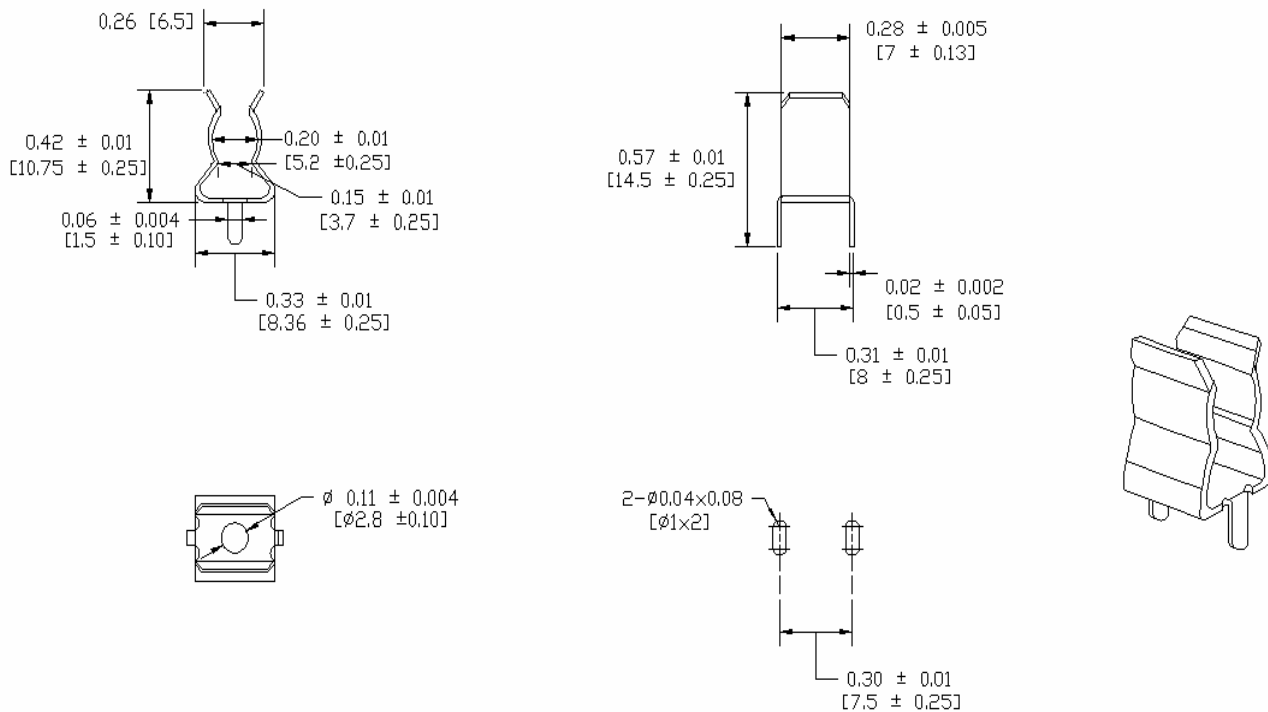

Warning:



- Operation beyond the specified maximum ratings or improper use may result in damage and possible electrical arcing and/or flame.
- Avoid contact of device with chemical solvent. Prolonged contact will damage the device performance.

Note: All specifications subject to change without notice.

Rev A 08/2007 - Page: 1/1
 Code J01