

THIS PRODUCT MANUFACTURED WITH LEAD-FREE PROCESSING

DESIGNED & DIMENSIONED IN MILLIMETERS [INCHES]

DO NOT SCALE FROM THIS PRINT

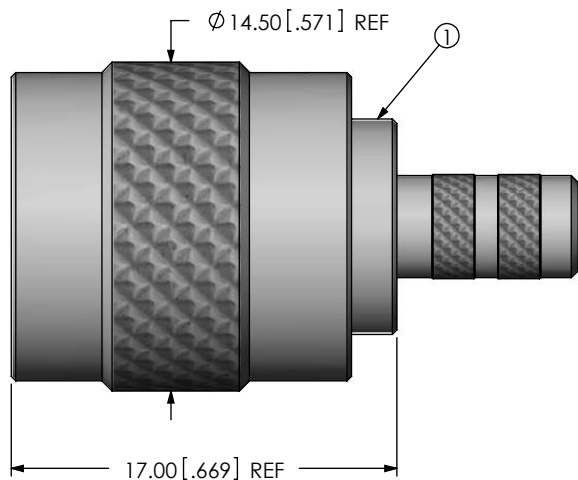

TNC-P-C-XX-ST-CA1

GENDER
-P: PLUG

TYPE
-C: CABLE

TERMINATION
-CA1: CABLE (RG174 OR RG316)

ORIENTATION
-ST: STRAIGHT

PLATING SPECIFICATION
-GN: GOLD / NICKEL
10µ" Au / 50µ" Ni MIN ON CENTER CONTACT
100µ" Ni MIN ON OTHER (SEE TABLE 1)

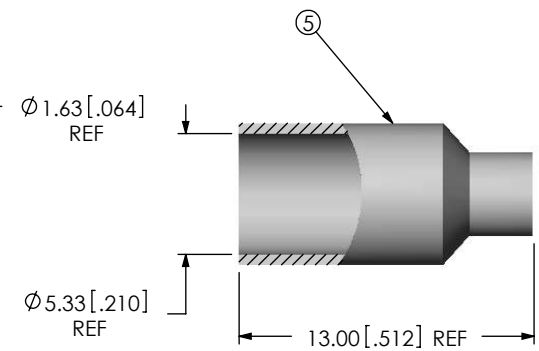
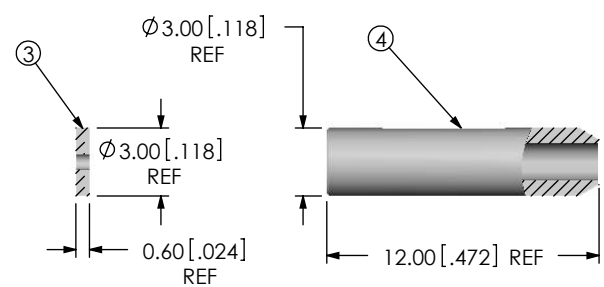
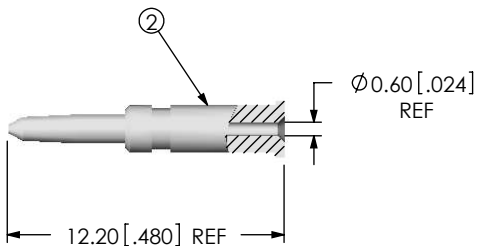

TABLE 1

ITEM	COMPONENT	-GN
1	SUB ASSEMBLY	SUB-TNC-P-C-N-ST-CA1
2	PIN	TNC-PIN-001-G
3	INSULATOR	TNC-INS-001
4	FERRULE 1	TNC-FER-001-N
5	FERRULE 2	TNC-FER-002-N

NOTES:

- REPRESENTS A CRITICAL DIMENSION.
- CENTER CONTACT PUSHOUT FORCE: 26.69 N [6LB] MIN
- NOTE DELETED.
- NOTE DELETED.
- PRODUCT TO BE PACKAGED PER PACKAGING STANDARD CO-HD-WI-3040-M
- NOTE DELETED.
- NOTE DELETED.
- NOTE DELETED.

UNLESS OTHERWISE SPECIFIED DIMENSIONS ARE IN MILLIMETERS [INCHES] TOLERANCES ARE: DECIMALS ANGLES .X: ±0.3 [.01] 5° .XX: ±0.13 [.005] .XXX: ±0.051 [.0020]	PROPRIETARY NOTE THIS DOCUMENT CONTAINS INFORMATION CONFIDENTIAL AND PROPRIETARY TO SAMTEC, INC. AND SHALL NOT BE REPRODUCED OR TRANSFERRED TO OTHER DOCUMENTS OR DISCLOSED TO OTHERS OR USED FOR ANY PURPOSE OTHER THAN THAT WHICH IT WAS OBTAINED WITHOUT THE EXPRESSED WRITTEN CONSENT OF SAMTEC, INC.	 520 PARK EAST BLVD., NEW ALBANY, IN 47150 PHONE: 812-944-6733 FAX: 812-948-5047 e-Mail: info@SAMTEC.com code 55322	
		DESCRIPTION: TNC STRAIGHT CABLE PLUG, RG174 & RG316 - 50 OHM DWG. NO. TNC-P-C-XX-ST-CA1	
MATERIAL: DO NOT SCALE DRAWING SHEET SCALE: 3:1 SHELL, FERRULE: BRASS CONTACT: BRASS DIELECTRIC: PTFE GASKET: SILICONE		BY: R MUSSER 12/19/2007 SHEET 1 OF 2	

REVISION J

J
J
J

⊕ 17.4 [.69]
⊕ 8.6 [.34]
⊕ 5.1 [.20]



IN-PROCESS 1
STRIP AND TIN INNER CONDUCTOR

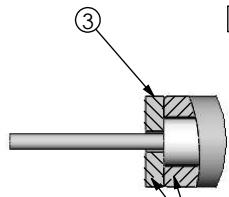

TNC-INS-001 & TNC-FER-001-X
TO BE FLUSH WITH CABLE DIELECTRIC

DETAIL 'B'
SCALE 4 : 1

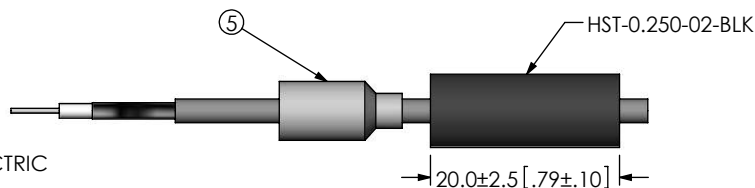

IN-PROCESS 2
ADD HEAT SHRINK TUBE AND FERRULE

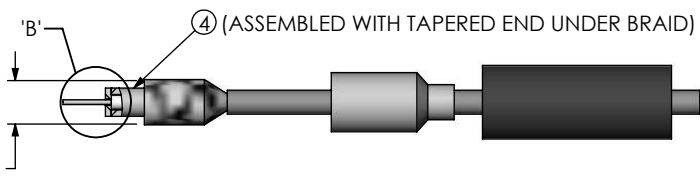

IN-PROCESS 3
FLARE SHIELD, ADD INNER FERRULE AND INSULATOR

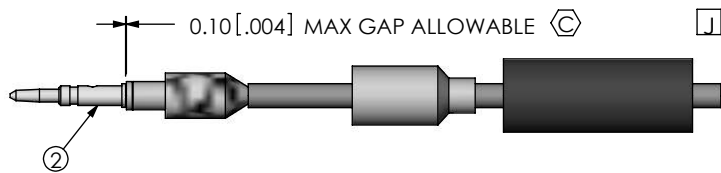

IN-PROCESS 4
SOLDER SIGNAL PIN

0.45 [.018] REF
TO CENTER CONTACT
J

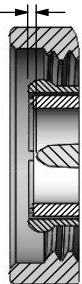

DETAIL 'A'
SCALE 2.5 : 1

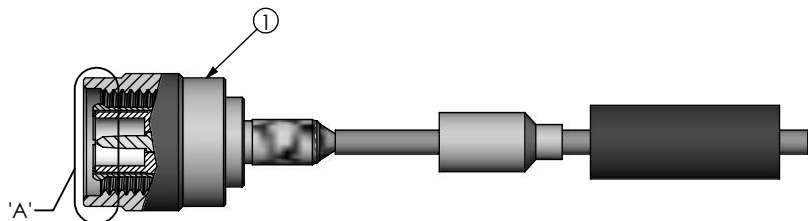

IN-PROCESS 5
ADD SUB-TNC-P-C-X-ST-CA1

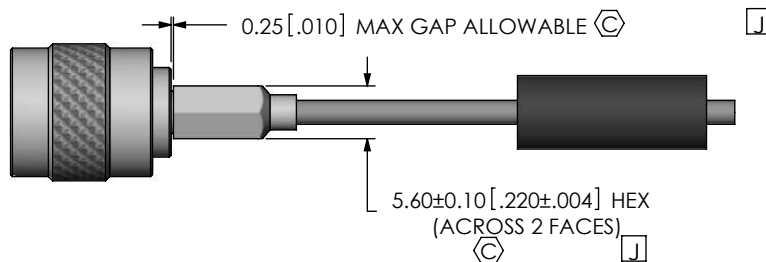

IN-PROCESS 6
CRIMP FERRULE
(USE RF CRIMP HAND TOOL #CAT-HT-126667-21 OR EQUIVALENT)
(USE .213" HEX DIE)

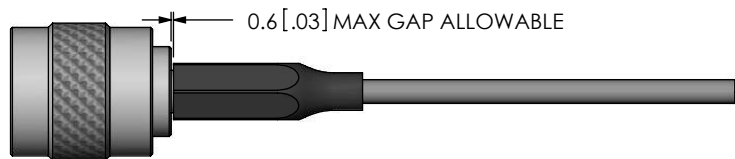

IN-PROCESS 7
APPLY HEAT SHRINK TUBE

PROPRIETARY NOTE

THIS DOCUMENT CONTAINS INFORMATION
CONFIDENTIAL AND PROPRIETARY TO
SAMTEC, INC. AND SHALL NOT BE REPRODUCED
OR TRANSFERRED TO OTHER DOCUMENTS OR
DISCLOSED TO OTHERS OR USED FOR ANY
PURPOSE OTHER THAN THAT WHICH IT WAS
OBTAINED WITHOUT THE EXPRESSED WRITTEN
CONSENT OF SAMTEC, INC.



520 PARK EAST BLVD, NEW ALBANY, IN 47150
PHONE: 812-944-6733 FAX: 812-948-5047
e-Mail: info@SAMTEC.com code 55322

DO NOT SCALE DRAWING

SHEET SCALE: 1:0.8

DESCRIPTION:
TNC STRAIGHT CABLE PLUG, RG174 & RG316 - 50 OHM

DWG. NO.
TNC-P-C-XX-ST-CA1

BY: R MUSSER 12/19/2007 SHEET 2 OF 2