

MATERIAL:  
 1.HOUSING: PA46, BK  
 2.CONTACT: COPPER ALLOY  
 3.GUARD PLATE: STAINLESS STEEL  
 4.MID PLATE: STAINLESS STEEL  
 5.SHELL: STAINLESS STEEL  
 6.WATERPROOF RING : LIQUID SILICA GEL

FINISH:  
 CONTACT: SEE ORDER INFORMATION  
 SHELL: NICKEL PLATING

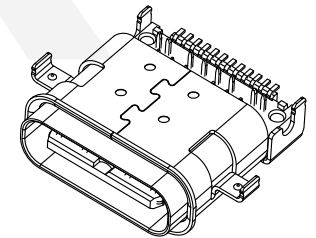
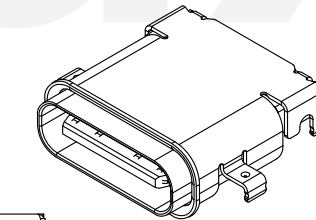
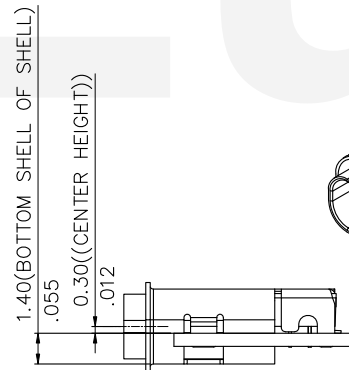
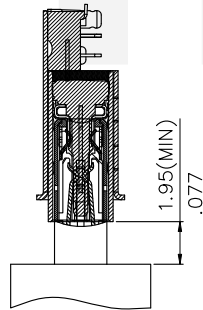
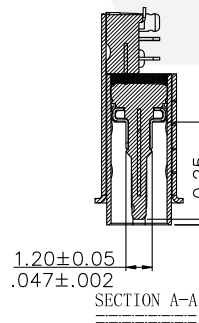
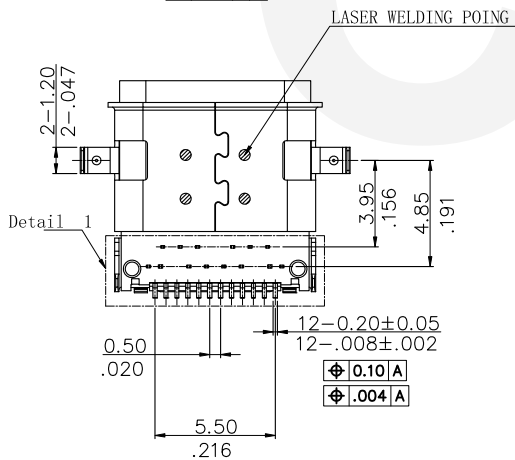
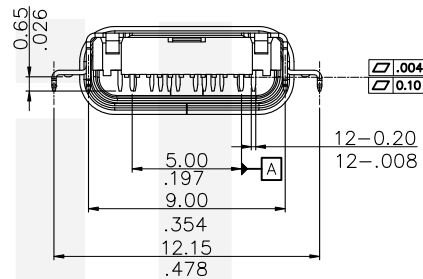

Ordering Code:

CU39 24 S \* S F D R 003 -LF  
 ① ② ③ ④ ⑤ ⑥ ⑦ ⑧ ⑨ ⑩

- ① Series No.
- ② No. of Circuits
- ③ S= Socket
- ④ Plating option:  
F= Selective 15u" Gold plated on contact ared and, Gold Flash plated on the other parts,Both of them areover 50u" Nickel
- ⑤ Shell Material & Plating :S= Stainless steel
- ⑥ Contact Material: F= Copper Alloy
- ⑦ Insulator Material & Color option:  
D= High Temp Black
- ⑧ Packing Option: R= Tape & Reel
- ⑨ 003=Waterproof Type (IP67)
- ⑩ -LF= For Lead Free IR Reflow Process

Lead Free Process

RoHS Compliant

4  
3  
2  
1

CVIL UX  
 2020.08.06  
 ISSUED

DRAWN BY: Kevin  
 ENGINEER: Kevin  
 CHECKED BY: Keny  
 APPROVED BY: Keny

DATE: 5/26-20'  
 UNIT: mm / inch  
 TOLERANCE UNLESS OTHERWISE SPECIFIED  
 .X ± 0.25/.010 X' ± 4'  
 .XX ± 0.20/.008 X' ± 2'  
 .XXX ± 0.10/.004 .XX' ±

TITLE: CU39 TYPE C/F 24PIN H1.4mm BOARD SMT TYPE WATERPROOF  
 MATERIAL:  
 FINISH:



瀚荃股份有限公司  
 CviLux Corporation

DRAWING NO. CU39S03SA PART NO. CU3924S\*SFDR003-LF  
 SCALE 1/1 SHEET 1 OF 3



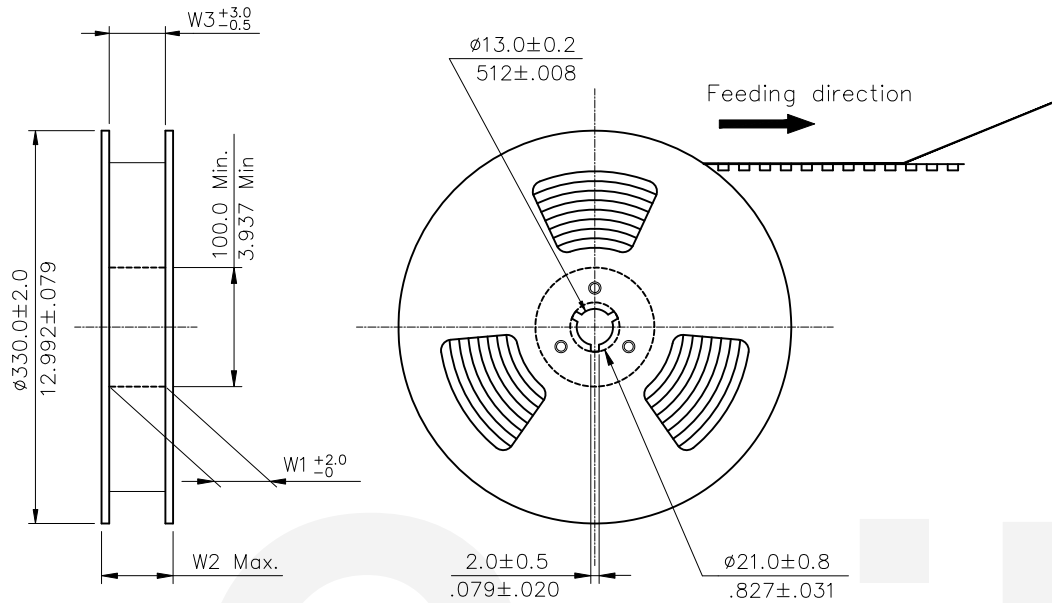

NOTE :

- \* Reel Material : HIPS
- \* Carrier Material : Clear, Conductive Polystyrene Alloy
- \* Cover Tape Material : Polyester
- \* Cover Tape Peel Strength : 0.1N – 1.3N
- \* Carrier camber is within 1mm in 250mm
- \* All dimensions meet EIA-481-B requirements.
- \* Quantity : 700 PCS/Reel

Dimension				Packing (Reel/Carton)
E	W1	W2	W3	
24.0(.945)	24.5(.965)	30.5(1.201)	24.5(.965)	10

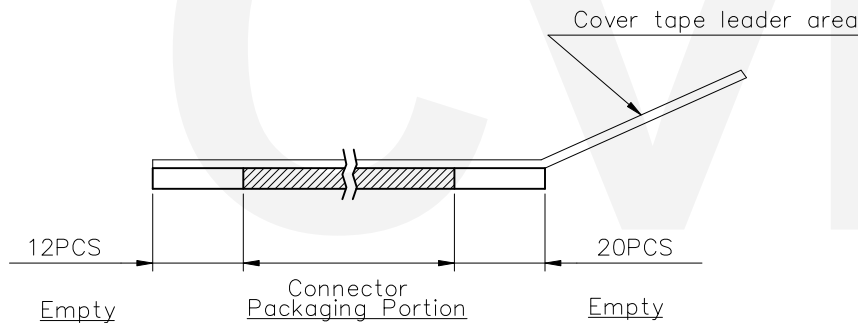
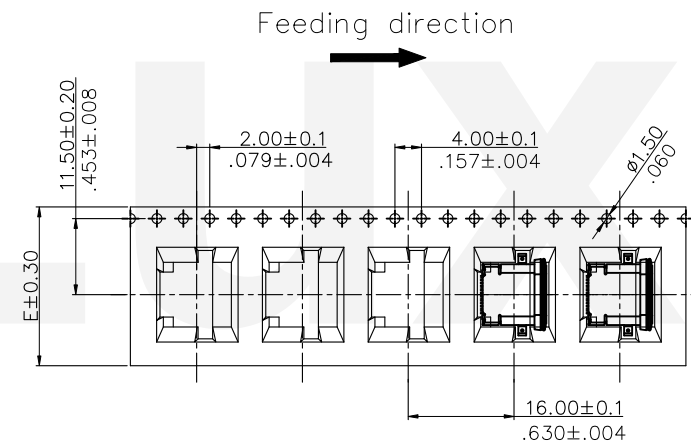

WATERPROOF RING



5000PCS/BAG

WATERPROOF RING Packing

BAG	(BAG/Carton)
5000 PCS	6

Lead Free Process

RoHS compliant

CVILUX  
2020.08.06  
ISSUED

4	3	2	1	SYM	NAME	DATE	REVISIONS	DRAWN BY:	Kevin	5/26-20'	ENGINEER:	Kevin	5/26-20'	CHECKED BY:	Keny	5/26-20'	APPROVED BY:	Keny	5/26-20'	UNIT: mm / inch	TOLERANCE UNLESS OTHERWISE SPECIFIED	TITLE: CU39 TYPE C/F 24PIN H1.4mm BOARD SMT TYPE WATERPROOF	MATERIAL:	FINISH:
																				.X ±	.X' ± 1'			
																				.XX ±	.X' ±			
																				.XXX ±	.XX' ±			



瀚荃股份有限公司  
CviLux Corporation

DRAWING NO.	CU39S03SA	PART NO.	CU3924S*SFDR003-LF
SCALE		SHEET	3 OF 3