

NOTES:

1. ONLY THE ITEMS WITH QUANTITIES SPECIFIED ON PARTS LIST ARE USED ON THIS APPLICATOR.

△ USED IN PLACE OF ITEM 38 WHEN INSULATION CRIMP IS NOT USED.

▲ GUARD MUST BE IN PLACE WHEN OPERATING APPLICATOR IN AMP-O-LECTRIC PRESS.

4. PARTS WITH QTY. OF REF. SPECIFIED (EXCEPT ITEM 79) ARE USED ON ITEM 32.

KEY:

■ RECOMMENDED SPARE PARTS.

▲ LUBRICATE DAILY USING NO. 20 MACHINE OIL.

● GREASE LIGHTLY.

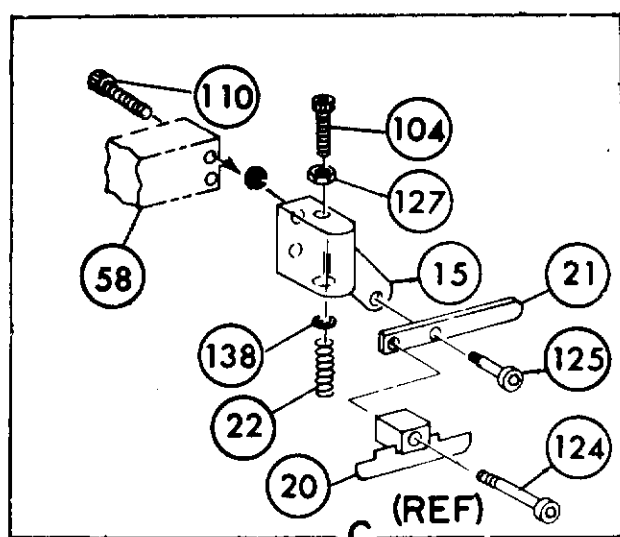

ALTERNATE DRAG METHOD

BTN HD SKT CAP SCR 3/8-16 X.75 (REF)

REF	QTY	PART NO	DESCRIPTION	ITEM NO	REF	QTY	PART NO	DESCRIPTION	ITEM NO
		21045-3	RING, RETAINING 'C' (.187 DIA) FEED PIN	145	REF	454220-1	CAP, RAM	59	
				144	REF	453736-1	HOUSING	58	
REF		5-21028-1	PIN, SLOT SPG (.12 DIA X .50) FD ADJ ROD	143				57	
				142				56	
REF		1-21030-7	PIN, DOWEL (.187 DIA X 1.50) HOUSING	141	REF	240624-1	PIN, FEED FINGER	55	
REF		1-21030-1	PIN, DOWEL (.187 DIA X .50) LEVER	140	REF	691497-1	SPRING, FEED FINGER	54	
				139	REF	240635-1	FINGER, FEED	53	
		22260-5	WASHER, FLAT (NO 6) DRAG SPRING	138	REF	240634-3	LEVER, TERMINAL	52	
REF		21899-4	WASHER, FLAT (5/16 DIA) SCR ADJ	137				51	
				136				50	
REF		21024-5	WASHER, LOCK (NO 10) FEED ADJ PLATE	135	1	690686-1	BOLT, CRIMPER	49	
2		21024-5	WASHER, LOCK (NO 10) SHEAR PLATES	134	1	690501-4	CAM, POST FEED 1 5/8 STROKE	48	
REF		21024-5	WASHER, LOCK (NO 10) FEED ROD GUIDE	133				47	
4		21024-4	WASHER, LOCK (NO 8) STRIP GUIDE	132				46	
2		21024-4	WASHER, LOCK (NO 8) SHEAR BLADE	131	1	690191-1	PLUG, NYLON	45	
				130	1	455674-1	RAM	44	
2		21018-4	NUT, HEX MACH (4-40) DRAG	129	1	690125-1	WASHER, LAMINATED	43	
REF		21068-5	NUT, HEX MACH (6-32) FD ADJ PLATE	128	1	690124-1	WASHER, RAM	42	
		21018-7	NUT, HEX MACH (10-32) DRAG SPRING	127			SPACER, DISC	41	
		21022-2	NUT, HEX SELF-LKG (8-32) DRAG STUD	126	2	23241-6	BALL, STEEL	40	
		5-21004-7	SCR, SKT HD SHLD (250 DIA X .25) DRAG ARM	125	2	690170-1	SPRING, COMPRESSION	39	
		21004-5	SCR, SKT HD SHLD (250 DIA X 1.00) DRAG	124	1	690142-1	DISC, INSULATION	38	
2		4-21078-8	SCR, SKT SET OVAL POINT (4-40 X .75) DRAG	123	1	3-455829-0	DISC, WIRE	37	
1		21009-2	SCR, SKT SET (1/4-20 X 25) (LOC-WEL) RAM	122	1	22480-5	WASHER, SPRING	36	
				121	1	690212-1	POST, RAM	35	
				120				34	
1		1-21002-7	SCR, BTN HD SKT CAP (6-32 X .38) CAM	119				33	
REF		3-21064-2	SCR, RD HD MACH (6-32 X 1.50) FEED ADJ	118	1	458980-2	APPLICATOR, BASIC (SUB ASSY)	32	
				117				31	
2		2-21002-2	SCR, BTN HD SKT CAP (8-32 X .50) STRIPPER	116				30	
REF		2-21002-9	SCR, BTN HD SKT CAP (10-32 X .75) HSG CAP	115				29	
1		22733-8	SCR, BTN HD SKT CAP (8-32 X .38) (LOC-WEL) ANVIL	114	1	1-690451-7	SPACER, STRIPPER	28	
4		3-21002-3	SCR, BTN HD SKT CAP (1/4-20 X .50) STR GDE PL	113	1	690455-3	STRIPPER	27	
REF		2-22733-9	SCR, BTN HD SKT CAP (1/4-20 X .75) BASE PL	112	REF	455676-1	PLATE, BASE	26	
				111	2	22354-8	DRAG, STUD	25	
		2-21000-4	SCR, SKT HD CAP (6-32 X 1.00) DRAG ADAPTOR	110	1	455678-1	PLATE, STRIP GUIDE	24	
2		23030-1	SCR, SKT HD CAP (6-32 X .25) (LOC-WEL) CP DISC	109			PLATE, STRIP HOLD	23	
2		221000-9	SCR, SKT HD CAP (8-32 X .75) SHEAR BLADE	108	2	4-22281-1	SPRING, DRAG	22	
3		221000-6	SCR, SKT HD CAP (8-32 X .38) STRIP GUIDE	107		240636-1	LEVER, DRAG	21	
1		2-21000-6	SCR, SKT HD CAP (8-32 X .38) STRIP GUIDE	106	1	454177-1	DRAG, STOCK	20	
REF		3-21000-7	SCR, SKT HD CAP (10-32 X .75) FD ROD GUIDE	105	1	458030-6	GUIDE, STRIP (REAR)	19	
		3-21000-9	SCR, SKT HD CAP (10-32 X 1.00) DRAG SPRING	104	1	458031-6	GUIDE, STRIP (FRONT)	18	
REF		3-21000-6	SCR, SKT HD CAP (10-32 X .62) FD ADJ PLATE	103	REF	454178-1	GUIDE, FEED ROD	17	
REF		3-21000-4	SCR, SKT HD CAP (10-32 X .38) PIVOT BLK	102	REF	4-22284-9	SPRING, FEED RETURN	16	
2		3-21000-8	SCR, SKT HD CAP (10-32 X .88) SHEAR PLATE	101			ADAPTER, DRAG	15	
REF		455750-3	GUARD ASSY	79				14	
		465184-9	LUBRICATION ASSY	78			SPACER, HOLD DOWN	13	
		455985-1	OIL, LUBRICATING	77			SPRING, HOLD DOWN	12	
		454406-1	SPACER, LUB BRACKET	76	1	240644-1	PLATE, REAR SHEAR	11	
				75			SPACER, SHEAR PLATE	10	
				74	1	690482-7	PLATE, FRONT SHEAR	9	
REF		458109-1	WASHER, FLAT (SPECIAL)	73	1	461295-4	ANVIL	8	
2		690603-1	SPRING, ASSIST	72	1	3-690474-1	BLADE, SLUG	7	
REF		690517-1	SPACER	71			HOLD DOWN, TERMINAL	6	
		22594-8	NUT, HEX	70	1	5-230641-7	SPACER, SHEAR BLADE	5	
		240628-1	PLATE, ADJ	69	1	238009-7	SPACER, TUBULAR	4	
		240626-1	SHAFT, PIVOT	68	1	5-456134-6	CRIMPER, INSULATION	3	
		240633-1	BUSHING	67	1	455888-5	SPACER, INSULATION	2	
		455680-1	LEVER, INTERMEDIATE	66	1	455430-1	CRIMPER, WIRE	1	
		240629-1	BLOCK, PIVOT	65					
		240632-2	SCREW, ADJ	64					
		240659-3	PIN, CAM ROLLER	63					
		240658-1	CAM, ROLLER	62					
REF		454398-1	ROD, FEED	61					
				60					

CRIMPING DATA				APPLICATOR WILL APPLY	
PAD LTR	CRIMP HEIGHT	WIRE SIZE	WIRE LENGTH		
A	.134	10			60399
B	.120	12			60400
C	.116	14			61844
D	NOT USED				

CRIMP	SIZE	TYPE	FEED	APPL INST
WIRE	10	F	1.150	A1 3039
INSUL	.80	F		
WIRE RANGE	12 TO 10	INSULATION RANGE	.150 TO .210	PRESS NO
REMARKS: AMPOMATOR				

REMARKS		NO	REV
APPL USED ON MACHINE PART NO		MACH SERIAL NO	TO APPLY TERMINAL
CUSTOMER NAME		APPL SERIAL NO	DISTRIBUTION
ADDRESS		PURCHASE ORDER	ORIGINAL
CITY		ENG APP	CUSTOMER COPY
			FIELD ENG COPY

REV	DATE	BY	DESCRIPTION
A	11-1-84
B	11-1-84
C	11-1-84
D	11-1-84

THIS INFORMATION IS CONFIDENTIAL AND IS DISCLOSED TO A NON-EMPLOYEE OR CONTRACTOR WITHOUT WRITTEN AUTHORIZATION FROM AMP INCORPORATED, HARRISBURG, PA.