

Bus system flat-type plug - SACCEC-M12FSB-2CON-M16/2,0-910 - 1519574

Please be informed that the data shown in this PDF Document is generated from our Online Catalog. Please find the complete data in the user's documentation. Our General Terms of Use for Downloads are valid (<http://download.phoenixcontact.com>)



Bus system flush-type socket, PROFIBUS, 2-pos., M12, shielded, B-coded, front/screw mounting with M16 thread, with 2 m bus cable, 2 x 0.25 mm²



Key commercial data

| | |
|--------------------------------------|---|
| Packing unit | 1 1 |
| GTIN |  4 017918 940119 |
| Weight per Piece (excluding packing) | 169.6 GRM |
| Custom tariff number | 85444290 |
| Country of origin | Germany |

Technical data

Dimensions

| | |
|-----------------|-----|
| Length of cable | 2 m |
|-----------------|-----|

Ambient conditions

| | |
|---------------------------------|----------------------------------|
| Ambient temperature (operation) | -25 °C ... 85 °C (Plug / socket) |
| Degree of protection | IP67 |

General

| | |
|-----------------------|-------------|
| Rated current at 40°C | 4 A |
| Rated voltage | 60 V |
| Number of positions | 2 |
| Contact resistance | ≤ 3 mΩ |
| Insulation resistance | ≥ 100 MΩ |
| Coding | B - inverse |

Bus system flat-type plug - SACCEC-M12FSB-2CON-M16/2,0-910 - 1519574

Technical data

General

| | |
|------------------------|---|
| Standards/regulations | M12 connector IEC 61076-2-101 |
| Status display | No |
| Surge voltage category | II |
| Pollution degree | 3 |
| Test voltage | 2500 V |
| Connection method | PROFIBUS |
| Mounting type | Front mounting M16 x 1.5 With locking nut |

Material

| | |
|---|---------------------|
| Inflammability class according to UL 94 | V0 |
| Contact material | CuZn |
| Contact surface material | Ni/Au |
| Contact carrier material | PA 66 |
| Material, knurls | Nickel-plated brass |
| Sealing material | NBR |

Cable

| | |
|------------------------------------|--|
| Cable type | PROFIBUS |
| Cable type (abbreviation) | 910 |
| UL AWM style | 21198 (80°C/300 V) |
| Conductor cross section | 2x 0.25 mm ² (signal line) |
| AWG signal line | 24 |
| Conductor structure signal line | 19x 0.13 mm |
| Core diameter including insulation | 2.55 mm ±0.07 mm |
| Wire colors | Red, green |
| Overall twist | 2 cores with 2 fillers to the core |
| Shielding | Plastic-coated aluminum foil, tinned copper braided shield |
| Optical shield covering | 85 % |
| External sheath, color | Violet, RAL 4001 |
| External cable diameter D | 7.8 mm ± 0.2 mm |
| Number of bending cycles | 4000000 |
| Bending radius | 65 mm |
| Traversing path | 4.5 m |
| Traversing rate | 3 m/s |
| Acceleration | 3 m/s ² |
| Max. bending cycles | 5000000 |
| Bending radius | 80 mm |

Bus system flat-type plug - SACCEC-M12FSB-2CON-M16/2,0-910 - 1519574

Technical data

Cable

| | |
|---------------------------------|---|
| Traversing path | 4.5 m |
| Traversing rate | 3 m/s |
| Acceleration | 3 m/s ² |
| Outer sheath, material | PUR |
| Material conductor insulation | Foamed PE |
| Conductor material | Tin-plated Cu litz wires |
| Insulation resistance | ≥ 5 GΩ*km |
| Conductor resistance | 157.2 Ω/km |
| Working capacitance | 30 nF |
| Wave impedance | nom. 150 Ω ±10 % (3 MHz ... 20 MHz) |
| Shield attenuation | ≤ 4.9 dB (at 16 MHz) |
| Nominal voltage, cable | 30 V |
| Test voltage Core/Core | 1500 V (50 Hz, 1 min.) |
| Test voltage Core/Shield | 1500 V (50 Hz, 1 min.) |
| Flame resistance | UL 1581, Sec. 1060 (FT-1) |
| | IEC 60332-1 |
| Other resistance | Low adhesion |
| Ambient temperature (operation) | -40 °C ... 80 °C (cable, fixed installation) |
| | -30 °C ... 70 °C (cable, flexible installation) |

Classifications

eCl@ss

| | |
|------------|----------|
| eCl@ss 4.0 | 27140815 |
| eCl@ss 4.1 | 27140815 |
| eCl@ss 5.0 | 27143423 |
| eCl@ss 5.1 | 27143423 |
| eCl@ss 6.0 | 27143423 |
| eCl@ss 7.0 | 27449001 |
| eCl@ss 8.0 | 27449001 |

ETIM

| | |
|----------|----------|
| ETIM 2.0 | EC001297 |
| ETIM 3.0 | EC002061 |
| ETIM 4.0 | EC002061 |
| ETIM 5.0 | EC002061 |

Bus system flat-type plug - SACCEC-M12FSB-2CON-M16/2,0-910 - 1519574

Classifications

UNSPSC

| | |
|---------------|----------|
| UNSPSC 6.01 | 31251501 |
| UNSPSC 7.0901 | 31251501 |
| UNSPSC 11 | 31251501 |
| UNSPSC 12.01 | 31251501 |
| UNSPSC 13.2 | 31251501 |

Approvals

Approvals

Approvals

GOST / GOST

Ex Approvals

Approvals submitted

Approval details



Drawings

Bus system flat-type plug - SACCEC-M12FSB-2CON-M16/2,0-910 - 1519574

Dimensioned drawing

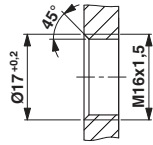

Housing cutout for M16 fastening thread, mounting panel with thread

Schematic diagram

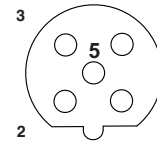

Pin assignment M12 socket, 5-pos., B-coded, female side

Cable cross section

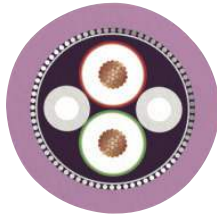

PROFIBUS [910]

Dimensioned drawing

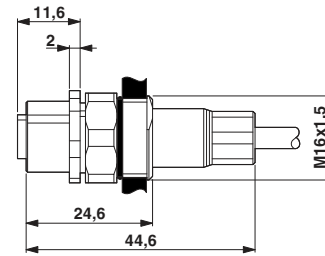

M12 flush-type connector

Circuit diagram

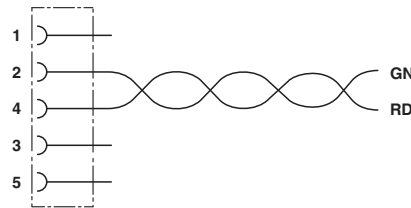

Contact assignment of the M12 socket