

RoHS COMPLIANT

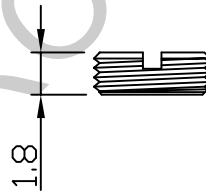
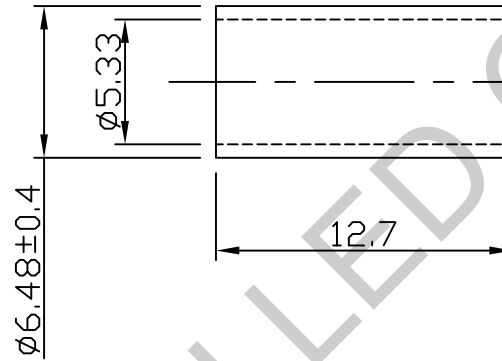
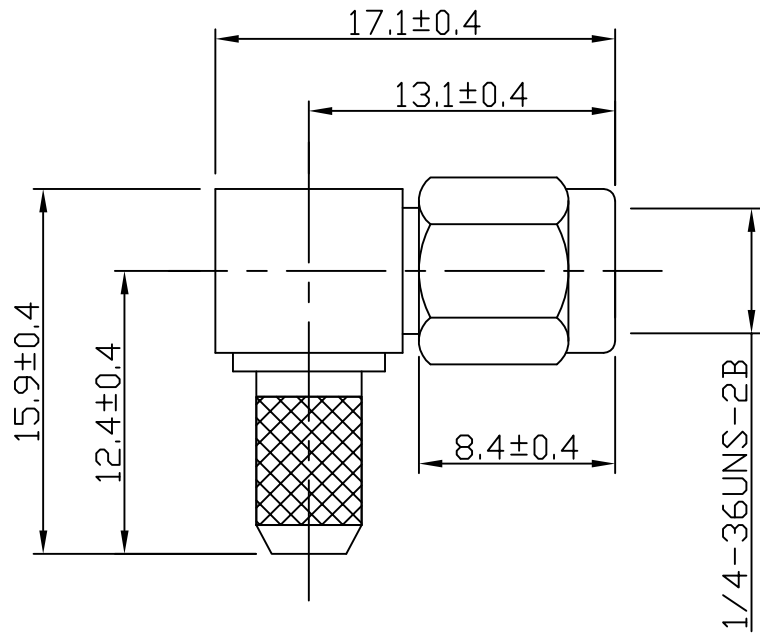

**Electrical Characteristics**

|                                     |                             |
|-------------------------------------|-----------------------------|
| Nominal Impedance:                  | 50 ohms                     |
| Frequency Range:                    | DC to 12.4 GHz              |
| VSWR:                               | 1.3:1 maximum               |
| Insertion Loss:                     | 0.2 dB at 6 GHz             |
| Operating Voltage (rms):            | 500 V maximum at sea level  |
| Dielectric Withstand Voltage (rms): | 1000 V maximum at sea level |
| Contact Resistance:                 | 2.0 milliohms maximum       |
| Insulation Resistance:              | 5000 megohms minimum        |

**Mechanical Characteristics**

|                       |                        |
|-----------------------|------------------------|
| Mating Cycles:        | 500 cycles minimum     |
| Interface Dimensions: | Conform to MIL-C-39012 |

**Environmental Characteristics**

|                    |                   |
|--------------------|-------------------|
| Temperature Range: | -65 °C to +165 °C |
|--------------------|-------------------|

| PART | DESCRIPTION                   |
|------|-------------------------------|
| 1    | Body<br>Brass, nickel plated  |
| 2    | Insulator<br>PTFE             |
| 3    | Contact<br>Brass, gold plated |
| 4    | Cap<br>Brass, nickel plated   |
| 5    | Gasket<br>Silicone, red       |

|                         |       |     |           |
|-------------------------|-------|-----|-----------|
| First Issue             | SN    | 1   | 10 Jul 02 |
| DESCRIPTION OF REVISION | APPVD | ISS | DATE      |

For stripping and assembly instructions see Drawing Number: VAIS2101



Cinch Connectivity Solutions  
7-13 Russell Way,  
Widford Industrial Estate,  
Chelmsford, Essex,  
CM1 3AA, UK.  
Tel: +44 (0) 1245 359515  
Fax: +44 (0) 1245 358938

SCALE: Not To Scale  
DIMENSIONS: mm  
TOLERANCES:  
± 0.2mm unless  
otherwise stated

DRAWN BY: S Nash  
CHECKED BY:  
APPROVED BY:  
DATE: 10 Jul 02

TITLE:  
SMA R/A Crimp Plug for RG58

PART NUMBER:  
**VS20-2051**

PAGE: 1 of 1