

DO NOT SCALE FROM THIS PRINT

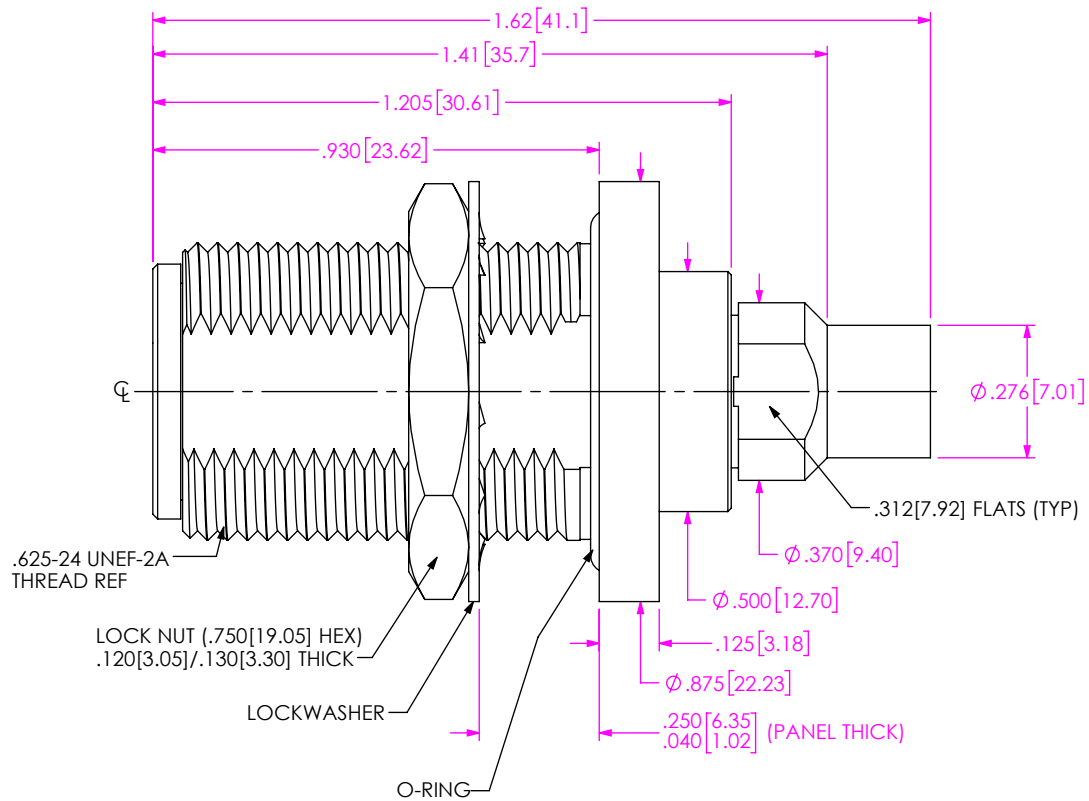

PRF06-J-C-EP-190-BS

SERIES
-06: NITPE

GENDER
-J: JACK

TYPE
-C: CABLE

TERMINATION
S: SOLDER CLAMP

ORIENTATION
-B: BULK ANGLE

CABLE TYPE
-190: SEMFLEX HP190

FINISH
-EP: 50µ" EXTRA HEAVY GOLD CENTER CONTACT, PASSIVATED OUTER CONTACT

DESIGNED & DIMENSIONED IN INCHES[MILLIMETERS]

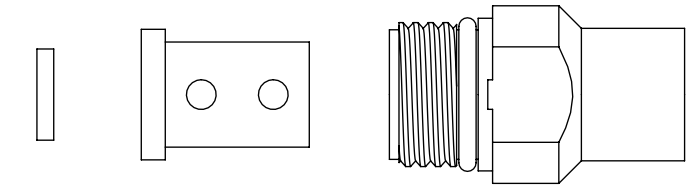
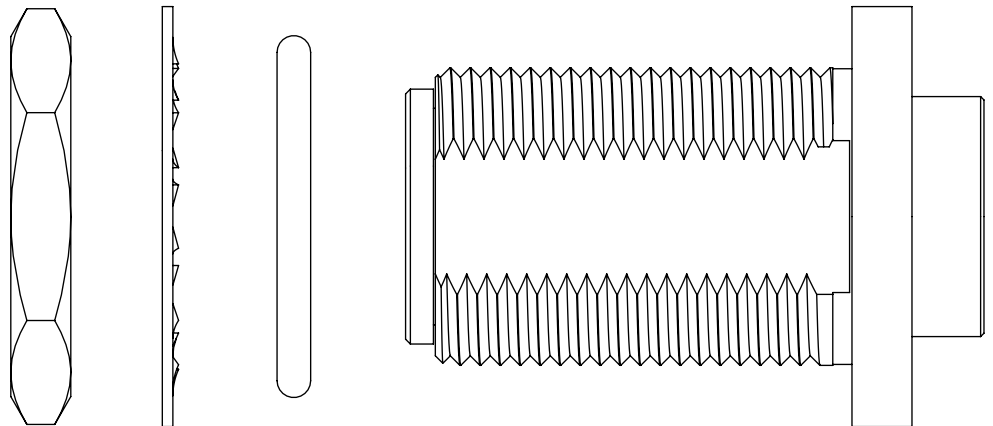
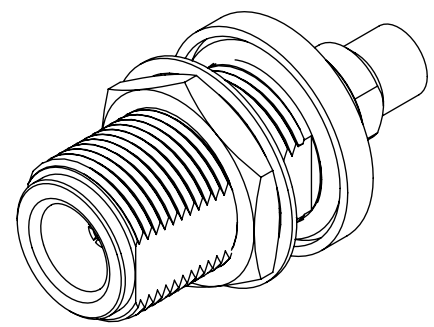

**EXPLODED VIEW
NOT TO SCALE
(FOR CLARITY ONLY)**

NOTES:

- 1. MATERIAL:**
 BODY, BUSHING, LOCK WASHER, LOCK NUT, CLAMP NUT: STAINLESS STEEL
 CONTACT: BERYLLIUM COPPER
 SOLDER FERRULE: BRASS ALLOY
 BEADS: PEI
 O-RINGS: SILICONE RUBBER
- 2. FINISH:**
 BODY, BUSHING, LOCK WASHER, LOCK NUT, CLAMP NUT: PASSIVATED
 CONTACT, SOLDER FERRULE: 50µ" MIN. GOLD OVER 50µ" MIN. NICKEL PLATE
- 3. PCI P/N: 3307**

UNLESS OTHERWISE SPECIFIED, DIMENSIONS ARE IN INCHES. TOLERANCES ARE: DECIMALS ANGLES .XX: ±.02[0.5] 1° .XXX: ±.005[0.13] .XXXX: ±.0005[0.013]	* PROPRIETARY NOTE * THIS DOCUMENT CONTAINS CONFIDENTIAL AND PROPRIETARY INFORMATION AND ALL DESIGN, MANUFACTURING, REPRODUCTION, USE, PATENT RIGHTS AND SALES RIGHTS ARE EXPRESSLY RESERVED BY SAMTEC, INC. THIS DOCUMENT SHALL NOT BE DISCLOSED, IN WHOLE OR PART, TO ANY UNAUTHORIZED PERSON OR ENTITY NOR REPRODUCED, TRANSFERRED OR INCORPORATED IN ANY OTHER PROJECT IN ANY MANNER WITHOUT THE EXPRESS WRITTEN CONSENT OF SAMTEC, INC.	
		520 PARK EAST BLVD, NEW ALBANY, IN 47150 PHONE: 812-944-6733 FAX: 812-948-5047 e-Mail: info@SAMTEC.com code 55322
DO NOT SCALE DRAWING	SHEET SCALE: 2.5:1	DESCRIPTION: N BULKHEAD JACK, SOLDER CLAMP FOR SEMFLEX HP190 CABLE
		DWG. NO. PRF06-J-C-EP-190-BS
		BY: CANDY W 05/13/2019 SHEET 1 OF 3

CABLE APPLICATION VIEWS

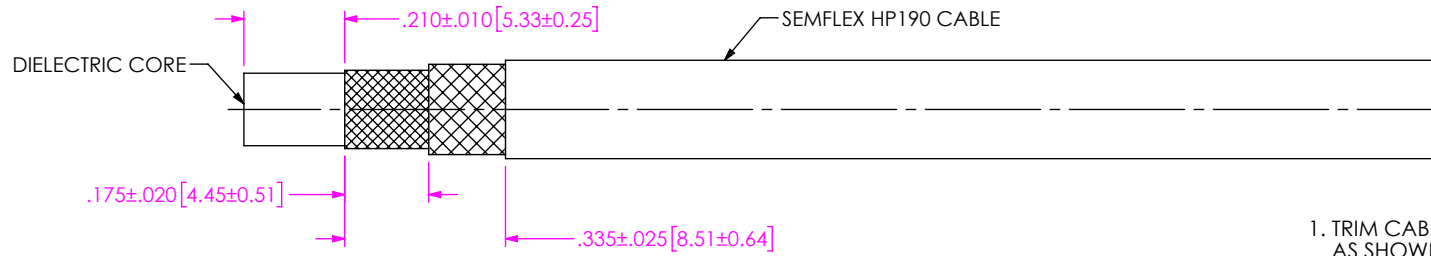

1. TRIM CABLE TO EXPOSE DIELECTRIC CORE AND OUTER BRAID AS SHOWN.

IN-PROCESS VIEW 1

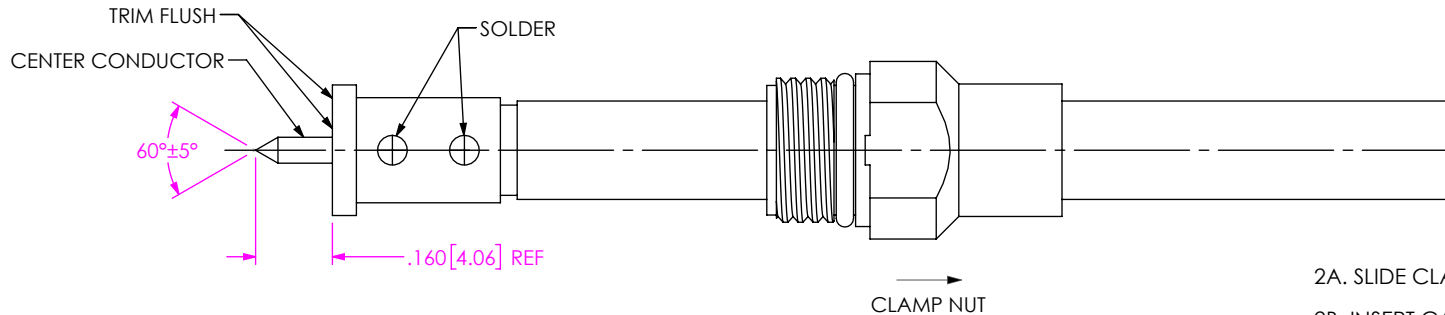

2A. SLIDE CLAMP NUT OVER CABLE IN ORIENTATION AS SHOWN.
 2B. INSERT CABLE INTO SOLDER FERRULE UNTIL BRAIDS SEATS AND SOLDER TO FERRULE WHERE SHOWN.
 2C. TRIM DIELECTRIC CORE FLUSH WITH FACE OF SOLDER FERRULE.
 2D. POINT CENTER CONDUCTOR AS SHOWN.

IN-PROCESS VIEW 2

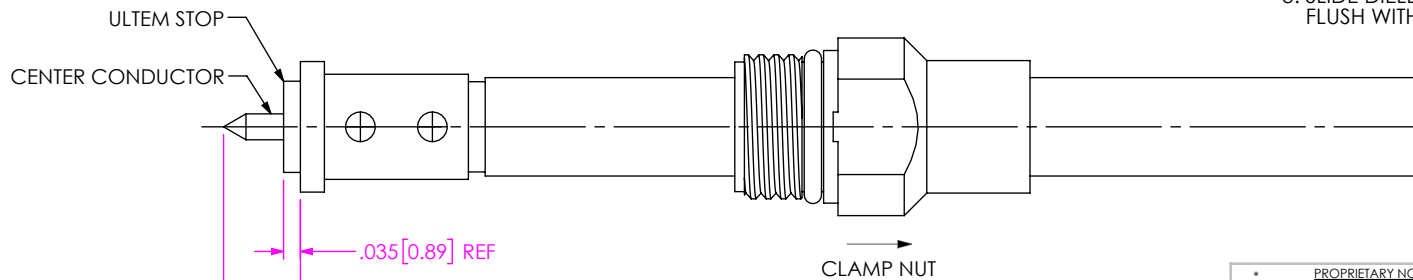

3. SLIDE DIELECTRIC STOP ONTO CABLE CENTER CONDUCTOR FLUSH WITH SOLDER FERRULE FACE.

IN-PROCESS VIEW 3

PROPRIETARY NOTE
 THIS DOCUMENT CONTAINS CONFIDENTIAL AND PROPRIETARY INFORMATION AND ALL DESIGN, MANUFACTURING, REPRODUCTION, USE, PATENT RIGHTS AND SALES RIGHTS ARE EXPRESSLY RESERVED BY SAMTEC, INC. THIS DOCUMENT SHALL NOT BE DISCLOSED, IN WHOLE OR PART, TO ANY UNAUTHORIZED PERSON OR ENTITY NOR REPRODUCED, TRANSFERRED OR INCORPORATED IN ANY OTHER PROJECT IN ANY MANNER WITHOUT THE EXPRESS WRITTEN CONSENT OF SAMTEC, INC.

DO NOT SCALE DRAWING

SHEET SCALE: 2.5:1



520 PARK EAST BLVD, NEW ALBANY, IN 47150
 PHONE: 812-944-6733 FAX: 812-948-5047
 e-Mail: info@SAMTEC.com code 55322

DESCRIPTION: N BULKHEAD JACK, SOLDER CLAMP FOR SEMFLEX HP190 CABLE

DWG. NO. PRF06-J-C-EP-190-BS

BY: CANDY W 05/13/2019 SHEET 2 OF 3

CABLE APPLICATION VIEWS

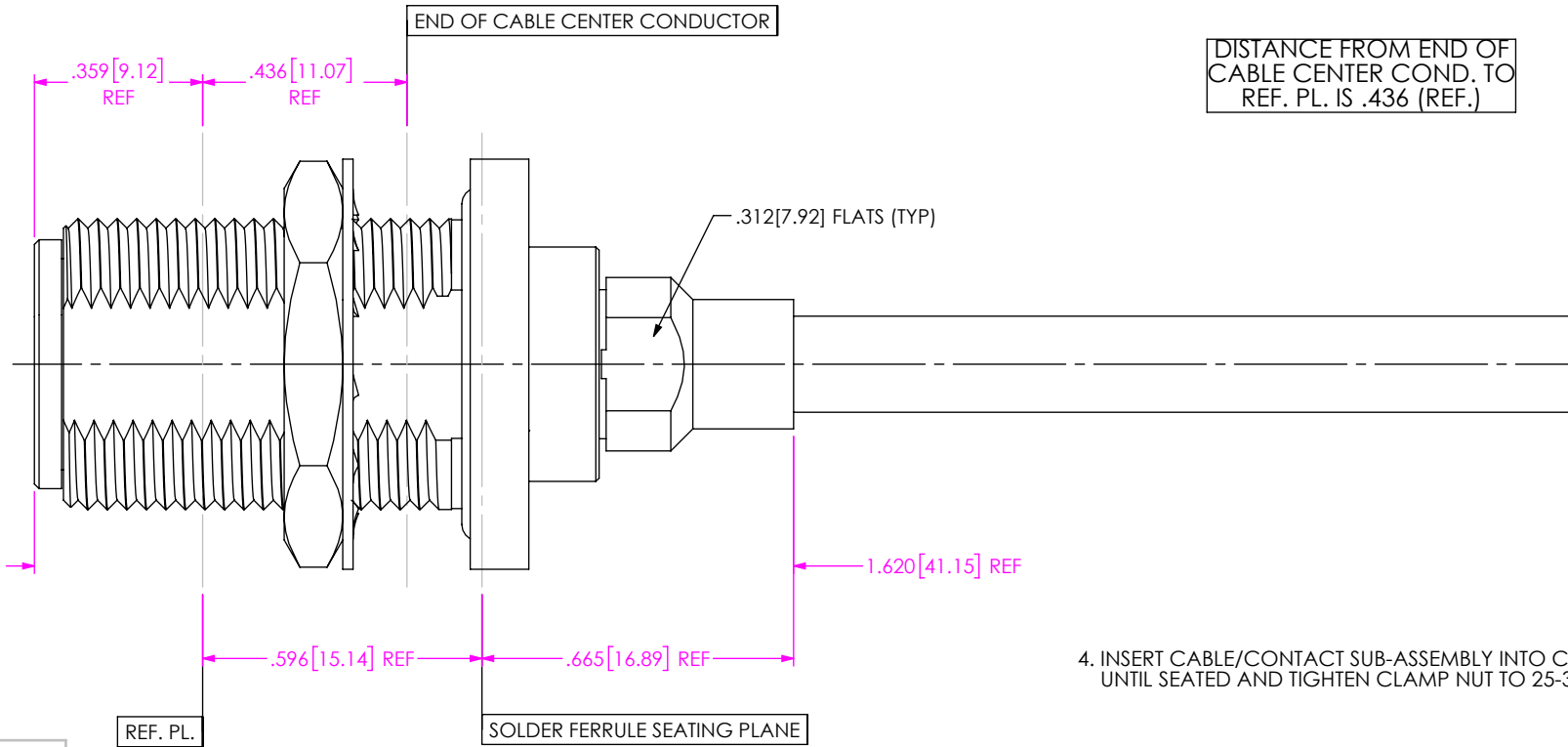

4. INSERT CABLE/CONTACT SUB-ASSEMBLY INTO CONNECTOR UNTIL SEATED AND TIGHTEN CLAMP NUT TO 25-35 IN-LBS.

IN-PROCESS VIEW 4

PROPRIETARY NOTE
 THIS DOCUMENT CONTAINS CONFIDENTIAL AND PROPRIETARY INFORMATION AND ALL DESIGN, MANUFACTURING, REPRODUCTION, USE, PATENT RIGHTS AND SALES RIGHTS ARE EXPRESSLY RESERVED BY SAMTEC, INC. THIS DOCUMENT SHALL NOT BE DISCLOSED, IN WHOLE OR PART, TO ANY UNAUTHORIZED PERSON OR ENTITY NOR REPRODUCED, TRANSFERRED OR INCORPORATED IN ANY OTHER PROJECT IN ANY MANNER WITHOUT THE EXPRESS WRITTEN CONSENT OF SAMTEC, INC.



520 PARK EAST BLVD, NEW ALBANY, IN 47150
 PHONE: 812-944-6733 FAX: 812-948-5047
 e-Mail info@SAMTEC.com code 55322

DO NOT SCALE DRAWING

SHEET SCALE: 2.5:1

DESCRIPTION: N BULKHEAD JACK, SOLDER CLAMP FOR SEMFLEX HP190 CABLE

DWG. NO. PRF06-J-C-EP-190-BS

BY: CANDY W 05/13/2019 SHEET 3 OF 3