

SEE NOTE 7

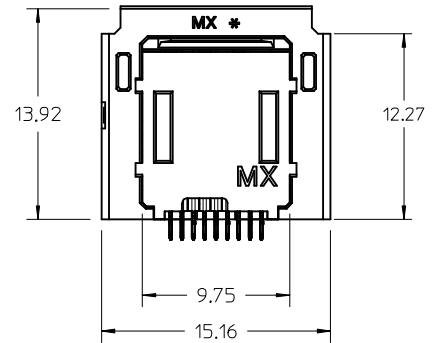
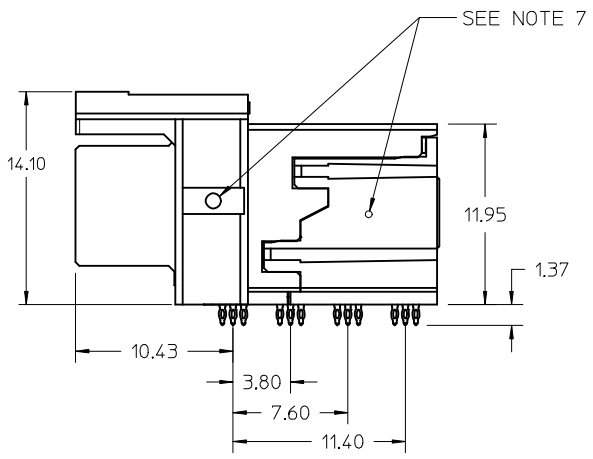
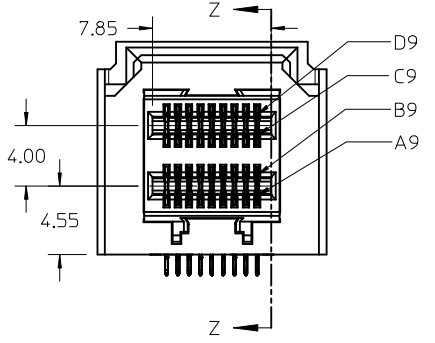
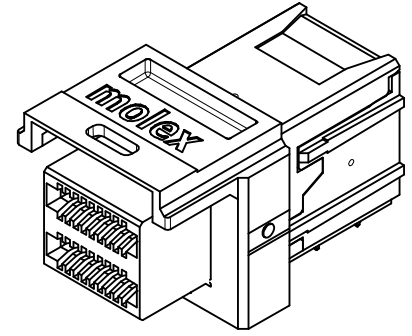
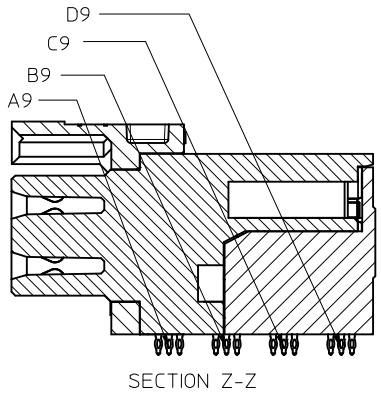

- NOTES:
- MATERIALS:  
CONNECTOR HOUSING: HIGH TEMPERATURE THERMOPLASTIC  
GLASS FILLED, UL 94V-0  
TERMINALS: COPPER ALLOY
  - FINISHES:  
CONTACT AREA: 0.76µM MIN GOLD OVER 2.54µM MIN NICKEL  
TAIL AREA:  
OPTION 1: 0.76µM-1.52µM TIN/LEAD (90/10) OVER 2.54µM MIN NICKEL  
OPTION 2: 0.76µM-1.52µM TIN (LEAD FREE) OVER 2.54µM MIN NICKEL
  - PRODUCT SPECIFICATION: PS-76867-001
  - PACKAGING SPECIFICATION: PK-76867-001
  - MATES WITH: MOLEX CABLE SERIES 100171, 100189, 100190 & 100191
  - MOUNTING HARDWARE NOT SUPPLIED, REFER TO APPLICATION SPECIFICATION AS-76867-001
  - APPROXIMATE MOLDING GATE LOCATION
  - PLUG MODULE PCB LAYOUT REFER TO SD-76866-9900

PLATING OPT.	MATERIAL NO.
OPTION 1	76867-0001
OPTION 2	76867-0011

<b>REV'D GATE LOCATION</b> IEC NO: UCP2015-4516 DRWN: TMCLELL 2015/04/28 CHKD: TMCLELLAND 2015/04/28 APPR: TMCLELL 2015/04/28	<b>QUALITY SYMBOLS</b> 	<b>GENERAL TOLERANCES (UNLESS SPECIFIED)</b>		<b>DIMENSION STYLE</b> <b>MM ONLY</b>	<b>SCALE</b> <b>4:1</b>	<b>DESIGN UNITS</b> <b>METRIC</b>	<b>THIRD ANGLE PROJECTION</b>	
		4 PLACES ± --- ± --- 3 PLACES ± --- ± .005 2 PLACES ± 0.13 ± .010 1 PLACE ± 0.25 ± --- 0 PLACE ± ±	DRAWN BY DATE KLANG 2009/05/15	<b>TITLE</b> <b>IPASS PLUS HD 1X1 ASSEMBLY INTERNAL</b>		<b>DOCUMENT NO.</b> <b>SD-76867-001</b>		<b>SHEET NO.</b> <b>1 OF 3</b>
		ANGULAR ±1/2° DRAFT WHERE APPLICABLE MUST REMAIN WITHIN DIMENSIONS	CHECKED BY DATE TMCLELLAND 2012/10/15	<b>MOLEX</b>		<b>SD-76867-001</b>		<b>THIS DRAWING CONTAINS INFORMATION THAT IS PROPRIETARY TO MOLEX INCORPORATED AND SHOULD NOT BE USED WITHOUT WRITTEN PERMISSION</b>
		<b>REV</b>	APPROVED BY DATE MBANAKIS 2010/11/17	<b>SIZE</b> <b>C</b>	<b>SEE CHART</b>			

# RECOMMENDED FOOTPRINT

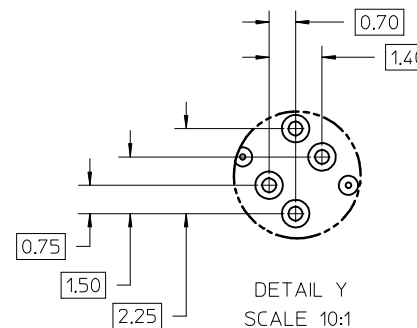
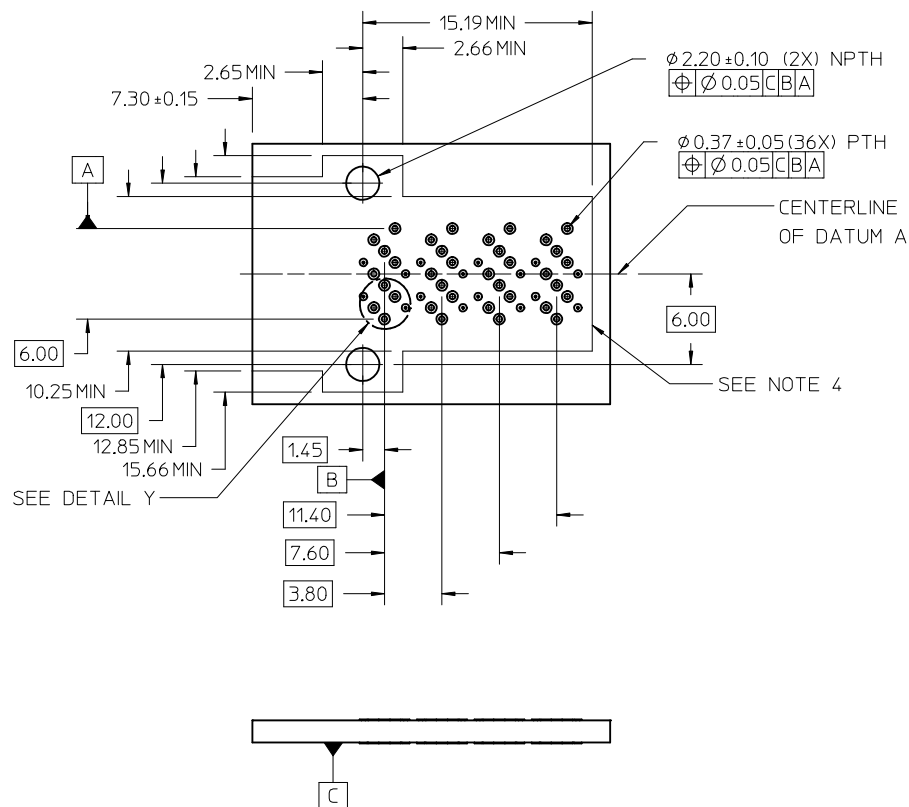

**NOTES:**

1. RECOMMENDED DRILL SIZE AND ANNULAR RING FOR A 0.37 $\phi$  FINISHED PTH - REFER TO APPLICATION SPECIFICATION AS-76867-001
2. MINIMUM RECOMMENDED SPACING: 14.00MM
3. MINIMUM PCB THICKNESS: 1.57MM
4. CONNECTOR KEEP OUT AREA

SEE SHEET 1 EC NO: UCP2015-4516 DRWN: TMCCLELL 2015/04/28 CHKD: TMCCLELL AND 2015/04/28 APPR: TMCCLELL 2015/04/28	QUALITY SYMBOLS ▽=0 ▽=0 ▽=0	GENERAL TOLERANCES (UNLESS SPECIFIED)		DIMENSION STYLE <b>MM ONLY</b>		SCALE <b>4:1</b>	DESIGN UNITS <b>METRIC</b>	THIRD ANGLE PROJECTION		
		4 PLACES ± --- ± ---	mm	INCH	DRAWN BY KLANG	DATE 2009/05/15	TITLE <b>IPASS PLUS HD 1X1 ASSEMBLY INTERNAL</b>			
		3 PLACES ± --- ± .005			CHECKED BY TMCCLELLAND	DATE 2012/10/15				
		2 PLACES ± 0.13 ± .010			APPROVED BY MBANAKIS	DATE 2010/11/17	DOCUMENT NO. <b>SD-76867-001</b>			
1 PLACE ± 0.25 ± ---			MATERIAL NO.		SHEET NO. 2 OF 3					
0 PLACE ± ±			ANGULAR ±1/2°		DRAFT WHERE APPLICABLE MUST REMAIN WITHIN DIMENSIONS		SIZE C THIS DRAWING CONTAINS INFORMATION THAT IS PROPRIETARY TO MOLEX INCORPORATED AND SHOULD NOT BE USED WITHOUT WRITTEN PERMISSION			

# FOOTPRINT CIRCUIT IDENTIFICATION

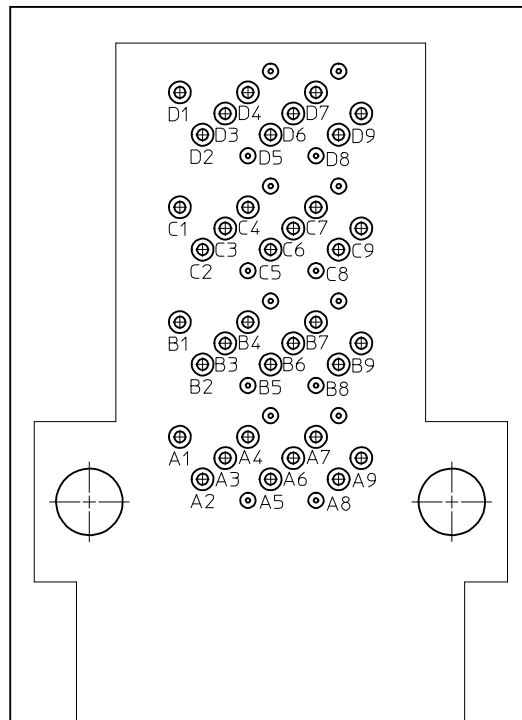

SEE SHEET 1 EC NO: UCP2015-4516 DRWN: TMCLELL 2015/04/28 CHKD: TMCLELL AND 2015/04/28 APPR: TMCLELL 2015/04/28	QUALITY SYMBOLS	GENERAL TOLERANCES (UNLESS SPECIFIED)		DIMENSION STYLE <b>MM ONLY</b>		SCALE <b>8:1</b>	DESIGN UNITS <b>METRIC</b>	THIRD ANGLE PROJECTION	
	▽=0	mm	INCH	DRAWN BY	DATE	TITLE <b>IPASS PLUS HD 1X1 ASSEMBLY INTERNAL</b>			
	▽=0	4 PLACES ± ---	± ---	KLANG	2009/05/15				
	▽=0	3 PLACES ± ---	± .005	CHECKED BY	DATE	DOCUMENT NO. <b>SD-76867-001</b>			
	▽=0	2 PLACES ± 0.13	± .010	TMCCLELLAND	2012/10/15				
REV	DESCRIPTION	ANGULAR ±1/2°		APPROVED BY	DATE	SHEET NO. <b>3 OF 3</b>			
B10		DRAFT WHERE APPLICABLE MUST REMAIN WITHIN DIMENSIONS		MBANAKIS	2010/11/17				
				MATERIAL NO.		THIS DRAWING CONTAINS INFORMATION THAT IS PROPRIETARY TO MOLEX INCORPORATED AND SHOULD NOT BE USED WITHOUT WRITTEN PERMISSION			
				SEE CHART					