

THIS DRAWING IS UNPUBLISHED.		RELEASED FOR PUBLICATION	
COPYRIGHT BY TYCO ELECTRONICS CORPORATION. ALL RIGHTS RESERVED.			
PART NUMBER	REV	FIRST USED	
565816-3	D	-	

LOC	DIST	REVISIONS					
A	66	P	LTR	DESCRIPTION	DATE	DWN	APVD
		D1		ECN 0150-0081-05	1-05	MY	TE

APPLICATOR PARTS LIST				TYPE			CRIMPING DATA				TERMINALS	
NO.	DESCRIPTION	REQ.	PART NO.	NO.	DESCRIPTION	REQ.	PART NO.					
1	WIRE CRIMPER	1	686916-2	42				TO APPLY TERMINAL				61148-
2	INS. CRIMPER	1	686917-1	43	SCREW, BUT. HD. 1/4x20	1	3-21002-2	WIRE SIZE				
3	ANVIL WIRE	1	464820-1	44				CRIMP HEIGHT				
4	ANVIL SPACER INS.	1	810685-2	45				21 .058				
5	SHEAR BLADE	1	464821-1	46				20 .059				
6	REAR SHEAR PLATE	1	385013-4	47				19 .061				
7	SHEAR BLADE SPACER - FRONT	1	374083	48	TERMINAL STOP (REF. 4)	1	686936-1	18 .063				
8	SHEAR BLADE SPACER - REAR	1	686918-1	49	DRAG STOP	1	452835-1	17 .066				
9	REAR ANVIL SPACER PLT.			50	DRAG BUSHING - FRT.	1	452836-1	CRIMP	SIZE	TYPE	FEED	
10	FRONT ANVIL SPACER PLT.			51	DRAG STUD - FRT.	1	452837-1	WIRE	.090	F		
11	TOOL SPACER			52	DRAG SPRING - FRT.	1	370572	INSUL.	.170	0	.500	
12	CRIMP SPACER	1	854652-8	53				SLEEVED				
13	FRONT STRIP GUIDE - TOP	1	691059-1	54				INSULATION RANGE	WIRE RANGE			
14	REAR STRIP GUIDE	1	379034-2	55				.095-.115	21-17 MAG.			
13A	FRONT STRIP GUIDE - BOT.	1	372895	56				EXPLODED VIEW				
15	RAM	1	471911	57				REMARKS: BUILT UP ANVIL TO RETAIN BLADE				
16	TOOL HOLDER			58				WIRE LOCATOR				
17	ADJ. CRIMP MOUNT ASSY.	1	465392-1	59				1" AIR FEED ASSY.				
18	ADJ. BLOCK			60				TENSION ADJ. PLATE				
19	APPLICATOR MOUNT ASSY.	1	471707-7	61				MISCELLANEOUS				
20	BASE PLATE			62				LUBRICATOR ASSY.				
21	BASE BLOCK			63				TERMINAL LUBRICANT REF.				
22	STRIP GUIDE PLATE			64				AIR BLAST ASSY.				
23	ANVIL HOLDER			65				ELBOW				
24	AUX. ANVIL HOLDER			66				COPPER TUBE				
25	STRIPPER	1	686914-1	67				DENOTES WEARING PARTS RECOMMEND PURCHASE REPLACEMENT				
26	STRIPPER MOUNT (REAR MT.)	1	686912-1	68				THIS APPLICATOR IS TO BE USED ON				
27	RETAINER PLATE	1	372251	69				AMP-O-ELECTRIC 1-471273-2				
28	STRIPPER SPACER ^{MT. REF} 25461	1	471505-9	70				AUTOMATIC AIR FEED				
29	STRIPPER BUSHING			71				ALIGN. GA. 679597-1				
30	STOCK DRAG	1	810917-1	72				SERIAL NO.	DATE SHIPPED	DESIGNED		
31	STOCK DRAG HANDLE	1	375382					CUSTOMER NAME AND ADDRESS				
32	STOCK DRAG STUD	1	354045-1									
33	STOCK DRAG SPRING	1	1-23847-0									
34	STOCK DRAG ADJ. SCREW	2	372997									
35	FEED FINGER HOLDER											
36	FEED FINGER	1	452817-1									
37	FEED FINGER TIP											
38	FEED FINGER SPACER											
39	BASE CASTING	1	570238									
40	GUARD	1	457664-3									
41												

AMPLIYAR ^{2/1/06 17} SEE 68149

THIS DRAWING IS A CONTROLLED DOCUMENT.		DWN	27JAN05	Tyco Electronics Corporation Harrisburg, Pa 17105-3608
		M. YOUNGER		
DIMENSIONS: INCHES		CHK	27BAM2005	END FEED STANDARD APPLICATOR
		C. ERISMAN		
TOLERANCES UNLESS OTHERWISE SPECIFIED:		APVD	28JAN2005	SIZE CAGE CODE DRAWING NO RESTRICTED TO
		T. ELBIN		
0 PLC ± -		PRODUCT SPEC		A2 00779 C-565816-3
1 PLC ± -		APPLICATION SPEC		
2 PLC ± -		WEIGHT		CUSTOMER DRAWING SCALE SHEET 1 OF 4 REV D1
3 PLC ± -				
4 PLC ± -				
ANGLES ± -				
FINISH				

AMP 830 (3/63) **APPLICATOR PARTS LIST (BOLT, NUT, SCREW, WASHER etc.)**

NO.	DESCRIPTION	SIZE	LGTH.	REQ.	PART NO.	NO.	DESCRIPTION	SIZE	LGTH.	REQ.	PART NO.
101	SCREW SOC. SET. S/L RAM PIN TO RAM (15)	1/4-20	1/2	1	21009-6	130	NUT, HEX S/L FRONT DRAG STUD (51)	8-32	~	1	21021-3
102	SCREW, HEX. HD. APPL. MT. (19) TO BASE CASTING (39)	3/8-16	1 1/4	3	3-21015-2	131	SCREW, SOC. HD. CAP DRAG STOP (49) TO APPL. MT. (19)	10-24	3/8	1	5-21000-2
103	WASHER, FLAT FRONT STRIP GUIDE (13 & 13A) TO APPL. MT. (19)	3/8 ID	~	3	371178	133	SCREW, SOC. HD. CAP	1/4-20	1/4	1	9-21001-0
104	SCREW SOC. HD. CAP REAR STRIP GUIDE (14) TO APPL. MT. (19)	8-32	5/8	2	2-21000-8	134	WASHER, LOCK BLADE (5) TO CRIMPER (1)	1/4 ID	~	1	21024-6
105	WASHER, FLAT DRAG ADJ. SCREWS (34)	8 ID	~	2	21055-6	136	SCREW, SOC. HD. CAP	1/4-20	7/8	2	21001-5
106	SCREW, SOC. HD. CAP DRAG HANDLE (31) TO DRAG (30)	8-32	3/8	2	2-21000-6	137	WASHER, FLAT AIR FEED ASSY. (64) TO BASE CASTING (39)	1/4 I.D.	~	2	21055-8
107	WASHER, FLAT R. DRAG STUDS (32)	8 I.D.	~	2	21055-6	138	SCREW SOC. HD. CAP	5-40	.25	1	6-21000-2
108	NUT, HEX ANVIL (3) ANVIL (4) SPACER (7 & 8) R. SLUG PL. (6) TO APPL. (19)	10-32	~	2	21018-7	139	WASHER, FLAT TERMINAL STOP (48) TO ANVIL, INS (9)	6 I.D.	~	1	21055-5
109	SCREW, FLAT HD. APPLICATOR ONLY TO INCLUDE	6-32	1/4	2	1-21003-8						
110	NUT, HEX. S/L CRIMPER MT. (17) SPACER (12) W. CRIMP (1) BLADE (5) TO RAM (15)	1/4-20	~	1	21022-4						
112	SCREW, SOC. HD. CAP TENSION ADJ. PLATE (65) TO FEED FINGER (36)	3/8-16	1 1/4	2	3-21001-6						
115	SCREW, SOC. HD. CAP CRIMPER INSERT (2) TO CRIMPER MT. (17)	1/4-20	1 1/2	2	21001-7						
116	SCREW, SOC. HD. CAP MT. ON-OFF VALVE OF AIR BLAST (68)	8-32	5/16	1	7-21000-4						
117	WASHER, FLAT RET. PL. (27) STRIPPER MT. (26) TO APPL. MT. (19)	8 ID	~	1	21055-6						
122	SCREW, SOC. HD. CAP STRIPPER (25) SPACER (28) LOCATOR (61) TO MOUNT (26)	8-32	5/16	1	7-21000-4						
123	WASHER, FLAT	8 ID	~	1	21055-6						
125	SCREW, SOC. HD. CAP	10-32	1/2	2	3-21000-5						
126	WASHER, FLAT	10 ID	~	2	21055-7						
118	SCREW, SOC. HD. CAP	10-32	7/8	2	3-21000-8						
119	SCREW, SOC. HD. CAP	10-32	3/4	2	3-21000-7						

NOTES: 61148

THIS DRAWING IS A CONTROLLED DOCUMENT.

DIMENSIONS: INCHES	TOLERANCES UNLESS OTHERWISE SPECIFIED: 0 PLC ± - 1 PLC ± - 2 PLC ± - 3 PLC ± - 4 PLC ± - ANGLES ± - FINISH	DWN M. YOUNGER 27 JAN 05 CHK C. ERISMAN 27 JAN 2005 APVD T. ELBIN 28 JAN 2005	tyco Electronics Tyco Electronics Corporation Harrisburg, Pa 17105-3608
MATERIAL		NAME PRODUCT SPEC APPLICATION SPEC	END FEED STANDARD APPLICATOR
		SIZE A2 CAGE CODE 00779 DRAWING NO. C-565816-3	RESTRICTED TO
		WEIGHT	SCALE 1:1 SHEET 2 OF 4 REV D1
		CUSTOMER DRAWING	

THIS DRAWING IS UNPUBLISHED. RELEASED FOR PUBLICATION
 © COPYRIGHT BY TYCO ELECTRONICS CORPORATION. ALL RIGHTS RESERVED.

LOC	DIST	REVISIONS			
P	LTR	DESCRIPTION	DATE	DWN	APVD
A	66	SEE SHEET 1	-	-	-

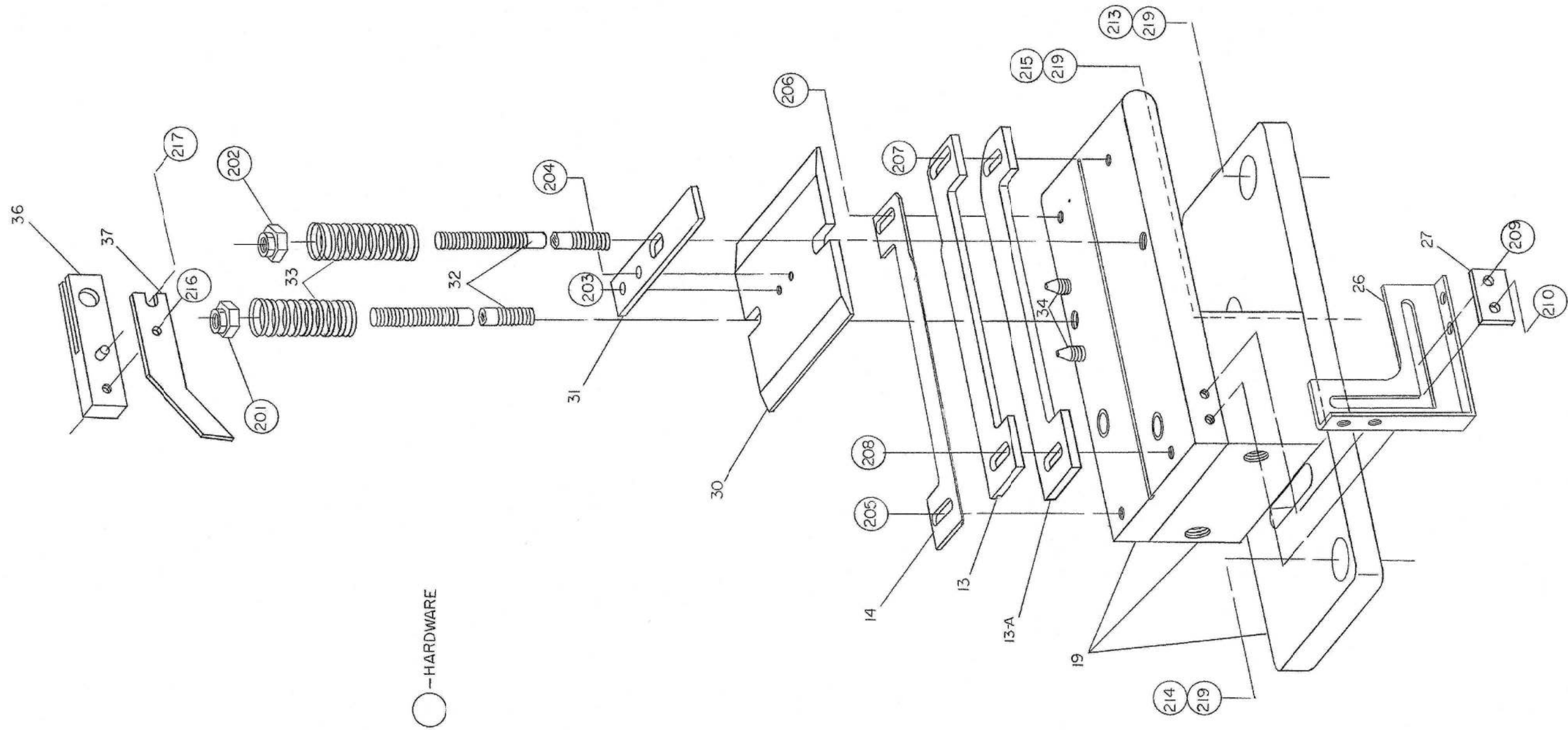

○—HARDWARE

THIS DRAWING IS A CONTROLLED DOCUMENT.		DWN M. YOUNGER 27JAN05	Tyco Electronics Corporation Harrisburg, Pa 17105-3608	
DIMENSIONS: INCHES		CHK C. ERISMAN 27BAM2005	NAME	
TOLERANCES UNLESS OTHERWISE SPECIFIED:		APVD T. ELBIN 28JAN2005	END FEED STANDARD APPLICATOR	
0 PLC	± .005	PRODUCT SPEC	SIZE	CAGE CODE
1 PLC	± .005	APPLICATION SPEC	A2	00779
2 PLC	± .005	WEIGHT	DRAWING NO C-565816-3	
3 PLC	± .005	MATERIAL	RESTRICTED TO	
4 PLC	± .005	FINISH	SCALE 1:1 SHEET 3 OF 4 REV D1	
ANGLES	± .005	CUSTOMER DRAWING		

THIS DRAWING IS UNPUBLISHED. RELEASED FOR PUBLICATION
 © COPYRIGHT BY TYCO ELECTRONICS CORPORATION. ALL RIGHTS RESERVED.

LOC	DIST	REVISIONS			
P	LTR	DESCRIPTION	DATE	DWN	APVD
A	66	SEE SHEET 1	-	-	-

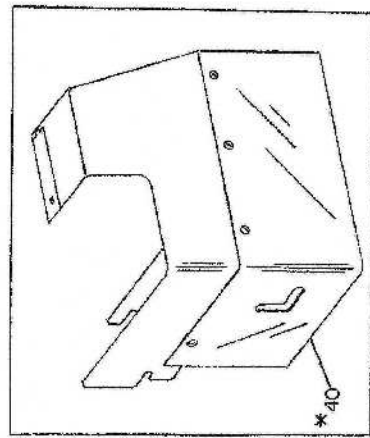
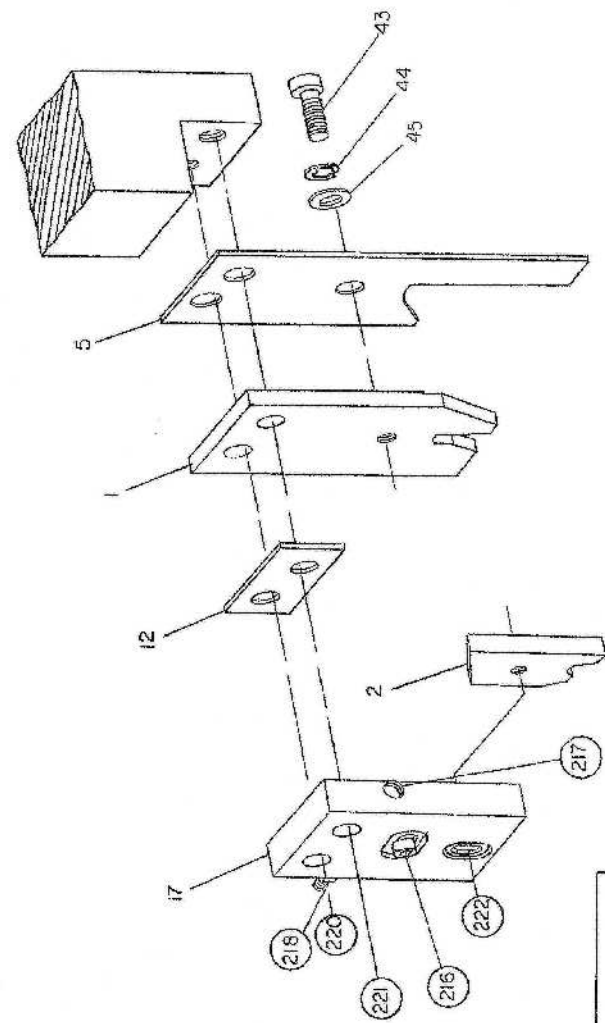

○ HARDWARE

△ OIL SPRINGLY USING VERY LIGHT OIL.

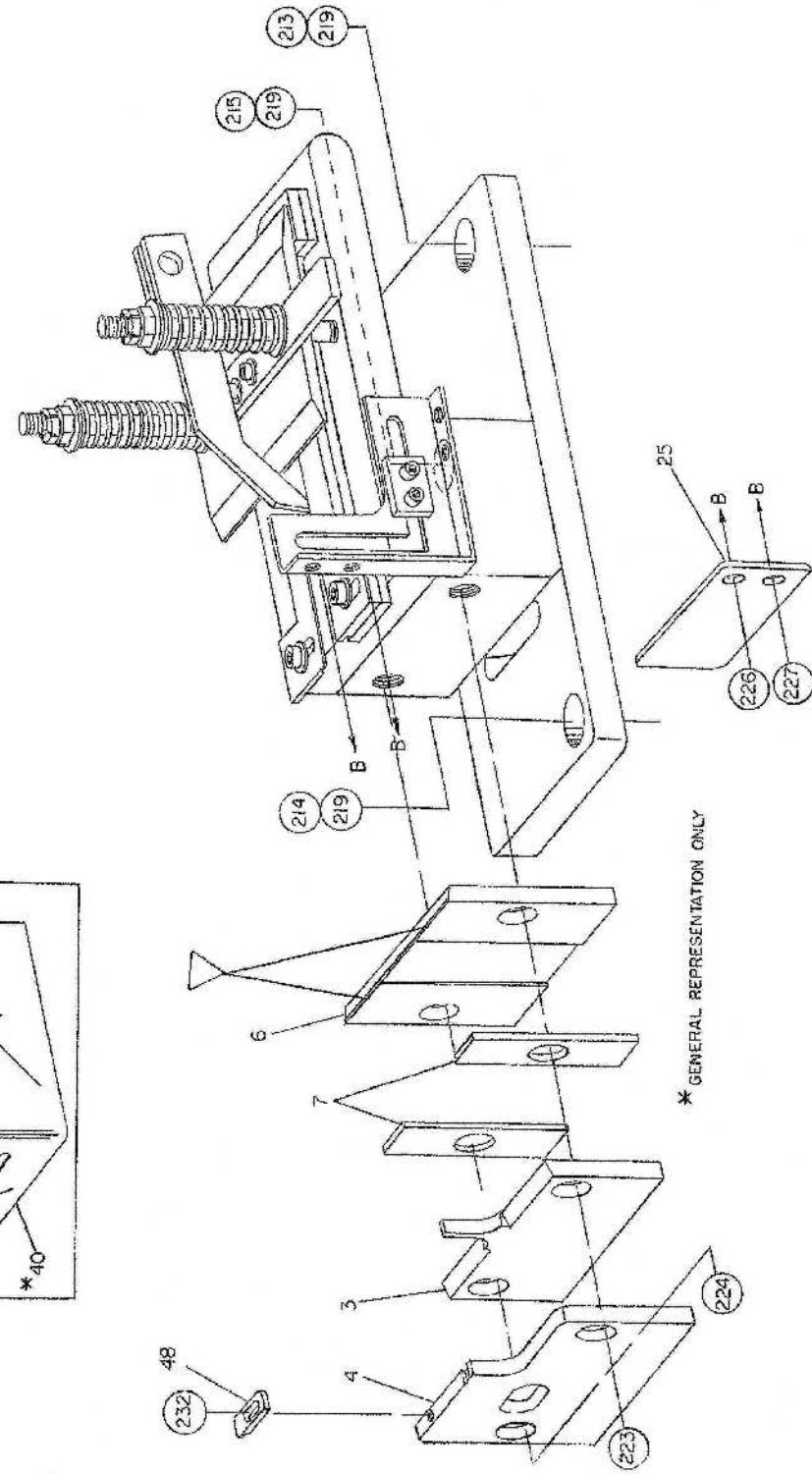

* GENERAL REPRESENTATION ONLY

THIS DRAWING IS A CONTROLLED DOCUMENT.		DWN M. YOUNGER 27JAN05	Tyco Electronics Corporation Harrisburg, Pa 17105-3608	
DIMENSIONS: INCHES		CHK C. ERISMAN 27BAM2005	END FEED STANDARD APPLICATOR	
TOLERANCES UNLESS OTHERWISE SPECIFIED:		APVD T. ELBIN 28JAN2005	NAME	RESTRICTED TO
0 PLC ± .005	1 PLC ± .005	PRODUCT SPEC	SIZE	CAGE CODE
2 PLC ± .005	3 PLC ± .005	APPLICATION SPEC	A2	00779
4 PLC ± .005	ANGLES ± .005	FINISH	DRAWING NO	DRAWING NO
MATERIAL		WEIGHT	C-565816-3	SCALE 1:1
		CUSTOMER DRAWING	SHEET 4 OF 4	REV D1