

No OF CCTS.	DIMn. A	DIMn. B
2	( 5.08 ± 0.05 ) .200 ± .002	( 9.91 ± 0.15 ) .390 ± .006
3	( 10.16 ± 0.08 ) .400 ± .003	( 14.99 ± 0.15 ) .590 ± .006
4	( 15.24 ± 0.08 ) .600 ± .003	( 20.07 ± 0.18 ) .790 ± .007
5	( 20.32 ± 0.08 ) .800 ± .003	( 25.15 ± 0.20 ) .990 ± .008
6	( 25.40 ± 0.10 ) 1.000 ± .004	( 30.23 ± 0.23 ) 1.190 ± .009
7	( 30.48 ± 0.13 ) 1.200 ± .005	( 35.31 ± 0.25 ) 1.390 ± .010
8	( 35.56 ± 0.20 ) 1.400 ± .008	( 40.39 ± 0.28 ) 1.590 ± .011
9	( 40.64 ± 0.20 ) 1.600 ± .008	( 45.47 ± 0.30 ) 1.790 ± .012
10	( 45.72 ± 0.20 ) 1.800 ± .008	( 50.55 ± 0.30 ) 1.990 ± .012
11	( 50.80 ± 0.20 ) 2.000 ± .008	( 55.63 ± 0.33 ) 2.190 ± .013
12	( 55.88 ± 0.25 ) 2.200 ± .010	( 60.71 ± 0.33 ) 2.390 ± .013

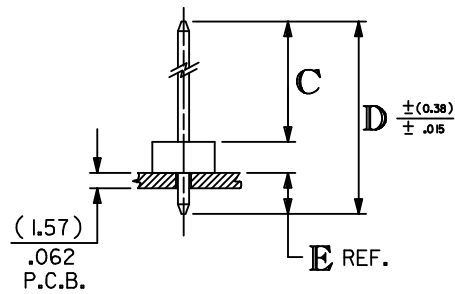
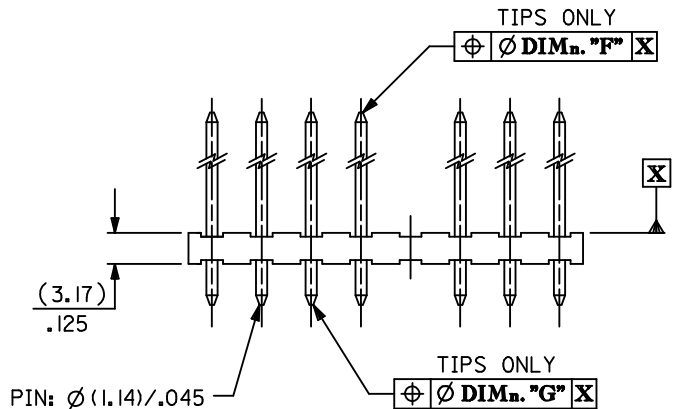

3003-N \* - \*  
 BASE No. | No. OF CCTS. | VERSION | VOID CODE  
 NO. CORRESPONDS TO CIRCUIT NO. VOIDED. MULTIPLE VOIDS START WITH 51.

- NOTES:  
 1. MATERIAL: WAFER: NYLON UL94V-2, COLOR: NATURAL PINS: BRASS  
 2. FINISH: (222) = OVERALL MATTE TIN, (0.00254)/.000100 MIN. OVER (0.00127)/.000050 MIN. NICKEL  
 3. PRODUCT SPECIFICATION: PS-99020-0087  
 4. PIN PUSH OUT FORCE: (1.36KG)/3LBS MIN.  
 5. PIN MUST MEET MOLEX SOLDERABILITY SPEC. ES-152.  
 6. MAX. BOW: (0.38)/.015 OVER (25.4)/1.00  
 7. FOR DIMENSIONS "C", "D", "E", "F" AND VERSIONS, SEE CHARTS ON SHEET 2 AND SUBSEQUENT SHEETS.  
 8. FOR VERSIONS WITH VOIDS, SEE SHEET 4.  
 9. CIRCUIT 1 IS USED TO DEFINE VOID LOCATION. CIRCUIT 1 MAY OR MAY NOT LINE UP WITH CIRCUIT 1 ON MATING PART.  
 10. THIS PART CONFORMS TO CLASS B REQUIREMENTS OF COSMETIC SPECIFICATION PS-45499-002.

REMOVE AE-3003-NC EEC NO: UCP2013-0223 DRWN:MMSTROH 2012/06/08 CHKD:MKIPPER 2012/07/18 APPR:FSMITH 2012/07/25	DESCRIPTION BP1	QUALITY SYMBOLS $\nabla F=0$ $\nabla E=0$ $\nabla F=0$	GENERAL TOLERANCES (UNLESS SPECIFIED)	DIMENSION STYLE MM/IN	SCALE 2:1	DESIGN UNITS METRIC	THIRD ANGLE PROJECTION
		4 PLACES ± --- ± ---	DRAWN BY DBYRNES	DATE 02/11/22	TITLE KK (5.08)/.200 VERTICAL HEADER ASSEMBLY ROUND PIN		
		3 PLACES ± --- ± .010	CHECKED BY BMAGUIRE	DATE 02/11/22			
		2 PLACES ± 0.25 ± .014	APPROVED BY FSMITH	DATE 2010/12/06			
1 PLACE ± 0.35 ± ---	ANGULAR ± --- °	DRAFT WHERE APPLICABLE MUST REMAIN WITHIN DIMENSIONS	MATERIAL NO. SEE CHART	DOCUMENT NO. SDAE-3003-N*	SHEET NO. 1 OF 4		
0 PLACE ± ±	SIZE B	THIS DRAWING CONTAINS INFORMATION THAT IS PROPRIETARY TO MOLEX INCORPORATED AND SHOULD NOT BE USED WITHOUT WRITTEN PERMISSION					

INDEX: FOR FULL DIMENSIONS SEE RELEVANT SHEET.

ENG. No.	PLATING	DIM. C	DIM. D	SHT. No.
AE-3003-NA	( 222 )	(11.94) / .470	(19.05) / .750	3
AE-3003-NB	( 222 )	(16.69) / .657	(23.80) / .937	3
AE-3003-NI	( 222 )	(13.51) / .532	(20.32) / .800	3

FOR VOID VERSIONS SEE SHEET 4.

SEE SHEET 1 EC NO: UCP2013-0223 DRWN:MMSTROH 2012/06/08 CHKD:KKIPPER 2012/07/18 APPR:FSMITH 2012/07/25	QUALITY SYMBOLS ∇=0 ∇=0 ∇=0	GENERAL TOLERANCES (UNLESS SPECIFIED) 4 PLACES ± --- ± --- 3 PLACES ± --- ± .010 2 PLACES ± 0.25 ± .014 1 PLACE ± 0.35 ± --- 0 PLACE ± ±	DIMENSION STYLE MM/IN DRAWN BY DATE DBYRNES 02/11/22 CHECKED BY DATE BMAGUIRE 02/11/22 APPROVED BY DATE FSMITH 2010/12/06	SCALE 1:1 DESIGN UNITS METRIC	THIRD ANGLE PROJECTION TITLE KK (5.08)/.200 VERTICAL HEADER ASSEMBLY ROUND PIN
	DESCRIPTION BP1	ANGULAR ± --- ° DRAFT WHERE APPLICABLE MUST REMAIN WITHIN DIMENSIONS	MATERIAL NO. SEE CHART	DOCUMENT NO. SDAE-3003-N*	SHEET NO. 2 OF 4
	THIS DRAWING CONTAINS INFORMATION THAT IS PROPRIETARY TO MOLEX INCORPORATED AND SHOULD NOT BE USED WITHOUT WRITTEN PERMISSION				
	molex				

10	9	8	7	6	5	4	3	2	1
ENG. NO.	AE-3003-NA		AE-3003-NB		AE-3003-NI				
DIMN. "C"	(11.94 ±0.51) .470 ±.020		(16.69 ±0.51) .657 ±.020		(13.51 ±0.51) .532 ±.020				
DIMN. "D"	(19.05) / .750		(23.80) / .937		(20.32) / .800				
DIMN. "E"	(3.94) / .155		(3.94) / .155		(3.63) / .143				
DIMN. "F"	(1.02) / .040		(1.02) / .040		(1.02) / .040				
DIMN. "G"	(1.02) / .040		(1.02) / .040		(1.02) / .040				
PLATING	(222)		(222)		(222)				

NO. OF CIRCUITS	PART NO.		ENG NO.		PART NO.		ENG NO.	
	2	10-08-102I	AE-3003-2A	10-08-102Z	AE-3003-2B	10-08-1029	AE-3003-2I	
3	▲ -103I	▲ -3A	▲ -103Z	▲ -3B	▲ -1039	▲ -3I		
4	-104I	-4A	-104Z	-4B	-1049	-4I		
5	-105I	-5A	-105Z	-5B	-1059	-5I		
6	-106I	-6A	-106Z	-6B	-1069	-6I		
7	-107I	-7A	-107Z	-7B	-1079	-7I		
8	-108I	-8A	-108Z	-8B	-1089	-8I		
9	-109I	-9A	-109Z	-9B	-1099	-9I		
10	-110I	-10A	-110Z	-10B	-1109	-10I		
11	▼ -111I	▼ -11A	▼ -111Z	▼ -11B	▼ -1119	▼ -11I		
12	10-08-112I	AE-3003-12A	10-08-112Z	AE-3003-12B	10-08-1129	AE-3003-12I		

SEE SHEET 1 EC NO: UCP2013-0223 DRWN:MMSTROH 2012/06/08 CHKD:MKIPPER 2012/07/18 APPR:FSMITH 2012/07/25	QUALITY SYMBOLS	GENERAL TOLERANCES (UNLESS SPECIFIED)	DIMENSION STYLE	SCALE	DESIGN UNITS	THIRD ANGLE PROJECTION
	▽/0	4 PLACES ± --- ± ---	MM/IN	1:1	METRIC	KK (5.08)/.200 VERTICAL HEADER ASSEMBLY ROUND PIN <b>molex</b>
	▽/0	3 PLACES ± --- ± .010	mm INCH	DRAWN BY DATE	TITLE	
	▽/0	2 PLACES ± 0.25 ± .014	DBYRNES 02/11/22	CHECKED BY DATE		
	1 PLACE ± 0.35 ± ---	BMAGUIRE 02/11/22	APPROVED BY DATE			
		0 PLACE ± ±	FSMITH 2010/12/06	MATERIAL NO.	DOCUMENT NO.	SHEET NO.
		ANGULAR ± --- °	SEE CHART	SDAE-3003-N*		3 OF 4
		DRAFT WHERE APPLICABLE MUST REMAIN WITHIN DIMENSIONS	THIS DRAWING CONTAINS INFORMATION THAT IS PROPRIETARY TO MOLEX INCORPORATED AND SHOULD NOT BE USED WITHOUT WRITTEN PERMISSION			

10 9 8 7 6 5 4 3 2 1

WAFERS WITH VOIDS:

No. OF CCTS	ENG. NO.	PART NO.	VOID CCT. LOCATION	FOR DIMns. SEE WAFER No.	PLATING
3	AE-3003-3A-2	38-00-5931	2	↑ AE-3003-NA ↓	↑ 222 ↓
4	AE-3003-4A-2	38-00-6865	2		
4	AE-3003-4A-51	38-00-0205	2,3		
6	AE-3003-6A-51	10-08-1067	2,4,5		
9	AE-3003-9A-2	10-08-1098	2		
10	AE-3003-10A-2	10-08-1108	2		
12	AE-3003-12A-51	10-08-1128	4,7		

SEE SHEET 1 DEC NO: UCP2013-0223 DRW:MMSTROH 2012/06/08 CHKD:HKIPPER 2012/07/18 APPR:FSMITH 2012/07/25 BP1	QUALITY SYMBOLS	GENERAL TOLERANCES (UNLESS SPECIFIED)	DIMENSION STYLE	SCALE	DESIGN UNITS	THIRD ANGLE PROJECTION
	$\nabla=0$ $\nabla=0$ $\nabla=0$	mm INCH	MM/IN	1:1	METRIC	
		4 PLACES ± --- ± ---	DRAWN BY DATE	KK (5.08)/.200 VERTICAL HEADER ASSEMBLY ROUND PIN <b>molex</b> DOCUMENT NO. SDAE-3003-N* SHEET NO. 4 OF 4		
		3 PLACES ± --- ± .010	CHECKED BY DATE			
		2 PLACES ± 0.25 ± .014	BMAGUIRE 02/11/22			
	1 PLACE ± 0.35 ± ---	APPROVED BY DATE				
	0 PLACE ± ±	FSMITH 2010/12/06				
	ANGULAR ± --- °	MATERIAL NO.	SEE CHART			
	DRAFT WHERE APPLICABLE MUST REMAIN WITHIN DIMENSIONS	SIZE B	THIS DRAWING CONTAINS INFORMATION THAT IS PROPRIETARY TO MOLEX INCORPORATED AND SHOULD NOT BE USED WITHOUT WRITTEN PERMISSION			

9 8 7 6 5 4 3 2 1