

LOC		DIST		REVISIONS			
TR	BY	DATE	DESCRIPTION	DATE	OWN	APVD	
C			REVISED PER EC 0513-0122-02	22APR02	DD	CC	

- 1 MATERIAL: HOUSING - NYLON, UL94V-0 (COLOR - BLACK).
CONTACTS - 0.25 THK COPPER ALLOY.
- 2 CONTACT FINISH: 0.003 MIN THK TIN-LEAD OVER 0.00127 MIN THK NICKEL, ALL OVER.
- 3 CONTACT OMITTED FROM POSITION SHOWN.
- 4. SOLDER TAIL MEETS AMP SOLDERABILITY SPECIFICATION 109-11-2.
- 5. MATES WITH SIMILARLY PLATED AMP-DUAC™ POWER CONNECTOR RECEPTACLE HOUSINGS/SOCKET CONTACTS.

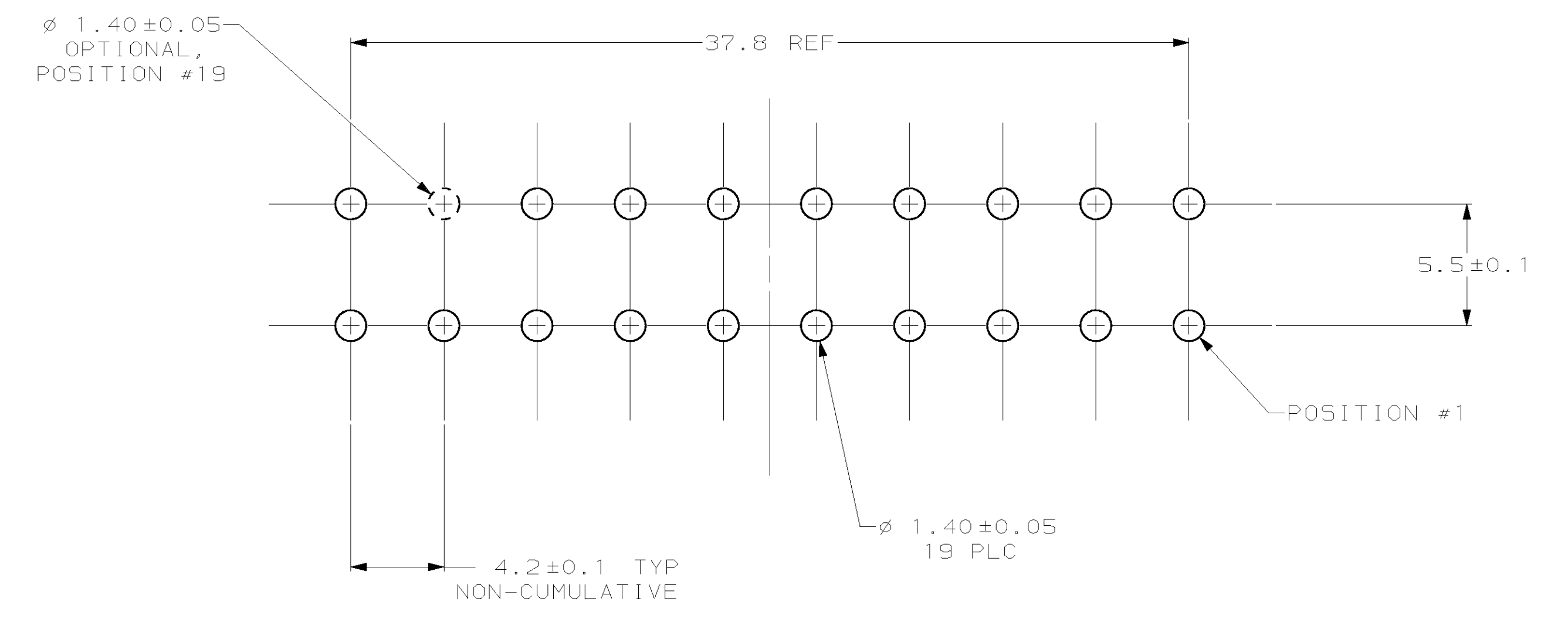

RECOMMENDED MOUNTING HOLE PATTERN FOR 1.78 MAX THICK P.C. BOARD COMPONENT SIDE SHOWN

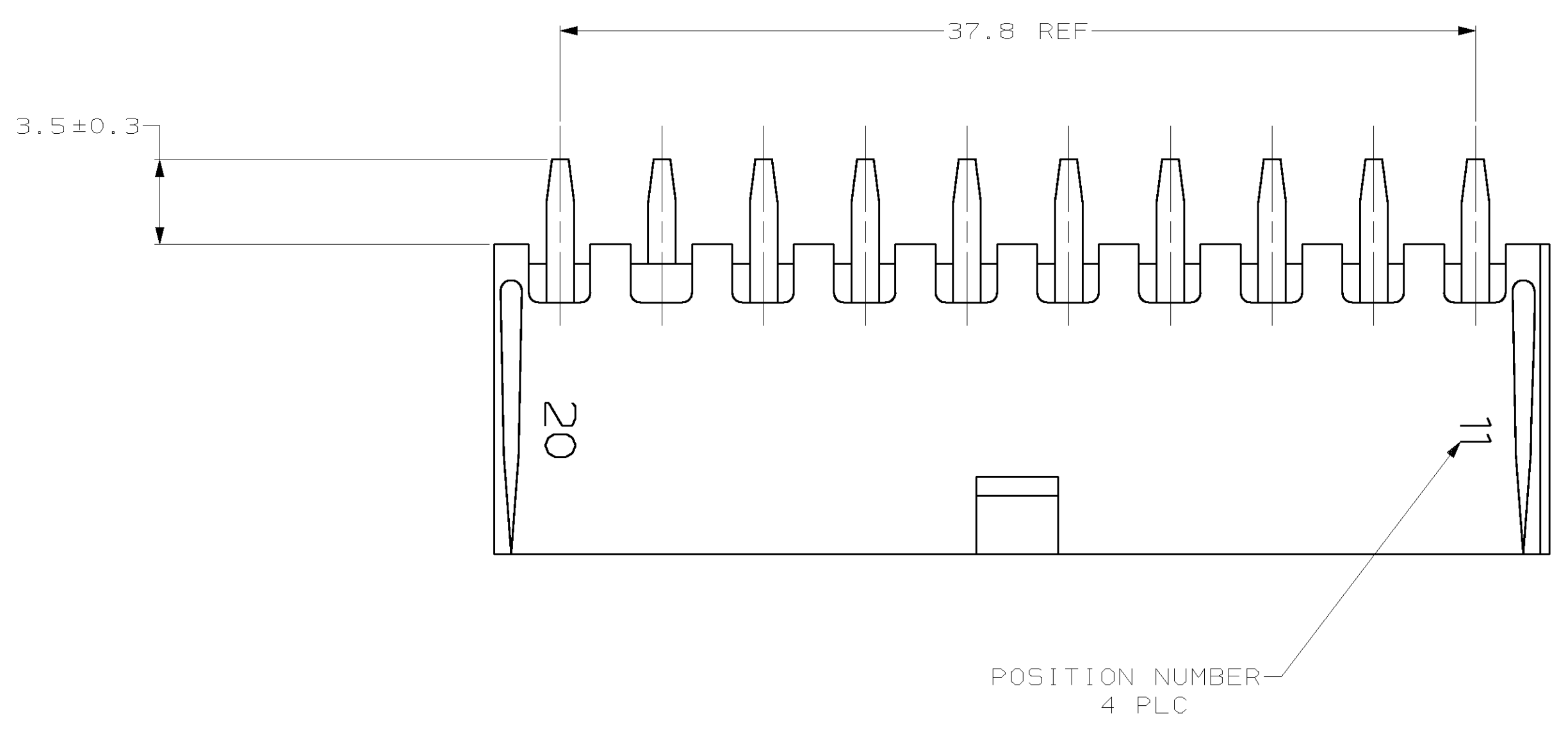
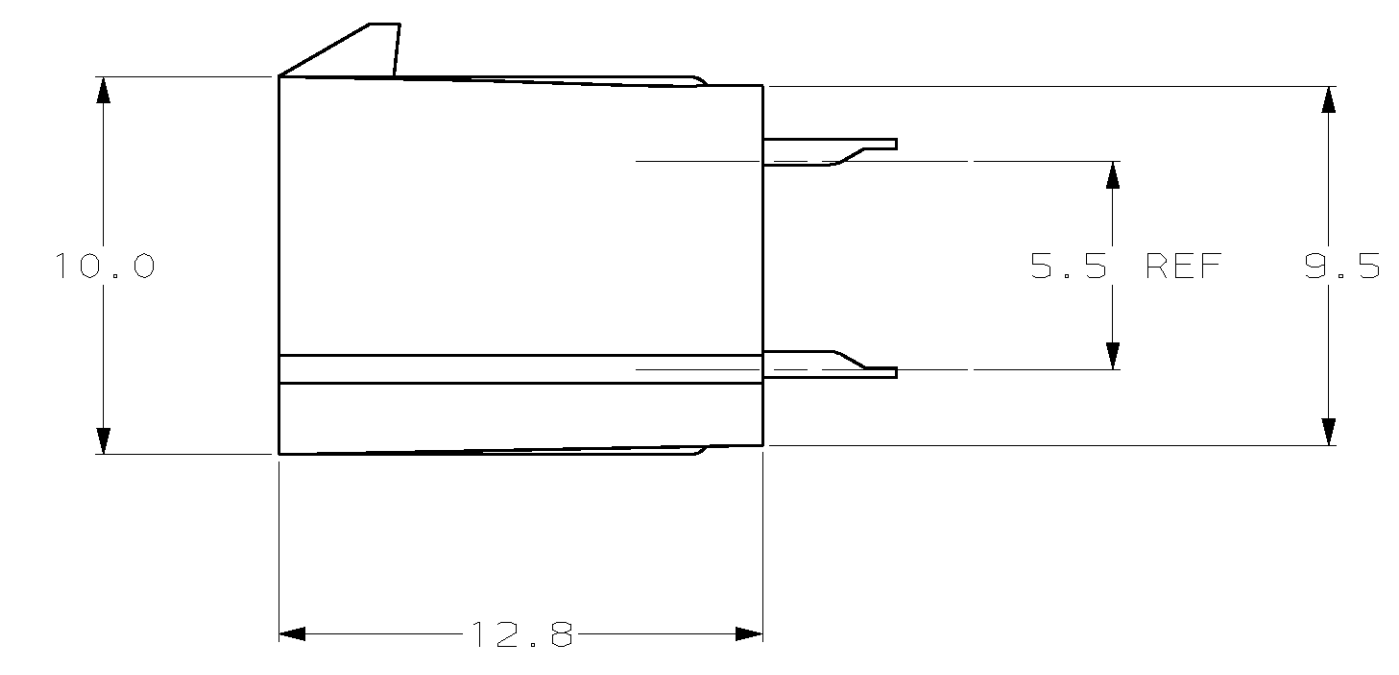
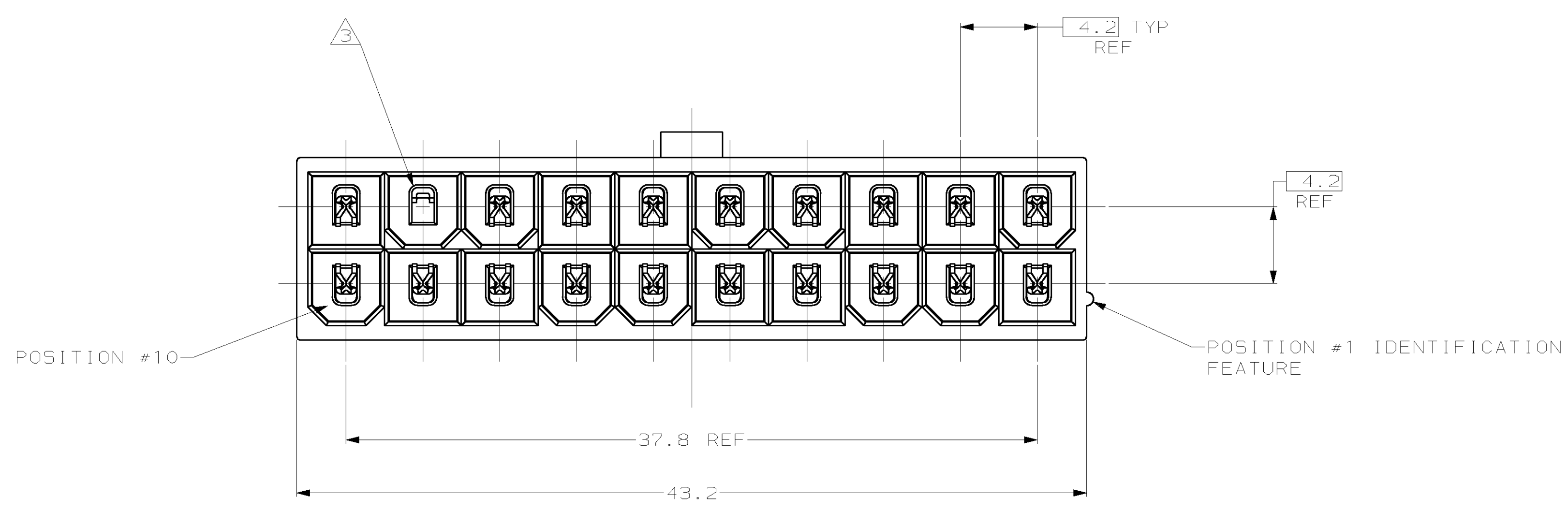

CONTACT		HOUSING		PART NUMBER	
MATERIAL	FINISH	MATERIAL	COLOR	794430-1	
THIS DRAWING IS A CONTROLLED DOCUMENT.		AMP Incorporated Harrisburg, PA 17105-3608		AMP	
DIMENSIONS: mm		TOLERANCES UNLESS OTHERWISE SPECIFIED:		PRODUCT SPEC: 108-1699	
0 PLC	±-	APVD: CASH		APPLICATION SPEC	
1 PLC	±0.2	APVD: SWING		NAME: ASSEMBLY, HEADER, HI-TEMP, VERTICAL, 20 POSITION, CIRCUIT 19 OMITTED, AMP-DUAC™ POWER CONNECTOR	
2 PLC	±0.13	APVD: CASH		SIZE: A1	
3 PLC	±-	APVD: SWING		SCALE: 5:1	
4 PLC	±-	APVD: CASH		SHEET: 1 of 1	
ANGLES	±-	APVD: SWING		REV: C	
MATERIAL: SEE TABLE		FINISH: SEE TABLE		CUSTOMER DRAWING	
		WEIGHT: -		DRAWING NO: 00779	
				DRAWING NO: 794430	