

used for: DIN EN 60603 TYPE "F"

SEE NOTE 3

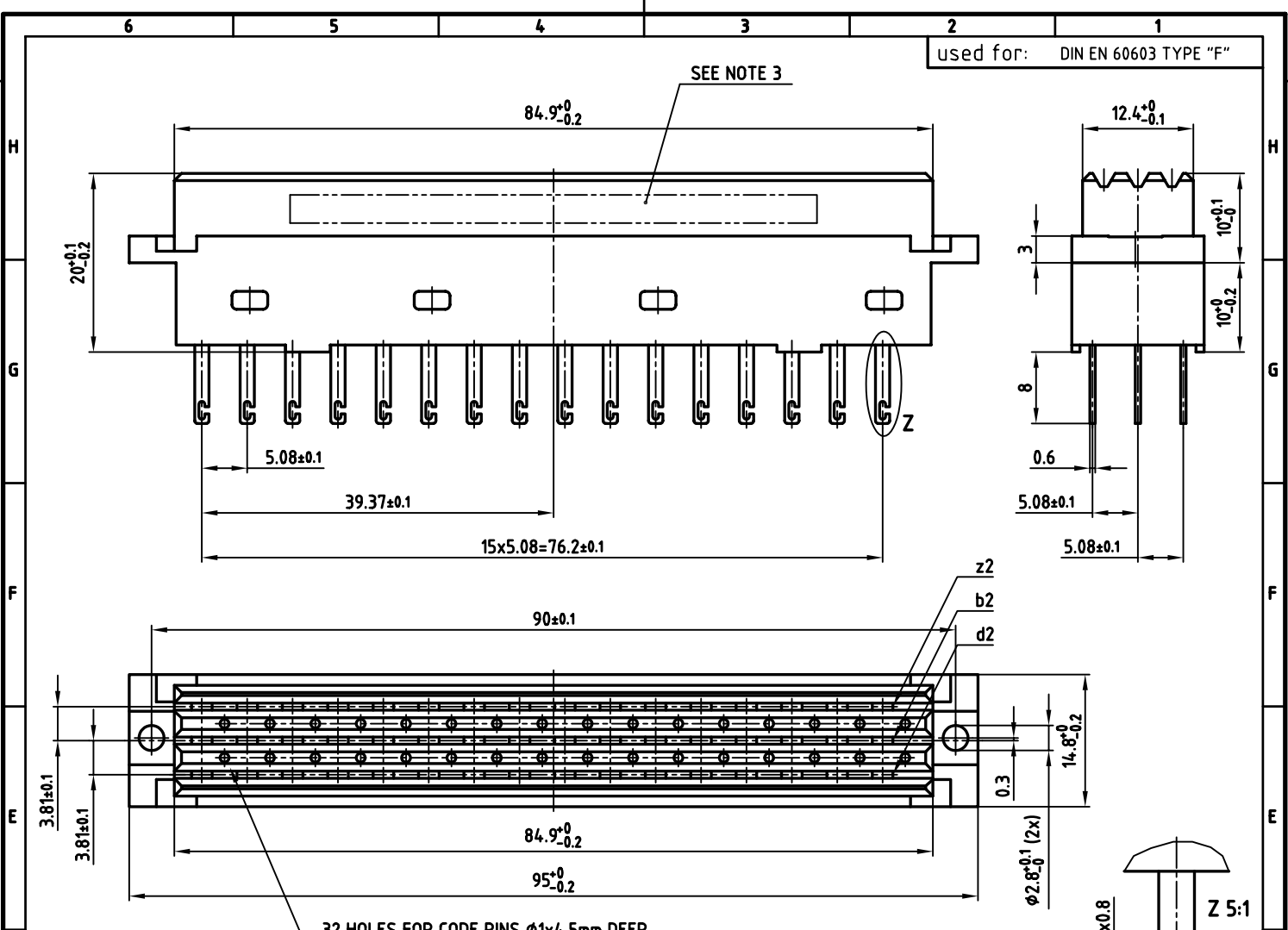

32 HOLES FOR CODE PINS $\phi 1 \times 4.5$ mm DEEP

NOTES:

1. INSULATOR: PBT GF UL 94 V-0; GREY
2. CONTACTS: COPPER ALLOY
PLATING: GOLD OVER NICKEL
50 MATING CYCLES
3. CONNECTOR IS PART MARKED: 122A11119X CONEC ABC

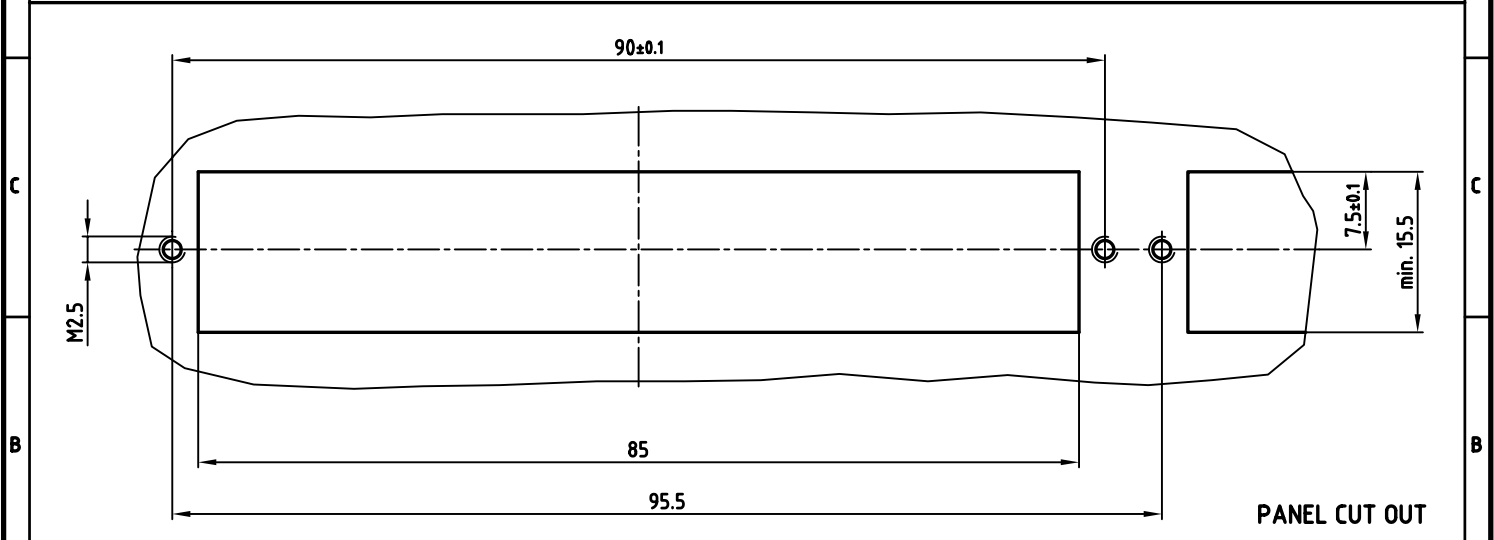

PANEL CUT OUT

APPROVAL # FREIGABE # DEBLOCAGE # AUTORIZACION # APPROVAL		tolerance		scale: 2:1 (5:1)	
CUSTOMER APPROVAL DATE:		dim. in mm		material: SEE NOTES	
NAME: TITLE:		2004 date name		title:	
COMPANY NAME:		drawn 14.07. Lehmenkühler		FEMALE CONNECTOR TYPE "F"	
APPROVAL # FREIGABE # DEBLOCAGE # AUTORIZACION # APPROVAL		appd. 14.07. Mickenbecker		48pos. SOLDER LUG	
THIS DRAWING MAY NOT BE COPIED OR REPRODUCED IN ANY WAY, AND MAY NOT BE PASSED ON TO A THIRD PARTY, WITHOUT WRITTEN PERMISSION. OWNERSHIP AND COPYRIGHT OF CONEC GmbH DO NOT ALTER CAD DRAWING BY HAND		norm DIN EN 60603		dwg no: AutoCAD 2004 DIN-A	
rev. description date name		d-old		12K1A314	
CONEC		part no: 122A11119X		3 sh: 1/1	