

P.C.B. HOLE DRILLINGS

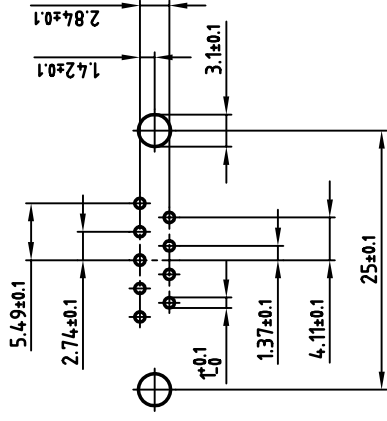

used for: D-SUB

NOTES:

1. METALSHELLS: STEEL; min. 320µ" TIN
2. INSULATORS: PBT GF UL 94 V-0, BLACK
3. CONTACTS: COPPER ALLOY
4. THREADED LOCK / SPACER CLIP: COPPER ALLOY; min. 200µ" TIN over 80µ" NICKEL
PCB-HOLE: $\phi 3.1 \pm 0.1$; PCB THICKNESS 1.6mm
5. COLLAR: COPPER ALLOY; min. 200µ" TIN over 80µ" NICKEL
6. MAXIMUM TORQUE VALUE FOR THREAD: 6" LBS
7. CONNECTOR IS PART MARKED: 164A16719X CONEC Y/WW
8. = CRITICAL DIMENSION

THIS DRAWING MAY NOT BE COPIED OR REPRODUCED IN ANY WAY, AND MAY NOT BE PASSED ON TO A THIRD PARTY WITHOUT WRITTEN PERMISSION.
 OWNERSHIP AND COPYRIGHT OF CONEC GMBH DO NOT ALTER CAD DRAWING BY HAND

tolerance		name	
2001	date	10.09.	E. Mickenbecker
	drawn	10.09.	A. Mickenbecker
	appd.		
	norm	DIN 41552	
	4-old		

scale:	2:1
material:	SEE NOTES
title:	D-SUB FEMALE
	9pos. SOLDER PIN STRAIGHT
	with threaded lock and spacer clip
dwg no:	AutoCAD 2000
	DIN-A
	3
	sh: 1/1
part no:	164A16719X



rev.	description	date	name