



STANDARD EXECUTIONS

- **DVC.2:** bushing with threaded blind hole, threaded stud and base plate in polished zinc-plated steel, vibration-damper body in natural rubber NR, black colour, hardness 40, 55, 70 Shore A ± 5 .
- **DVC.2-SST:** bushing with threaded blind hole, threaded stud and base plate in AISI 304 stainless steel, vibration-damper body in natural rubber NR, black colour, hardness 55 Shore A ± 5 .

FEATURES AND APPLICATIONS

The rubber buffers have been designed to damp vibrations, shocks and noises produced by moving bodies or non-balanced vibrating masses of equipment and machines.

Unlike DVA rubber buffers, under pressure these articles allow more lateral movement without leaving the vertical plane of the metal insert.

Vibrations can cause:

- malfunctioning and reduction of the machine lifespan and/or of the adjacent ones;
- damage to operator's health;
- noise.

Load diagrams for each single code are available on request. See Technical data and guidelines for the choice(on page).

SPECIAL EXECUTIONS ON REQUEST

Natural rubber NR, hardness 40, 70 Shore A ± 5 , for executions with AISI 304 stainless steel base.



| D | | | | L | | | |
|----|------|----|------|----|------|------|------|
| mm | inch | mm | inch | mm | inch | mm | inch |
| 10 | 0.39 | 50 | 1.97 | 8 | 0.31 | 33.5 | 1.32 |
| 15 | 0.59 | 55 | 2.17 | 10 | 0.39 | 34 | 1.34 |
| 20 | 0.79 | 57 | 2.24 | 15 | 0.59 | 45 | 1.77 |
| 21 | 0.83 | 60 | 2.36 | 19 | 0.75 | 48 | 1.89 |
| 25 | 0.98 | 70 | 2.75 | 20 | 0.79 | 50 | 1.97 |
| 30 | 1.18 | 72 | 2.83 | 22 | 0.87 | 53 | 2.09 |
| 35 | 1.38 | 75 | 2.95 | 25 | 0.98 | 60 | 2.36 |
| 40 | 1.57 | 95 | 3.74 | 30 | 1.18 | 75 | 2.95 |

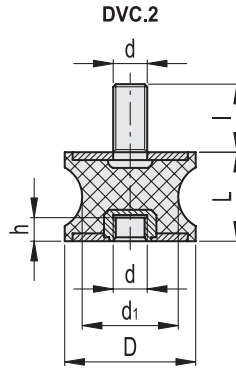

DVC.2 - 10 - 8 - 10 - M4 - 10 - 55
 D d1 L d l Shore A

METRIC

| Description | D | L | d | d1 | l | h | △ | Hardness 40 Shore A | | | Hardness 55 Shore A | | | Hardness 70 Shore A | | | | | |
|---------------------------|----|------|-----|-----|----|----|-----|---------------------|--------------|----------------------|---------------------|--------|--------------|----------------------|------------------|--------|--------------|----------------------|------------------|
| | | | | | | | | Code | Max load [N] | Max. deflection [mm] | Stiffness [N/mm] | Code | Max load [N] | Max. deflection [mm] | Stiffness [N/mm] | Code | Max load [N] | Max. deflection [mm] | Stiffness [N/mm] |
| DVC.2-10-8-10-M4-10-* | 10 | 10 | M4 | 8 | 10 | 4 | 3 | 433901 | 47 | 2.5 | 19 | 433751 | 88 | 2.5 | 35 | 434051 | 124 | 2.5 | 50 |
| DVC.2-15-8,5-15-M4-10-* | 15 | 15 | M4 | 8,5 | 10 | 4 | 5 | 433911 | 81 | 3.75 | 22 | 433761 | 132 | 3.75 | 35 | 434061 | 180 | 3.75 | 48 |
| DVC.2-15-12-15-M4-10-* | 15 | 15 | M4 | 12 | 10 | 4 | 6 | 433916 | 132 | 3.75 | 35 | 433766 | 142 | 3.75 | 38 | 434066 | 191 | 3.75 | 51 |
| DVC.2-20-14-15-M6-18-* | 20 | 15 | M6 | 14 | 18 | 6 | 14 | 433923 | 278 | 3.75 | 74 | 433773 | 360 | 3.75 | 96 | 434073 | 429 | 3.75 | 114 |
| DVC.2-20-14-19-M6-18-* | 20 | 19 | M6 | 14 | 18 | 6 | 16 | 433925 | 255 | 4.75 | 54 | 433775 | 314 | 4.75 | 66 | 434075 | 398 | 4.75 | 84 |
| DVC.2-20-14-20-M6-18-* | 20 | 20 | M6 | 14 | 18 | 6 | 17 | 433927 | 252 | 5 | 50 | 433777 | 305 | 5 | 61 | 434077 | 396 | 5 | 79 |
| DVC.2-21-16-22-M6-18-* | 21 | 22 | M6 | 16 | 18 | 6 | 18 | 433931 | 260 | 5.5 | 47 | 433781 | 340 | 5.5 | 62 | 434081 | 399 | 5.5 | 73 |
| DVC.2-20-12-30-M6-18-* | 20 | 30 | M6 | 12 | 18 | 6 | 22 | 433921 | 174 | 7.5 | 23 | 433771 | 267 | 7.5 | 36 | 434071 | 299 | 7.5 | 40 |
| DVC.2-20-14-30-M6-18-* | 20 | 30 | M6 | 14 | 18 | 6 | 25 | 433929 | 173 | 7.5 | 23 | 433779 | 255 | 7.5 | 34 | 434079 | 380 | 7.5 | 51 |
| DVC.2-25-18-20-M6-18-* | 25 | 20 | M6 | 18 | 18 | 6 | 36 | 433941 | 593 | 5 | 119 | 433791 | 631 | 5 | 126 | 434091 | 1038 | 5 | 208 |
| DVC.2-25-20-20-M6-18-* | 25 | 20 | M6 | 20 | 18 | 6 | 39 | 433946 | 695 | 5 | 139 | 433796 | 1119 | 5 | 224 | 434096 | 1713 | 5 | 343 |
| DVC.2-30-22-20-M8-20-* | 30 | 20 | M8 | 22 | 20 | 8 | 44 | 433956 | 655 | 5 | 131 | 433806 | 863 | 5 | 173 | 434106 | 1272 | 5 | 254 |
| DVC.2-30-18-25-M8-20-* | 30 | 25 | M8 | 18 | 20 | 8 | 49 | 433951 | 572 | 6.25 | 92 | 433801 | 881 | 6.25 | 141 | 434101 | 1762 | 6.25 | 282 |
| DVC.2-35-31-15-M8-20-* | 35 | 15 | M8 | 31 | 20 | 8 | 46 | 433966 | 785 | 3.75 | 209 | 433816 | 1310 | 3.75 | 349 | 434116 | 2453 | 3.75 | 654 |
| DVC.2-35-25-34-M8-20-* | 35 | 34 | M8 | 25 | 20 | 8 | 60 | 433961 | 1355 | 8.5 | 159 | 433811 | 1975 | 8.5 | 232 | 434111 | 3050 | 8.5 | 359 |
| DVC.2-40-30-25-M8-23-* | 40 | 25 | M8 | 30 | 23 | 8 | 73 | 433975 | 2392 | 6.25 | 383 | 433825 | 3188 | 6.25 | 510 | 434125 | 4432 | 6.25 | 709 |
| DVC.2-40-25-30-M8-23-* | 40 | 30 | M8 | 25 | 23 | 8 | 76 | 433973 | 1229 | 7.5 | 164 | 433823 | 2127 | 7.5 | 284 | 434123 | 2947 | 7.5 | 393 |
| DVC.2-40-33-30-M8-23-* | 40 | 30 | M8 | 33 | 23 | 8 | 80 | 433979 | 861 | 7.5 | 115 | 433829 | 1178 | 7.5 | 157 | 434129 | 2191 | 7.5 | 292 |
| DVC.2-40-20-48-M8-23-* | 40 | 48 | M8 | 20 | 23 | 8 | 86 | 433971 | 657 | 12 | 55 | 433821 | 931 | 12 | 78 | 434121 | 1482 | 12 | 124 |
| DVC.2-40-32-50-M8-23-* | 40 | 50 | M8 | 32 | 23 | 8 | 94 | 433977 | 684 | 12.5 | 55 | 433827 | 1043 | 12.5 | 83 | 434127 | 1733 | 12.5 | 139 |
| DVC.2-50-42-30-M10-28-* | 50 | 30 | M10 | 42 | 28 | 10 | 112 | 433981 | 1420 | 7.5 | 189 | 433831 | 1975 | 7.5 | 263 | 434131 | 2945 | 7.5 | 393 |
| DVC.2-55-44-45-M10-28-* | 55 | 45 | M10 | 44 | 28 | 10 | 162 | 433986 | 1012 | 11.25 | 90 | 433836 | 1320 | 11.25 | 117 | 434136 | 2013 | 11.25 | 179 |
| DVC.2-57-25-45-M10-28-* | 57 | 45 | M10 | 25 | 28 | 10 | 155 | 433991 | 1007 | 11.25 | 90 | 433841 | 1313 | 11.25 | 117 | 434141 | 1765 | 11.25 | 157 |
| DVC.2-60-49-60-M10-28-* | 60 | 60 | M10 | 49 | 28 | 10 | 245 | 433996 | 1430 | 15 | 95 | 433846 | 2560 | 15 | 171 | 434146 | 4428 | 15 | 295 |
| DVC.2-70-45-53-M12-37-* | 70 | 53 | M12 | 45 | 37 | 12 | 321 | 434001 | 1993 | 13.25 | 150 | 433851 | 2219 | 13.25 | 167 | 434151 | 2473 | 13.25 | 187 |
| DVC.2-72-64-33,5-M12-37-* | 72 | 33,5 | M12 | 64 | 37 | 12 | 385 | 434006 | 3530 | 8.38 | 421 | 433856 | 3364 | 8.38 | 401 | 434156 | 7740 | 8.38 | 924 |
| DVC.2-75-60-40-M12-37-* | 75 | 40 | M12 | 60 | 37 | 12 | 450 | 434011 | 2605 | 10 | 261 | 433861 | 3922 | 10 | 392 | 434161 | 7005 | 10 | 701 |
| DVC.2-95-80-75-M16-41-* | 95 | 75 | M16 | 80 | 41 | 16 | 740 | 434016 | 7438 | 18.75 | 397 | 433866 | 1036 | 18.75 | 55 | 434166 | 13990 | 18.75 | 746 |



Vibration damping elements



Conversion Table
1 mm = 0.039 inch

| D | | | | L | | | |
|----|------|----|------|----|------|------|------|
| mm | inch | mm | inch | mm | inch | mm | inch |
| 10 | 0.39 | 50 | 1.97 | 8 | 0.31 | 33.5 | 1.32 |
| 15 | 0.59 | 55 | 2.17 | 10 | 0.39 | 34 | 1.34 |
| 20 | 0.79 | 57 | 2.24 | 15 | 0.59 | 45 | 1.77 |
| 21 | 0.83 | 60 | 2.36 | 19 | 0.75 | 48 | 1.89 |
| 25 | 0.98 | 70 | 2.75 | 20 | 0.79 | 50 | 1.97 |
| 30 | 1.18 | 72 | 2.83 | 22 | 0.87 | 53 | 2.09 |
| 35 | 1.38 | 75 | 2.95 | 25 | 0.98 | 60 | 2.36 |
| 40 | 1.57 | 95 | 3.74 | 30 | 1.18 | 75 | 2.95 |

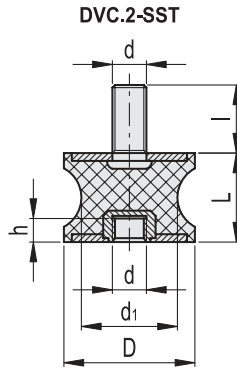

DVC.2 - 10 - 8 - 10 - SST - M4 - 10 - 55

D
d₁
L
Stainless steel
d
l
Shore A

INOX STAINLESS STEEL **METRIC**

| Description | D | L | d | d ₁ | l | h | Δ | Hardness 40 Shore A | | | Hardness 55 Shore A | | | Hardness 70 Shore A | | | |
|--------------------------------|----|------|-----|----------------|----|----|-----|---------------------|--------------|----------------------|---------------------|------|--------------|----------------------|------------------|-------|--------------|
| | | | | | | | | Code | Max load [N] | Max. deflection [mm] | Stiffness [N/mm] | Code | Max load [N] | Max. deflection [mm] | Stiffness [N/mm] | Code | Max load [N] |
| DVC.2-10-8-10-SST-M4-10-55 | 10 | 10 | M4 | 8 | 10 | 4 | 3 | 47 | 2.5 | 19 | 434201 | 88 | 2.5 | 35 | 124 | 2.5 | 50 |
| DVC.2-15-8,5-15-SST-M4-10-55 | 15 | 15 | M4 | 8,5 | 10 | 4 | 5 | 81 | 3.75 | 22 | 434211 | 132 | 3.75 | 35 | 180 | 3.75 | 48 |
| DVC.2-15-12-15-SST-M4-10-55 | 15 | 15 | M4 | 12 | 10 | 4 | 6 | 132 | 3.75 | 35 | 434216 | 142 | 3.75 | 38 | 191 | 3.75 | 51 |
| DVC.2-20-14-15-SST-M6-18-55 | 20 | 15 | M6 | 14 | 18 | 6 | 14 | 278 | 3.75 | 74 | 434223 | 360 | 3.75 | 96 | 429 | 3.75 | 114 |
| DVC.2-20-14-19-SST-M6-18-55 | 20 | 19 | M6 | 14 | 18 | 6 | 16 | 255 | 4.75 | 54 | 434225 | 314 | 4.75 | 66 | 398 | 4.75 | 84 |
| DVC.2-20-14-20-SST-M6-18-55 | 20 | 20 | M6 | 14 | 18 | 6 | 17 | 252 | 5 | 50 | 434227 | 305 | 5 | 61 | 396 | 5 | 79 |
| DVC.2-21-16-22-SST-M6-18-55 | 21 | 22 | M6 | 16 | 18 | 6 | 18 | 260 | 5.5 | 47 | 434231 | 340 | 5.5 | 62 | 399 | 5.5 | 73 |
| DVC.2-20-12-30-SST-M6-18-55 | 20 | 30 | M6 | 12 | 18 | 6 | 22 | 174 | 7.5 | 23 | 434221 | 267 | 7.5 | 36 | 299 | 7.5 | 40 |
| DVC.2-20-14-30-SST-M6-18-55 | 20 | 30 | M6 | 14 | 18 | 6 | 25 | 173 | 7.5 | 23 | 434229 | 255 | 7.5 | 34 | 380 | 7.5 | 51 |
| DVC.2-25-18-20-SST-M6-18-55 | 25 | 20 | M6 | 18 | 18 | 6 | 36 | 593 | 5 | 119 | 434241 | 631 | 5 | 126 | 1038 | 5 | 208 |
| DVC.2-25-20-20-SST-M6-18-55 | 25 | 20 | M6 | 20 | 18 | 6 | 39 | 695 | 5 | 139 | 434246 | 1119 | 5 | 224 | 1713 | 5 | 343 |
| DVC.2-30-22-20-SST-M8-20-55 | 30 | 20 | M8 | 22 | 20 | 8 | 44 | 655 | 5 | 131 | 434256 | 863 | 5 | 173 | 1272 | 5 | 254 |
| DVC.2-30-18-25-SST-M8-20-55 | 30 | 25 | M8 | 18 | 20 | 8 | 49 | 572 | 6.25 | 92 | 434251 | 881 | 6.25 | 141 | 1762 | 6.25 | 282 |
| DVC.2-35-31-15-SST-M8-20-55 | 35 | 15 | M8 | 31 | 20 | 8 | 46 | 785 | 3.75 | 209 | 434266 | 1310 | 3.75 | 349 | 2453 | 3.75 | 654 |
| DVC.2-35-25-34-SST-M8-20-55 | 35 | 34 | M8 | 25 | 20 | 8 | 60 | 1355 | 8.5 | 159 | 434261 | 1975 | 8.5 | 232 | 3050 | 8.5 | 359 |
| DVC.2-40-30-25-SST-M8-23-55 | 40 | 25 | M8 | 30 | 23 | 8 | 73 | 2392 | 6.25 | 383 | 434275 | 3188 | 6.25 | 510 | 4432 | 6.25 | 709 |
| DVC.2-40-25-30-SST-M8-23-55 | 40 | 30 | M8 | 25 | 23 | 8 | 76 | 1229 | 7.5 | 164 | 434273 | 2127 | 7.5 | 284 | 2947 | 7.5 | 393 |
| DVC.2-40-33-30-SST-M8-23-55 | 40 | 30 | M8 | 33 | 23 | 8 | 80 | 861 | 7.5 | 115 | 434279 | 1178 | 7.5 | 157 | 2191 | 7.5 | 292 |
| DVC.2-40-20-48-SST-M8-23-55 | 40 | 48 | M8 | 20 | 23 | 8 | 86 | 657 | 12 | 55 | 434271 | 931 | 12 | 78 | 1482 | 12 | 124 |
| DVC.2-40-32-50-SST-M8-23-55 | 40 | 50 | M8 | 32 | 23 | 8 | 94 | 684 | 12.5 | 55 | 434277 | 1043 | 12.5 | 83 | 1733 | 12.5 | 139 |
| DVC.2-50-42-30-SST-M10-28-55 | 50 | 30 | M10 | 42 | 28 | 10 | 112 | 1420 | 7.5 | 189 | 434281 | 1975 | 7.5 | 263 | 2945 | 7.5 | 393 |
| DVC.2-55-44-45-SST-M10-28-55 | 55 | 45 | M10 | 44 | 28 | 10 | 162 | 1012 | 11.25 | 90 | 434286 | 1320 | 11.25 | 117 | 2013 | 11.25 | 179 |
| DVC.2-57-25-45-SST-M10-28-55 | 57 | 45 | M10 | 25 | 28 | 10 | 155 | 1007 | 11.25 | 90 | 434291 | 1313 | 11.25 | 117 | 1765 | 11.25 | 157 |
| DVC.2-60-49-60-SST-M10-28-55 | 60 | 60 | M10 | 49 | 28 | 10 | 245 | 1430 | 15 | 95 | 434296 | 2560 | 15 | 171 | 4428 | 15 | 295 |
| DVC.2-70-45-53-SST-M12-37-55 | 70 | 53 | M12 | 45 | 37 | 12 | 321 | 1993 | 13.25 | 150 | 434301 | 2219 | 13.25 | 167 | 2473 | 13.25 | 187 |
| DVC.2-72-64-33,5-SST-M12-37-55 | 72 | 33,5 | M12 | 64 | 37 | 12 | 385 | 3530 | 8.38 | 421 | 434306 | 3364 | 8.38 | 401 | 7740 | 8.38 | 924 |
| DVC.2-75-60-40-SST-M12-37-55 | 75 | 40 | M12 | 60 | 37 | 12 | 450 | 2605 | 10 | 261 | 434311 | 3922 | 10 | 392 | 7005 | 10 | 701 |
| DVC.2-95-80-75-SST-M16-41-55 | 95 | 75 | M16 | 80 | 41 | 16 | 740 | 7438 | 18.75 | 397 | 434316 | 1036 | 18.75 | 55 | 13990 | 18.75 | 746 |

Vibration damping elements