

THIS DRAWING IS UNPUBLISHED. RELEASED FOR PUBLICATION
 © COPYRIGHT - By - ALL RIGHTS RESERVED.

REVISIONS				
P	LTR	DESCRIPTION	DATE	APVD
P		REV PER ECO-16-014416	10-28-16	CT DM

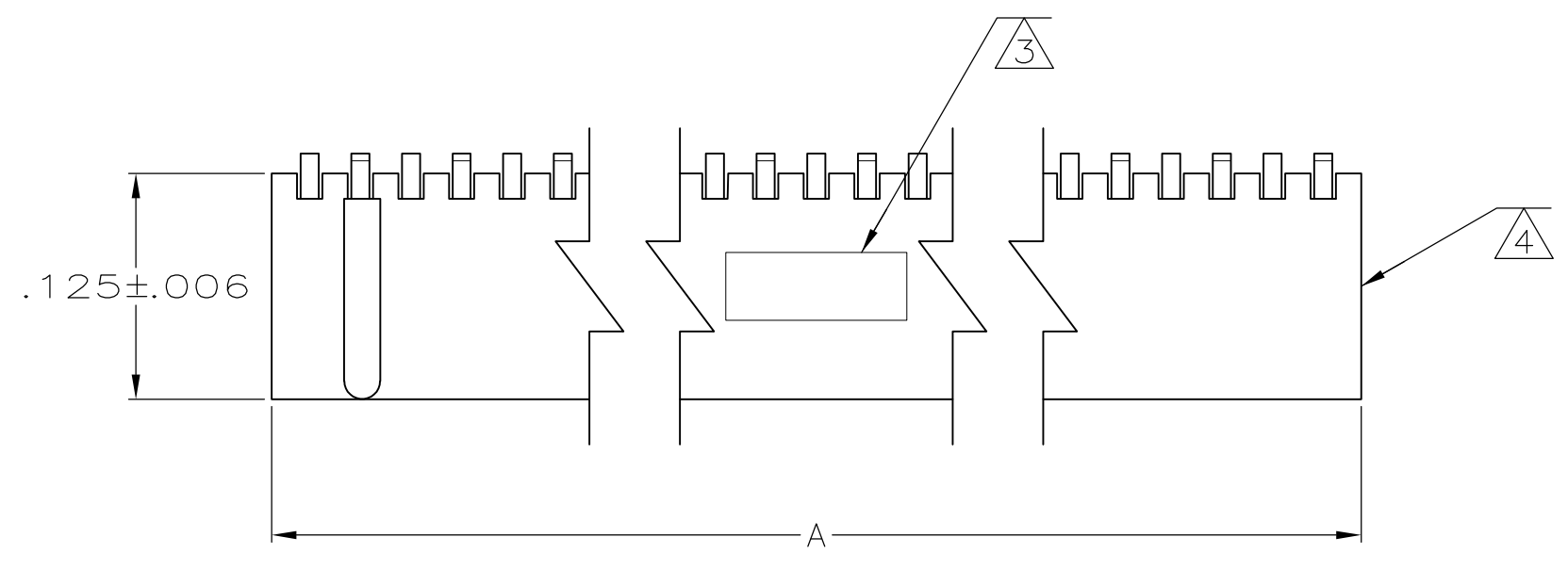

- POLARIZING KEYS ARE INTENDED TO PREVENT 180° MISMATCH OF LIKE SIZES; KEYS ARE NOT INTENDED TO PREVENT MATING OF DIFFERENT SIZES.
- TAILS SOLDER DIPPED .025 MIN LENGTH, WITH SN63 SOLDER PER QQ-S-571.
- MARK AMP, PART NUMBER AND DATE CODE. MARKING MAY BE ON 2 SIDES OF THE PART. SMALLER ASSEMBLIES MAY CONTAIN NO MARKING OR PARTIAL MARKING.
- HOUSING MATERIAL: FLAME RETARDANT GLASS REINFORCED POLYESTER. COLOR: BLACK.
- SOCKET CONTACT MATERIAL: BERYLLIUM COPPER PER QQ-C-533. ALTERNATE MATERIAL: PHOSPHOR BRONZE PER QQ-B-750. CONTACT FINISH: PLATED GOLD .000050 THICK ON MATING AREA PLATED GOLD FLASH ON CONTACT TAIL, ALL OVER NICKEL .000050 THICK.

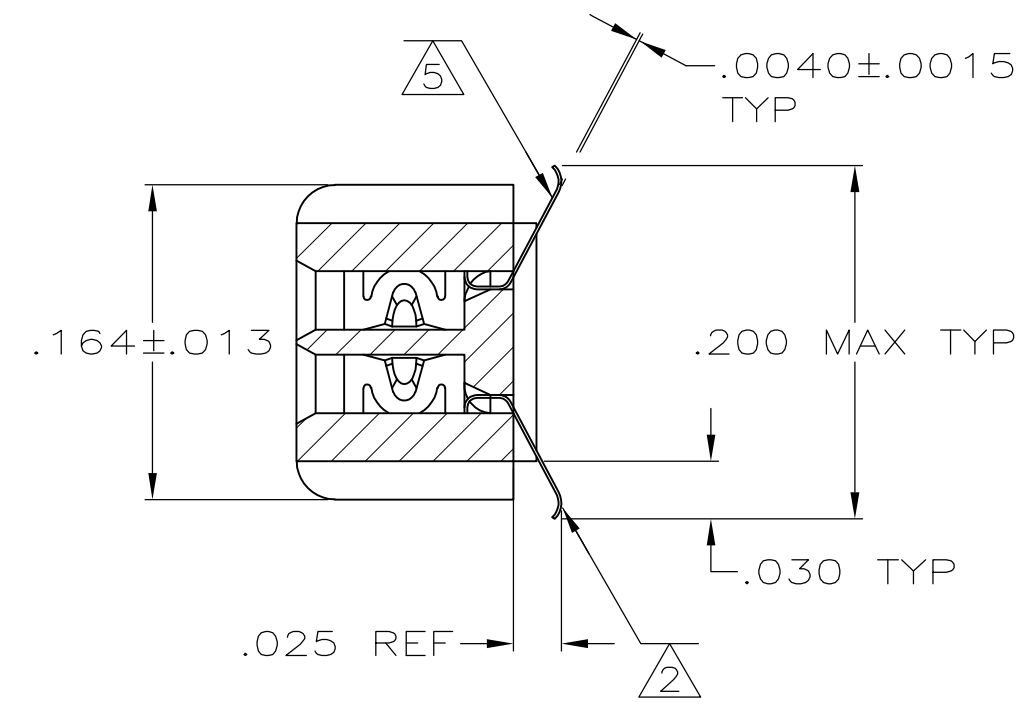
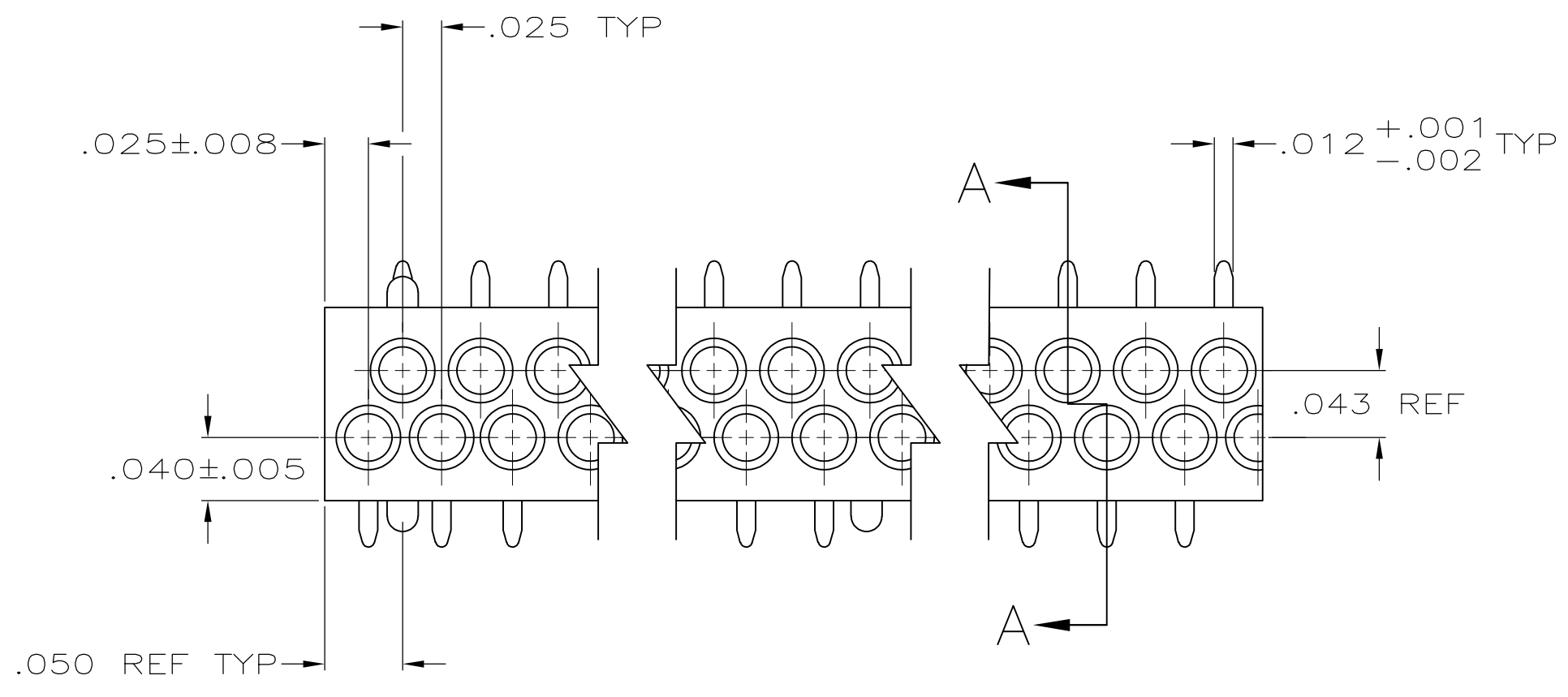

SECTION A-A

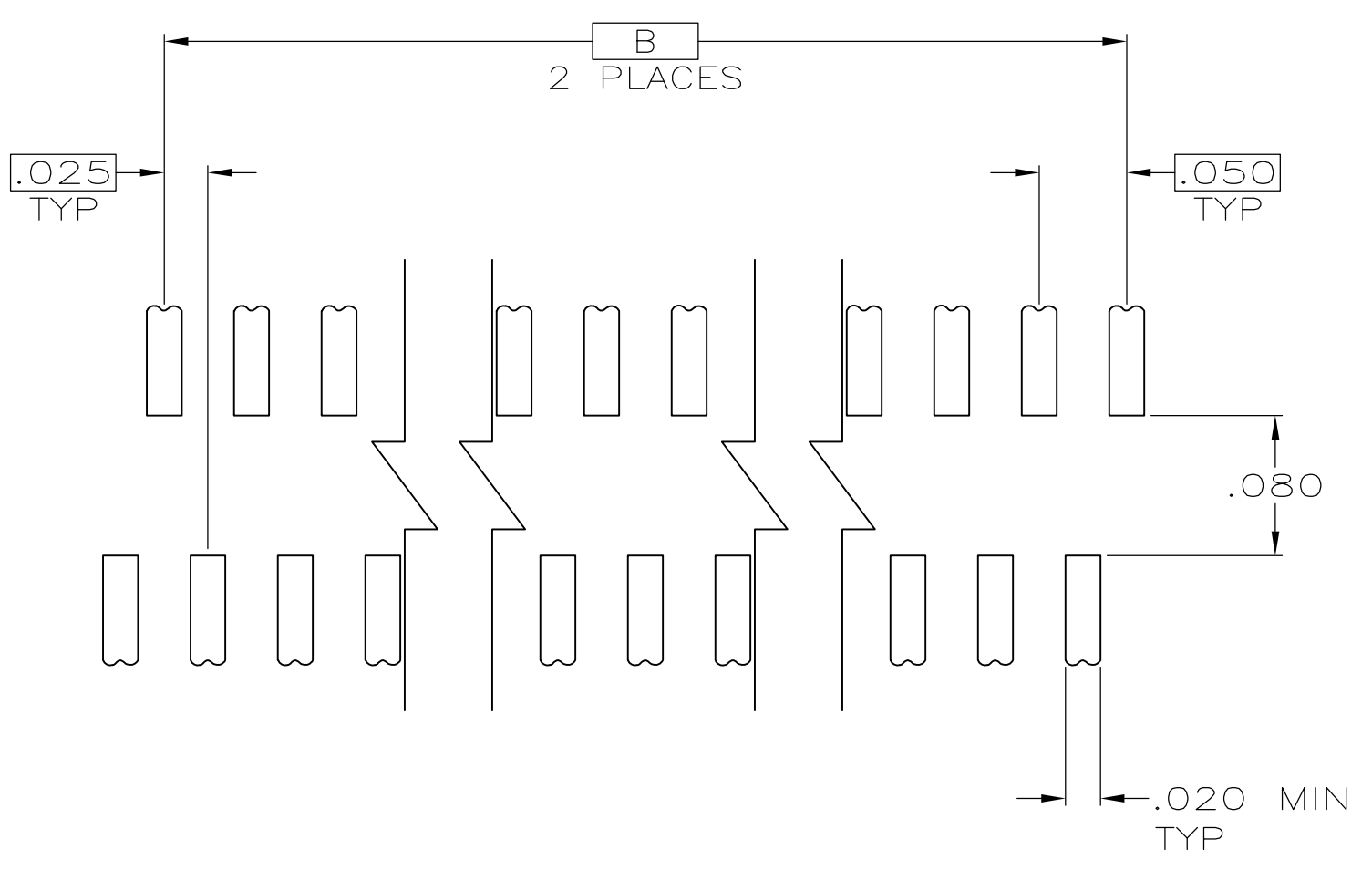

RECOMMENDED P. C. BOARD LAYOUT

.700	.775	30	213143-8
.550	.625	24	213143-7
1.200	1.275	50	213143-6
1.150	1.225	48	213143-5
.950	1.025	40	213143-4
.600	.675	26	213143-3
.100	.175	6	213143-2
.050	.125	4	213143-1
B	A	NO. OF POSITIONS	PART NO

THIS DRAWING IS A CONTROLLED DOCUMENT.		DWN T. SHUEY	12-7-88	TE TE Connectivity	
DIMENSIONS: INCHES		CHK -	APVD -		
TOLERANCES UNLESS OTHERWISE SPECIFIED:		PRODUCT SPEC -		SIZE A2	
0 PLC ± -		APPLICATION SPEC -		CAGE CODE 00779	
1 PLC ± -		WEIGHT 0		DRAWING NO C-213143	
2 PLC ± -		CUSTOMER DRAWING		RESTRICTED TO -	
3 PLC ± .010		SCALE 10:1		SHEET 1 of 1	
4 PLC ± -		REV P			
ANGLES ± -					
MATERIAL SEE CALLOUTS		FINISH SEE CALLOUTS			