

CR6A2GPP CR6A8GPP  
 CR6A4GPP CR6A10GPP  
 CR6A6GPP

GLASS PASSIVATED JUNCTION  
 GENERAL PURPOSE SILICON RECTIFIER  
 6A, 200 THRU 1000 VOLTS

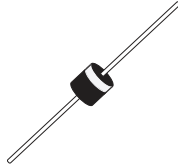

CASE 106

# Central<sup>TM</sup>

## Semiconductor Corp.

### DESCRIPTION:

The CENTRAL SEMICONDUCTOR CR6A4GPP Series types are 6.0 Amp Glass Passivated Junction Silicon Rectifiers which are high quality, well constructed, highly reliable components designed for use in all types of military, commercial, industrial, entertainment, computer, and automotive applications.

**THIS DEVICE IS MANUFACTURED WITH A GLASS PASSIVATED CHIP FOR OPTIMUM RELIABILITY.**

**MARKING: FULL PART NUMBER**

**MAXIMUM RATINGS:** ( $T_A=25^\circ\text{C}$  unless otherwise noted)

		<b>CR6A</b>					
	<b>SYMBOL</b>	<b>2GPP</b>	<b>4GPP</b>	<b>6GPP</b>	<b>8GPP</b>	<b>10GPP</b>	<b>UNITS</b>
Peak Repetitive Reverse Voltage	$V_{RRM}$	200	400	600	800	1000	V
DC Blocking Voltage	$V_R$	200	400	600	800	1000	V
RMS Reverse Voltage	$V_{R(RMS)}$	140	280	420	560	700	V
Non-Repetitive Peak Reverse Voltage (Halfwave, single phase, 60Hz peak)	$V_{RSM}$	240	480	720	960	1200	V
Average Forward Current, $T_A=60^\circ\text{C}$	$I_O$			6.0			A
Non-Repetitive Peak Forward Surge Current (Halfwave, single phase, 60Hz peak)	$I_{FSM}$			400			A
Operating and Storage Junction Temperature	$T_J, T_{stg}$			-65 to +175			$^\circ\text{C}$

**ELECTRICAL CHARACTERISTICS:** ( $T_A=25^\circ\text{C}$  unless otherwise noted))

<b>SYMBOL</b>	<b>TEST CONDITIONS</b>	<b>MAX</b>	<b>UNITS</b>
$I_R$	$V_R=\text{Rated } V_{RRM}$	10	$\mu\text{A}$
$I_R$	$V_R=\text{Rated } V_{RRM}, T_A=100^\circ\text{C}$	1.0	mA
$V_F$	$I_F=6.0\text{A}$	1.0	V

CASE 106 - MECHANICAL OUTLINE

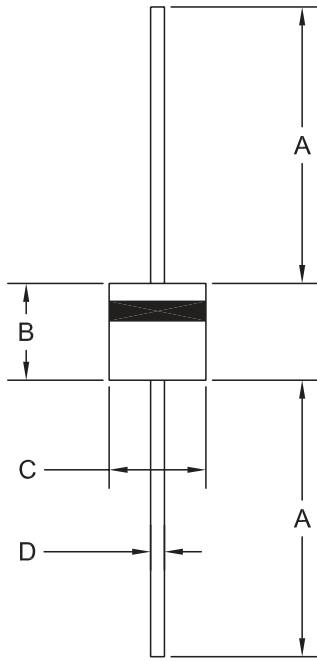

R1

DIMENSIONS				
SYMBOL	INCHES		MILLIMETERS	
	MIN	MAX	MIN	MAX
A	1.000	-	25.40	-
B	0.340	0.360	8.64	9.14
C	0.340	0.360	8.64	9.14
D	0.048	0.053	1.22	1.35

CASE 106 (REV: R1)

MARKING: FULL PART NUMBER

R1 (1-May 2008)

## OUTSTANDING SUPPORT AND SUPERIOR SERVICES



---

### PRODUCT SUPPORT

Central's operations team provides the highest level of support to insure product is delivered on-time.

- Supply management (Customer portals)
- Inventory bonding
- Consolidated shipping options
- Custom bar coding for shipments
- Custom product packing

---

### DESIGNER SUPPORT/SERVICES

Central's applications engineering team is ready to discuss your design challenges. Just ask.

- Free quick ship samples (2<sup>nd</sup> day air)
- Online technical data and parametric search
- SPICE models
- Custom electrical curves
- Environmental regulation compliance
- Customer specific screening
- Up-screening capabilities
- Special wafer diffusions
- PbSn plating options
- Package details
- Application notes
- Application and design sample kits
- Custom product and package development

---

### REQUESTING PRODUCT PLATING

1. If requesting Tin/Lead plated devices, add the suffix "TIN/LEAD" to the part number when ordering (example: 2N2222A TIN/LEAD).
2. If requesting Lead (Pb) Free plated devices, add the suffix "PBFREE" to the part number when ordering (example: 2N2222A PBFREE).

---

### CONTACT US

#### Corporate Headquarters & Customer Support Team

Central Semiconductor Corp.  
145 Adams Avenue  
Hauppauge, NY 11788 USA  
Main Tel: (631) 435-1110  
Main Fax: (631) 435-1824  
Support Team Fax: (631) 435-3388  
[www.centrasemi.com](http://www.centrasemi.com)

**Worldwide Field Representatives:**  
[www.centrasemi.com/wwreps](http://www.centrasemi.com/wwreps)

**Worldwide Distributors:**  
[www.centrasemi.com/wwdistributors](http://www.centrasemi.com/wwdistributors)

---

For the latest version of Central Semiconductor's **LIMITATIONS AND DAMAGES DISCLAIMER**, which is part of Central's Standard Terms and Conditions of sale, visit: [www.centrasemi.com/terms](http://www.centrasemi.com/terms)